



---

**To:** Parks, Recreation and Cultural Services Committee  
**Date:** February 6, 2018

**From:** Serena Lusk  
General Manager, Community Services  
Jane Fernyhough  
Director, Arts, Culture and Heritage Services  
**File:** 06-2345-20-  
WCAM1/Vol 01

**Re:** **West Cambie Neighbourhood Park Master Plan and Public Art Capital Project**

---



**Staff Recommendation**

1. That the West Cambie Neighbourhood Park Master Plan, as detailed in the staff report titled “West Cambie Neighbourhood Park Master Plan and Public Art Capital Project,” dated February 6, 2018, from the General Manager, Community Services, and the Director of Arts, Culture and Heritage Services be approved;
2. That the concept proposal for the proposed public artwork for the West Cambie Neighbourhood Park, titled “Pergola Garden,” by the artist team Polymétis Projects, as detailed in the staff report titled “West Cambie Neighbourhood Park Master Plan and Public Art Capital Project,” dated February 6, 2018, from the General Manager, Community Services, and the Director of Arts, Culture and Heritage Services, be endorsed;
3. That the West Cambie Neighbourhood Park Public Art Project for \$725,000 be approved and included in the 2018 Capital Budget; and
4. That the City’s 5-Year Financial Plan (2018–2022) be amended to include the \$725,000 for the West Cambie Neighbourhood Park Public Art Project funded by the Public Art Reserve.

Serena Lusk  
General Manager, Community Services  
(604-233-3344)

Jane Fernyhough  
Director, Arts, Culture and Heritage Services  
(604-276-4288)

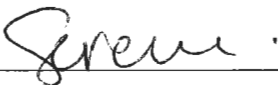
Att. 3

REPORT CONCURRENCE		
<b>ROUTED TO:</b>  Engineering Finance	<b>CONCURRENCE</b>  <input checked="" type="checkbox"/> <input checked="" type="checkbox"/>	<b>CONCURRENCE OF GENERAL MANAGER</b>  
<b>REVIEWED BY STAFF REPORT / AGENDA REVIEW SUBCOMMITTEE</b>	<b>INITIALS:</b>  CS	<b>APPROVED BY CAO</b>  

## Staff Report

### Origin

West Cambie Neighbourhood Park is a recent addition to the City of Richmond's park and open space system. It will serve as the local park space for the residents in the rapidly developing Alexandra neighbourhood, which is adjacent to Richmond's City Centre. Land acquisition for the site was completed in 2011; the park is comprised of large lots, formerly used for single family purposes. The park has been graded, and pathways have been constructed to provide residents opportunities for walking and jogging, as well as connections to adjacent neighbourhood greenways. Open lawn areas have also been used for informal recreational activities.

In July 2012, construction of the first district energy system in the City of Richmond, the Alexandra District Energy Utility (ADEU), was completed. The building housing the Energy Centre is located in the north central part of West Cambie Neighbourhood Park. Field One is located in the Greenway to the north. Field Two of its geo-exchange system has been installed in the east portion of the site.

Capital submissions for park construction were approved in 2010, 2012, 2013 and 2016; another submission will be made in 2019.

On April 10, 2017, Council approved the West Cambie Neighbourhood Park Integrated Landscape Public Art Project Call to Artists to select and contract an artist, or artist team, as part of the West Cambie Neighbourhood Park planning process.

Open Houses were held in September and November 2017 to gain public input towards the development and refinement of a master plan for the site and the public art opportunity.

The purpose of this report is to summarise the findings of the public consultation process, including the feedback received online via the City's social media network, and to present the West Cambie Neighbourhood Park Master Plan and public art concept proposal for approval.

This report supports Council's 2014-2018 Term Goal #2 A Vibrant, Active and Connected City:

*Continue the development and implementation of an excellent and accessible system of programs, services, and public spaces that reflect Richmond's demographics, rich heritage, diverse needs, and unique opportunities, and that facilitate active, caring, and connected communities.*

2.1. *Strong neighbourhoods.*

2.3. *Outstanding places, programs and services that support active living, wellness and a sense of belonging.*

2.4. *Vibrant arts, culture and heritage opportunities.*

This report supports Council's 2014-2018 Term Goal #3 A Well-Planned Community:

*Adhere to effective planning and growth management practices to maintain and enhance the livability, sustainability and desirability of our City and its neighbourhoods, and to ensure the results match the intentions of our policies and bylaws.*

3.2. *A strong emphasis on physical and urban design.*

This report supports Council's 2014-2018 Term Goal #4 Leadership in Sustainability:

*Continue advancement of the City's sustainability framework and initiatives to improve the short and long term livability of our City, and that maintain Richmond's position as a leader in sustainable programs, practices and innovations.*

4.2. *Innovative projects and initiatives to advance sustainability.*

## **Analysis**

### The Existing Site

West Cambie Neighbourhood Park is approximately six acres in size and together with the neighbourhood Greenways, it will play an important role in connecting north to Thomsett Elementary School and south to Garden City Lands, a destination open space being developed for community wellness, agriculture, and ecological conservation.

Development of the surrounding Alexandra Neighbourhood has occurred over the past several years. Multifamily residences have been constructed to the east and west, and more development is underway across Tomicki Avenue to the south. Elevations of the new roads which front onto the park have been raised considerably. This has resulted in the grade of the park being quite low with respect to the rest of the neighbourhood; resulting in water pools in lower parts of the site.

Remnants of the park's former residential landscapes still exist, including ornamental and naturalized plant material. In particular, one property was used as a commercial garden nursery, and many trees, including a Sequoiadendron "Redwood" grove, still exist on the site. This variety of landscape forms important ecological corridors and foraging grounds for raptors, such as barn owls, as well as habitat for other wildlife species. The greenways also retain a similar combination of introduced and naturalized tree, shrubs, and grass areas.

To date, the park has been developed to a basic level. Recently constructed pathways are frequently used for walking and jogging within the park property; the open lawns are used for informal recreation; and the existing vegetation provides opportunities for appreciation of nature. In addition to this work, a geothermal energy exchange field has been installed within the eastern section of the park, along with the Alexandra District Energy Utility Energy Centre building which occupies a central location along the parks' Odlin Road frontage. Expansion of the field into the western part of the site is currently being planned.

### Public Consultation Process

In the fall of 2017, the public was invited to two Open Houses to provide input and feedback towards preparation of the concept plan for the park. The first Open House took place on September 14, 2017, at the park site; the second Open House was hosted on November 18, 2017, at the Polygon sales centre, located on Tomicki Avenue.

Concurrent to the Open House process, the community was also invited to view all of the engagement process materials and complete the questionnaires on the Let's Talk Richmond website, [www.LetsTalkRichmond.ca](http://www.LetsTalkRichmond.ca). All of the public consultation results are provided in Attachment 1, page 2.

Phase One was considered the discovery phase, ideas related to park programming, character, and play equipment were presented, examined, and explored. A total of 80 respondents completed the survey. Based on this feedback, guidelines were developed to inform the design of the park and its facilities:

#### **1. Neighbourhood Destination:**

- create a sense of place;
- provide diverse uses for a broad range of age groups; and
- offer a well-rounded, nature inspired, play experience.

#### **2. Ecological/Environmental Focus:**

- respond to the park's unique hydrological pattern;
- celebrate and preserve significant trees located within the park;
- demonstrate the park's environmental values; and
- provide natural habitat for animals and insects.

#### **3. Place of Connection:**

- create a place for people to gather, interact with others and reconnect with nature;
- provide connections to existing and planned greenways, as well as bicycle paths; and
- integrate surrounding green spaces and natural areas.

For Phase Two of the consultation process, two concept options were prepared for evaluation (Attachment 1, page 7). The programming elements were the same, but the options differed in their layout of the various park features and use areas. Comments received at the Open Houses and via the Let's Talk website, 40 in total, were amalgamated to help develop the final concept plan.

## Final West Cambie Neighbourhood Park Master Plan

The proposed concept design for the park (Attachment 1, page 8) maintains a strong natural expression throughout, with greater refinement along certain edges, and within key use areas.

Highlights of the plan include:

### **Gathering Area**

This space is to be developed south of the ADEU Energy Centre building; it will form the core of the social life of the park. Seating, picnic tables, and a shelter will be provided to encourage social gathering and the forming of connections among the neighbourhood residents.

### **Open Lawn**

An open lawn exists on the east side of the park over the existing geothermal exchange field. It will be improved so that it can be used for informal activities. It will also be managed as part of the West Cambie ecological corridor, along with the greenways, providing habitat and hunting grounds for owls and possibly other species.

### **Amphitheatre**

A large mound, approximately 1.5 metres in height, is proposed to anchor the southwest corner of the park. Its eastern face will support amphitheatre seating that will look east towards an informal performance area where occasional open-air, neighbourhood scale programming can be staged.

### **Rain Garden**

Taking advantage of existing low areas within the park, a rain garden will be developed meandering through the centre of the site, acting as a bridge between the west and east activity areas. A deck will provide visitors with an opportunity to overlook the wetland on its west edge.

### **Pedestrian pathways and bicycle paths**

A strong north-south pathway will connect to the Greenways to the north and south of the site and will be defined by paving. Another pathway, sinuous in shape, will wind its way through plantings designed to create habitat for wildlife. All pathways will be universally accessible.

### **Children's Play Area**

The playground will be situated in the northwest corner of the park; its openness to the street frontage will maximize accessibility and visibility. Equipment ranging from traditional to freer, more natural and informal in character, will be selected or constructed to create an interesting and fun play environment. The play area's location will take advantage of the proximity to the washrooms and water fountain in the nearby ADEU Energy Centre building.

### **Half-Court Basketball**

A basketball court will be located adjacent to the playground. The court playing area will be 15.2 metres by 22.9 metres, ideal for four-on-four play. It could also be used for other activities.

**Table Tennis**

Fixed table tennis tables will be placed west of the Energy Centre building.

**Fenced Off Leash Dog Area**

This fenced area, east of the Energy Centre building, will provide space for dog owners to exercise and socialize their dogs off leash. Suitable furnishings (e.g., benches, water fountain) will be provided.

**Pollinator Pasture and other Ecological Features**

Landscape mounds and meadows will be incorporated throughout the site with a variety of trees, shrubs, and pollinator plant species to provide shade and beauty, increase biodiversity, and enhance habitat creation for wildlife. These will stand in contrast to the formally maintained open lawn areas. Plantings to create natural hunting grounds for raptors and barn owls will be installed. Nesting boxes for barn owls have already been attached to the south face of the ADEU Energy Centre building; barn owl visits have already been recorded.

The Park Master Plan will be implemented in phases. The capital requests which have already been approved will be used to complete the first phase in 2018. A capital request will be submitted in 2019 to complete the park development.

**Selection Process for Artists and Artworks**

On April 11, 2017, an artist call was issued to select and contract an artist or artist team as part of the West Cambie Neighbourhood Park planning process. A deadline of May 4, 2017, was set, only professional artists residing in Canada were eligible.

Twenty-five submissions by artists from across Canada were received during the first stage of the process. On May 10, 2017, following the Public Art Program's Administrative Procedures for artist selection for civic public art projects, a five-member selection panel reviewed the submissions.

Members of the selection panel included:

- Clarence Sihoe, retired City of Richmond Parks Planner;
- Mia Weinberg, Artist;
- Shannon Fitzpatrick, Teacher, Richmond resident;
- Grant Brumpton, Landscape Architect, Design Team; and
- Kathleen Gallagher, Artist, Richmond resident.

City staff attended the selection panel meeting to provide project background for the selection panel and to address technical questions.

In reviewing the submissions, the selection panel considered how the proposals responded to the theme identified in the artist call, *Connectivity: Ecology, Infrastructure and History*, and the potential for the artist to create a compelling work of art, as evidenced in the samples of past

projects provided by the applicants. Following discussion and deliberations, the panel shortlisted five artists/artist teams to develop their initial approach to the project, and present a concept proposal in an interview with the selection panel.

The shortlisted artists were:

- Simon Frank, Hamilton;
- Polymétis, Toronto;
- David Jacob Harder, Wells;
- Illarion Gallant, Victoria; and
- Glen Andersen, Carmen Rosen, Marina Szijarto, Richmond.

The artists attended site orientations at West Cambie Neighbourhood Park with staff and the design consultant team on May 25, 2017, and June 6, 2017.

On June 6, 2017, the selection panel met to interview the five shortlisted artist teams. Following lengthy and thoughtful deliberation, the panel recommended the artist team Polymétis, comprised of Michaela MacLeod and Nicholas Croft for the concept design commission. The panel praised the team for their creativity and sensitivity to environmental concerns.

Further information about the artists and examples of the artists' previous public art projects are contained in Attachment 2.

### Public Art Public Consultation

As part of the public consultation phase for the park concept, the public was invited to provide feedback on the public art through the Open House process and the questionnaires on the Let's Talk Richmond website. The public was presented with examples of public art and asked for feedback and preferences on:

- integration of public art with nature;
- functional and recreational uses for public art; and
- materials to include (earth, stone, wood, composite).

In Phase Two, as a result of the feedback from the Phase One consultation process, two concept options were prepared for evaluation. Comments received at the Open Houses and via the Let's Talk website were considered to help develop the final public art concept. Feedback from the public supported the direction for an open and airy structure incorporating a wood structure and providing a place for the public to enjoy as well as attracting pollinators and birds.

### Recommended Public Art Concept Proposal

Created by Nicholas Croft and Michaela MacLeod of Polymétis, working in consultation with the landscape design team, *Pergola Garden* has been integrated within the proposed final park concept plan. The functional artwork is based on the theme of "Connectivity, Ecology,



Infrastructure, and History,” and is consistent with West Cambie Area Plan’s vision for this neighbourhood as a “complete and balanced community.”

The wood lattice structure provides a sheltering or gathering space for a variety of public uses. Storm water management is a major feature of the artwork, which will tie into the adjacent rain garden.

The artists describe the artwork as follows:

*Inspired by its landscape setting, Pergola Garden provides shelter for park visitors enjoying picnics, taking part in exercises, or watching a performance. Its expressive and expansive roof captures rainwater and ties it closely with the site’s storm water management system. This connection will enable it to assist in recharging the park’s ephemeral water feature.*

Further information about the proposed artwork is contained in Attachment 2.

A technical review and coordination phase with the landscape architect-led design team will be included with the design development phase of the artwork. The artist, City staff, and design consultants will continue to meet to review construction coordination and implementation budgets.

#### Alexandra District Energy Utility

A critical consideration while developing the Master Plan for the park was incorporating within the design the Alexandra District Energy Utility Energy Centre building and its existing and future geothermal exchange fields (Attachment 3):

#### **Energy Centre building**

The building footprint is approximately 1,000 m<sup>2</sup>, and is situated along the site’s Odlin Road frontage. Completed in 2016, it contains public washrooms, public open space under the large overhang for public to practice Tai Chi, yoga, have a picnic etc., as well as its own public art feature.

#### **Existing Geothermal Exchange field**

Geo-exchange wells have been installed in the east section of the park, approximately 6,500 m<sup>2</sup> (1.6 acres) in area.

#### **Future Geothermal Exchange field**

Development of a further geothermal exchange field in West Cambie Neighbourhood Park is planned on the south-west side of the park. It is proposed to be up to 6,400 m<sup>2</sup> (1.5 acres) in size and is anticipated to be built in 2020. Development of the park over the area designated for geothermal field expansion will be interim in nature; lawn, pathways, and features which can be easily restored once the engineering work is completed.

## Financial Impact

There is no financial impact for the West Cambie Neighbourhood Park Master Plan as a result of this report. Phase One works will be funded by existing capital accounts. Subsequent phases will be the subject of a capital request for 2019.

The project budget for *Pergola Garden*, the West Cambie Neighbourhood Park integrated landscape concept proposal, is estimated to be in the range of \$600,000 to \$750,000. The City is currently in receipt of Letters of Credit from Polygon Homes for public art projects in the Alexandra Neighbourhood which can support a total artwork budget of approximately \$725,000.

The Letters of Credit will be drawn against and the corresponding funds will be deposited into the Public Art Reserve, which will then finance the proposed West Cambie Neighbourhood Park Public Art capital project for \$725,000.

The Polygon Development Ltd. Letters of Credit are summarized as follows:

Application File	Address	Project Name	Contribution Date	Uncommitted Funds (LC)
RZ 10-537689 DP 10-551711	9399 Odlin Rd	Mayfair Place	January 25, 2011	\$210,040
RZ 06-344033	9288 Odlin	Meridian Gate	June 25, 2007	\$169,392
RZ 12-598503 DP 13-631492	9311 Alexandra Rd	Alexandra Court	August 8, 2013	\$390,506
RZ 06 354959 DP 07 359314	9800 Odlin	Hennessy Green	June 25, 2007	\$83,220
Total Contribution				\$853,158
Administration Fee 15%				\$127,974
<b>Artwork Budget</b>				<b>\$725,184</b>

Any maintenance or repairs required for the public art project will be the responsibility of the Public Art Program. A portion of the developer's public art contribution will be established as a maintenance reserve for this project; City funds will be allocated out of the Public Art Program's annual operating budget for future maintenance of this project.

## Conclusion

West Cambie Neighbourhood Park will play an important role in providing year round recreational and leisure opportunities for residents of the area. It will function as a quiet neighbourhood green space, and as a place for people to gather, socialize, and entertain within an active setting. The site will also take on increased significance for Richmond's Ecological Network. The recommended West Cambie Neighbourhood Park Concept Plan is the result of a comprehensive public engagement process. Approval of the plan will advance the project to the detailed design and construction documentation phase.



Jamie Esko  
Manager, Parks Planning, Design  
and Construction  
(604-233-3341)

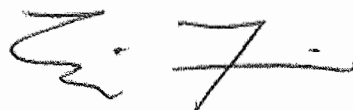

Eric Fiss, Architect AIBC, MCIP, LEED AP  
Public Art Planner  
(604-247-4612)

- Att. 1: West Cambie Neighbourhood Park Master Plan and Public Process  
2: *Pergola Garden* Public Art Concept Proposal  
3: ADEU Geoexchange Field Expansion

# ATTACHMENT 1

## WEST CAMBIE NEIGHBOURHOOD PARK MASTER PLAN AND PUBLIC PROCESS



# SITE ANALYSIS

West Cambie Neighbourhood Park will primarily serve residents of the Alexandra Neighbourhood and is a link in the greenway network between Garden City Lands to the South and Cambie Road to the North. The park plays a significant role in providing valuable habitat, and foraging for a variety of wildlife species.

The park incorporates a number of unique features including: a variety of existing trees, seasonal flooding that creates a wetland, geotexchange field installed below the east lawn, the ADEU Energy Centre, and a proposed geotexchange field in the South West corner.

## VEGETATION



## WETLAND



## SURROUNDING GREEN SPACES + BIKE NETWORK



TOMSETT  
ELEMENTARY

WEST CAMBIE  
NEIGHBOURHOOD  
PARK

GARDEN CITY  
LANDS

## GEOEXCHANGE FIELD

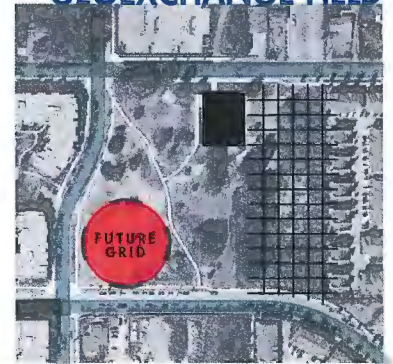

## CIRCULATION





# WHAT WE HEARD PUBLIC OPEN HOUSE #1

My preference for the design of wetland:

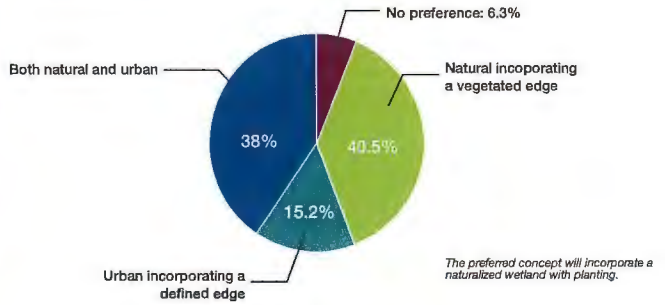

I would like the wetland to include the following TWO features:  
(Chart represents number of responses per category)

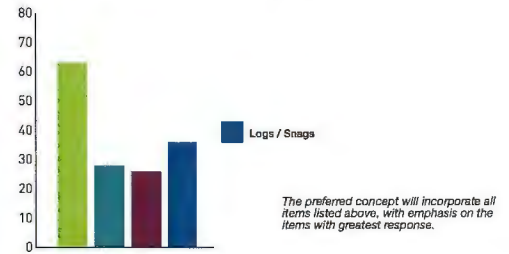

## What we have heard so far?

During the last open house, members of the public were asked to provide feedback about potential options for the site. A total of 80 respondents completed the survey. Below is a summary of the input received to date.

## Design Guidelines

Based on the outcomes of the survey the following guidelines were developed to inform the design of the park and facilities:

### 1. Neighbourhood Destination

- create a sense of place
- provide a diversity of uses for a broad range of age groups
- offer a well-rounded play experience that is nature inspired

### 2. Ecological / Environmental

- respond to the park's unique hydrological pattern
- celebrate and preserve significant trees located within the park
- demonstrate the park's environmental values
- provide natural habitat for animals and insects

### 3. Place of Connection

- create a place for people to gather, interact with others and reconnect with nature
- provide connection with existing and planned greenways and bicycle paths
- integrate with surrounding green spaces and natural areas

I would like the existing trees:

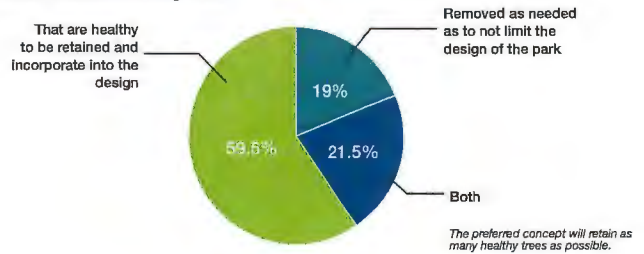

I would like the open lawn area to include:  
(Chart represents categories ranked by importance)

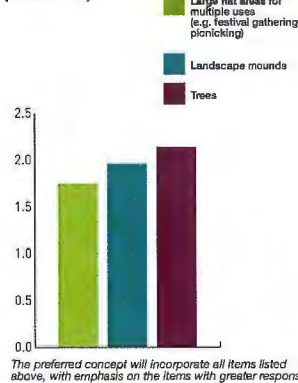

I would like the gathering area to include:  
(Chart represents categories ranked by importance)

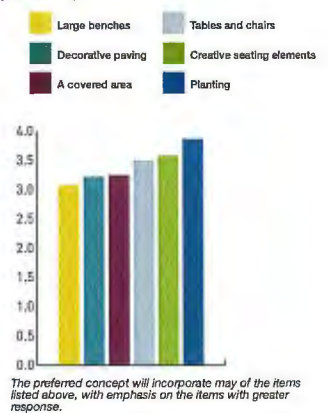

A specialized workout playground or area, shaded by a wooden trellis

Would like to see ducks come to play at the pond. I have seen them coming for few users

We have a young family – all/anything things play would be great. For all ages (not just have equipment for older or

To build a permanent Butterflyway pollinates friendly gardens that could be maintained by volunteers. Butterflyway rangers in Richmond





# SCHEMATIC DESIGN OPTION #1

The layout for Option 1 maintains a natural expression with refined edges. The site will be raised to provide universal access from the sidewalk and create a seasonal wetland. The wetland provides focal point in the southern half of the park and is framed by circulation. A strong north south pathway will connect to the greenways to the north and south of the site and will be defined by special paving. The children's play area and table tennis are located along the angled path to the north east. The fenced off leash dog area is located to the east the of ADEU Energy Centre and will be enhanced with landscape mounds and planting. The 4 on4 basketball court is located to the West of the ADEU Energy Centre, adjacent to the North South pathway. Landscape mounds will be incorporated throughout the site with a variety of trees and pollinator plant species.



## LEGEND

- |                     |                                   |  |  |  |
|---------------------|-----------------------------------|--|--|--|
| 1 4 on 4 Basketball | 4 Meadow                          | 7 Fenced Off Leash Dog Area                      | 10 Open-Lawn and Future Geoechange field | 15 Entrance to Park, Coordinated with Greenway Path to the South |
| 2 Table Tennis      | 5 Children's Play Area, Multi-age | 8 Water Fountain                                 | 11 Seasonal Wetland                      |  |
| 3 Gathering Area    | 6 Existing Trees To Be Retained   | 9 Rain Garden Directing Surface Water to Wetland | 12 Entrance with Feature Wall / Bench    |  |

# SCHEMATIC DESIGN OPTION #1

## PROGRAM

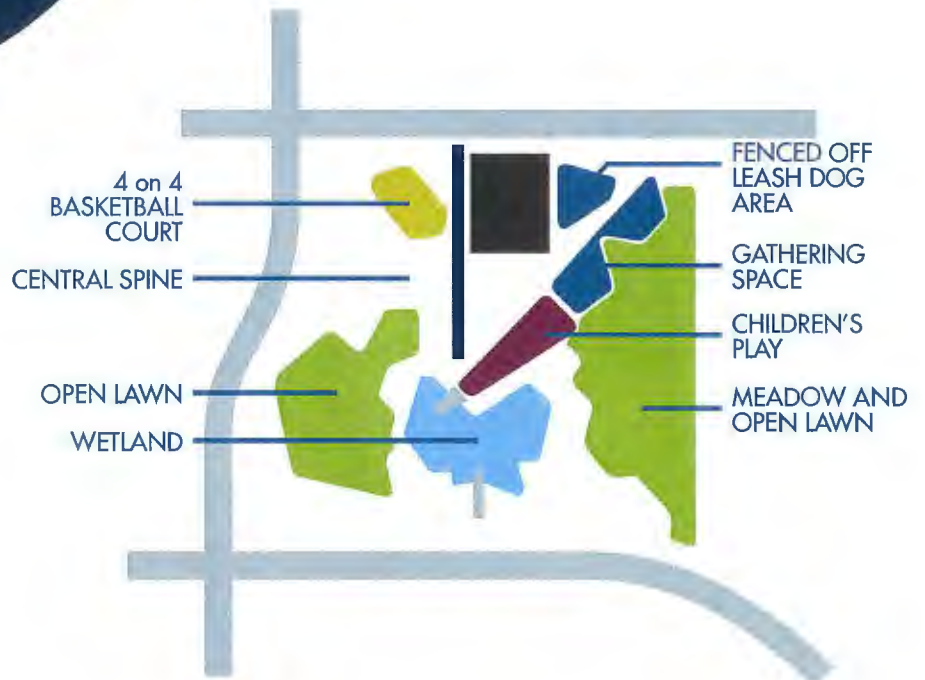

## CIRCULATION

### LEGEND

-  PRIMARY CIRCULATION  
(excludes sidewalks around perimeter of site)
-  SECONDARY CIRCULATION

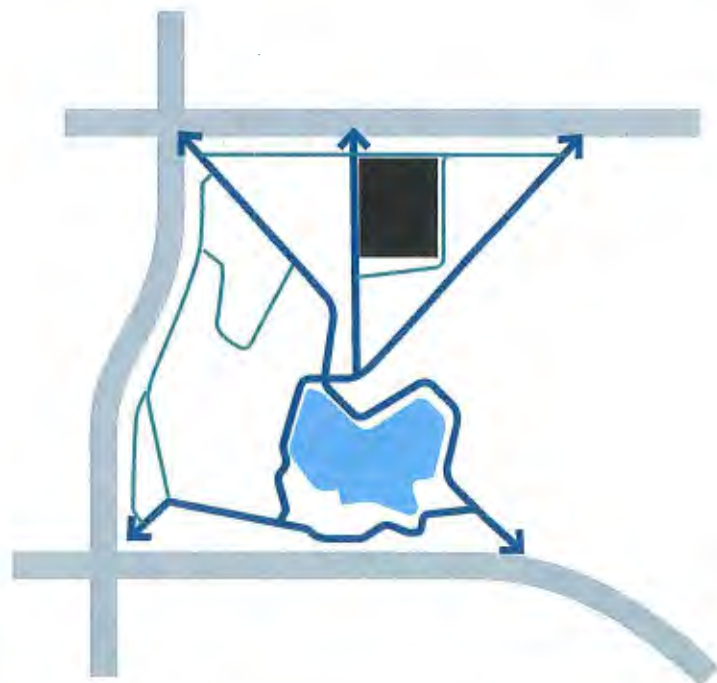



# SCHEMATIC DESIGN OPTION #2

Option 2 maintains a natural expression along the East of the site that transitions to a formal raised amphitheatre at the West. The site will be raised to provide universal access from the sidewalk and create a seasonal wetland. The wetland meanders through the centre of the site and acts a visual bridge between the west and east activity areas. A strong north south pathway connects to the north and south greenways and will be defined by special paving. The children's play area, table tennis, and 4on 4 basketball court are located along the west of the ADEU Energy Centre. The fenced off leash dog area is located to the east of the of ADEU Energy Centre and will be enhanced with landscape mounds and planting, a variety of trees and pollinator plant species.



## LEGEND

- |                                   |                     |                                    |  |
|-----------------------------------|---------------------|------------------------------------|--|
| 1 Fenced Off Leash Dog Area       | 4 Water Fountain    | 7 Existing Trees To Be Retained    | 10 Open-Lawn and Future Geoechange Field                         |
| 2 Meadow                          | 5 4 on 4 Basketball | 8 Seasonal Wetland                 | 11 Lawn Amphitheatre   |
| 3 Children's Play Area, Multi-age | 6 Gathering Area    | 9 Bridge with Lookout Over Wetland | 12 Entrance to Park, Coordinated with Greenway Path to the South |

# SCHEMATIC DESIGN OPTION #2

## PROGRAM

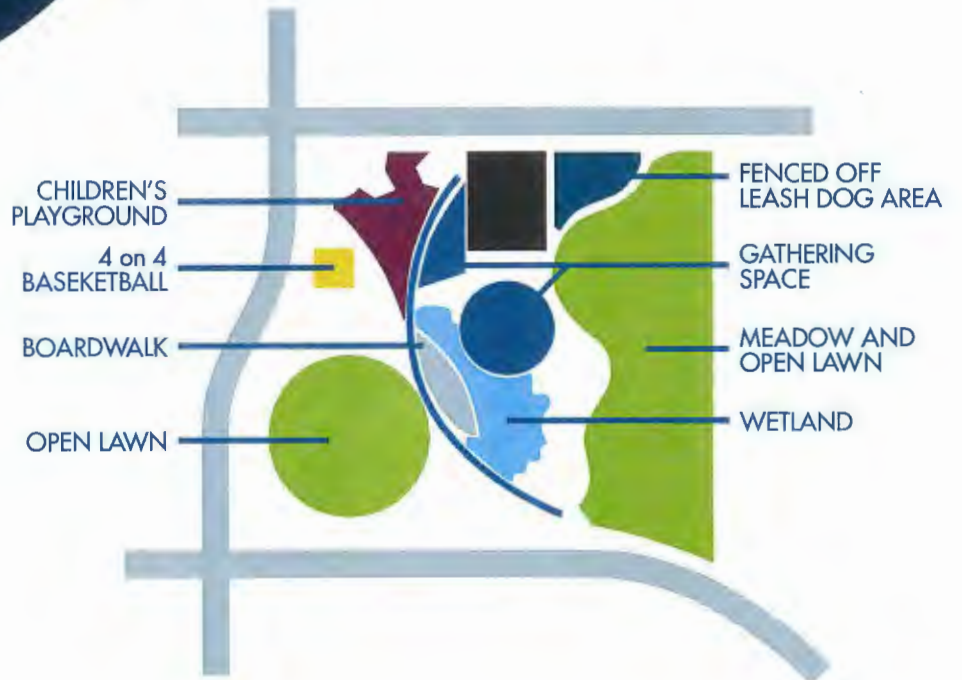

## CIRCULATION

### LEGEND

-  PRIMARY CIRCULATION  
(excludes sidewalks around perimeter of site)
-  SECONDARY CIRCULATION

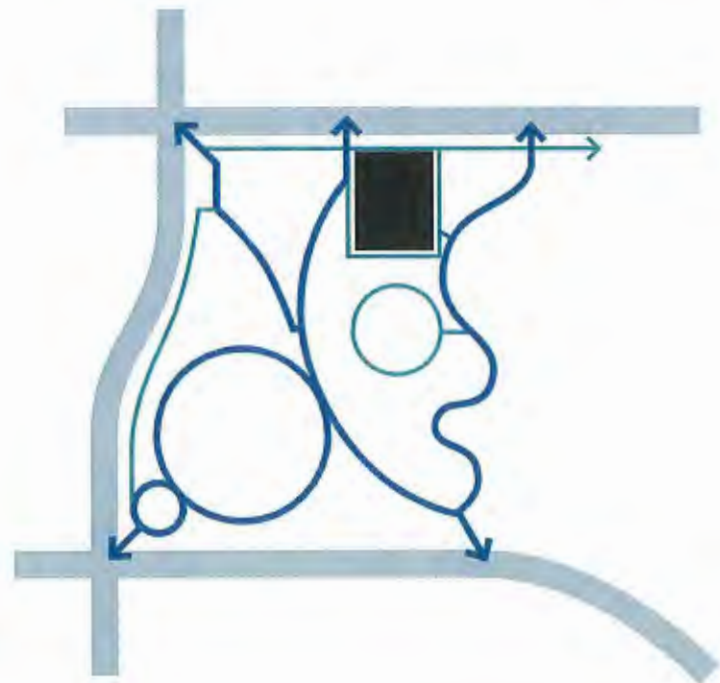



# WHAT WE HEARD PUBLIC OPEN HOUSE #2

I would like the gathering area to include:  
(Chart represents categories ranked by importance)

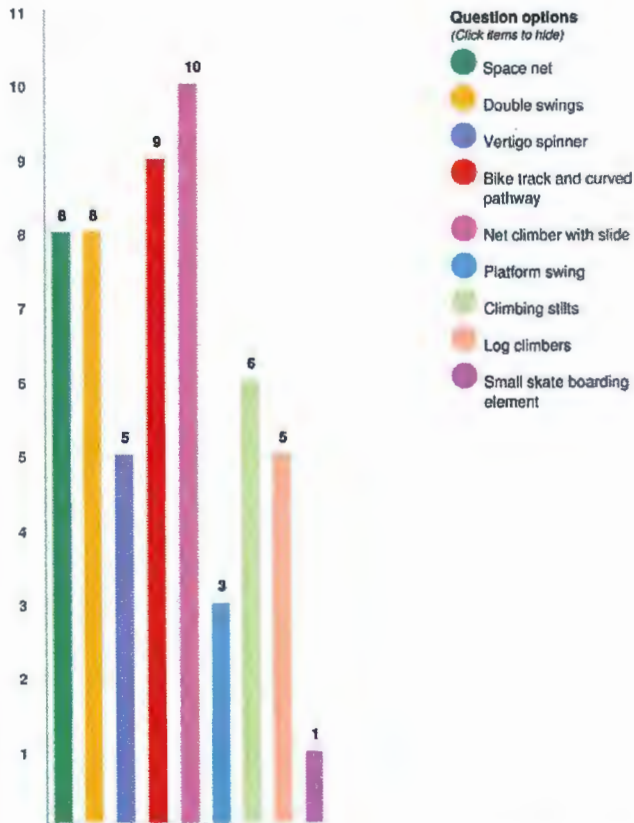

I prefer the location of the wetland in:

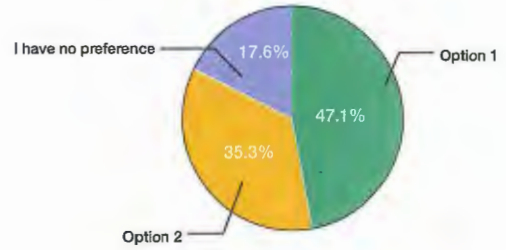

I prefer to the location of the children's play area in:

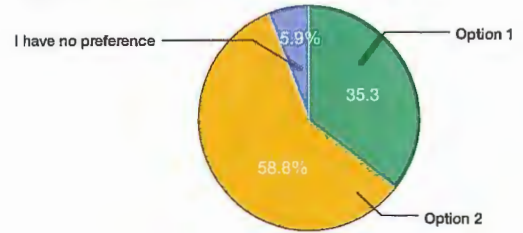

I prefer to the location of the gathering area in:

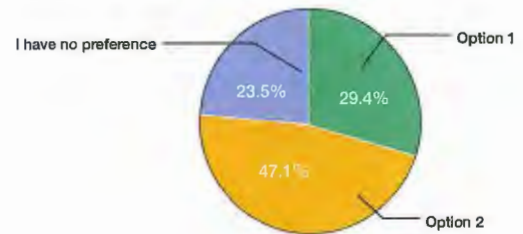

I prefer to the location of the basketball court in:

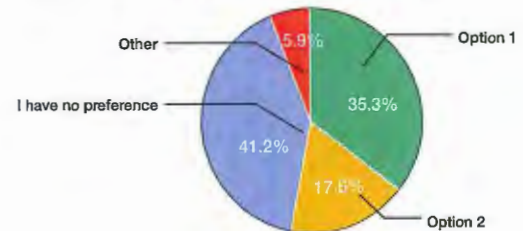

The gathering area is also separated from the basketball court and children's playground

Option 1 has a larger meadow for informal park use

Option 2 the Children's play area is nearer to the apartments and streets which means its more 'eyes on' and safer for freer play

Option 2 has larger meadow areas which provides better habitat for pollinators and other wildlife. Formal grass should be located to the West only.



# MASTER PLAN

The Master Plan for West Cambie Neighbourhood Park encompasses the programming layout and blend of natural and formal elements presented in the publicly preferred option from the second open house.

The park design incorporates areas that will be raised to meet the surrounding sidewalk for accessibility, with some areas remaining at the existing grade to protect existing trees and to help with the creation of the rain garden. The rain garden meanders through the centre of the site and acts a visual bridge between the west and east activity areas. A strong north south pathway connects to the neighbouring greenways and will be defined through paving. Additional circulation pathways have been provided throughout the park to connect programming elements.

The park also includes a children's play area, table tennis, and a basketball court, all located to the west of the ADEU Energy Centre. A fenced off leash dog area and large wild flower meadow is located to the east of the of ADEU Energy Centre and will be enhanced with landscape mounds and planting, a variety of trees and pollinator plant species.

A public art element will also be located within the Park. It will be located within the gathering area just south the ADEU Energy Centre.



## LEGEND

- |                                   |                     |                                    |  |  |
|-----------------------------------|---------------------|------------------------------------|--|--|
| 1 Fenced Off Leash Dog Area       | 4 Drinking Fountain | 7 Existing Trees To Be Retained    | 10 Open-Lawn and Future Geoechange Field                         | 13 Planting beds with Pollinator species |
| 2 Wildflower Meadow               | 5 4 on 4 Basketball | 8 Seasonal Rain Garden             | 11 Lawn Amphitheatre   | 14 Crushed Gravel Pathway                |
| 3 Children's Play Area, Multi-age | 6 Gathering Area    | 9 Bridge with Lookout Over Wetland | 12 Entrance to Park, Coordinated with Greenway Path to the South | 15 Hardsurface Pathway                   |
|                                   |                     |                                    |  | 16 Public Art Location                   |



# PARK CHARACTER

## ELEMENTS & FEATURES



NET CLIMBER WITH METAL SLIDE



DOUBLE SWING



CLIMBING STUFS



LOG CLIMBERS



MEADOW



SQUARE TIMBER LOG BENCHES



TABLE TENNIS



SMALL SKATE / BICYCLE PARK ELEMENT



BOARDWALK



INTERPRETIVE PANEL



OPEN LAWN

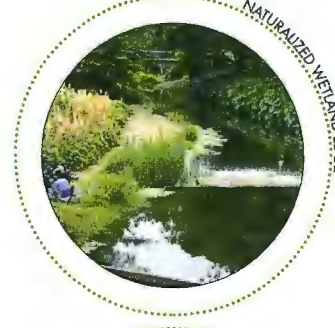

NATURALIZED WETLAND EDGE



LANDSCAPE MOUNDS



TERRACE SEATING

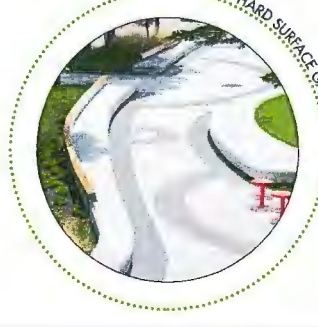

HARD SURFACE GATHERING SPACE

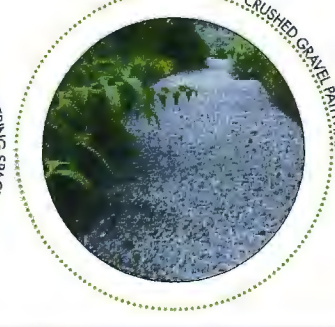

CRUSHED GRAVEL PATHWAY

# ATTACHMENT 2

## PUBLIC ART

POLYMÉTIS

# PERGOLA GARDEN

A PUBLIC ART PROPOSAL FOR  
WEST CAMBIE PARK IN RICHMOND, B.C.

SUBMITTED FEBRUARY 5, 2018  
**CNCL - 364**



PERGOLA GARDEN





PERGOLA GARDEN

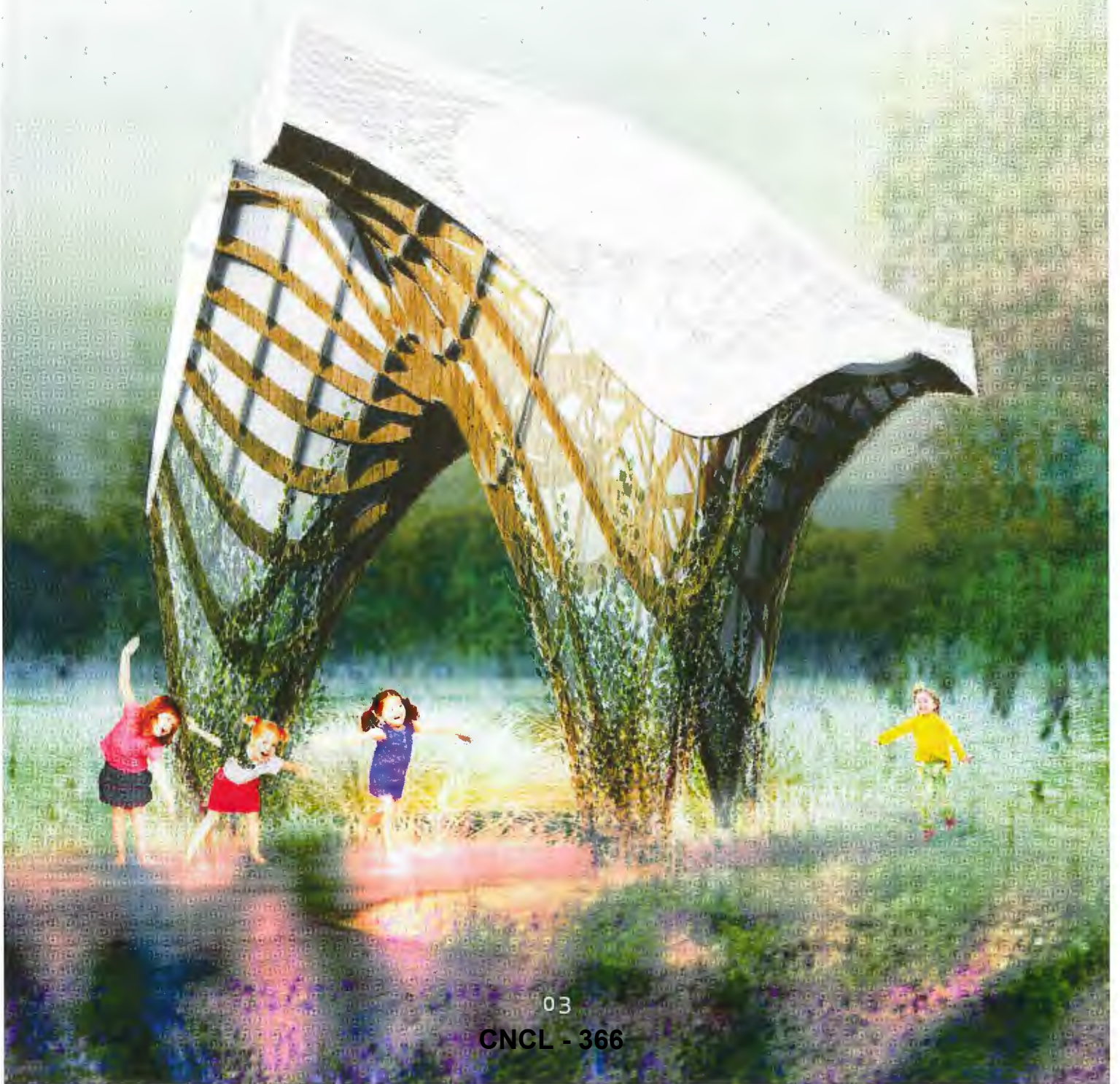





PERGOLA GARDEN DRAWS ITS MAIN INSPIRATION FROM THE NATURAL LANDSCAPE OF THE FRASER VALLEY, AND MORE SPECIFICALLY, THE FRASER RIVER'S HIGHLY SEDIMENTED TIDAL FLOW--A FORCE THAT CONTINUALLY RESHAPES THE RIVER BASIN IN A PERSISTENT PROCESS OF DEPOSIT AND EROSION. THE INTENT OF THE ARTWORK IS TWO-FOLD: FIRST, TO CREATE A SCULPTURE THAT DEFINES A SPACE CAPABLE OF ANIMATING THE PARK, THAT ACTS AS A CATALYST FOR SPONTANEOUS SOCIAL EXCHANGE BETWEEN PARK USERS AND SERVES AS AN IDENTIFYING LANDMARK WITHIN THE PARK AND THE SURROUNDING NEIGHBORHOOD; AND, SECOND, TO INTEGRATE THE PIECE INTO THE LARGER NATURAL AND CULTURAL SYSTEMS OF THE NEW WEST CAMBIE NEIGHBORHOOD PARK AND ITS ENVIRONS.

## CONCEPT - EROSION

OVERALL, THE FORM OF PERGOLA GARDEN EVOKES THE IMPRESSION OF A LANDFORM BEING SMOOTHED BY THE CURRENTS OF A RIVER. THE ARTWORK'S SINUOUS FORM IS CREATED THROUGH A PROCESS OF MATERIAL ADDITION AND SUBTRACTION, MIMICKING THE GEOLOGICAL PROCESSES THAT CREATED THE LANDSCAPE OF THE AREA. IN THE PROCESS OF SUBTRACTION, THE WORK IS PUNCTURED VERTICALLY BY AN ARTICULATED SERIES OF THREE HOLES. THESE VOIDS CREATE OCULI IN THE CANOPY, ALLOWING THE SUN TO PENETRATE INTO THE SPACE BELOW, CREATING PLAYFUL SHADOWS AND CHANGING SPATIAL EXPERIENCES THROUGHOUT THE DAY. CARVED ARCHWAYS CREATE THRESHOLDS AND OPEN PASSAGES FOR GATHERING AND EXPLORATION BELOW. THE FORM IS TRANSLATED INTO A RIBBED WOOD STRUCTURE, FOR LIGHTWEIGHT AND SUSTAINABLE CONSTRUCTION. AS A PROCESS OF ADDITION, VEGETATION, PLANTED AROUND THE BASE OF THE STRUCTURE'S LEGS, GROWS HEARTILY OVER TIME ALONG THE SKELETAL RIBS OF THE UNDERSIDE OF THE WORK. CLIMBING PLANTS TELL A STORY AS THEY SOFTEN THE HARDNESS OF THE SCULPTURE AND MAKE IT AN EXTENSION OF THE LANDSCAPE AROUND.

CONCEPT - EROSION

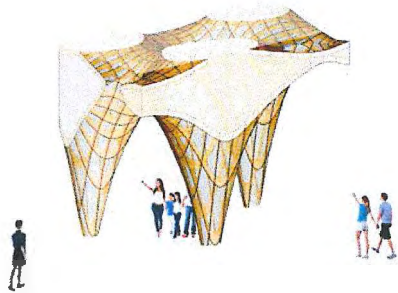
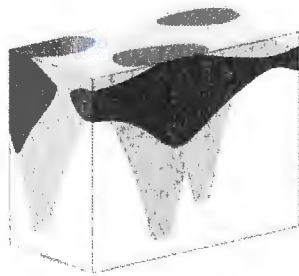
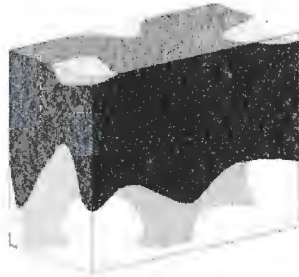

## DIMENSIONS

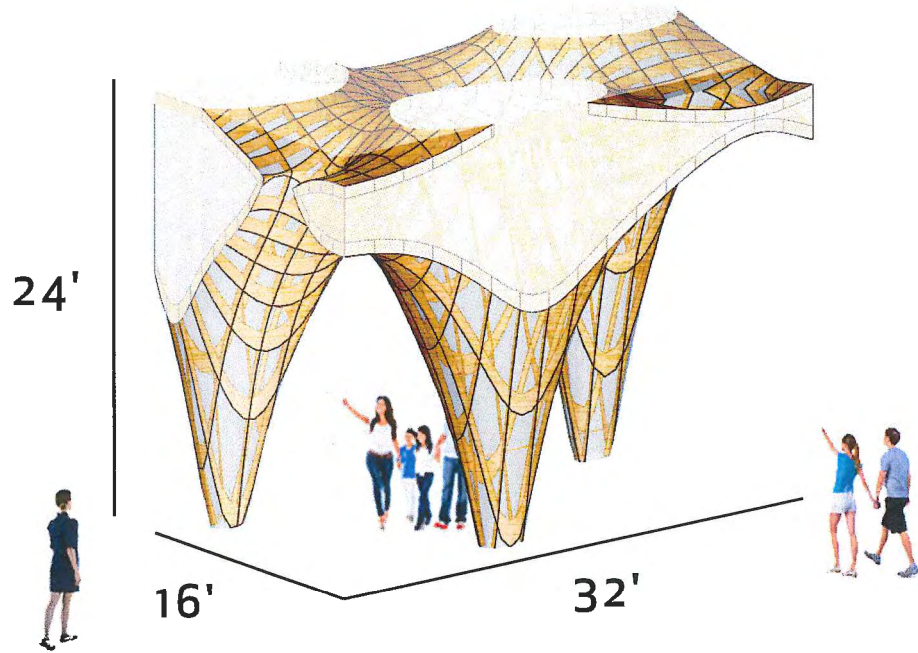



## FUNCTION - SHADED CANOPY

A MULTIFUNCTIONAL PIECE, THE SCULPTURE PROVIDES A SHADED CANOPY FOR EXERCISE, PICNICS, AND LOUNGING, AND WOULD BECOME THE DISTINCT MEETING PLACE IN THE PARK.

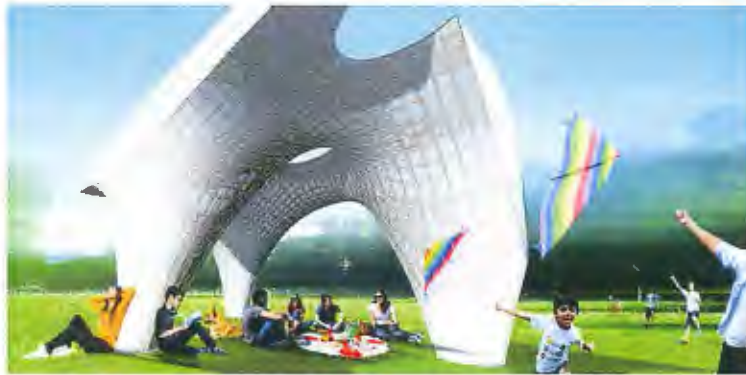

## FUNCTION - RAINWATER COLLECTION

THE ARTWORK'S FORM SERVES TO CAPTURE RAINWATER AND CHANNEL IT DOWNWARD TO ESTUARY RECHARGING SYSTEMS VIA THE RAIN GARDEN BELOW, CONNECTING IT TO THE LARGER ECOLOGY OF THE PARK.

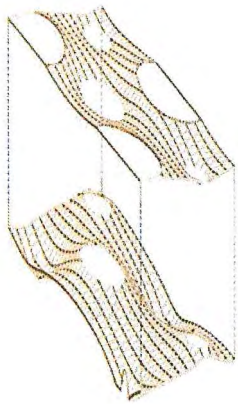

WOOD STRUCTURE

+

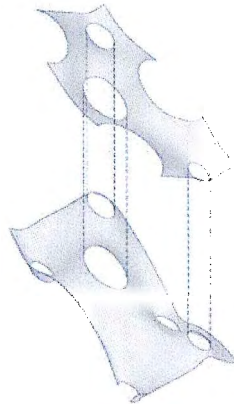

MEMBRANE

=

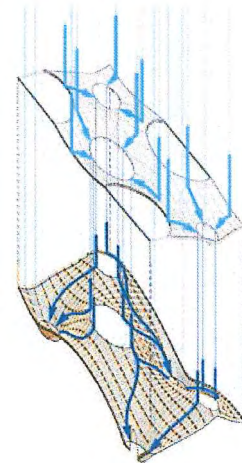

WATER COLLECTION

LOCATED AT THE HEART OF THE PARK

PROPOSED LOCATION



CNCL - 373



## SUSTAINABLE & DURABLE

THE SITE-RESPONSIVE INTEGRATED WORK IS BUILT WITH ENVIRONMENTALLY LOW-IMPACT MATERIALS, PRINCIPALLY CNC-MILLED LAMINATED VENEER LUMBER AND VEGETATION IN COMBINATION WITH A PARTIAL COVERING OF SYNTHETIC MEMBRANE FOR ENVIRONMENTAL CONTROL AND WATER COLLECTION.

THE PROJECT HAS BEEN EVALUATED BY A STRUCTURAL ENGINEER AND DEEMED TO BE STRUCTURALLY SOUND IN ITS FORMATION. THE PROPOSED WOOD MATERIAL IS LVL (LAMINATED VENEER LUMBER), AN ENGINEERED WOOD PRODUCT THAT USES MULTIPLE LAYERS OF THIN WOOD ASSEMBLED WITH STRUCTURAL ADHESIVES. THE MATERIAL WOULD BE SUSTAINABLY SOURCED AND DIGITALLY FABRICATED FOR PRECISION. A LAYER OF WEATHERPROOF COATING FOR DURABILITY AND INCREASED LIFETIME WOULD BE ADDED TO ALL WOOD MEMBERS.

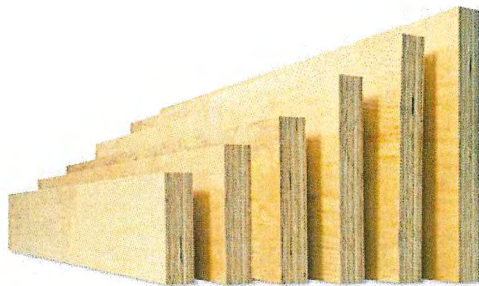

## PLANT GROWTH OVER TIME

FINAL SELECTION OF THE VINES HAS NOT BEEN MADE. THE VINES MUST BE TESTED ON-SITE BEFORE A FINAL SELECTION; HOWEVER, AT THIS TIME, WE ARE PROPOSING TO USE EITHER MOONLIGHT CHINESE HYDRANGEA VINE OR WHITE JAPANESE WISTERIA. MOONLIGHT CHINESE HYDRANGEA IS A SELF-CLINGING VINE WITH LARGE WHITE HYDRANGEA-LIKE BLOOMS, THAT INCREASE IN ABUNDANCE OVER TIME. THE GREEN HEART-SHAPED LEAVES TURN YELLOW IN THE FALL. THE BARE WOODY TWINING STEMS WILL PROVIDE INTEREST IN THE WINTER LANDSCAPE. WHITE JAPANESE WISTERIA IS A TWINING, WOODY VINE KNOWN FOR ITS HUGE GRAPE-LIKE CLUSTERS OF VERY FRAGRANT WHITE FLOWERS. BOTH VINES WERE CHOSEN FOR THEIR VISUAL INTEREST, ENVIRONMENTAL SUITABILITY, AND LOW MAINTENANCE QUALITIES.



# PLANT GROWTH OVER TIME

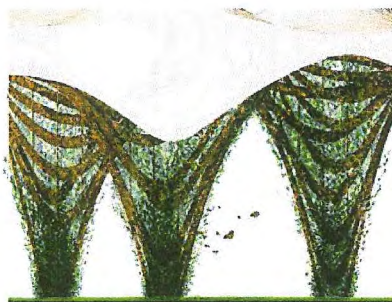
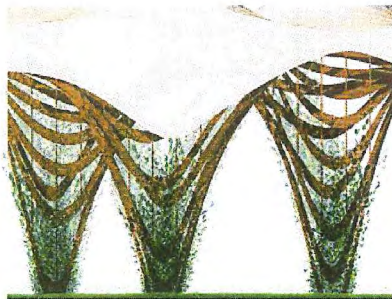
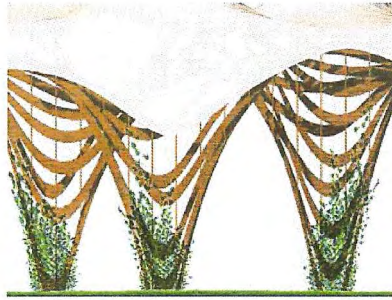

## BUDGET

AN INITIAL BUDGET FOR ENGINEERING, MATERIALS, FABRICATION AND INSTALL OF THE ARTWORK AND FOUNDATION HAS BEEN DETERMINED TO BE IN THE RANGE OF \$600,000 - \$750,000.

PRELIMINARY STRUCTURAL ENGINEERING HAS BEEN COMPLETED AND STRATEGIES HAVE BEEN IDENTIFIED TO BALANCE OVERALL SCALE WITH THE SPACING OF STRUCTURAL MEMBERS, IF AN INCREASE OR DECREASE IN THE ARTWORK'S SIZE, DENSITY, OR SIZE OF WOOD COMPONENTS IS DESIRED.

**ATTACHMENT 3**

**ADEU GEOEXCHANGE FIELD  
EXPANSION**



# ADEU GEO EXCHANGE FIELD EXPANSION



## LEGEND

-  Future Geoexchange Field Expansion  
Area shown 6,400 sqm
-  Existing Geoexchange Field
-  ADEU Building - Existing