

CULLEN CONSTRUCTION LTD

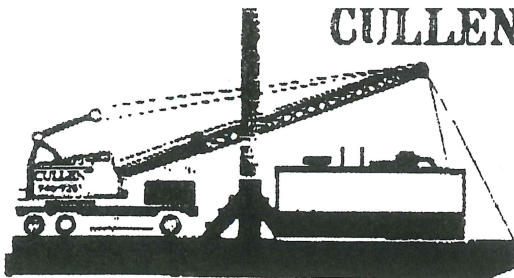

3590, 40th street
Delta, B.C.
V4K 3N2

Schedule 1 to the Minutes of the
Parks, Recreation & Cultural
Services Committee meeting of
Richmond City Council held on
Tuesday, November 28, 2017.

ESTIMATES

July 21, 2001

CONDITION



FAIR CONDITION



13 ft.

8 ft.

Imperial Cannery East Apron:
Repair fender piles and chalks
❖ Install fender logs
2 days @ 1800.00 3600.00

East Finger Pier:

- ❖ Repair or replace 20 fender piles
- ❖ Replace 4 bearing piles
- ❖ Install caps and chalks as required
- ❖ Install float logs
- ❖ Supply cap and chalk timbers

7 days @ 1800.00 3000.00
12600.00
15,600.00

Sheet piles

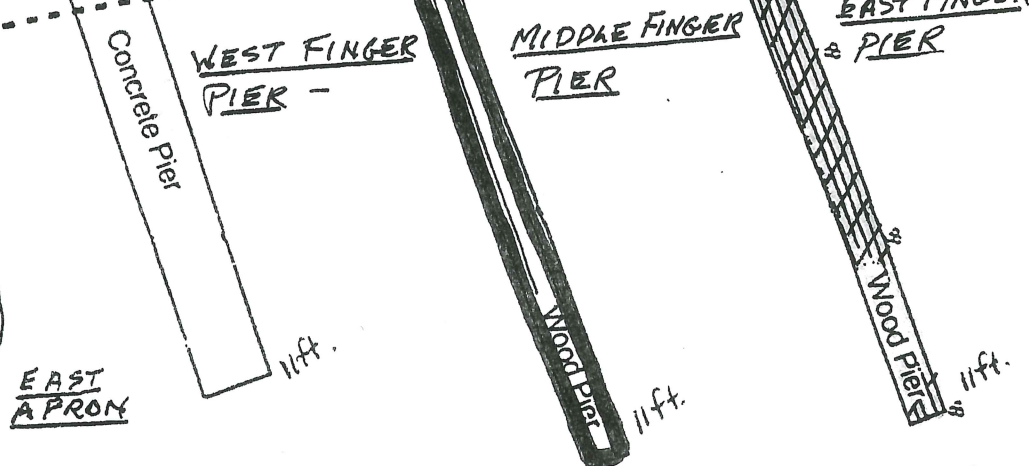
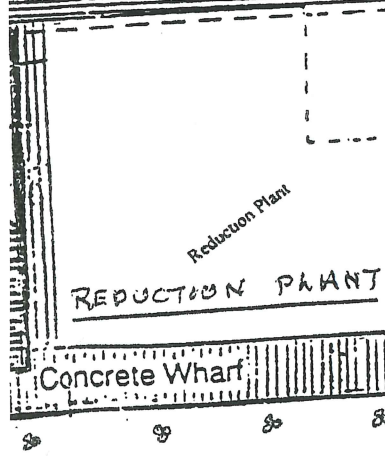

200 ft
les
align wharf face for tie up
14,400.00

Middle Finger Pier:
❖ Repair or replace 11 fender piles
❖ Replace bad chalk timbers
❖ Install caps as required
❖ Install float logs
❖ Supply cap and chalk timbers

1200.00
7200.00
8,400.00

line length of

uded any cost for the piles required as there are enough piles in
 structures that can be reused to complete the repair work as
 at logs will have to be purchased or donated if all tie ups require
 ve not put in a cost for this item.

er questions, please don't hesitate to call
 cluding Cullen Construction in your proposal.

Cullen
 Construction
 Ltd.

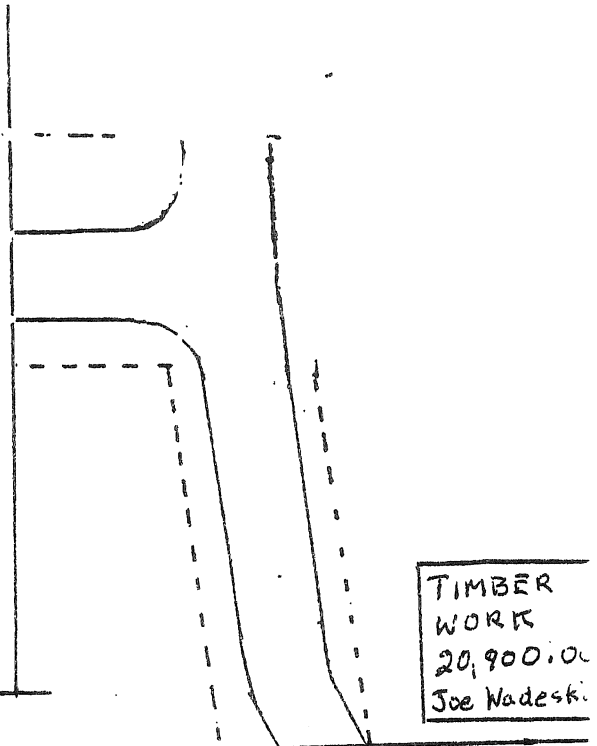

TIMBER
 WORK
 20,900.00
 Joe Wadeski

Gillnet Pier:
 ❖ Repair or replace 11 fender piles
 ❖ Install float logs
 2 days @ 1800.00 3600.00

Gillnet loft:
 ❖ Remove old deck, stringers and caps
 ❖ Repair or replace 12 fender piles
 ❖ Repair or replace bearing piles
 ❖ Install 14 new cap timbers
 ❖ Dispose of old materials
 ❖ Supply new caps timbers and hardware
 8 days @ 1800.00

1200.00
 3600.00
 14400.00
 19,200.00

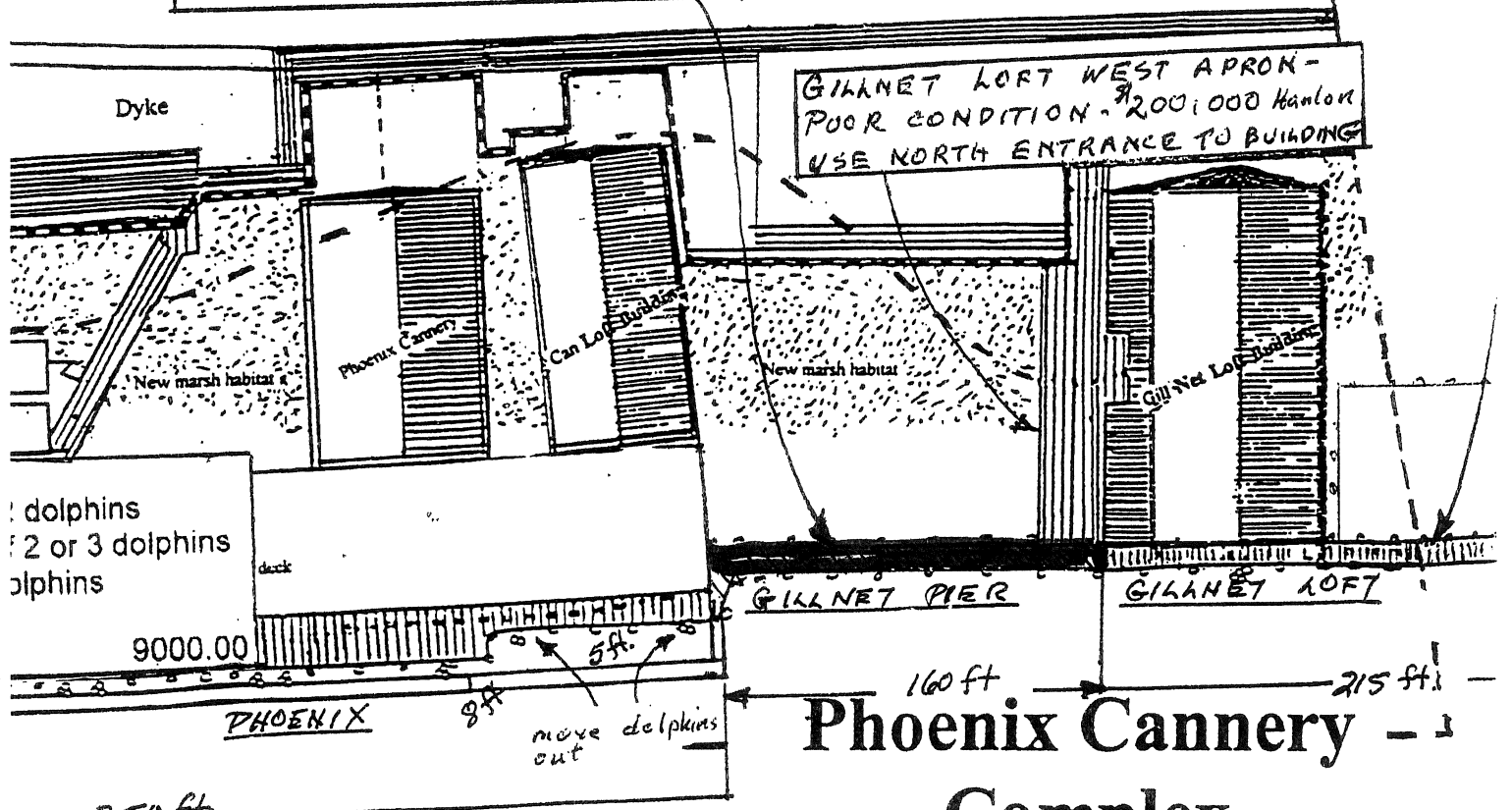

Phoenix Cannery - Complex

① Rebuild Gillnet Pier + piles for 300' Phoenix float.

or
 ② Piles for 300' Phoenix float only

Perspective Sketch - The Net Loft Basin

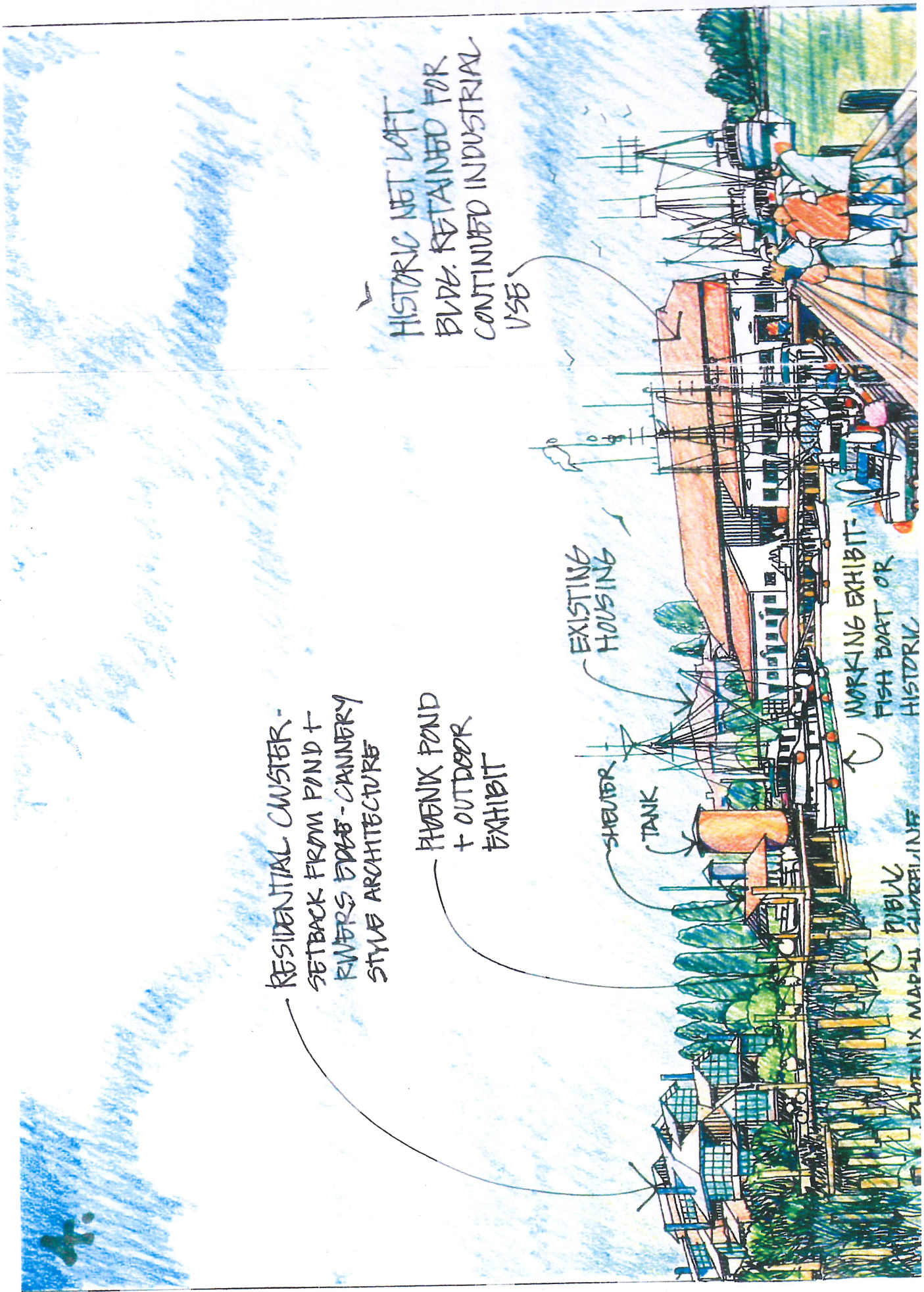

RESIDENTIAL CLUSTER -
SETBACK FROM POND +
RIVERS EDGE - CANNERY
STYLE ARCHITECTURE

PHOENIX POND
+ OUTDOOR
EXHIBIT

EXISTING
HOUSING

HISTORIC NET LOFT
BLDG. RETAINED FOR
CONTINUED INDUSTRIAL
USE

SHEUTER
TANK

WORKING EXHIBIT -
FISH BOAT OR
HISTORIC

PHOENIX MAPLE
CHERRYLINE