



To: General Purposes Committee **Date:** November 8, 2011
From: W. Glenn McLaughlin **File:** 12-8275-05/2011-Vol
 Chief Licence Inspector & Risk Manager 01
Re: **Rokapa Management Ltd., doing business as Well Pub**
6511 Buswell Street
Re-location of Liquor Primary Licence

Staff Recommendation

That Council decline comment on the liquor license amendment application submitted by Rokapa Management Ltd., doing business as Well Pub, to re-locate their liquor primary licenced area within the premises, and that a letter be forwarded to Liquor Control and Licensing Branch with this decision.



W. Glenn McLaughlin
 Chief Licence Inspector & Risk Manager
 (604-276-4136)

FOR ORIGINATING DEPARTMENT USE ONLY					
			CONCURRENCE OF GENERAL MANAGER 		
REVIEWED BY TAG	YES	NO	REVIEWED BY CAO	YES	NO
	<input checked="" type="checkbox"/>	<input type="checkbox"/>		<input checked="" type="checkbox"/>	<input type="checkbox"/>

Staff Report

Origin

The Provincial Liquor Control and Licensing Branch (LCLB) issues licences in accordance with the Liquor Control & Licensing Act and Regulations.

Local Government is given opportunity to provide comments and recommendations to LCLB on certain liquor licence applications and amendments. The process requires that local government provide a Council resolution that either:

- comments on the legislative review criteria (views of residents, potential for noise, traffic, impact on the community) or;
- decline comment on the application.

This report deals with a liquor amendment application from Rokapa Management Ltd. (The Applicant), doing business as Well Pub, seeking a resolution from Council in support of re-locating an existing Liquor Primary Licence area to another area within the same premises.

Analysis

Since September of 2009, Well Pub has been licenced to operate a 25 person capacity Liquor Primary area adjoining the Food Primary area in Legends Pub located at 6511 Buswell St. (Attachment 1).

The Applicant has applied to LCLB to move the liquor primary licence of Well Pub to an area within Legends Pub. (Attachment2) Currently, the Well Wine Bar liquor licence is dormant and will continue to be inactive following the proposed relocation.

The Applicant has cited that by moving the Liquor Primary area into the Legends Pub area it would allow more seating in the Food Primary area which is needed because;

- the food primary room is popular for fundraising events for minor sport and various charities with many children joining their parents for these events
- the food primary room is growing in popularity and by taking out the liquor primary area it will increase the number of families that can patronize the restaurant
- the new drinking and driving regulations have curtailed overall alcohol consumption and subsequently the consumer is gravitating to food primary use.

Staff recommends that Council decline comment on this application for the following reasons:

- the area that Well Pub wishes to re-locate is already licenced as a Liquor Primary establishment
- the views of residents and the general public were gathered in February of 2009 when the Applicant originally sought Council comments for the Liquor Primary licence and the re-location will not directly affect the general public and;

- there is no increase in patron capacity or hours of operation making posting of publications unnecessary.

If the City declines comment on the application, LCLB may require the Applicant to do the assessment before approving any change to the liquor licence.

Financial Impact

None

Conclusion

The liquor license re-location within the existing licenced pub will not impact the general public as there is no increase in capacity or hours of service. Staff recommends that the City decline comment on the Liquor License application and Council's resolution be forwarded to the LCLB in accordance with the legislative requirements.

Joanne Hikida
Supervisor, Business Licence
(604-276-4155)

JMH:jmh

ATTACHMENT 1

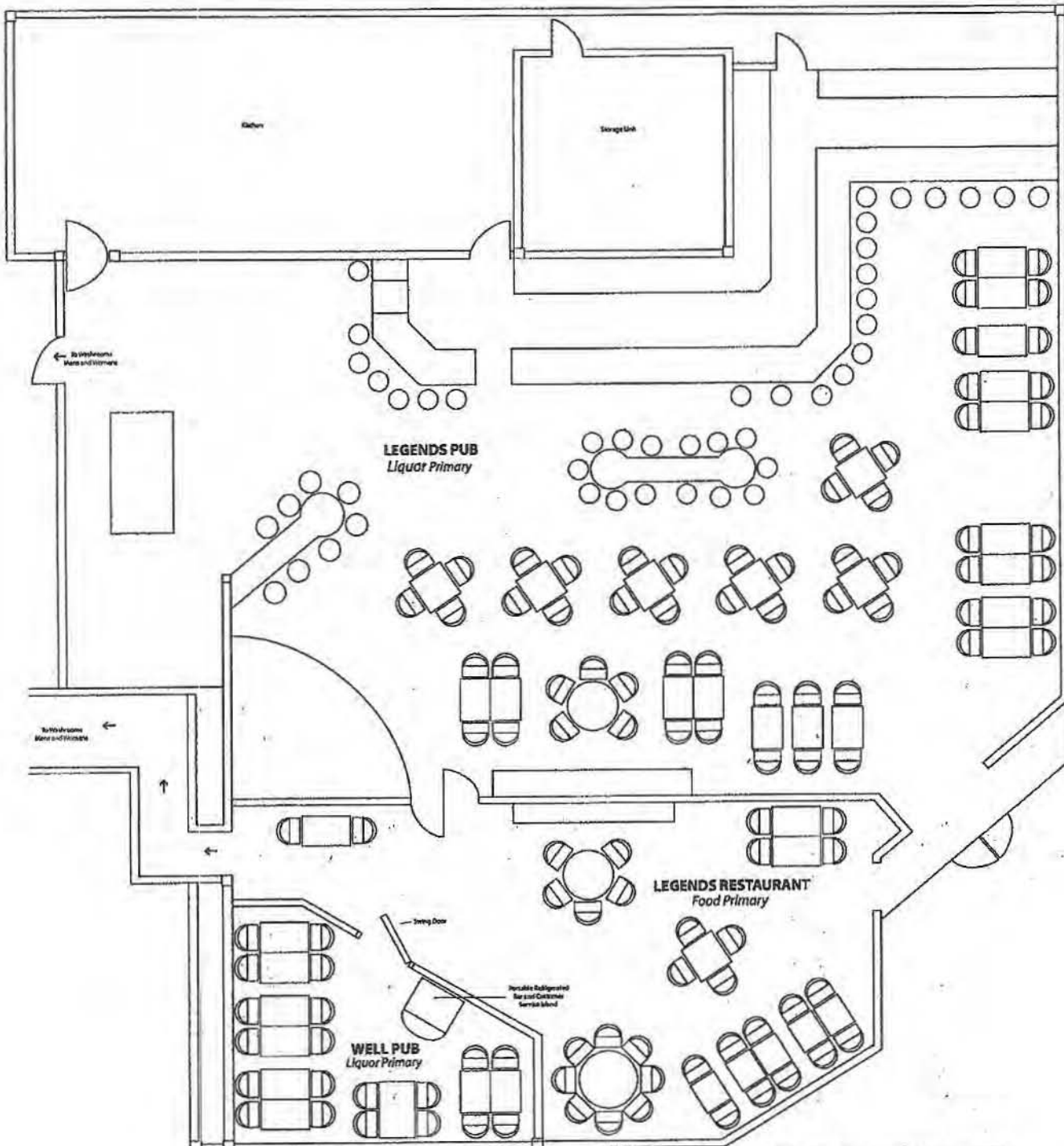

Scale: 1/4" = 1'

CITY OF RICHMOND	
DATE	
APR 01 2009	
RECEIVED	
Bldg Approvals	

ATTACHMENT 2

10
25H-12

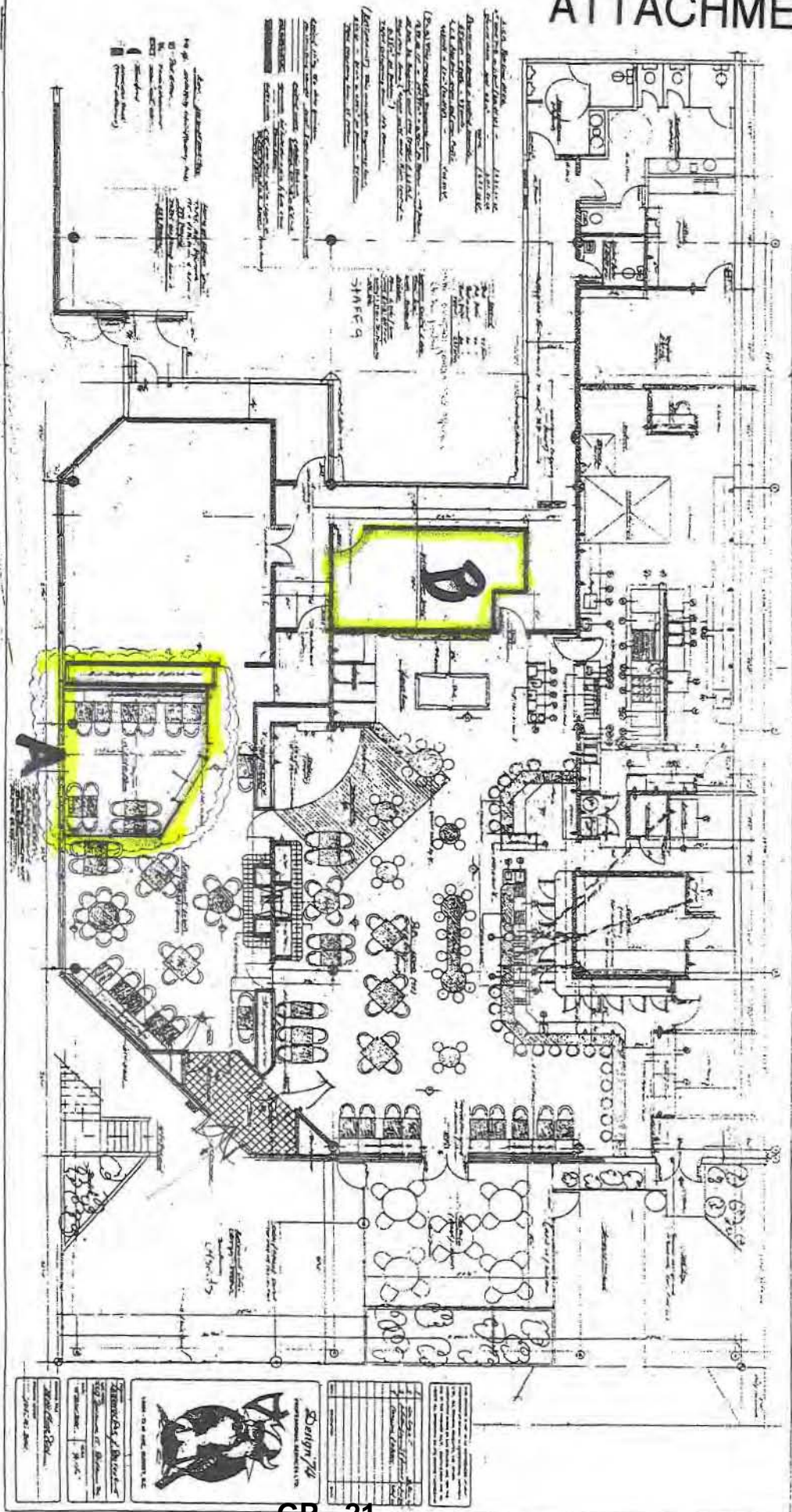

SECOND BUILDING APPROXIMATE
REPAIR ITEMS

WOODPANEL WITH SLEEVES
AS SHOWN IN DRAWING

BDMK

08.04.17

• CURRENTLY IN (A) LOCATION
• WOULD LIKE TO MOVE UP TO (B) LOCATION

<p>Design 7/16 ARCHITECTURAL ARCHITECTS</p>	<p>DATE: 08/04/17</p> <p>PROJECT: 25H-12</p>
	<p>DESIGNER: [Name]</p> <p>ARCHITECT: [Name]</p>
<p>PROJECT NO. 25H-12</p>	<p>DATE: 08/04/17</p>

