



City of Richmond

Report to Committee

To: Parks, Recreation and Cultural Services Committee
 From: Vern Jacques, Acting Director, Recreation & Cultural Services
 Re: Paulik Gardens Neighbourhood Park Community Public Art Project, "Lulu, A Memory Garden"

To Parks, Recreation & Culture -
 Date: April 16, 2008 *Apr 29, 2008*
 File: 11-7000-09-20-054/Vol 01

Staff Recommendation

That the final concept design, as prepared by Jacqueline Metz and Nancy Chew, be endorsed for the Community Public Art Project entitled "Lulu, A Memory Garden", at Paulik Gardens Neighbourhood Park.

Vern Jacques
 Vern Jacques
 Acting Director, Recreation & Cultural Services

Att. 3

FOR ORIGINATING DEPARTMENT USE ONLY			
ROUTED TO:	CONCURRENCE	CONCURRENCE OF GENERAL MANAGER	
Parks Planning, Design & Construction ...	Y <input checked="" type="checkbox"/> N <input type="checkbox"/>	<i>[Signature]</i>	
REVIEWED BY TAG	YES <input checked="" type="checkbox"/> NO <input type="checkbox"/>	REVIEWED BY CAO	YES <input checked="" type="checkbox"/> NO <input type="checkbox"/>

Staff Report

Origin

The community public art project for Paulik Gardens Neighborhood Park was initiated by Parks, Recreation & Cultural Services, and a Call for Submission was executed in the Spring of 2005. In accordance with the City Public Art Policy for artist selection, a 5-person panel chose the artist team of Jacqueline Metz & Nancy Chew to undertake the project.

On December 19, 2005, Council approved the allocation of \$30,000 for the development of a community public art project for the new Paulik Gardens Neighbourhood Park, in the McLennan South Sub-Area, to be led by the artist team Metz & Chew.

On January 16, 2008 Jacqueline Metz and Nancy Chew presented their final concept design to the Richmond Public Art Commission (RPAC). The RPAC unanimously approved the final concept design and recommends acceptance by Council.

Analysis

Community Public Art is one component of the City's Public Art Program and invites neighbourhood residents to collaborate with artists and other community organizations to create art works for significant neighbourhood sites.

The artist team undertook research into the cultural history of the new neighbourhood park, including Lulu Island Water Garden, formerly on the site of the new community park. They solicited personal memories of the surviving family members who grew up in the area that now forms the park. This research included interviews with Ed and Wally Paulik, whose parents created and managed the large ornamental garden and the woodlot that are the central features of the new park, and Peter Ohler whose family operated Lulu Island Water Gardens, a once prominent horticultural business specializing in aquatic plants.

Following the initial research phase, the artist team contacted community organizations and neighbourhood schools to solicit interest in the art project. A web site was established to gather comments and memories. Submissions from Palmer Senior Secondary art class students and the Poetry Club were received and have been incorporated into the art plan.

The final design for the art project consists of two parts (**Attachment 1**):

- large pavers cut from basalt pillars with text developed with the Palmer Senior Secondary student Poetry Club sandblasted into the face of the stones and placed at various locations throughout the park (**Attachment 2**); and
- a centre piece of large etched black stone paver slabs (0.3 m x 1.4 m) placed in a radial pattern incorporating the drawings of horticultural images created by the Palmer Senior Secondary art students (**Attachment 3**).

If approved, work on the etching and sandblasting of the stones would commence, with installation scheduled for the Fall of 2008, in coordination with the Park development.

April 16, 2008

- 3 -

Financial Impact

The proposed project costs of \$30,000 are within the public art budget, and approved for this project in December of 2005.

Conclusion

“Lulu, a Memory Garden” is a project which embraces community involvement. Using memories, family stories, writing and visual arts from the community, Jacqueline Metz & Nancy Chew have created an eloquent project that enhances community identity, history and charm of an important part of Richmond’s heritage and urban landscape.

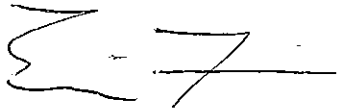

Eric Fiss
Public Art Planner
(604-247-4612)

EF:ef

BETWEEN
THESE TREES

THE
FERNS GROW

ALONG THIS PATH I
GO

Sweet
SCENT
IN THE AIR

THE TREES TOOK TO THE
FLOWERS TOOK
FROM FACE TO BEAUTY.
THIS GIANT LOCK

WITH
THESE HANDS
I MENDED
A BROKEN HEART
AND
GREW IT INTO
A GARDEN

THESE
WINDOWS
OF STAINED GLASS
ARE BUILT FOR
YOU

GREEN
GRASS
TIDES
LAP

THE
BLUES
RI

A
HUNDRED SHADES
OF GREEN
ARE ENOUGH

SOMEONE
HAS PAINTED
THIS PICTURE
WITH A SPADE

RODS

Lulu, A Memory Garden Site Plan

Lulu, a Memory Garden

Art Plan
 Paulik Gardens Neighbourhood Park
 Approx. scale: 1:750
 January 16, 2008
General Curator Board

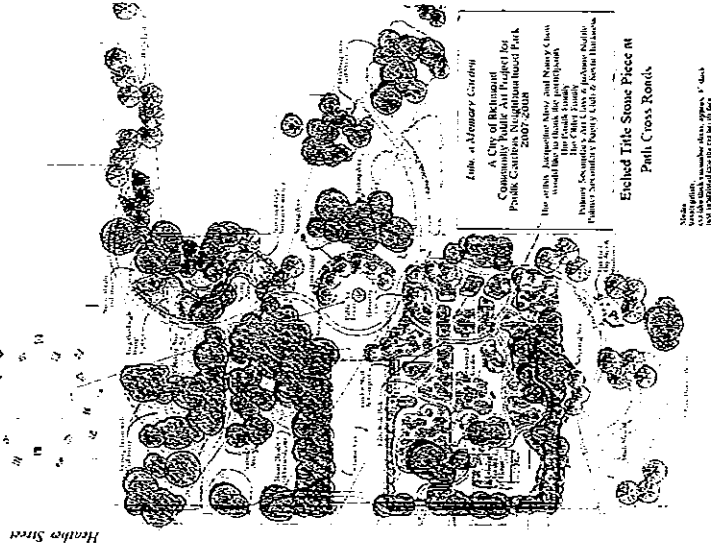

Nancy Clive & Jacqueline Niles
 Nancy Clive, 106-109 Base Street, Vancouver, BC V6G 1R6
 604-275-0184 nancy@nancyclive.com

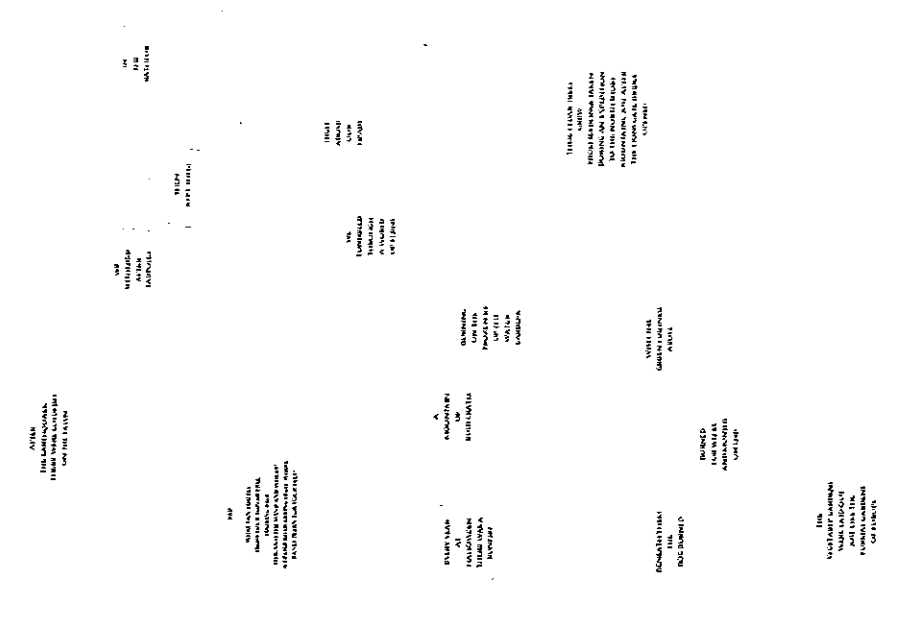

Text for Stone Pavers For Placement in the Paulik Gardens Neighbourhood Park
Developed with the Palmer Secondary Poetry Club

DAD
WHAT CAN YOU SEE
FROM YOUR POPLAR TREE.
LOOKING BACK
THROUGH THE WIND AND WHEAT?
A FRASER RIVER EBBING HIGH. WHOSE
BANKS YEARN FOR YOUR FEET?

WITH
THESE HANDS
I MENDED
A BROKEN HEART
AND
GREW IT INTO
A GARDEN

BENEATH THEM
THE
BOG BURNED

BURNED
FOR WEEKS
AND MONTHS
ON END

WITH THE
GREEN LUSHNESS
ABOVE

Lulu, a Memory Garden

Text on Basalt
Paulik Gardens Neighbourhood Park

January 16, 2008

Nancy Chew & Jacqueline Metz
Muse Atelier, 106-1956 Haro Street, Vancouver, BC V6G 1H6
604-685-6134 museatelier@shaw.ca



Poetry on Stone
sliced basalt pillars
basalt "cucumber slices", approx. 5" thick
text sandblasted into the cut basalt face

**Horticultural Images For Centrepiece Commons
Developed with the Palmer Secondary Drawing Class
Location Plan**

Lulu, a Memory Garden

Preliminary Art Plan - showing centrepiece in round commons
Paulik Gardens Neighbourhood Park
January 9, 2008

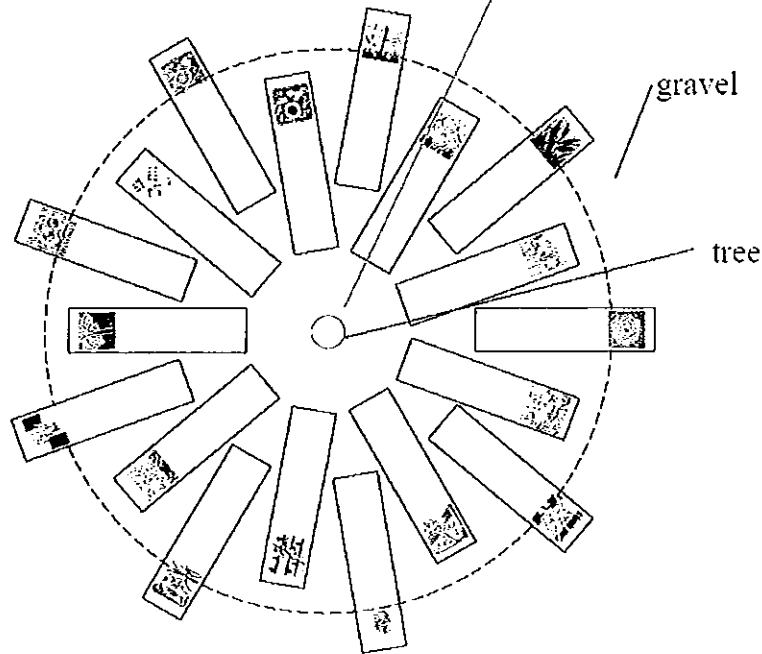
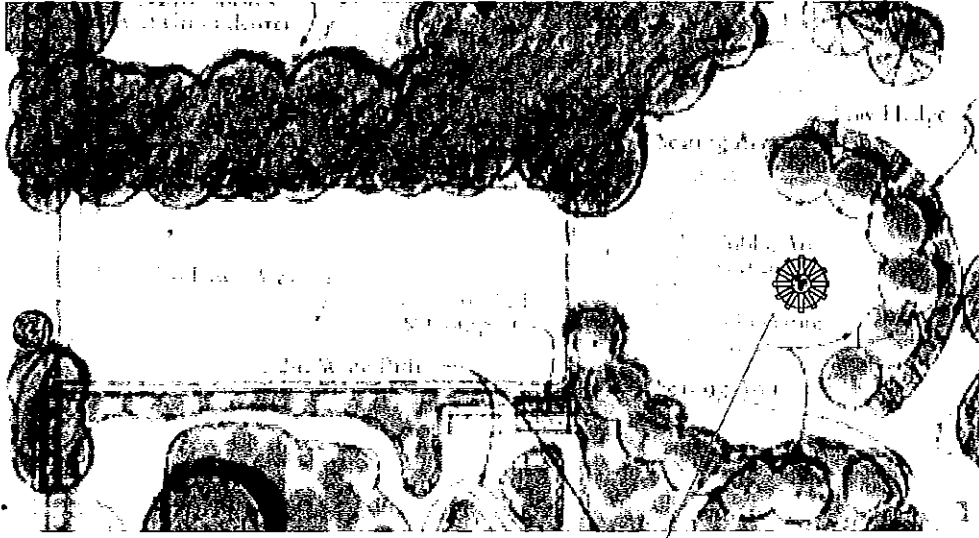

Nancy Chew & Jacqueline Metz
Muse Atelier, 106-1956 Haro Street, Vancouver, BC V6G 1H6
604-683-6184 museatelier@shaw.ca

Lulu, a Memory Garden

Images on Stone

Paulik Gardens Neighbourhood Park
January 16, 2008

Palmer Secondary Art Students

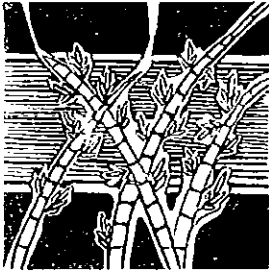

Mina Ueda



Ashley Fung



Yara Vaziri



Kyle Cooper



Isabel Lee



Justin Sze



Grace Lee

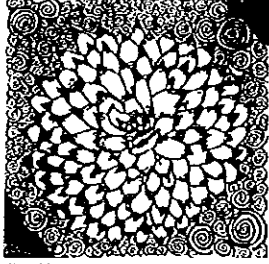

Diana Fung



Henry Gao

Nancy Chew & Jacqueline Metz
MUSE Atelier, 106-1956 Haro Street, Vancouver, BC V6G 1H6
604-683-6184 museatelier@shaw.ca

Media:
digital files laser-etched onto
black stone pavers, 12" x 48"

