

11266 No. 2 Rd
 Lot Size: 0.6 ha (1.46 ac)

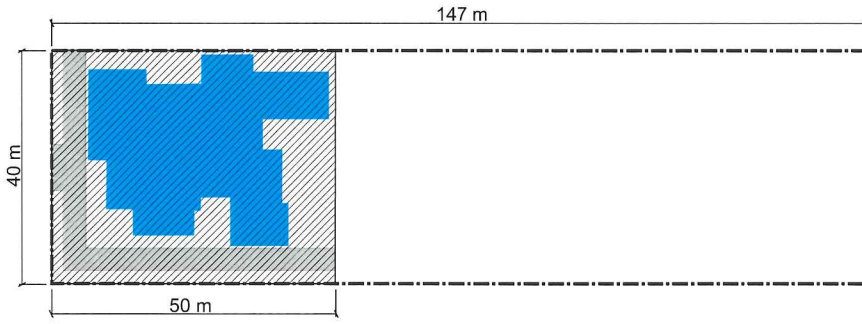

Issued Building Permit

- House Size: 1,707 m² (18,374 ft²)
- House Footprint: 889 m² (9,569 ft²)
- Approx. Farm Home Plate: 2,000 m² (21,528 ft²)
- Hard Surfaces

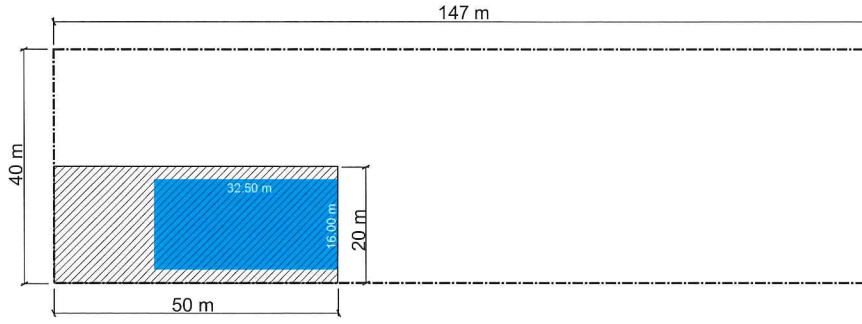

Proposed Bylaws*

- House Size: 1,000 m² (10,764 ft²)
- House Footprint: 520 m² (5,597 ft²)
- Farm Home Plate: 1,000 m² (10,764 ft²)

*House footprint and farm home plate shown conceptually. Actual dimensions and location may vary.

Schedule 156 to the Minutes of the Public Hearing meeting of Richmond City Council held on Monday, May 15, 2017 and Wednesday, May 17, 2017.

11111 No. 4 Rd
 Lot Size: 2.58 ha (6.3 ac)

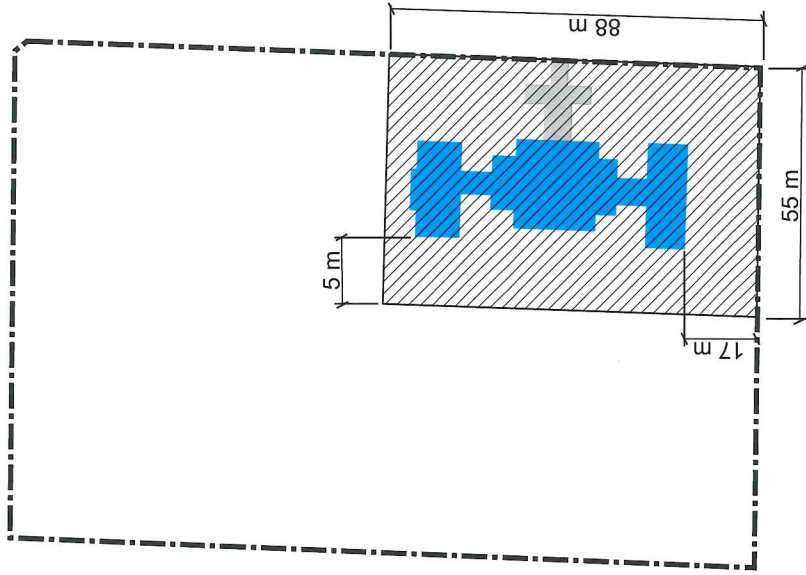

Issued Building Permit

- House Size: 2,380 m² (25,618 ft²)
- House Footprint: 1,395 m² (15,017 ft²)
- Approx. Farm Home Plate: 4,840 m² (52,097 ft²)
- Hard Surfaces

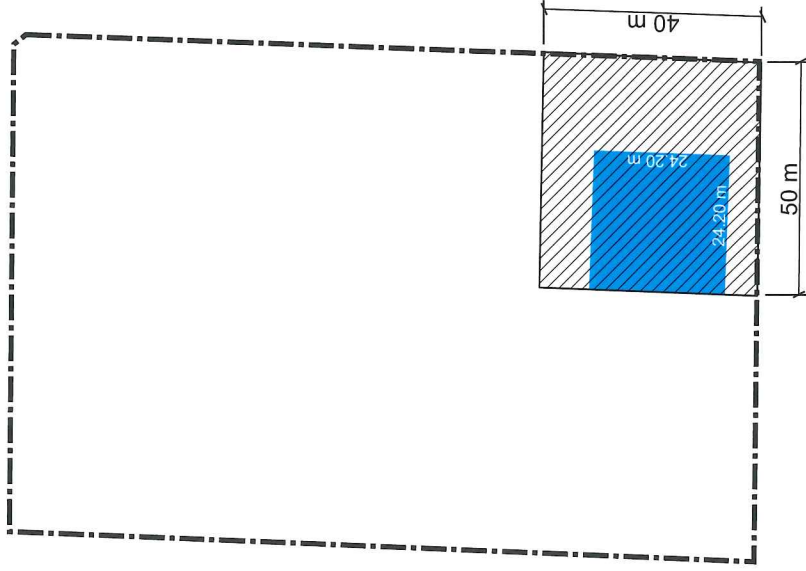

Proposed Bylaws*

- House Size: 1,000 m² (10,764 ft²)
- House Footprint: 586 m² (6,308 ft²)
- Farm Home Plate: 2,000 m² (21,528 ft²)

*House footprint and farm home plate shown conceptually. Actual dimensions and location may vary.

10288 Granville Ave

Lot Size: 1.72 ha (4.24 ac)

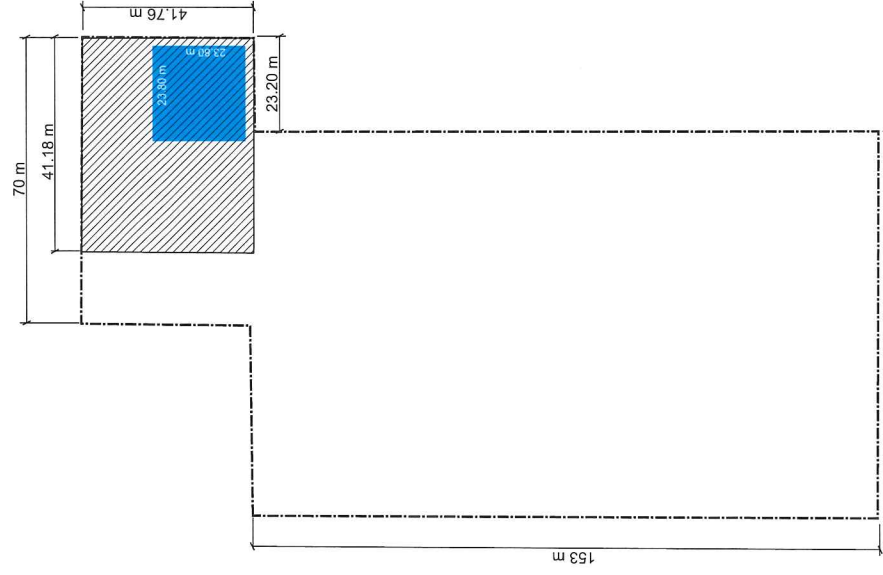
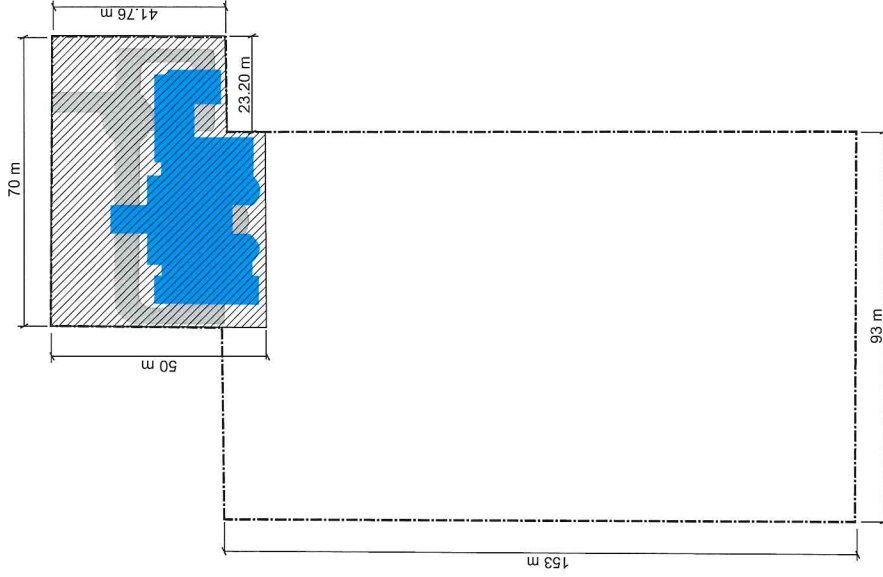

Issued Building Permit

- House Size: 2,001 m² (21,539 ft²)
- House Footprint: 1,135 m² (12,218 ft²)
- Approx. Farm Home Plate: 3,410 m² (36,705 ft²)
- Hard Surfaces

Proposed Bylaws*

- House Size: 1,000 m² (10,764 ft²)
- House Footprint: 567 m² (6,103 ft²)
- Farm Home Plate: 1,720 m² (18,514 ft²)

*House footprint and farm home plate shown conceptually. Actual dimensions and location may vary.