



Parks, Recreation & Cultural Services Committee

Date: Tuesday, May 27, 2014

Place: Anderson Room
Richmond City Hall

Present: Councillor Harold Steves, Chair
Councillor Ken Johnston
Councillor Evelina Halsey-Brandt
Councillor Bill McNulty
Mayor Malcolm Brodie

Absent: Councillor Linda Barnes

Also Present: Councillor Chak Au
Councillor Linda McPhail

Call to Order: The Chair called the meeting to order at 4:00 p.m.

MINUTES

It was moved and seconded

That the minutes of the meeting of the Parks, Recreation and Cultural Services Committee held on Tuesday, April 29, 2014, be adopted as circulated.

CARRIED

NEXT COMMITTEE MEETING DATE

Tuesday, June 24, 2014, (tentative date) at 4:00 p.m. in the Anderson Room

COMMUNITY SERVICES DEPARTMENT

1. GARDEN CITY LANDS LEGACY LANDSCAPE PLAN

(File Ref. No. 06-2345-20) (REDMS No. 4219968 v.4)

With the aid of a visual presentation (attached to and forming part of these minutes as **Schedule 1**), Mike Redpath, Senior Manager, Parks and Yvonne Stich, Park Planner, gave an overview of the proposed Garden City Lands (GCL) Legacy Landscape Plan. Mr. Redpath and Ms. Stich commented on the following: (i) the planning process; (ii) the community consultation process; (iii) the location of the GCL; (iv) the history of the GCL; (v) the projected population in areas adjacent to the GCL; (vi) the GCL as part of the Agriculture Land Reserve (ALR); (vii) the land use framework; (viii) the different proposed landscape zones; (ix) the area's hydrology; (x) the preservation of native plant species and animals; (xi) the proposed layout of the site; (xii) the proposed landscape features; (xiii) the proposed farming features and strategies; (xiv) the integration of community programs and cultural features; (xv) the proposed internal trails and perimeter pathway; and (xvi) funding strategies and resource management planning.

Mr. Redpath spoke of the completed community consultations and advised of the suggestions received, which included:

- creating safe pedestrian access to the site;
- providing for a caretaker, particularly if animals are kept on site;
- providing a security strategy to protect the site from vandalism and theft;
- providing adequate irrigation and understanding the hydrology of the site;
- supplying adequate parking for users of the site; and
- developing partnerships with stakeholders in the community.

Discussion ensued with regard to the grid layout and soil conditions of the site and in reply to queries from Committee, Mr. Redpath noted that the soil can be remediated to accommodate a variety of crops.

In reply to queries from Committee, Mr. Redpath advised that a consultation team will be used to further study the hydrology of the site. Ms. Stich added that the hydrology study will require a minimum of one year to complete and will help determine the management strategy of the site. Ms. Stich then noted that initial work can begin along edges of the site, where the soil has been previously disturbed by road construction.

Parks, Recreation & Cultural Services Committee

Tuesday, May 27, 2014

Discussion ensued with regard to (i) suitable locations in the site for fruit trees; (ii) maintaining an on-going relationship with the Agricultural Land Commission; and (iii) additional public consultation.

In reply to queries from Committee, Ms. Stich advised that a diagonal layout of the site that was initially proposed created triangular-shaped parcels that were not practical to use; as a result, the layout was changed to a north-south design.

In reply to queries from Committee, Cathryn Volkering Carlile, General Manager, Community Services, advised that public consultation, at this stage of the Plan has concluded, however additional public consultation sessions can be added at Council's direction.

Discussion ensued with regard to (i) using fruit tree sponsorship as a way to involve the community; (ii) including an on-site caretaker that would be involved with the activities on the site; (iii) relocating a heritage home on the site; and (iv) rotating crops on the farming portion of the site.

In reply to queries from Committee, Mr. Redpath noted that users of the GCL are encouraged to use public or alternative transportation; however some vehicle parking will be required for the site. It was then suggested that the parking spaces do not necessarily need to be paved.

Discussion then ensued with regard to the timeline of the studies that are being conducted on the site.

Jim Wright, 8300 Osgoode Drive, expressed concern with the Garden City Lands Legacy Landscape Plan and read from his submission (attached to and forming part of these minutes as **Schedule 2**).

John ter Borg, 5860 Sandpiper Court, commented on (i) the unique features and history of the GCL; (ii) the need to focus on maintaining natural features of the site; (iii) the hydrology of the site; (iv) the potential uses for the flex fields; (v) the site's trail system; and (vi) the buffers between different ecological areas of the site.

In reply to queries from Committee, Mr. Redpath clarified that the flex fields are passive open spaces and will not be designated for sports field use. He added that a non-farm use application would have to be submitted to allow for sports field use. Staff were then directed to change the name of the flex fields to avoid any confusion with regard to the possible uses for the said fields.

Kent Mullinix, Kwantlen Polytechnic University (KPU), commented on the possible partnership between the City and KPU with regard to the GCL. He noted that KPU can assist with the farm management plan and establish plantings for the site. Also, he added that KPU can offer solutions to manage the soil and parking on the site.

Parks, Recreation & Cultural Services Committee
Tuesday, May 27, 2014

In reply to queries from Committee, Mr. Mullinix advised that the optimal period to plant fruit trees is in the spring in order to avoid damage from winter conditions.

De Whalen, 13631 Blundell Road, expressed support for the Garden City Lands Legacy Landscape Plan and noted that the site will provide passive recreation accessible to low income families.

The Chair provided a list of native plant species, (attached to and forming part of these minutes as **Schedule 3**) and recommended that native species be used for planting in the GCL.

It was moved and seconded

That the Garden City Lands Legacy Landscape Plan as detailed, and attached to the staff report titled "Garden City Lands Legacy Landscape Plan," dated May 5, 2014, from the Senior Manager, Parks, be endorsed as a guide for future detailed planning and development of the Garden City Lands.

CARRIED

Staff were directed to present the Garden City Lands Legacy Landscape Plan at a future Council meeting.

Mayor Brodie left the meeting (5:05 p.m.) and did not return.

2. DOG OFF LEASH PROGRAM UPDATE 2014

(File Ref. No. 11-7200-20) (REDMS No. 4227416 v.8)

Discussion ensued with regard to the size of the designated off-leash areas in the city, and Dee Bowley-Cowan, Acting Manager, Parks Programs advised that the size of the off-leash area can be expanded if needed.

In reply to queries from Committee, Mr. Redpath noted that the size of an off-leash area is dependent on the dimensions of the site and the needs of the dogs. He added that informational signage is proposed to be installed on each off-leash site and that community feedback is encouraged during the pilot project program.

In reply to queries from Committee, Ms. Bowley-Cowan noted that a layout that would separate large and small dogs in the off-leash area would be dependent on the needs of the community.

Discussion ensued with regard to the enforcement of aggressive dogs.

Discussion then ensued regarding responsible dog ownership and the environmental impact of the off-leash areas.

Parks, Recreation & Cultural Services Committee
Tuesday, May 27, 2014

It was moved and seconded

- (1) *That the existing temporary fenced dog off leash area at Dover Park be relocated to the McCallan Road Right of Way/Railway Corridor and be designated as a fenced dog off leash area to be reviewed on an annual basis as detailed in the staff report "Dog Off Leash Program Update 2014" from the Senior Manager, Parks dated May 5, 2014;*
- (2) *That the vacant City-owned lot located at 7300 Elmbridge Way be designated as a fenced dog off leash area as detailed in the staff report "Dog Off Leash Program Update 2014" from the Senior Manager, Parks dated May 5, 2014 and be reviewed on an annual basis;*
- (3) *That a designated fenced dog off leash area be located on a portion of Garden City Community Park as detailed in the staff report "Dog Off Leash Program Update 2014" from the Senior Manager, Parks dated May 5, 2014 and be reviewed on an annual basis; and*
- (4) *That a designated fenced dog off leash area be located on a portion of South Arm Community Park as detailed in the staff report "Dog Off Leash Program Update 2014" from the Senior Manager, Parks dated May 5, 2014 and be reviewed on an annual basis.*

CARRIED

3. MANAGER'S REPORT

(i) McDonald and Point Grey Tidal Marsh Projects

The Chair referred to a newspaper notice and an email from Port Metro Vancouver, (attached to and forming these minutes as **Schedule 4**) and expressed concern with regard to the potential impacts to wildlife habitat as a result of the McDonald and Point Grey Tidal Marsh Project.

In reply to queries from Committee, Dave Semple, General Manager, Community Services, noted that the McDonald and Point Grey Tidal Marsh Project site was acquired by the Vancouver Airport Authority and that staff will participate in the consultation process. Staff were then directed to provide a written submission to Port Metro Vancouver expressing the City's concerns with the proposed project.

Cllr. Au left the meeting (5:14 p.m.) and did not return.

Parks, Recreation & Cultural Services Committee
Tuesday, May 27, 2014

(ii) *Branscombe House*

Jane Fernyhough, Director, Arts, Culture and Heritage Services, provided an update on Branscombe House noting that work is being done to replace the perimeter fencing, new gates to the parking lot will be added, and the landscaping will be updated. Also, she noted that staff are preparing a report for possible uses of the site.

(iii) *Doors Open and Taste of the Empire*

Ms. Fernyhough spoke of the upcoming Doors Open event, scheduled for June 7 and 8, 2014, as well as Taste of the Empire event, scheduled for May 31 to June 1, 2014 at the Richmond Cultural Centre's Rooftop Garden.

(iv) *Richmond Sports and Community Events*

Gregg Wheeler, Manager, Sports and Community Events, commented on sports and community events happening in the city including:

- the BC Elementary Track and Field Championships hosted by the Kajacks Track and Field Club;
- Ladies football at Hugh Boyd Secondary School;
- Richmond City Baseball tournament
- Richmond Lacrosse Salmon Festival Tournament,
- SOS Children's Village Run; and
- Sockeye Run Car Show and Shine, hosted by the Richmond Lion's Club.

(v) *Historical Boats*

Mr. Semple commented on the option to locate the rum-runner boat to the Britannia site and noted that a report to Council detailing preservation options will be presented later this year.

ADJOURNMENT

It was moved and seconded

That the meeting adjourn (5:17 p.m.).

CARRIED

Parks, Recreation & Cultural Services Committee
Tuesday, May 27, 2014

Certified a true and correct copy of the Minutes of the meeting of the Parks, Recreation & Cultural Services Committee of the Council of the City of Richmond held on Tuesday, May 27, 2014.

Councillor Harold Steves
Chair

Evangel Biason
Auxiliary Committee Clerk

GARDEN CITY LANDS

LEGACY LANDSCAPE PLAN

MAY 2014



PLANNING PROCESS & METHODOLOGY

City Council Term Goal: 2011-2014
“Complete the Garden City Lands planning
process by 2014”

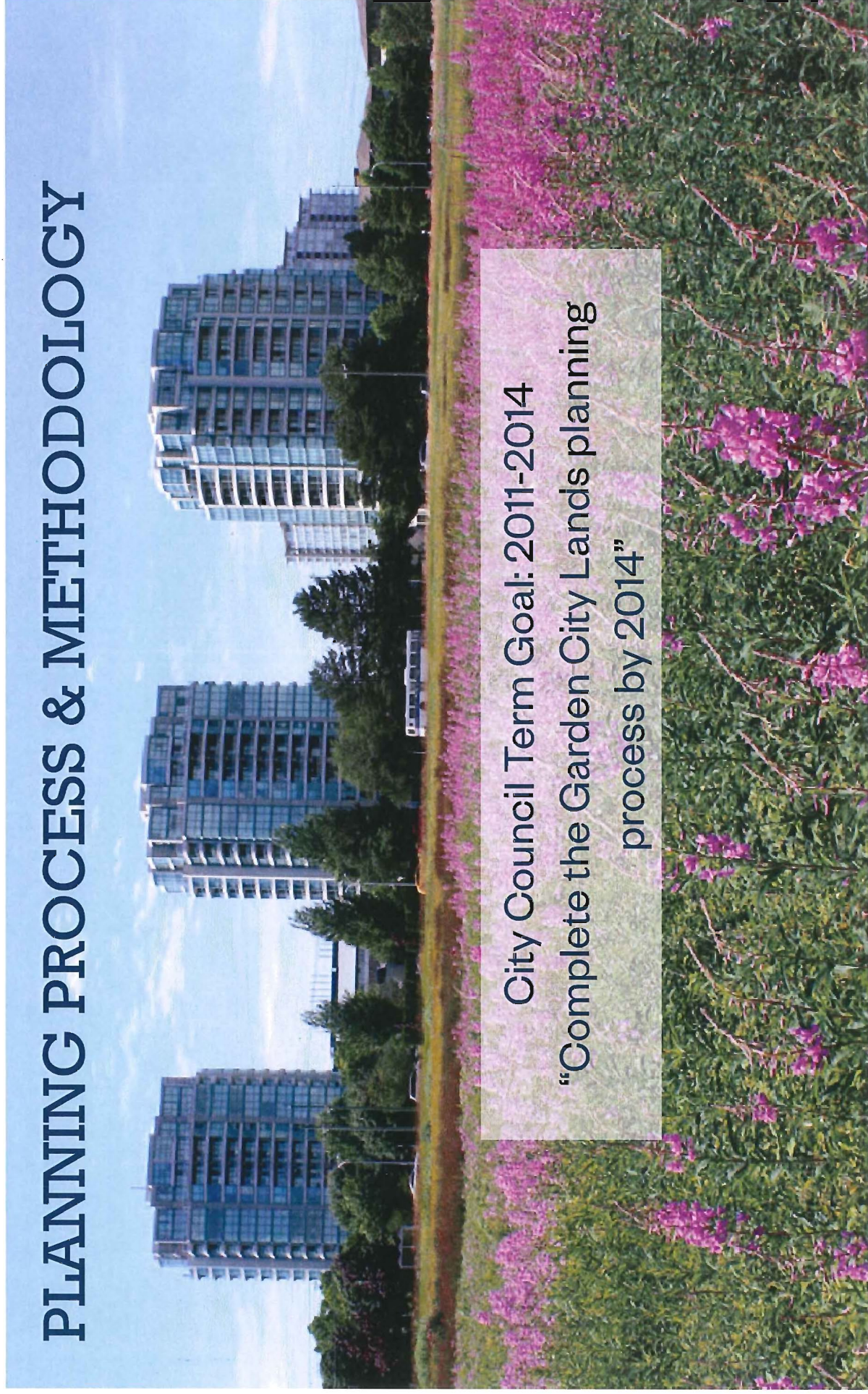

KEY PLANNING STAGES

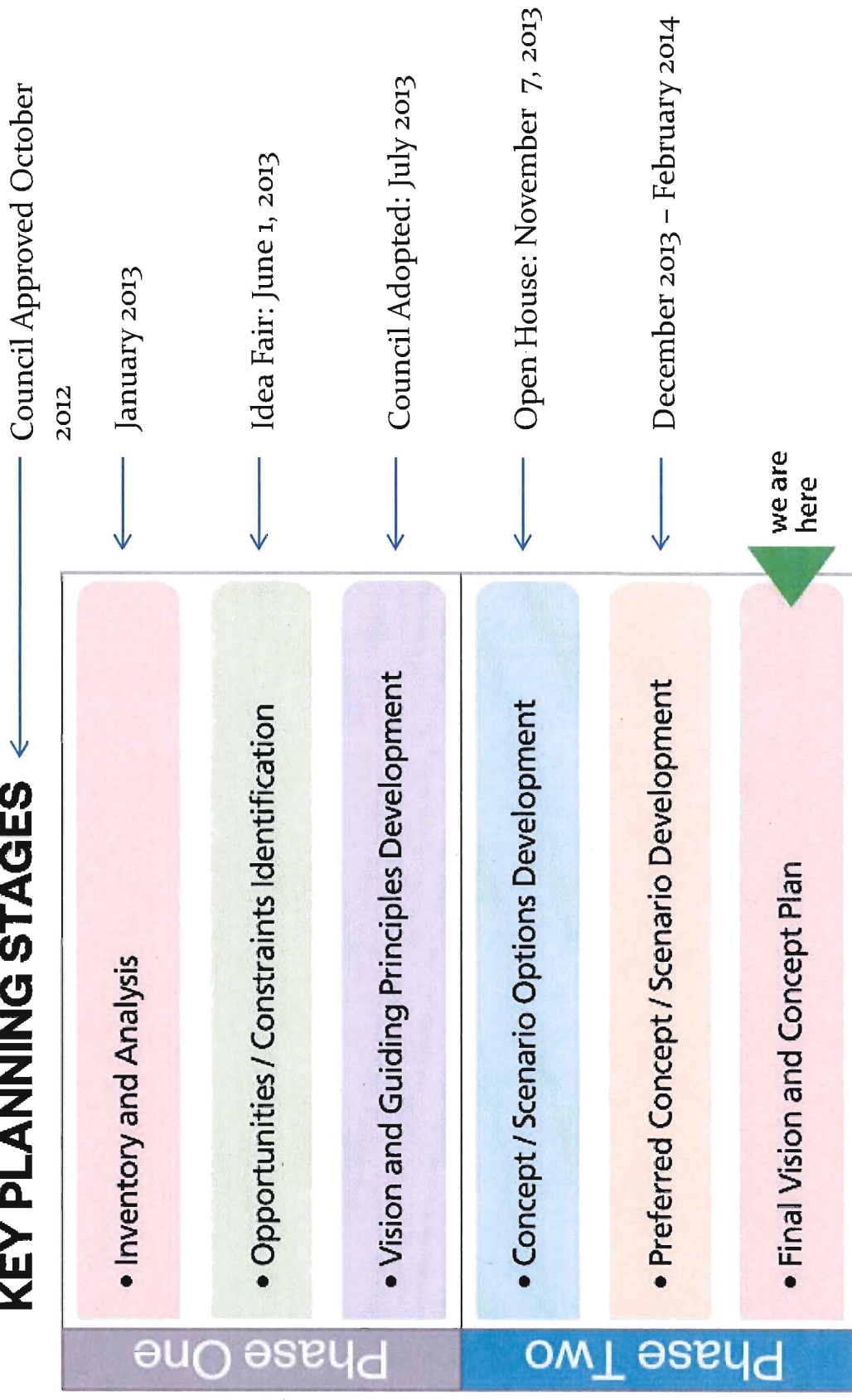

CONSULTATION PROCESS

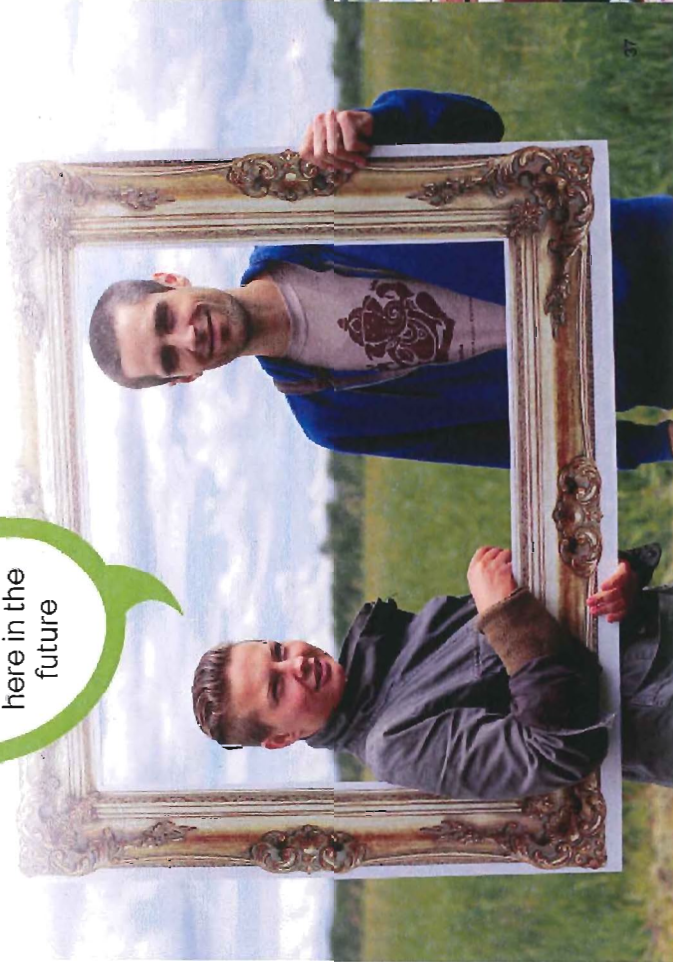

WHAT WE HEARD... JUNE 1, 2013



QUESTION:

Tell us which of the following farm and non-farm activities permitted on the ALR you would support?



Ecological Reserve
(e.g. Richmond Nature Park)



Passive Recreation
(e.g. walking trails, botanicals, bird watching, picnics)



Open Parkland
(e.g. community gardens, sports, community gardens)



Site-related Education and Research
(e.g. sustainability centre)



Crop Production
(e.g. root and green vegetables)



Agricultural Tourism
(e.g. harvest market, farm tours)



Leave As Is
(e.g. for future generations)

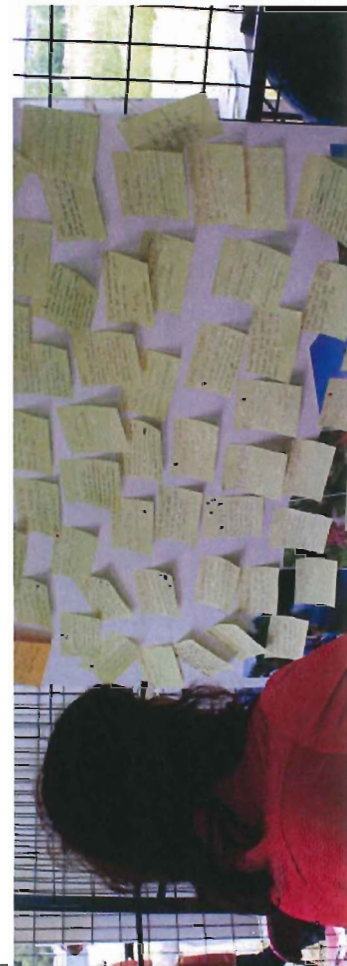

NATURE CONCEPT



ON THE GRID CONCEPT



OFF THE GRID CONCEPT



NOVEMBER 7, 2013 OPEN HOUSE

These three concept plans were presented at the Open House located in Lansdowne Mall. Approximately 1000 people attended the all day event. Participants were asked to rank these concepts and given the option of selecting "None of the Above".



WHAT WE HEARD... NOVEMBER 7, 2013

STRONGLY <-> SOMEWHAT
STRONGLY DO NOT SUPPORT

QUESTION:

Each concept has been designed with a menu of 38 proposed Elements. I support the following major elements...



Natural Features
e.g. top conservation areas, grass meadows



Water Features
e.g. separated wetland, pond



Agriculture
e.g. demonstration gardens, markets and local food hubs



Gateways & Connections
e.g. entry features at entrances, agricultural landscape to nature park



Parkland Amenities
e.g. trails and boardwalks, income for community fund



Interpretation & Art
e.g. creative and interactive displays, dog-friendly



Multi-Functional Hub
e.g. space for farmer markets, farm & community kitchen

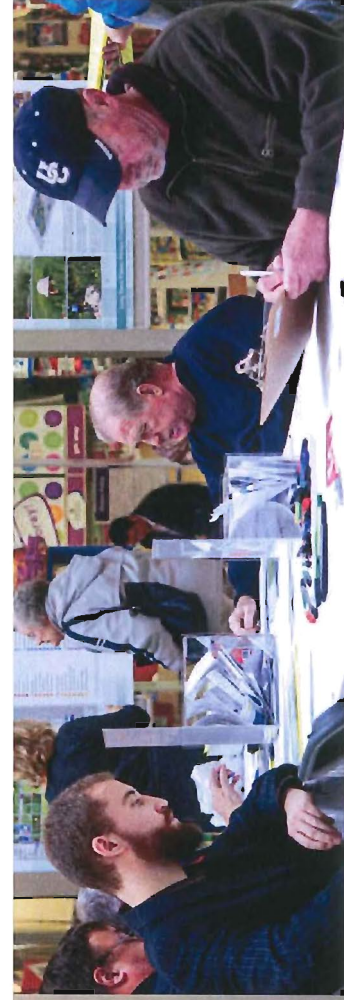

SURROUNDING CONTEXT

- ☐ Unique location
- ☐ Transition between urban, natural and rural
- ☐ 2km to the waterfront
- ☐ 472 acre ecological hub

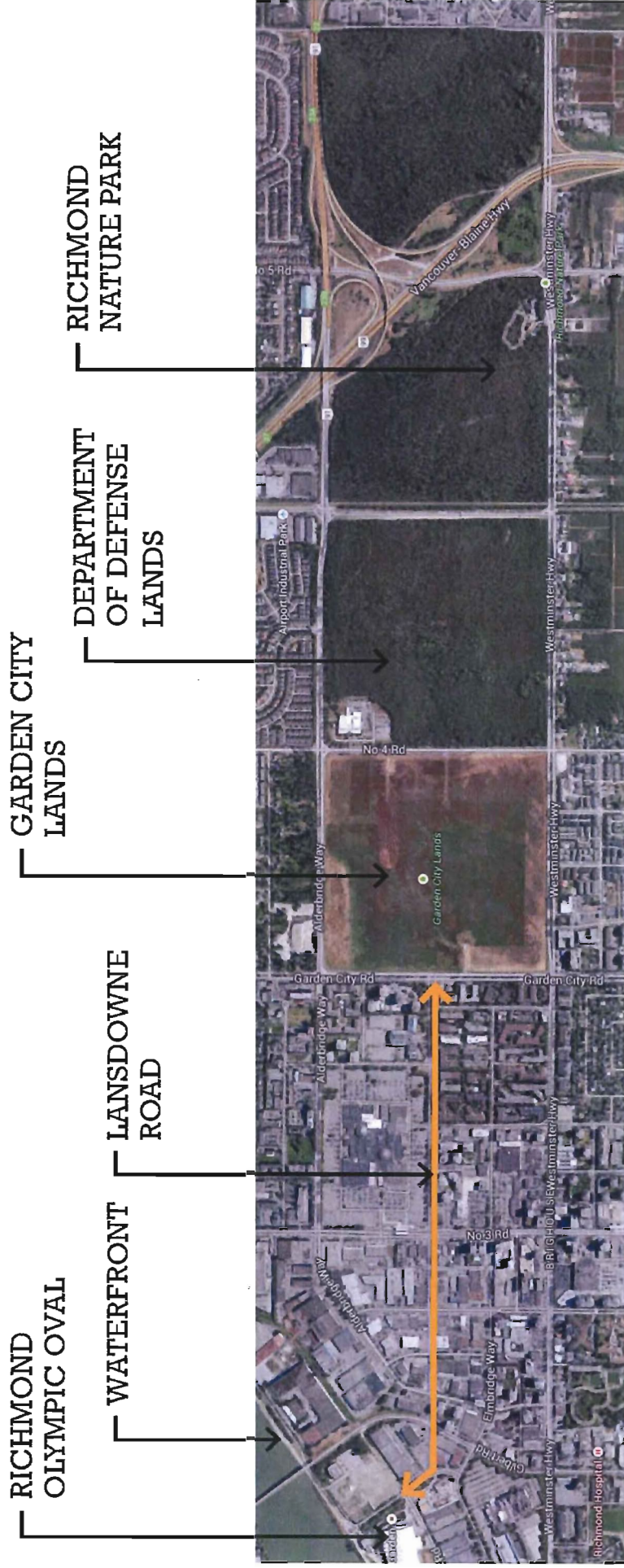



2016 Projected Population



HIGHLY VISIBLE

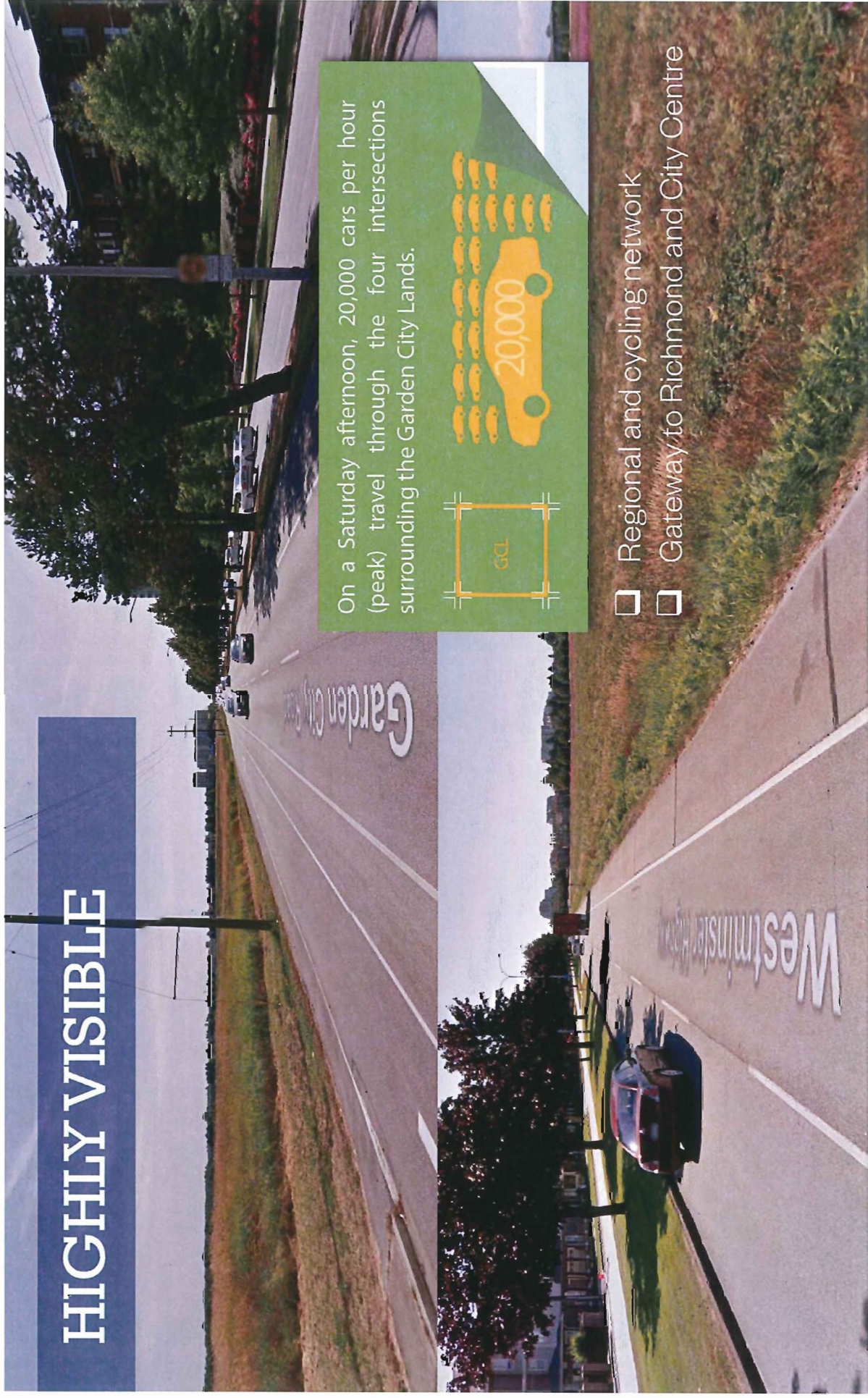

Garden City Blvd

Westminster Hwy

On a Saturday afternoon, 20,000 cars per hour (peak) travel through the four intersections surrounding the Garden City Lands.

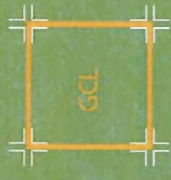

- ☐ Regional and cycling network
- ☐ Gateway to Richmond and City Centre

HISTORY

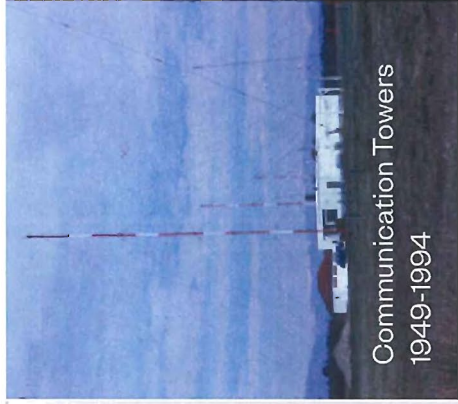

Communication Towers
1949-1994



View over Lansdowne Centre 1980s

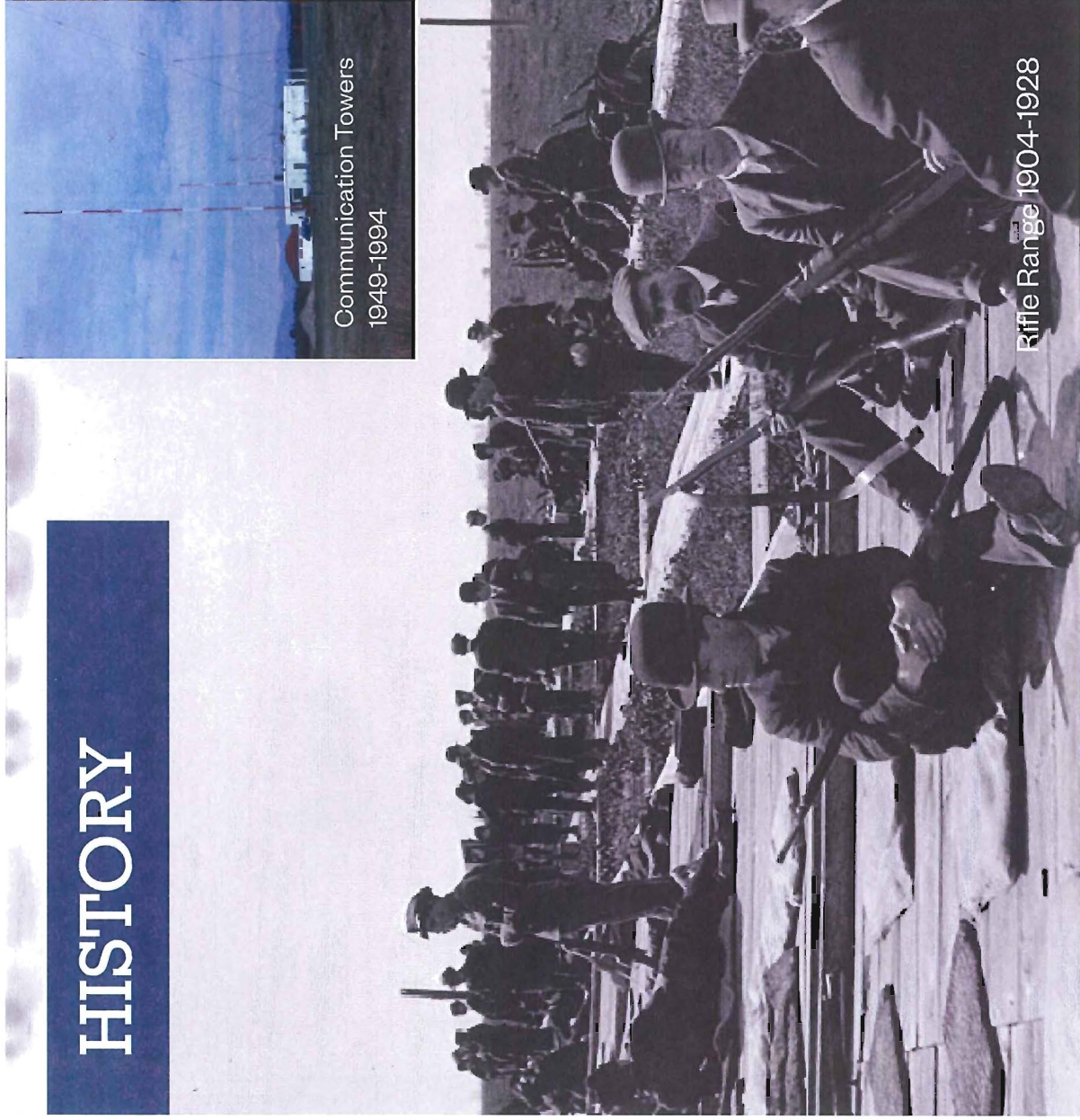

Rifle Range 1904-1928

AGRICULTURAL LAND RESERVE

In addition to traditional farming uses the following are considered allowable use:

- Ecological reserve
- Passive recreation
- Open parkland
- Horticulture and nurseries
- Education and research
- Buildings for farming
- Storage and farm sales of agricultural products
- Agri-tourism



LEGACY PLAN: LAND USE FRAMEWORK

1. Urban Agriculture
2. Natural Environment
3. Community Wellness and Active Living
4. Cultural Landscape / Place-Making

Multi-Functional Landscape

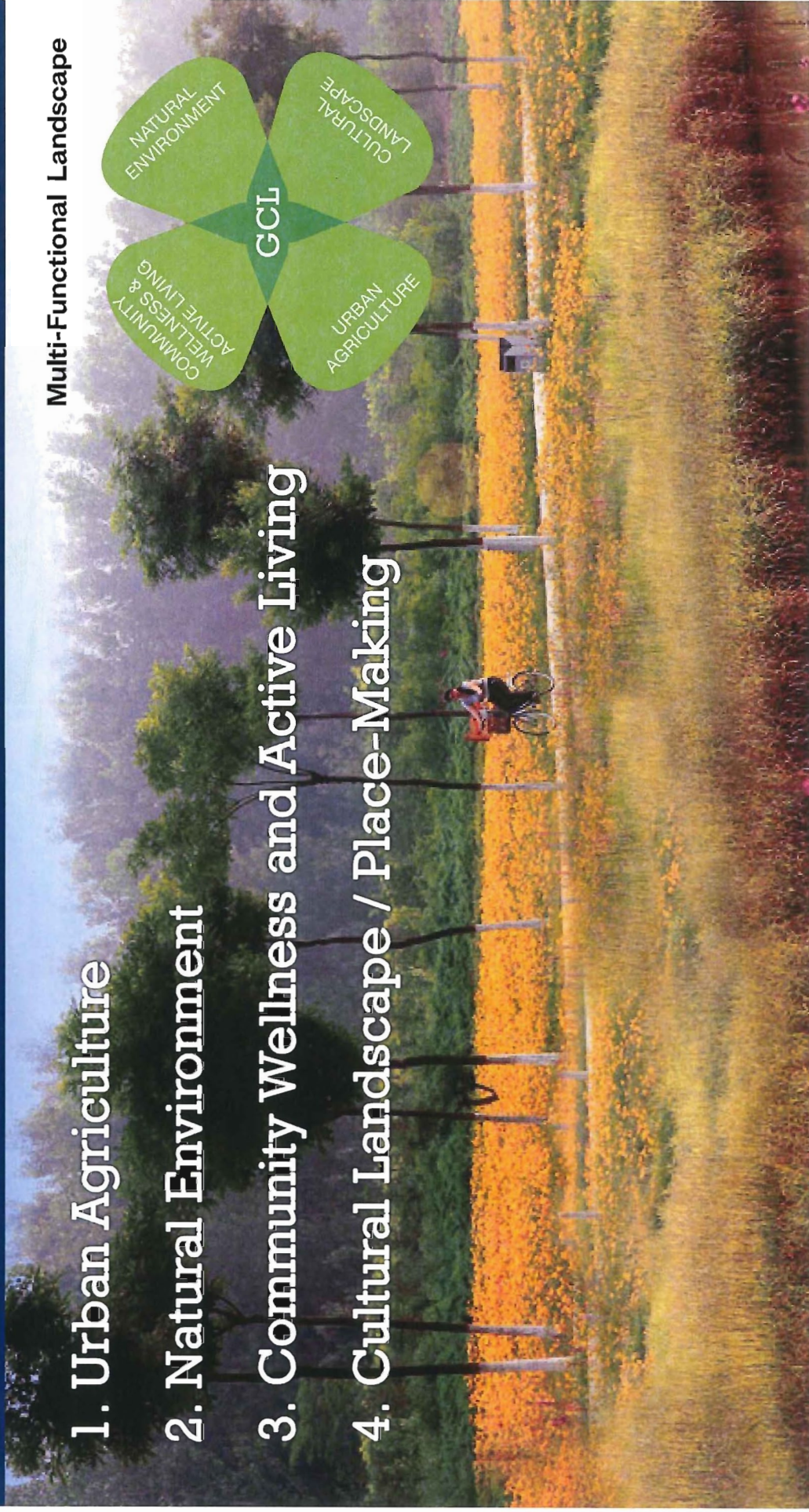

URBAN AGRICULTURE

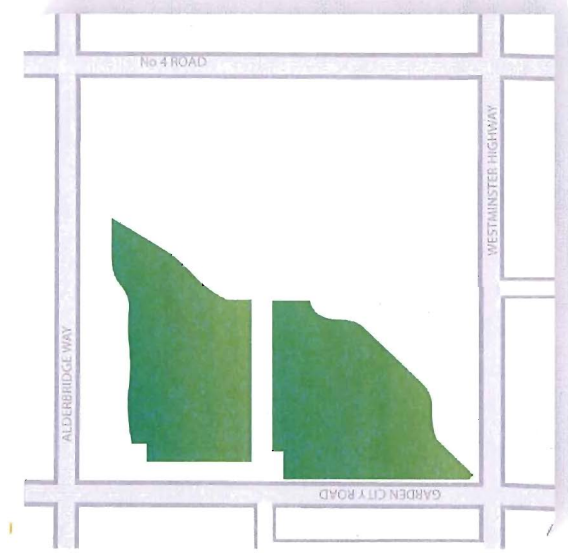
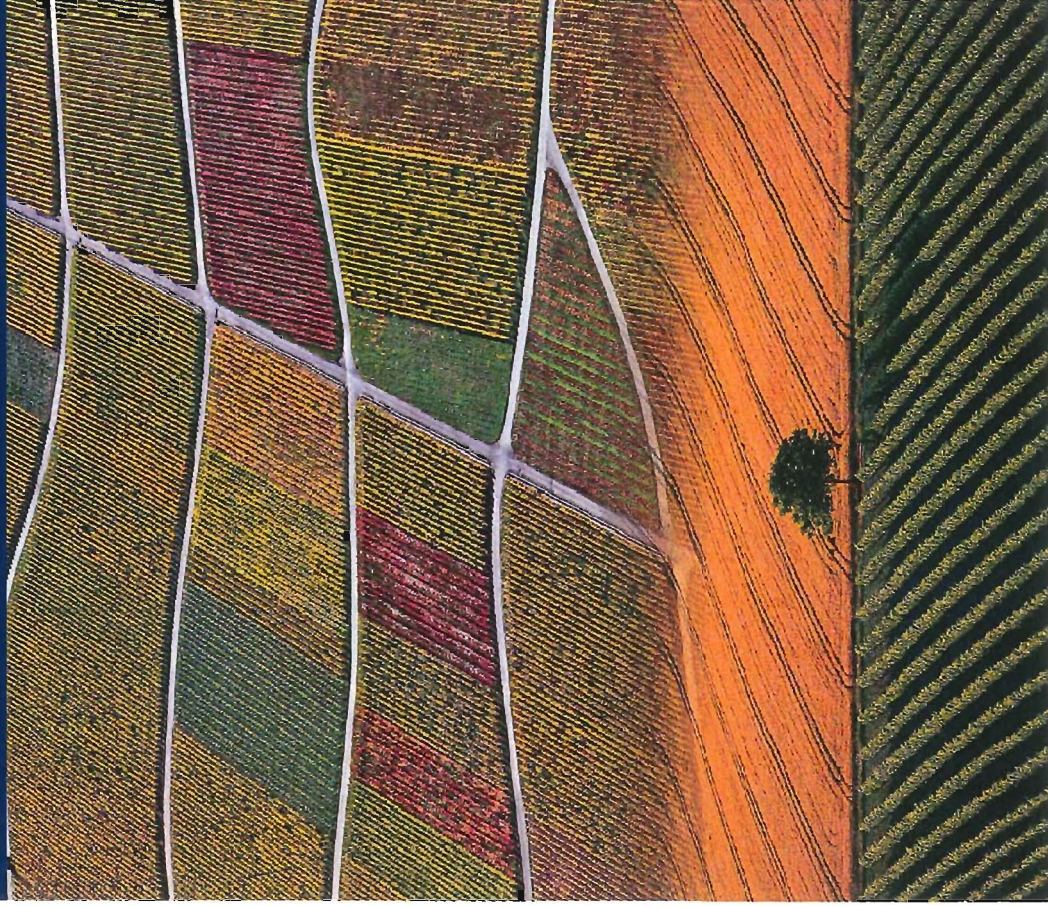

OUTCOME:

A showcase for innovative and sustainable agricultural practices with community benefits within a public park setting.

NATURAL ENVIRONMENT

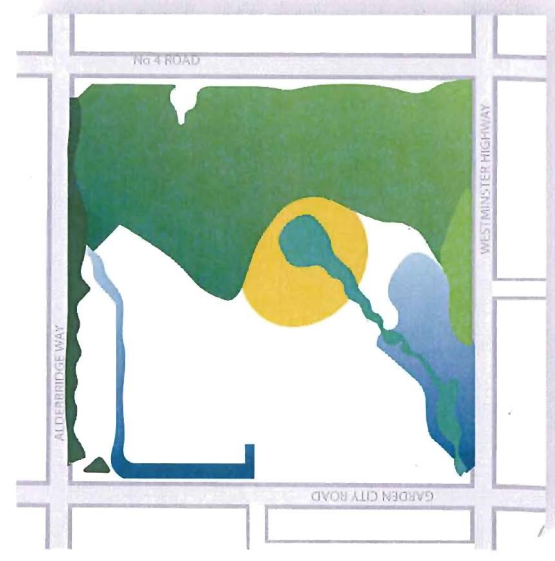

OUTCOME:

A highly valued, biologically diverse and resilient natural environment that reflects the inherent ecology of the Lands and is a vital contribution to the City's overall Ecological Network and community health.

COMMUNITY WELLNESS

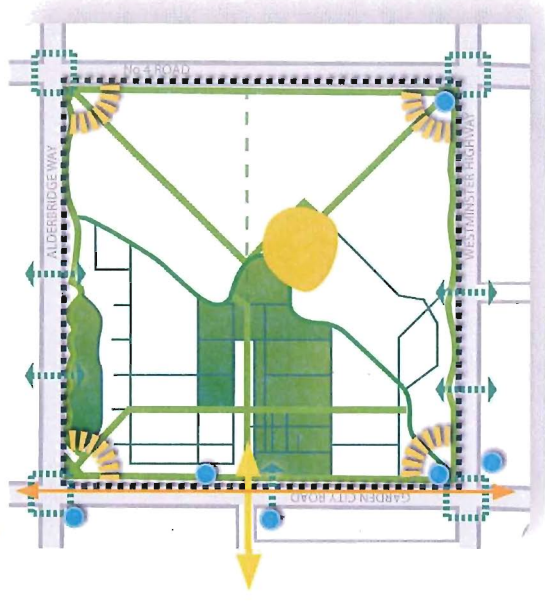

OUTCOME:

An accessible, safe and appealing public open space that promotes healthy lifestyles and community cohesiveness through a unique richness of adaptable social, environmental, agricultural and recreational amenities and programs.

CULTURAL LANDSCAPE

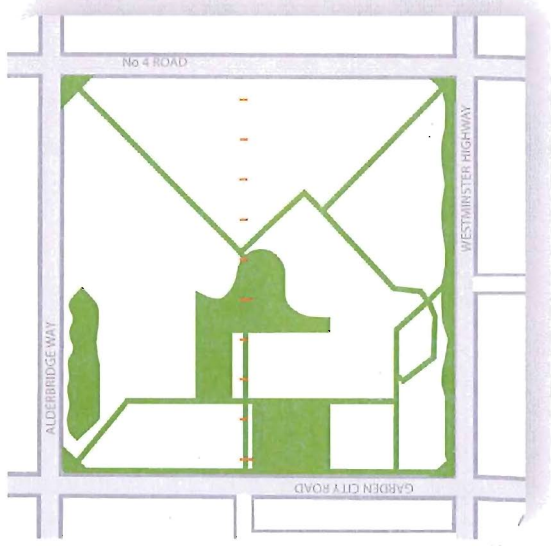

OUTCOME:

A rich and vibrant place with a distinct identity that reflects and highlights the unique characteristics of the site and generates fond memories, community pride, and a deep appreciation of the agricultural and ecological values of the Lands.

LEGACY LANDSCAPE PLAN

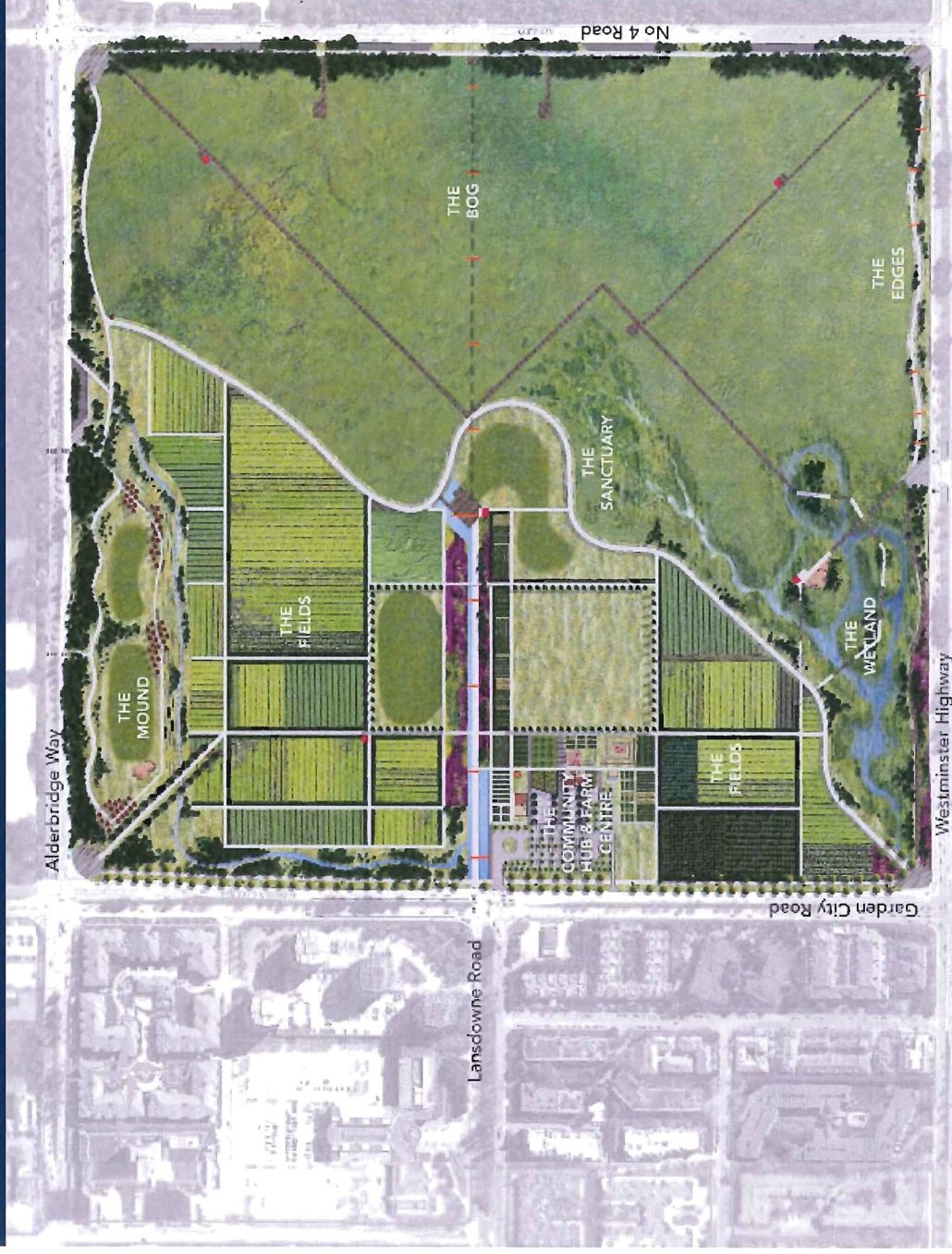

THE LEGACY PLAN

LANDSCAPE ZONES

- The Bog
- The Mound
- The Fields
- The Sanctuary
- The Wetland
- The Community Hub & Farm Centre
- The Edges

THE BOG

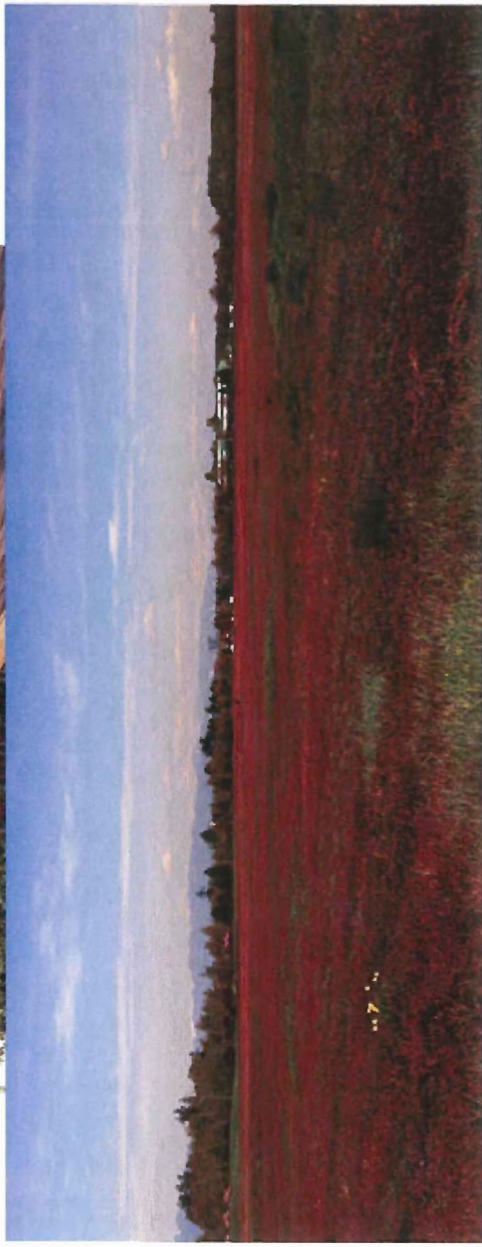
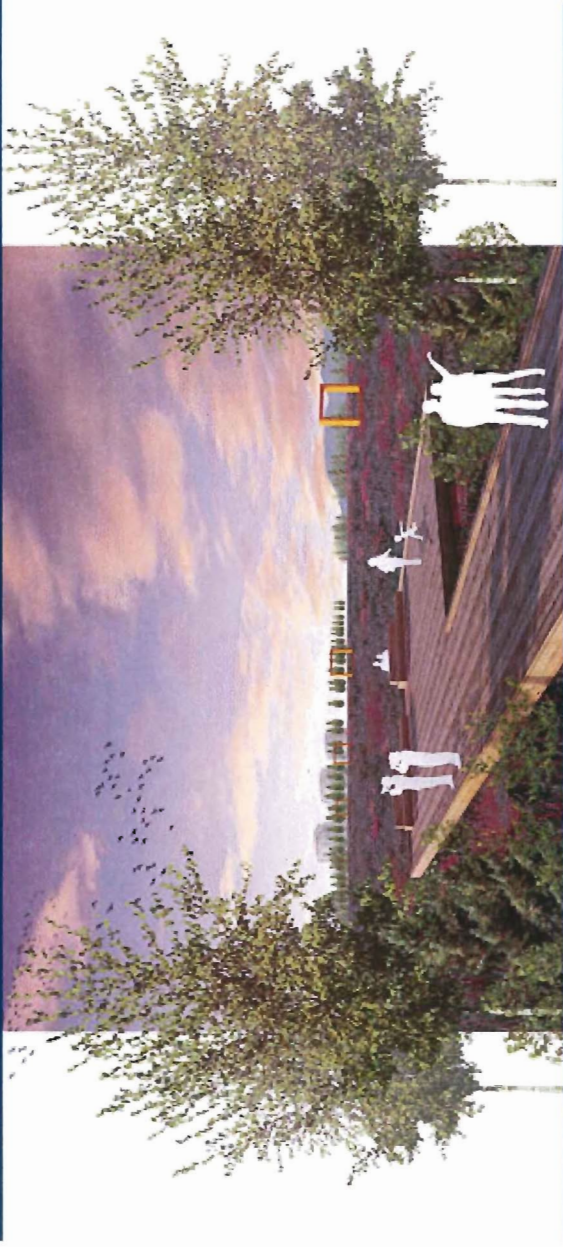

- Eastern half of site
- Raised peat bog area
- Protect as a natural area
- Protect critical bog plants
- Boardwalks, lookouts, interpretation
- Raised earth dike to protect bog

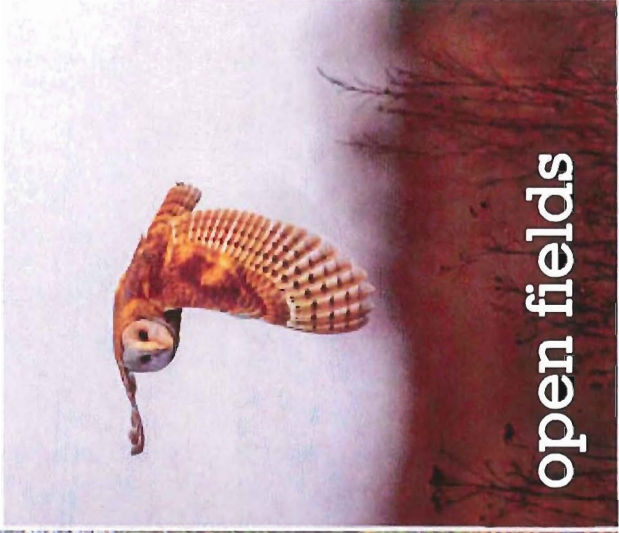

THE WETLANDS

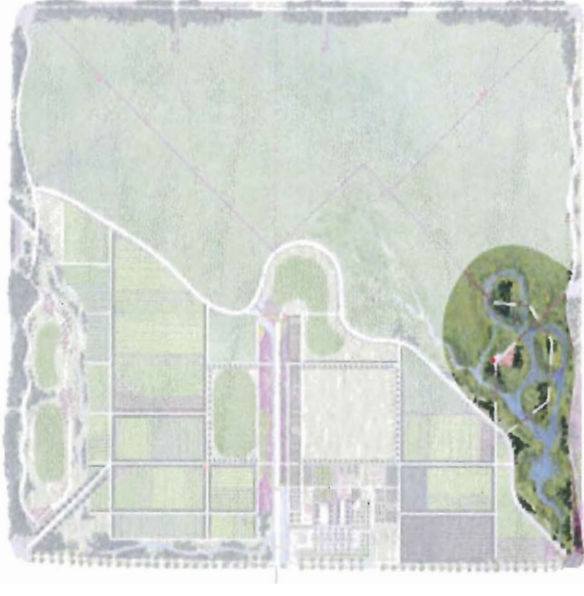

- Expansion of the bog watercourse
- Year round water
- Added biodiversity
- Potential rain & storm water retention
- Islands, lookouts, boardwalks
- Weirs to control water

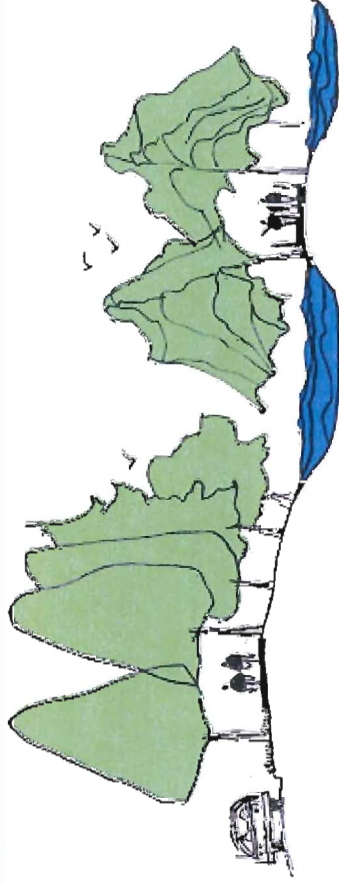

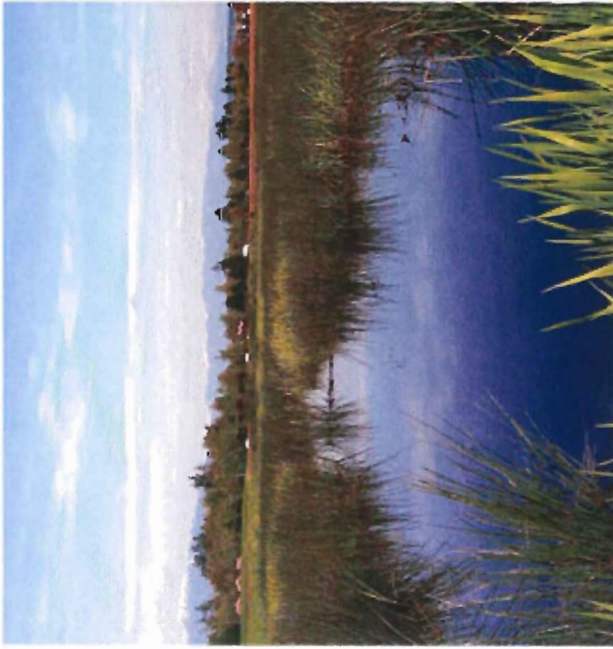
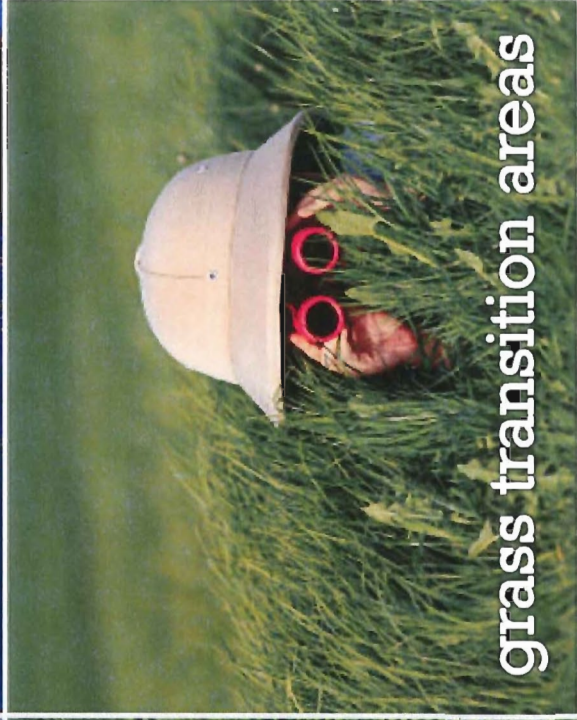

THE SANCTUARY



- Centre of the site
- Quiet respite from traffic
- Ecologically sensitive area
- Larger moss patch
- Boardwalks, lookouts and interpretation

THE FIELDS



- Central and western part of site
- Allows for cultivation of crops, horticultural plants, tree nursery, flex fields, research and education
- Fields on a north-south grid
- A range of plot sizes
- Multi-use paths
- Drainage canals, fences, hedgerows

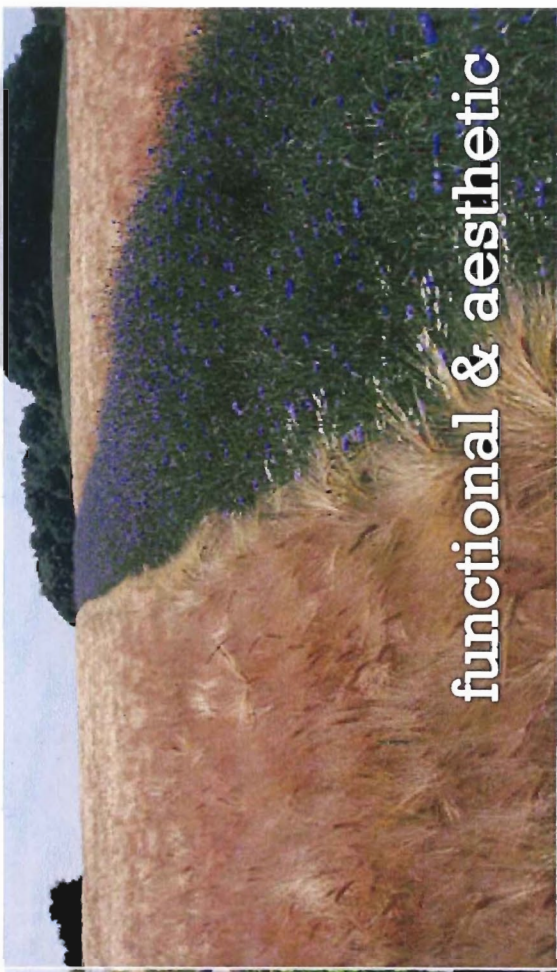

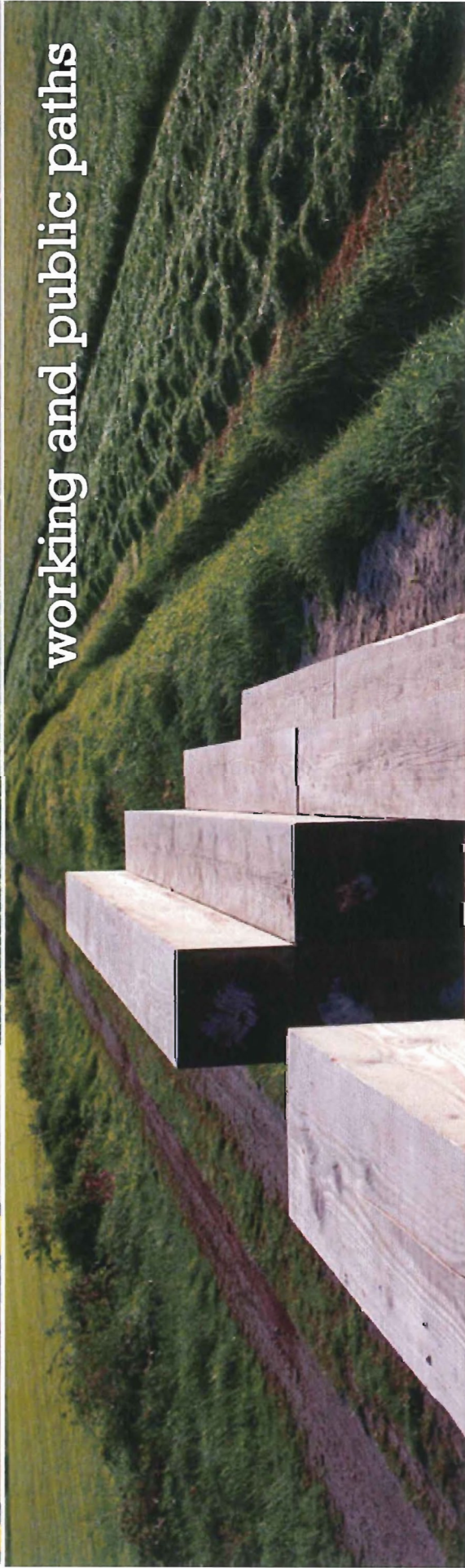

working and public paths

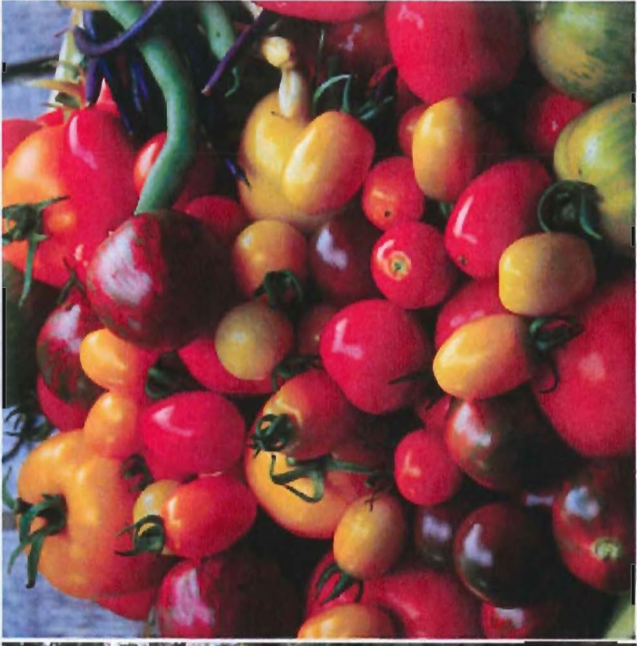

education and research



community programs



THE MOUND



- North edge along Alderbridge
- Existing landfill area
- Provides excellent views
- Flexible neighbourhood park space
- Trees area along street edge add biodiversity and a buffer zone.



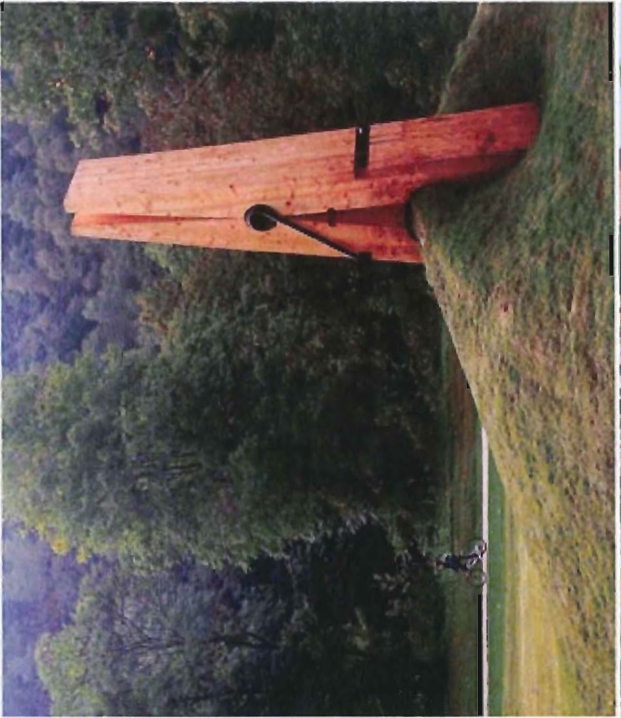
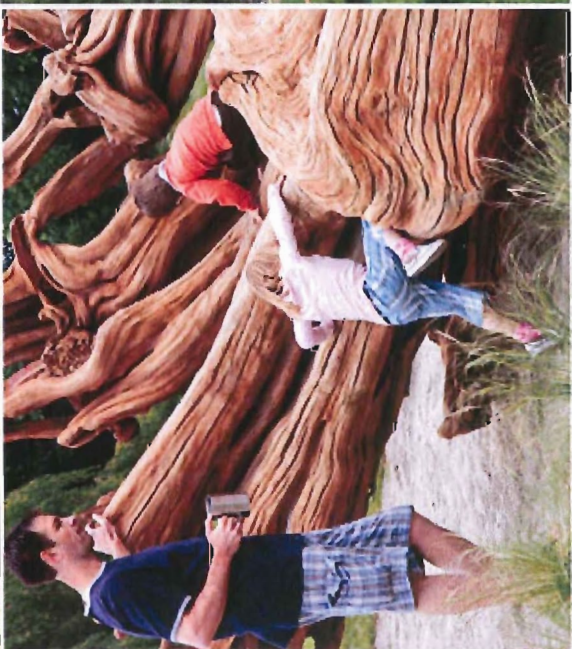

THE COMMUNITY HUB / FARM CENTRE



LEGEND

1. Orchard / Parking (500-800 seats)
2. Co-located Multifunctional Green Buildings
Welcome and Interpretation Centre,
Community Functions, Agricultural Centre
3. Informal Play
4. Event Field
5. Community Flex Plaza
6. Display Gardens
7. Picnic Orchard
8. Community Gardens
9. Demonstration Fields
10. Tree Nursery
11. Agricultural Field
12. Garden City Shared Use Greenway
13. Garden City Lands Main Entrance and
Lansdowne Terminus Water Feature
14. Agricultural Fields
15. Crosswalk and Site Entrance

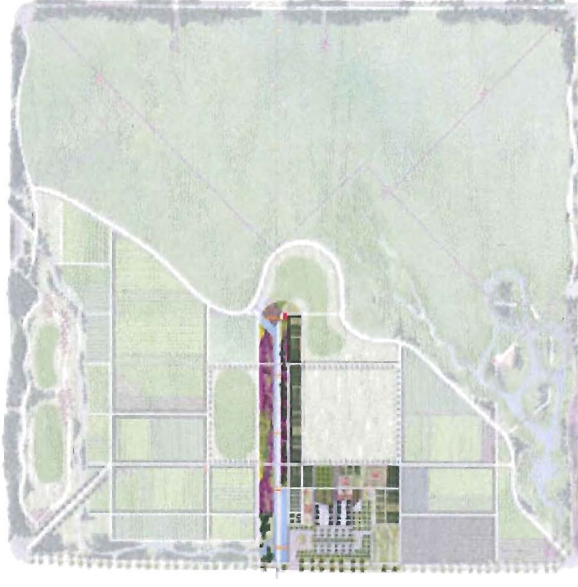

- Primary entry into site
- Connects with Lansdowne Road
- Multi-functional gathering area
- Demonstration, community gardens
- Farm produce sales
- Buildings to support farming, educational, and community uses



Garden City Road Greenway

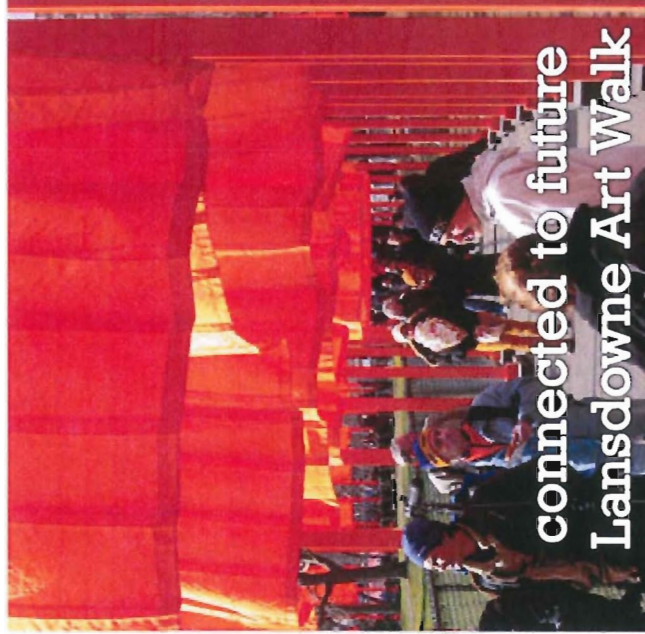

connected to future
Lansdowne Art Walk

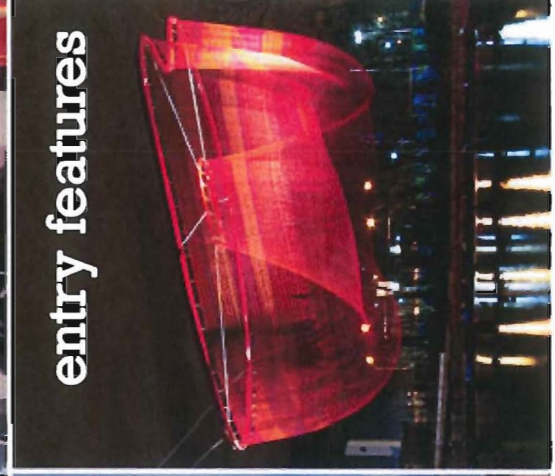

entry features



demonstration gardens



garden rooms



harvest & culinary events



community gardens

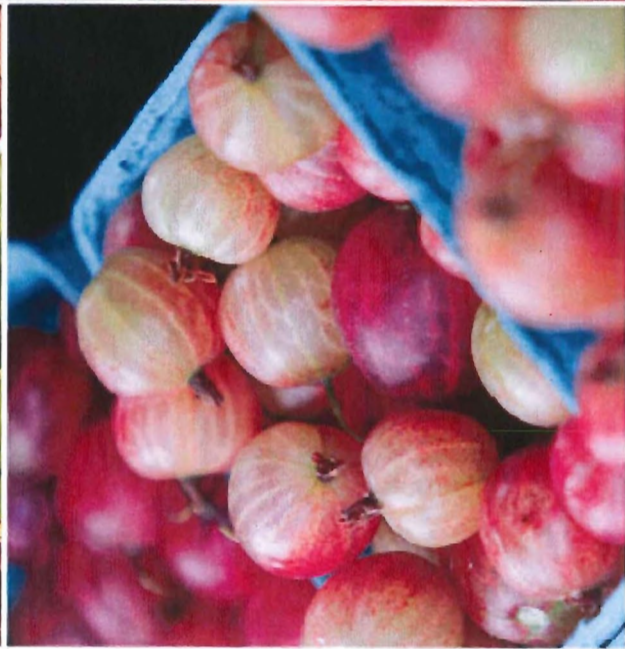

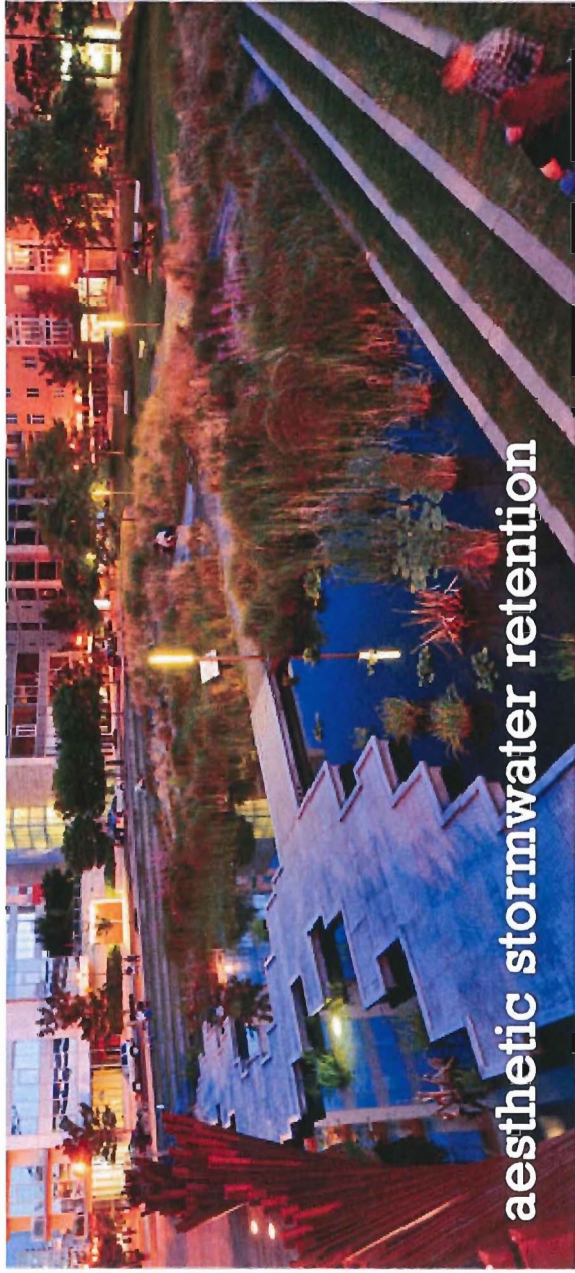

aesthetic stormwater retention

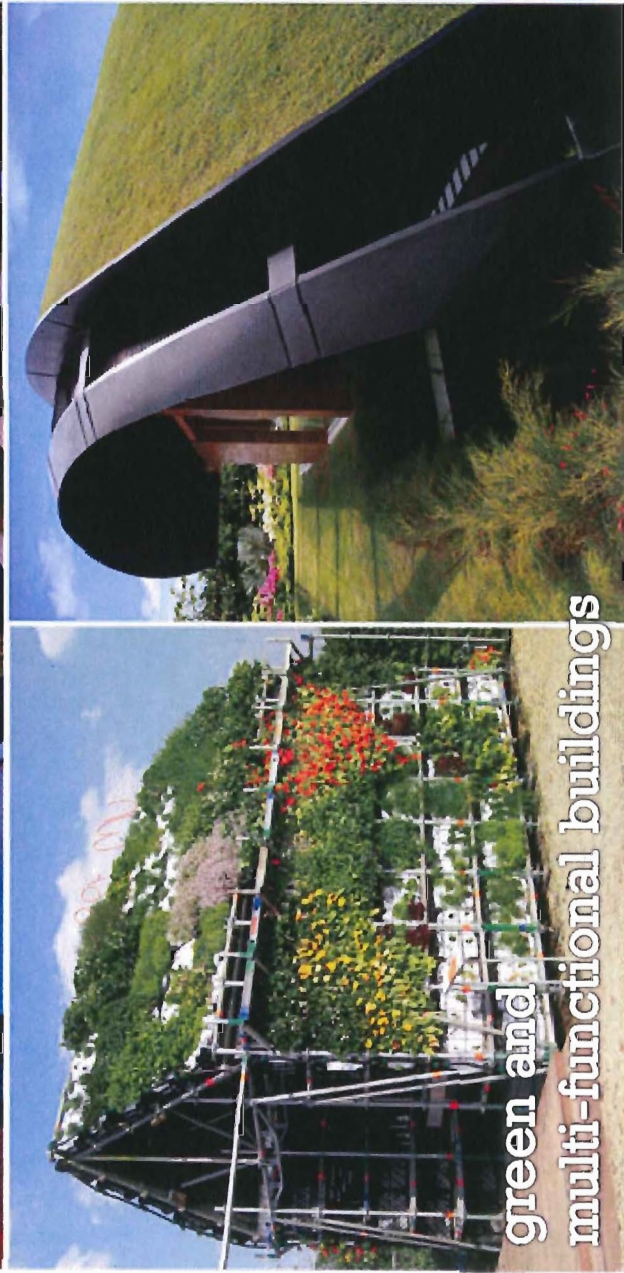
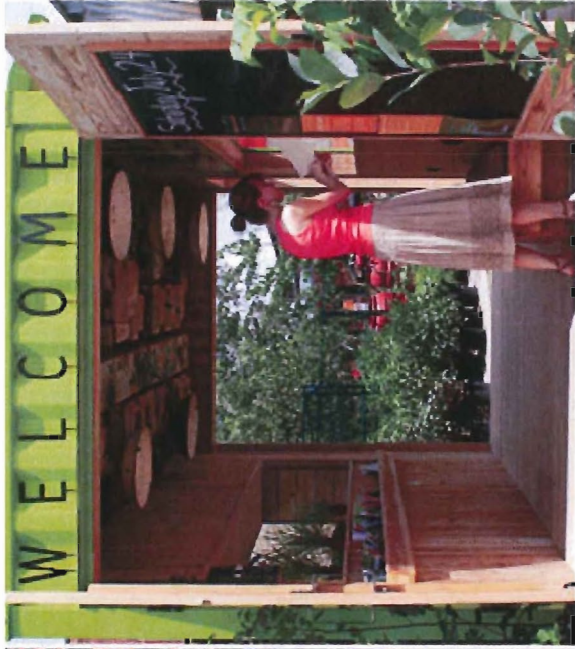

green and
multi-functional buildings



THE EDGES

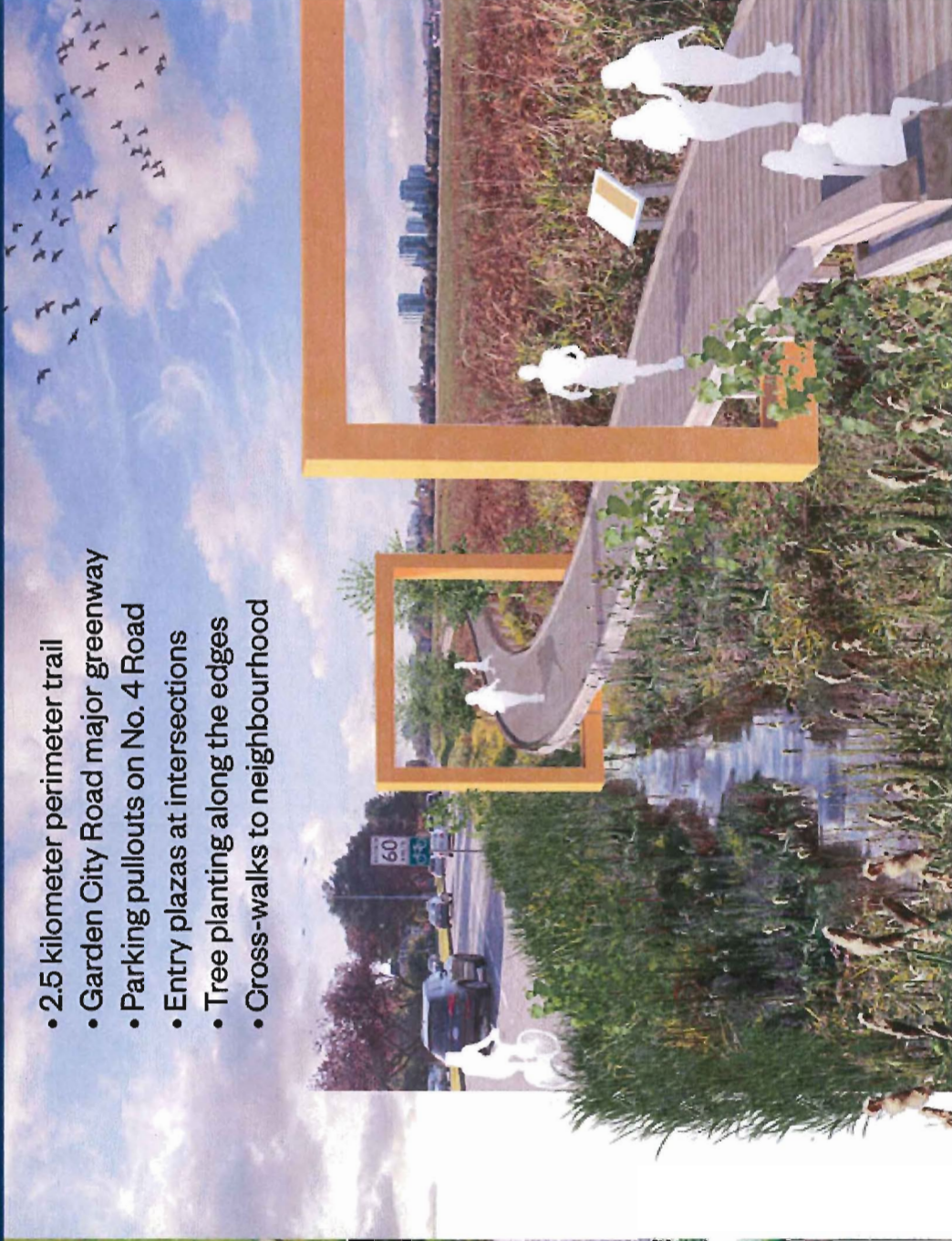

- 2.5 kilometer perimeter trail
- Garden City Road major greenway
- Parking pullouts on No. 4 Road
- Entry plazas at intersections
- Tree planting along the edges
- Cross-walks to neighbourhood

THE CULTURAL LANDSCAPE



art integrated into
the environment

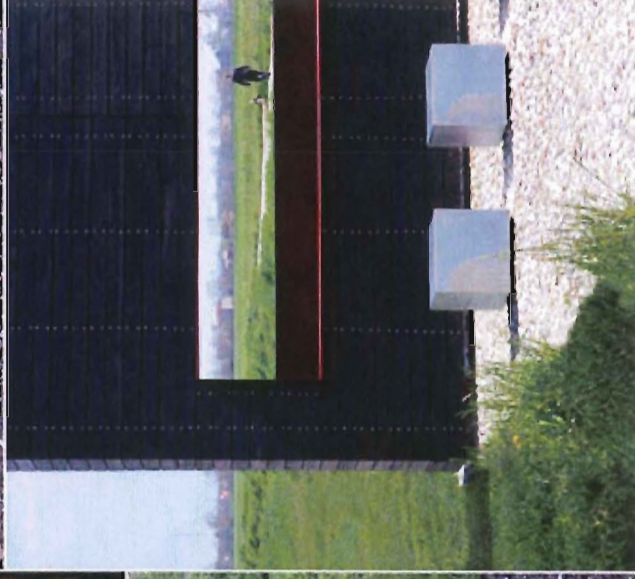



garden competitions

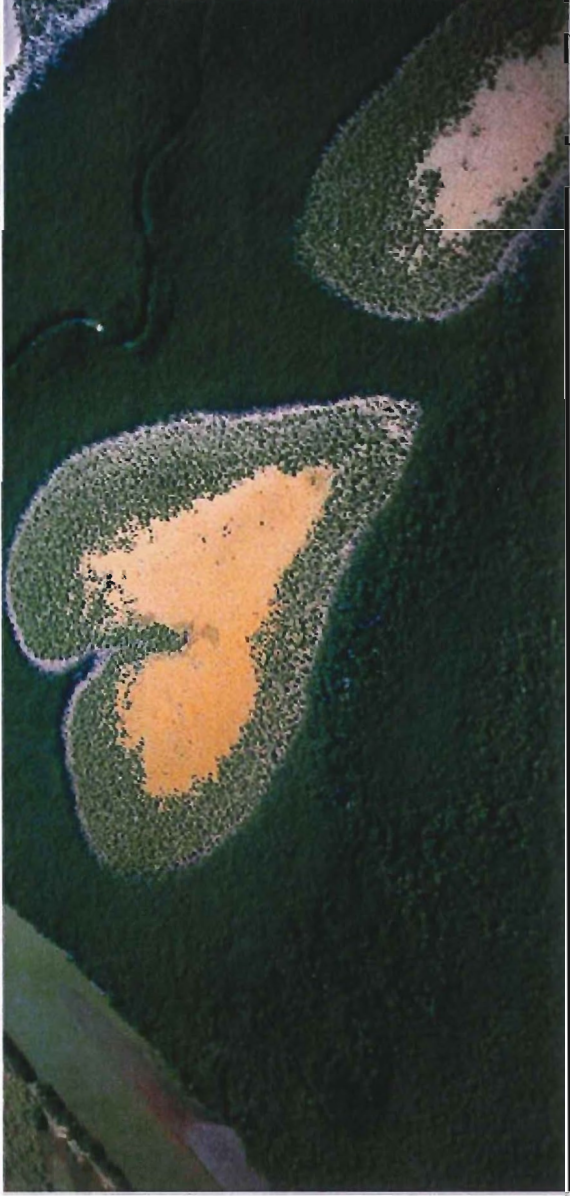

special events

KEY CONSIDERATIONS

A Long Term Perspective:

- It is a long term vision
- It has to be adaptable and flexible
- It will require an ongoing relationship with the Agricultural Land Commission
- Tread lightly and develop slowly



NEXT STEPS

- Undertaking a **detailed hydrology monitoring** and testing
- Development of a **detailed resource management plan** for the site which will include site maintenance, water management and farm management.
- Development of a **funding strategy** and multi-year implementation plan
- Preparation of phased **multi-year capital submissions**
- Development of a **partnership strategy**
- Establishing an **interpretation program** and phased programming strategy for the lands

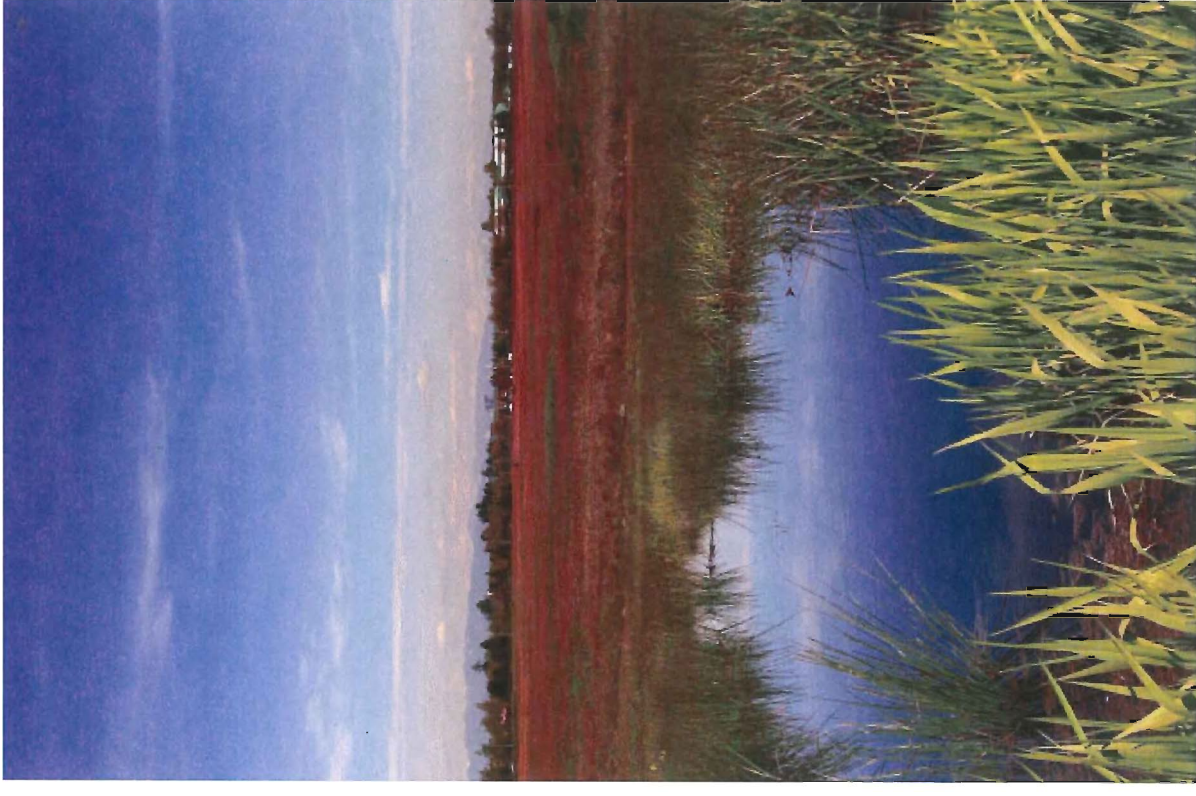

GARDEN CITY LANDS

Creating a Legacy



Councillor Steves and council members,

Garden City Conservation Society directors
Mike and Yvonne invited us to meet with them today, but we weren't able to manage it. We would have shared this with them, and now we'll share it with you too.

Garden City Conservation Society directors have come up with four improvements to recommend. For time reasons, I will mainly describe the *gaps* to fill.

We do all agree there has been further progress. Now, on to the four gaps.

First: On the Landscape Zones page (PDF page 59), we came across this image (which I've blurred for effect). There's a bulge of "Flex Field" into the bog area. I put a cutout of the bog area over the satellite image. The Flex Field includes part of the depression that enables the best sphagnum patch, which is labeled "Sphagnum bog sanctuary." The trail on the bog edge has to be a farm road with a diking role, and the construction equipment and the road's weight will affect the area. The route also needs to be well away from that sensitive spot to limit accidental damage by park users. The point is that *great* care is needed there. On the graphic, it is easy to fix, but we need to have the intent of *great* care too.

Second: Three pages into The Wetland part (PDF page 74), the plan still says "The predominant Scotch heather in the north-east corner is not native to Richmond, however, well suited to the bog environment." The heather has colonized far beyond that corner by now. After it moves into a sphagnum patch, it wipes out the sphagnum, which is the *keystone genus*. We can't have the ecosystem without the sphagnum (which we found lately is being quite resilient, but let's not press our luck). The legacy value of the bog would be lost. A decision whether to save the legacy is basic, so we recommend it be addressed now.

Third: In the Implementation part (PDF page 100), there's this: "selectively allow natural progression along the edges." There's been damage to world-class 180-degree panoramic natural views from the Garden City Lands area of the City Centre. We have a bit of a second chance because any edge trees can be planned to mitigate that loss of legacy and somewhat restore the legacy.

Fourth: The plan includes an ALR commitment that can become an ALR legacy, because the Lands are the best place in the world to celebrate it. However, that requires us to *embrace* the ALR on the Lands. The #22 and #23 fields still look like renamed areas for sports tournaments and large festivals that are not ALR uses. Also, the farmers market I heard about at an AAC meeting is not an ALR use. The future need is for a *farmgate* market, and that *is* an ALR use if half of what's sold is produced on the Lands. We recommend *celebrating the ALR* on the Lands.

TREES (PINE)

LOGEPOLE PINE (*Pinus contorta latifolia*)

Jack Pine - Black Pine

NOTE: the most commonly used name for this tree is jack pine. However this name is correctly used for *Pinus banksiana*, a close relative east of the Rockies and probably not extending into B.C.

SHORE PINE (*P. contorta contorta*) is recognized by some authorities as a closely related tree growing in poor soil or swampy ground close to the sea coast. Generally it is twisted and crooked in form with bushy, irregular limbs. In other features it very closely resembles lodgepole pine.

RANGE: A tree likely to be found almost any place in B.C. from middle mountain to sub-alpine elevations.

FORM: Under normal conditions a tall, slender tree to 18" in diameter and 100' high. The crown is narrow and rounded with the thin limbs often occurring only on the top third of the tree. Young trees are narrowly conical with regular whorls of bushy, up-pointing limbs.

BARK: Mottled, dark grey with some trees showing light brown areas. Light covering of small, loose scales.

LEAVES: 2 needles to a bundle. 1 1/2" - 2 1/2" long, and often with yellowish-green tinge.

FRUIT: A hard oval cone, spiny, and up to 2" long. Usually clustered and often hanging unopened on tree for several years.

WOOD: A straight grained, light wood, pale in color. Generally regarded as a weed species in B.C. but gradually assuming importance because of abundance and accessibility. Used largely for railway ties, mine props and fuel.

DID YOU KNOW that most burned-over forests east of the Cascades grow up in a very dense stand of lodgepole pine. This is because the cones withstand fires and later open to release their seed.

QUICK CHECK: A two-needle piné, the only one in B.C.

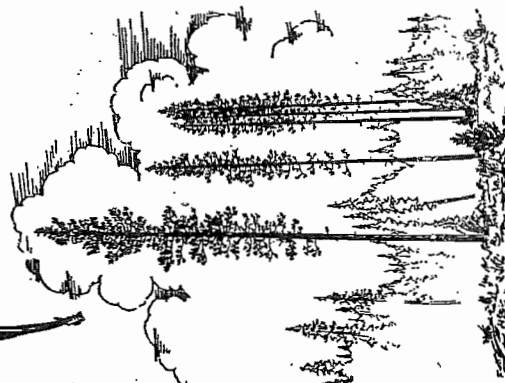
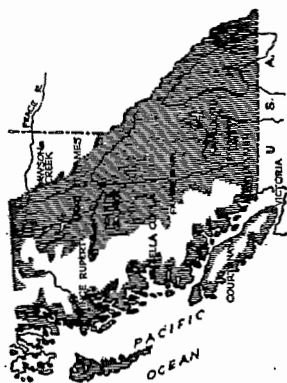

TREES (CRABAPPLE)

PACIFIC CRAB-APPLE (*Malus diversifolia*) (*Malus fusca*)

Oregon Crab-Apple

RANGE: Coastal strip of entire Province including adjacent islands. Seeks low, damp places such as stream and swamp edges where it often forms an impenetrable thicket. Common on low ocean frontage.

FORM: A small, scraggly tree to 30' high and 12" in diameter or often shrublike with a number of straight, smooth stems an inch or two thick. Very bushy when growing in the open. It doesn't carry true thorns but numerous, stout and sharp spurs an inch or two long give a realistic imitation.

BARK: Very fissured, scaly and patchy on old trunks and branches.

LEAVES: Much like those of apple trees except for tendency to produce irregular lobes and a variety of shapes. Thick, sharply toothed and with prominent veins. Mostly 2" - 3 1/2" long.

FRUIT: Clusters of white, fragrant, "apple blossoms" appear from April 15 to May 15. Followed by bunches of little, oblong apples about 1/2" long. These are first greenish in color but turn yellowish or blushed with red. They are edible but rather acid in flavor.

WOOD: Very compact and fine-grained. Sometimes used in small ornamental turnery because of toughness and brownish hue of wood.

DID YOU KNOW that beautiful autumn colors are produced from yellow and russet colored leaves?

QUICK CHECK: Wet land habitat, some lobed "apple" leaves, fragrant flowers, or clusters of small apples.

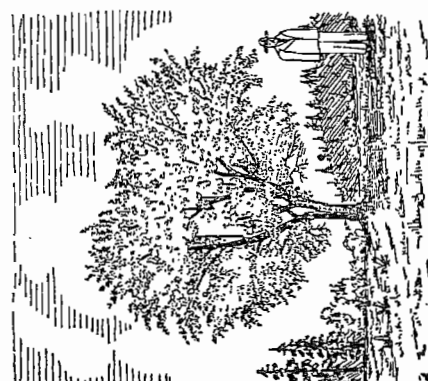
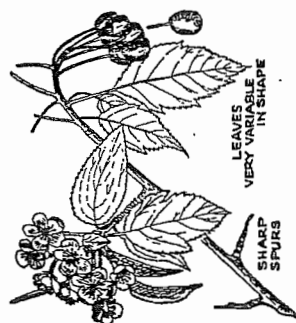
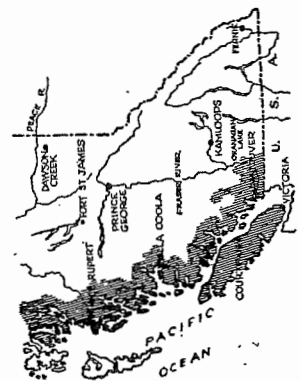

TREES (WILLOW)

★ PACIFIC WILLOW (*Salix lasiandra*)

Western Black Willow - Black Willow

PEACHLEAF WILLOW (*S. amygdaloides*) is listed in various works as a tree ranging along streams in southeastern B.C. However the writer doubts that it occurs in B.C. except in very limited localities. Its main characteristics are thin drooping branchlets and "peachlike" leaves. It can be confused easily with Pacific willow. Osoyoos Lake is one place where it is found.

RANGE: At lower elevations along stream banks and near other water sources. Extends eastward from Vancouver Island to the Kootenays but is confined to a southerly strip. Common in lower Similkameen Valley.

FORM: A crooked trunk branching into a number of upright limbs which produce a ragged, rounded outline to the crown. Seldom more than 30' high and 16" in diameter. The thin leaves and long slender twigs impart a graceful appearance.

BARK: Blackish in color and channelled into irregular, rough plates from many furrows and cross seams. The rather thick branchlets are smooth and orange to brown in color, while new twigs are light green.

LEAVES: Quite distinctive because of a long thin point with a sideways twist. From 2" - 5" long and very finely toothed. A shiny, dark green above but with a whitish pallor beneath. Leaf stems are thickish and less than 1/2" long.

FRUIT: Thick catkins about 2" long and appearing with the leaves. A bright yellow color is characteristic at maturity followed by a fuzzy white cotton often showing on the trees until July.

WOOD: Pale brown and brittle. Very soft and not used for any specific purpose.

DID YOU KNOW that the liking for water often results in long rows of these trees outlining the margins of sloughs and streams. Sections of limbs stuck in wet ground will root easily and quickly. Most willows have two small "ears" or wings at the base of their leaf stems when the leaves are young. The two willows mentioned here are regarded as the only two "tree" willows in the Province.

QUICK CHECK: A black-barked, ragged tree growing near water. Shiny, dark green leaves with a long thin point usually twisted to the side

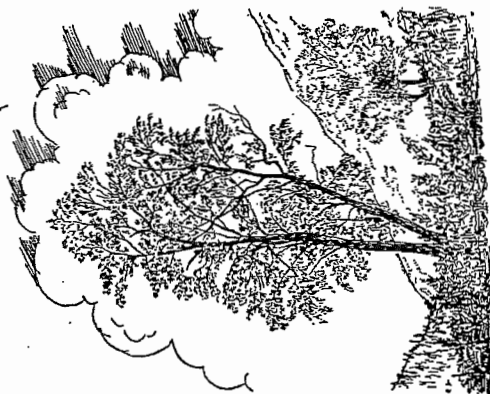
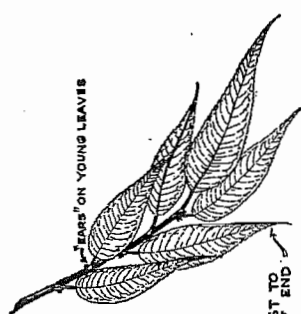
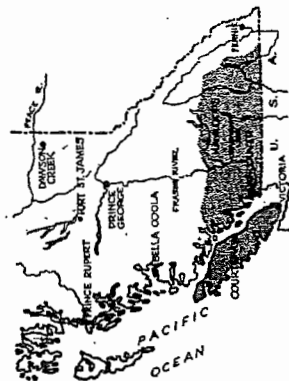

TREES (CHERRY)

BITTER CHERRY (*Prunus emarginata*)

The tree form of this cherry sometimes is distinguished as a variety, *Prunus emarginata mollis*. It is found in the wetter parts of the range and has leaves to 4" long. This book treats them as one species. Be on the watch around towns and farms for hybrid forms resulting from cross pollination with domestic trees.

WILD RED CHERRY (*P. pensylvanica*) is supposed to range westward from the Rockies to the Kootenays. However the writer doubts that this tree is found in B.C. except for a slight intrusion along the Rockies. The leaves are much longer-pointed than the above and the berries each have a stem about 1" long.

RANGE: Lower elevations on Vancouver Island, southern Coastal Zone, to 3,000' through the Wet Interior extending to sub-alpine forest zone. Common on east slopes of mountains between Grand Forks and Nelson. Ootsa Lake.

FORM: Presents a wide variation depending on type of soil and climatic factors. At the Coast it is a slender tree up to 10' in diameter and 60' high. The branches are straight and point upwards. On drier sites and at higher elevations a low crooked shrub up to 10' high may be expected. Leaves grow along the branches rather than on side twigs, thus the tree framework is quite accurately outlined.

BARK: Dirty, lightly roughened and grayish-brown in color. Marked with grayish lenticels up to 2" long.

LEAVES: On shrubby trees, they vary from 1 1/2" - 3" long but in tall trees they may be 4" long. Blunt leaf points on older leaves, sharp on new growth; fine, rounded teeth and two small knobs or glands on the stem are other features.

FRUIT: The fragrant white flowers may be seen during April and May. They form rounded clusters toward limb ends and are replaced by pea-size bright red berries of extremely bitter taste. Each berry is on a short stem about 1/2" long. These stems branch from a stouter central stem from 1/2" - 1" in length.

WOOD: A brittle, quick-rotting wood sometimes cut for fuel.

DID YOU KNOW that the cherry bark can be peeled from the tree and polished to a rich red? Indians used strips of this bark in their basket weaving to give color to their work.

QUICK CHECK: From a distance the small narrow leaves outline the limb framework. Glands on dull-pointed leaf make it the bitter cherry. Rounded clusters of white flowers (5 - 10) or bright red berries on stems about 1/2" long.

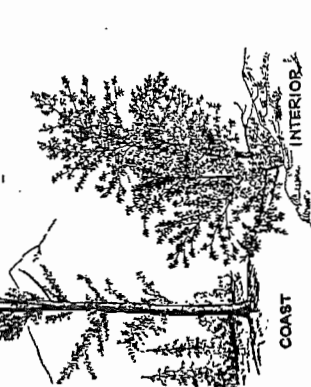
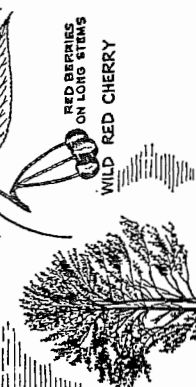
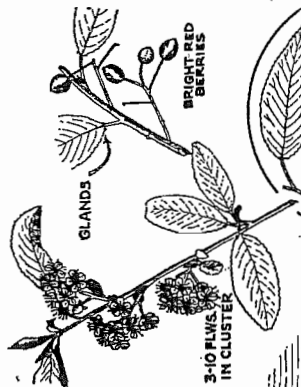
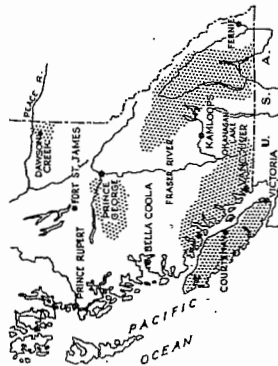



PORT METRO
vancouver

McDonald and Point Grey Tidal Marsh Projects

Proposed McDonald and Point Grey Tidal Marsh Projects

Between May 26 and June 8, 2014 Port Metro Vancouver invites you to participate in a public engagement regarding the proposed McDonald and Point Grey Tidal Marsh Projects.

The proposed projects are initiatives of Port Metro Vancouver's Habitat Enhancement Program and involve the creation of intertidal marsh habitat to benefit fish and wildlife. The proposed McDonald Tidal Marsh Project site is located on Sea Island, north of Vancouver International Airport and upstream of the mouth of the McDonald Slough. The proposed Point Grey Tidal Marsh Project site is located along the eastern portion of the Point Grey Booming Grounds, near the mouth of the North Arm Jetty of the Fraser River.

We invite you to participate by:

- Reading the Discussion Paper and submitting a Feedback Form (in print or online at **www.PortTalk.ca/HabitatEnhancement**)
- Signing up for the PortTalk web forum:
www.PortTalk.ca/HabitatEnhancement
- Providing a written submission to:
habitat.enhancement@portmetrovancover.com
- Attending a public open house:

DATE	TIME	LOCATION
Monday, June 2nd	6:00 PM- 8:00 PM	Delta Vancouver Airport, 3500 Cessna Dr, Richmond B.C.
Wednesday, June 4th	6:00 PM- 8:00 PM	UBC: Liu Institute for Global Issues, 6476 NW Marine Drive, Vancouver B.C.

Engagement materials, including the Discussion Paper and Feedback Form, will be available online on May 26. The deadline for submitting a completed feedback form or providing a written submission is June 8, 2014.

All input received during the engagement period will be compiled in an Engagement Summary Report. Port Metro Vancouver will also prepare a Consideration Memo, demonstrating how feedback will be considered by the Port. For more information, please phone **(604) 665-9066** or email **habitat.enhancement@portmetrovancover.com**.

MayorandCouncillors

TO: MAYOR & EACH
COUNCILLOR
FROM: CITY CLERK'S OFFICE

From: Port Metro Vancouver [habitat.enhancement@portmetrovancover.com]
Sent: Monday, 26 May 2014 12:10
To: MayorandCouncillors
Subject: Engagement Reminder and Habitat Enhancement Program Update
Categories: 01-0140-20-PMVA1 - Port Metro Vancouver (Vancouver Fraser Port Authority - VFPA)

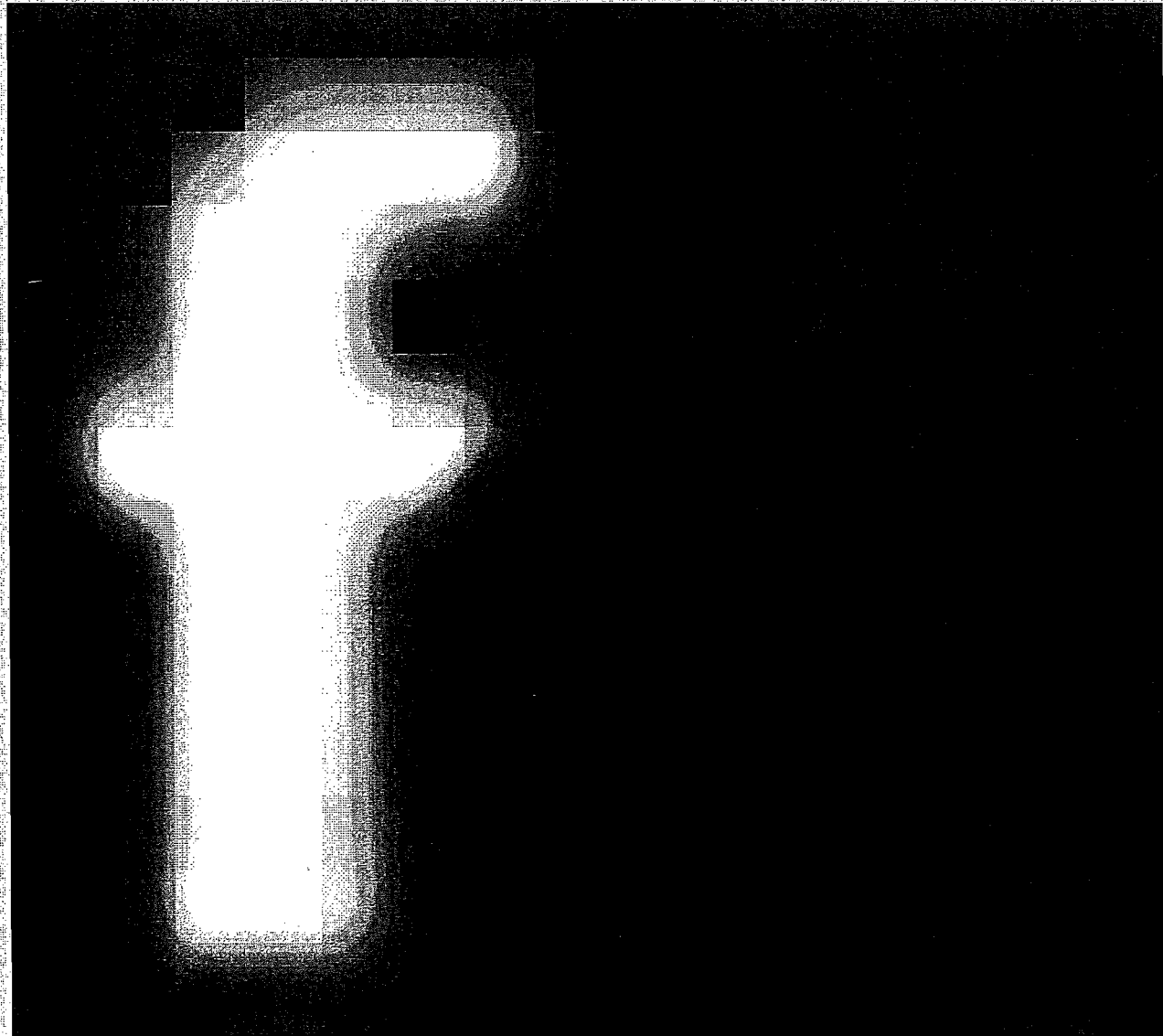

Habitat Enhancement Program Update

Public Engagement: Proposed McDonald and Point Grey Tidal Marsh Projects

Starting today (May 26th) through June 8th 2014, Port Metro Vancouver invites you to

PHOTOCOPIED

SAD

MAY 26 2014

& DISTRIBUTED

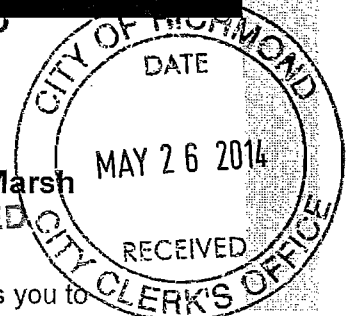

participate in a public engagement regarding the proposed McDonald and Point Grey Tidal Marsh Projects.

The proposed McDonald Tidal Marsh Project site is located on Sea Island, north of the Vancouver International Airport and upstream of the mouth of the McDonald Slough. The proposed Point Grey Tidal Marsh Project site is located along the eastern portion of the Point Grey Booming Grounds, near the mouth of the North Arm Jetty of the Fraser River.

The proposed projects are initiatives of Port Metro Vancouver's Habitat Enhancement Program and involve the creation of intertidal marsh habitat to benefit fish and wildlife.

We invite you to participate by:

- Reading the Discussion Paper and Submitting a Feedback Form (in print or online at www.PortTalk.ca/HabitatEnhancement)
- Signing up for the PortTalk web forum: www.PortTalk.ca/HabitatEnhancement
- Providing a written submission to habitat.enhancement@portmetrovancover.com
- Attending a public open house (details below)

Open House Details:

- **Monday, June 2, 2014**, 6PM - 8PM, Delta Vancouver Airport (3500 Cessna Drive, Richmond, B.C.)
- **Wednesday, June 4, 2014**, 6PM - 8PM, Liu Institute for Global Issues (University of British Columbia) (6476 NW Marine Drive, Vancouver, B.C.)

The deadline for submitting a completed Feedback Form or providing a written submission is June 8, 2014.

All input received during the engagement period will be compiled in an Engagement Summary Report. Port Metro Vancouver will also prepare a Consideration Memo, demonstrating how feedback will be considered.

For more information, please phone (604) 665-9066 or email habitat.enhancement@portmetrovancover.com.

Glenrose Tidal Marsh Project: Ongoing Construction Update

- Habitat enhancement work commenced at the Glenrose Downstream site on April 22, 2014. All work has been completed until the fish window of least risk reopens mid-June (including slope protection, perimeter berm and select pile removal). Sand infill is expected to take place near the end of June.
- Work at the Glenrose Cannery site commenced on May 5. Brushing, select pile removal and rip rap blanket construction was completed May 22. Sand infill is expected to be completed when the fish window of least risk reopens.
- Dredging for sand infill and construction of the Gunderson site is expected to take place mid-June.

Field Studies Information: June 2014

Port Metro Vancouver is continuing field studies as part of ongoing environmental and

technical work for the Habitat Enhancement Program. Information regarding field studies being undertaken in June 2014 is available in the Information Centre at www.PortTalk.ca/HabitatEnhancement.

Regards,

The Habitat Enhancement Program Team

[End your subscription](#) | [Unsubscribe](#)

PORT METRO VANCOUVER
100 The Pointe
999 Canada Place
Vancouver, BC V6C 3T4