



City of Richmond

Report to Committee

To: Parks, Recreation and Cultural Services
Committee

Date: February 25, 2013

From: Jane Fernyhough
Director, Arts, Culture and Heritage

File: 11-7000-09-20-132/Vol
01

Re: **Hugh McRoberts Secondary School Community Public Art Project**

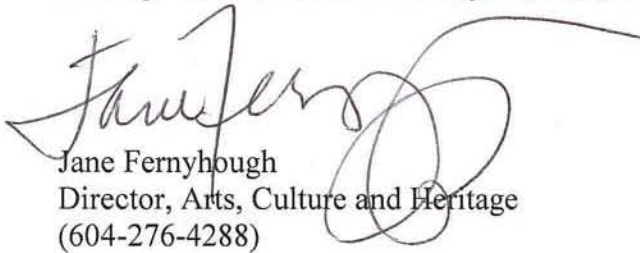

Staff Recommendation

That the concept proposal for the Hugh McRoberts Secondary School Community Public Art Project by artist Jasmine Reimer as presented in the report from the Director, Arts, Culture and Heritage Services dated February 25, 2013, be endorsed.

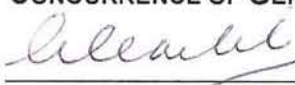

Jane Fernyhough
Director, Arts, Culture and Heritage
(604-276-4288)

Att. 4

REPORT CONCURRENCE			
ROUTED TO: Budgets	CONCURRENCE <input checked="" type="checkbox"/>	CONCURRENCE OF GENERAL MANAGER 	
		REVIEWED BY DIRECTORS	INITIALS: 

Staff Report

Origin

Through the arts, a community can explore ideas, issues and concerns, voice community identity, express historical and cultural spirit, and create dialogue. The City's Community Public Art Program creates opportunities for collaborative art projects between community groups and professional artists of all disciplines. Working with a professional artist, the community group is involved in all stages of planning and commissioning of a public art project.

This report brings forward for consideration the concept proposal jointly developed by the students of Hugh McRoberts Secondary School (HMSS) and the artist Jasmine Reimer.

This initiative is in line with Council Term Goal 9.5:

"Promote existing cultural resources and activities to increase public awareness, enhance quality of place and engage citizens across generations."

Analysis

Terms of Reference – Community Public Art Selection Process

Under the terms of the administrative procedures for community public art projects, annual calls are issued separately to community groups and to artists wishing to collaborate on artwork for public sites in Richmond. Following review and endorsement by the Public Art Advisory Committee, the Public Art Program issued two separate proposal calls on May 1, 2011, one for an expression of interest from Richmond community groups interested in collaborating with an artist, and a second for artists' expression of interest for inclusion on an artist roster for consideration in community projects. These calls were posted on the City's Public Art web page, with a deadline for submissions on June 30, 2011.

In accordance with the City Public Art Program procedures for the community program, a selection panel reviewed the portfolios of artists on the Community Public Art Roster, to match an appropriate artist with the community group. The selection panel met on February 23, 2012 and included the following members:

- Danny Chen, Artist, Canadian Artists Society
- Camilla Pickard, Writer and Educator, Emily Carr University of Art and Design
- Crystal Lan, Student, Hugh McRoberts Secondary School
- Nicole Porter, Teacher, Sponsor Lead Contact, Hugh McRoberts Secondary School

Artists were evaluated on the basis of artistic merit of past work; appropriateness to the goals of the Program including past work with community groups and with youth in particular; and artist qualifications. The panel recommended artist Jasmine Reimer of Vancouver for this project.

Recommended Public Art Project

Art students of Hugh McRoberts Secondary will participate in the project. Nicole Porter, art teacher and lead contact will coordinate in class and after school activities.

The project is proposed for an outdoor site which will be improved in the coming year (**Attachment 1**). The art project will be integrated and coordinated with the landscape design. Artist Jasmine Reimer has met with the HMSS students and teachers to understand their project, generate ideas and develop the concept (**Attachment 2**).

The art project will take the form of concrete casting benches made from school lockers (and items found within them), a significant object in the daily lives of students, and uses these castings to create places to sit, study or perform in the outdoor school plaza. Richmond School District No. 38 supports this project and has given permission to locate the artwork on school property. The District Maintenance and Operations department will continue to review the status of the project as it continues to progress.

As the site will be accessible to the community during after school hours, staff will also consult with staff and the Community Association Board at the South Arm Community Centre on the design and location of the benches.

Further information about the proposed art project (**Attachment 2**), the artists' resume (**Attachment 3**), and examples of the artist's previous community public art projects (**Attachment 4**) is provided in the attachments to this report.

Financial Impact

The Public Art Program has allocated \$15,000 for this community project from existing funds in the approved 2011 Public Art Capital Project.

Conclusion

Richmond's Community Public Art Program creates opportunities for collaborative public art projects between Richmond community groups and artists of all disciplines. The program is based on the belief that through the arts, communities can explore issues, ideas and concerns, voice community identity, express cultural spirit and create dialogue.

The Hugh McRoberts Secondary School community public art project outlined in this report embraces and explores this community's identity. This project will make use of hands-on approach to the making of public art, involving the students in all aspects of the project, from visualization through fabrication, installation and documentation. Hugh McRoberts Secondary School, Richmond School District No. 38 and the Richmond Public Art Advisory Committee have enthusiastically endorsed the public art concept.

If endorsed, the project will move into the design and fabrication phase, with implementation scheduled to be completed by Fall 2013.



Eric Fiss
Public Art Planner
(604-247-4612)

Location



Site



Outdoor area to be redeveloped

Hugh McRoberts Secondary School Public Art Concept Proposal

Artist: Jasmine Reimer

This project will animate the soon-to-be-redesigned outdoor plaza (currently paved) along the south of Hugh McRoberts Secondary School. Functional sculptural forms will provide outdoor furnishings for study, socializing, and potentially for performance.

The students strongly desire to convey details of their daily lives, and through brainstorming sessions we have developed an idea that involves taking interior imagery within the school and placing it outdoors as a part of the artwork, thus fostering a connection between the school, students, and surrounding community.

The students chose the school locker as the primary image to indicate student experience because of the amount of time spent in and around the locker areas. Incorporating used lockers as *found objects*, specifically the locker door, they will become artwork by transforming them into bench style seating. The locker door will be turned horizontal, a rubber mold will be made and then it will be cast in concrete to create a bench seat. On top of or underneath the locker door (bench seat) objects of personal or school property will be cast in place, resulting in a detailed and permanent human presence. When objects are placed under the locker/bench seats the objects become functional and supportive legs for the bench. (See concept sketches, below)

To begin the process we will select multiple locker doors, as objects for casting. To initiate this multi-phase project, I will select one locker concept. I have included six different ideas and one of several preliminary layout concepts to be included in the greater landscape design. (A final landscape design from Skala -the landscape designers- is currently in progress and therefore placement of the artwork is TBD.) With the assistance of the students, I will construct two or three durable silicone rubber molds using full-size locker doors. Once completed, the molds will be used to make multiple casts. The locker bench/sculptures will be made of high-strength (6000 psi) cast concrete in approximately 6'x12"x3" slabs; sealed for moisture protection and tinted/dyed/painted bright colors. It will be reinforced using 1/2" re-bar and supported by 2" square pipe/structural steel legs and in some cases a combination of cast and steel supports. (See construction drawings). The bench will be supported by below-grade footings at a depth appropriate for the weight and height to be determined after consultation with an engineer.

The students will select personal objects such as apples, candy bars, paper, backpacks etc...that will be secured to the surface of the real locker prior to mold making and thus, incorporated into the face of the mold. The result will be a permanently attached candy bar (etc...) cast in concrete and securely implanted on the surface of the locker. The objects will appear to *sit* on the locker/bench surface as if abandoned by the previous visitor. As a result, the sculpture takes on a complex association to the lived, student experience and reinforces the individual identity of the student and interior/exterior motif. The responsive silicone rubber mold will replicate the details of the locker door such as air vents, lock recesses and hinges uniting unique characteristics of the locker with the personal objects and thus, the identities of the students within the school.

Because the landscape design has not been determined we will start by constructing three rubber molds and complete **one** locker bench/sculpture by July 2013. (Two locker/benches if time permits) The bench can be placed onsite when completed and moved according to the landscape designers' needs. Once the landscape design has been confirmed, the students can

construct additional locker sculptures/benches in accordance with specific landscape features. Please refer to the attached materials list and budget for detailed materials and costs.

The students will be able to contribute to the project, under the supervision of the art instructors and myself, through basic metal work and mold making and casting procedures. The durable and professional molds will allow the students to repeat the process as the project continues, creating the potential for several years of student collaboration and involvement beyond July 2013.

In addition, because the rubber molds will remain as school property, the artwork/benches will be easily repaired or replaced if needed in the future. Concrete that is sealed and painted is easily cleaned and maintained. If the paint is chipped, it is simple to touch up the damaged area, as I will use paint found at the local hardware store. The painting process involves an acid-etching to ensure bondage to the concrete, primer to seal the concrete and guard against weather and then two coats of weather-proof exterior paint. I will then add an additional sealant/top coat to safeguard against harsh weather elements and potential vandalism. To deter skateboarding on the edges of the benches I will install 'Skateboard Guards', made of steel, that are designed specifically for the purpose.

In December 2012, I presented the class with rough design concepts that I thought would create a dynamic and functional public sculpture and space. Since then, as a group, we have simplified and re-designed the original concept. I envision the work as a series of six or more bench/sculptures that come together to create an outdoor, public outdoor area. My suggestion for the future space is to construct more art locker/benches and place them at intervals with regular cast concrete benches of similar design and scale resulting in a visual rhythm of color and interest. I foresee the mixture of 'regular' and 'creative' seating resulting in a lively social space where students study, eat and relax and during the summer months; and where the surrounding community can read and picnic. (See site plan rendering provided by Skala, below)

Budget overview	
Artist fee	\$3,000
Materials (molds and first sculpture)	\$3,550
Fabrication fees (first sculpture)	\$1,000
Engineer's fee (first sculpture)	\$650
Installation (first sculpture)	\$1,000
Documentation	\$300
Materials	\$4,800
Contingency	\$700
Total:	\$15,000

Workshop with students at Hugh McRoberts Secondary School



Jasmine Reimer with students learning about the techniques of art casting

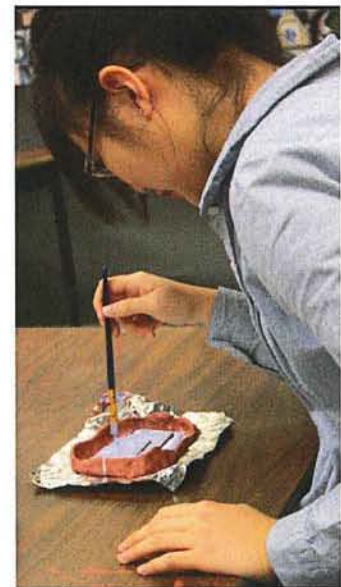

Preparing the rubber molds used in the casting process

Concepts for production:

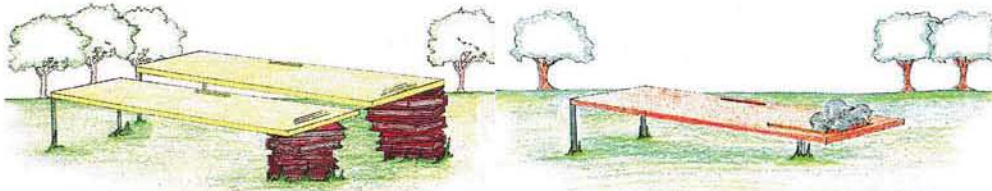

Library Locker
Locker Bench Concept
Hugh McRoberts Secondary School
Jasmine Reimer February 10th, 2013

Essay Writing
Locker Bench Concept
Hugh McRoberts Secondary School
Jasmine Reimer February 10th, 2013

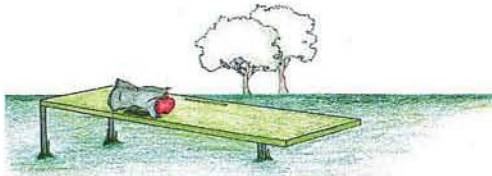

Lunch Locker
Locker Bench Concept
Hugh McRoberts Secondary School
Jasmine Reimer February 10th, 2013

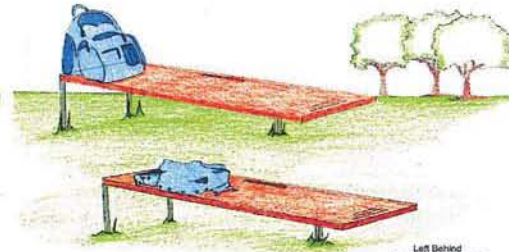

Left Behind
Locker Bench Concept
Hugh McRoberts Secondary School
Jasmine Reimer February 10th, 2013

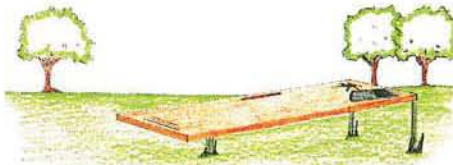

Kids and Cat House
Locker Bench Concept
Hugh McRoberts Secondary School
Jasmine Reimer February 10th, 2013



Double Define
Locker Bench Concept
Hugh McRoberts Secondary School
Jasmine Reimer February 10th, 2013

Possible future layout of benches (subject to final landscape plan by Skala)

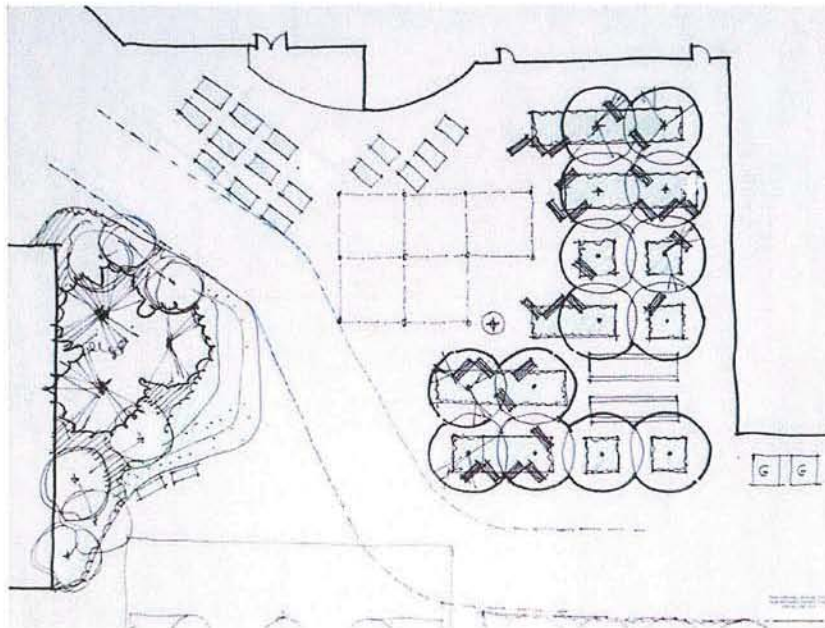

Fabrication details

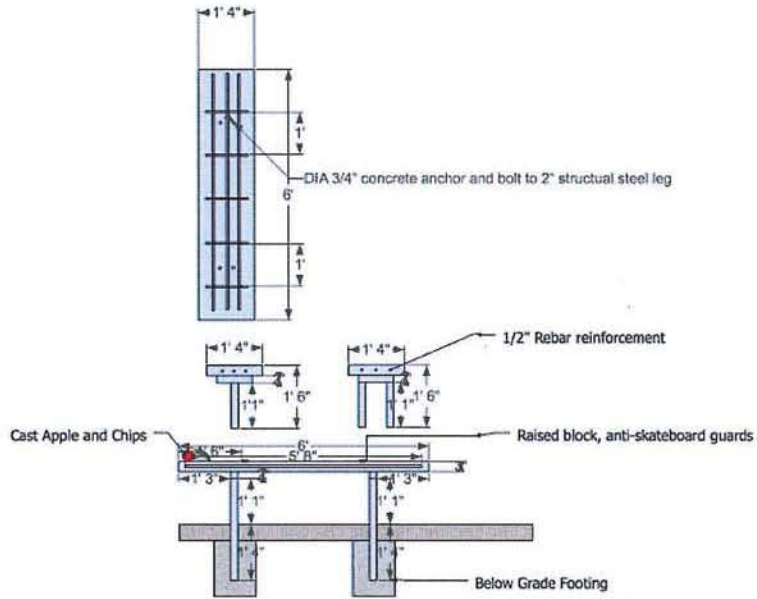

Please Note:
All benches will be constructed following this plan unless the bench has artwork installed under the bench seat. It will then follow the attached drawing titled 'Art Construction'.

Jasmine Reimer
Locker-Bench Construction Drawings
Hugh McRoberts Secondary School
February 17th, 2013

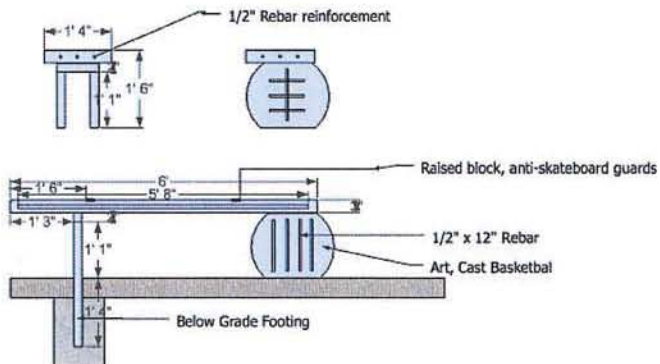
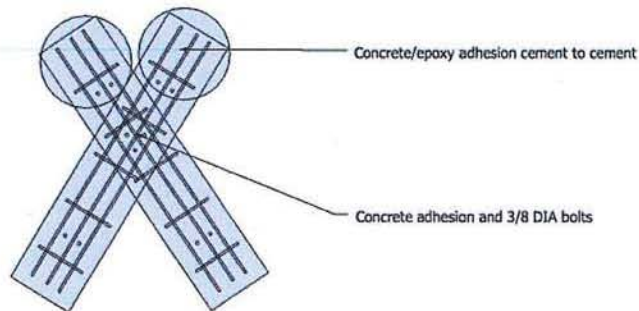

Jasmine Reimer
Art Construction Drawing
Hugh McRoberts Secondary School
February 17th, 2013

Jasmine Reimer

#312-1869 Frances St.
 Vancouver BC V5L 1Z8
 1 778 320 4712

jasmine_reimer@hotmail.com

www.jasminereimer.com

Education

2009	Emily Carr University	BFA	Vancouver BC
2007	Langara College	Diploma	Vancouver BC
2001	Grant MacEwan College	Diploma	Edmonton AB

Solo Exhibitions

2010	Kelowna Art Gallery	1000 lbs. 3 Days	Kelowna BC
	304 Days Gallery	Slump	Vancouver BC

Group Exhibitions

2010	221a Artist Run Centre	MERKIN-tile	Vancouver BC
	Point Exhibits	To Tame A Land	Vancouver BC
	W2	The Cheaper Show 9	Vancouver BC
	221a Artist Run Centre	Pact 5: Beast	Vancouver BC
2009	QE Mezzanine Gallery	In Vision	Vancouver BC
	On The Rise	Where We Start From	Vancouver BC
	Concourse Gallery	Undress	Vancouver BC
	Concourse Gallery	Interwoven	Vancouver BC
2008	Plank Gallery	Heads or Tails	Vancouver BC

Commissions/Public Work

2008	Family	Portrait Private	Vancouver BC
------	--------	------------------	--------------

Relevant Work Experience

Current	Liz Magor	Assistant to the Artist	Vancouver BC
Current	Daryl Plater Architect	Assistant	Vancouver BC
2009	Freelance	Sculpture Maintenance	Vancouver BC
	The Framing & Art Centre	Custom Framing	Vancouver BC
2008	Art For Life	Silent Auction Host	Vancouver BC
	Autumn Brook Gallery	Gallery Assistant	Vancouver BC
2006	Big River Productions	Lighting Designer	Vancouver BC
	Arts Club Theatre Co.	Artist Liaison	Vancouver BC
	Wild Excursions	Stage Manager	Vancouver BC
	Raymond Burr Theatre	Production Manager	Vancouver BC
	Langara College	AHIS Research/Admin.	Vancouver BC
		Assistant	

Grants/Awards

2009	Canadian Millennium Scholarship -(\$1000.000)
	The Vancouver Foundation –Achievement Award (\$1000.000)
2008	Canadian Millennium Scholarship - (\$1000.00)



Reimer, *Pursuit*, 2010 Fabric, Sand, Found Objects, 18 Casters
56"x 38"x 22"
Kelowna Art Gallery, Kelowna, BC



Reimer, *Pile*, 2010, Plaster, Dye, Resin, Wood 18"x12"x20"
304 Days Gallery Vancouver