



City of Richmond

Report to Committee

To: Parks, Recreation and Cultural Services Committee

Date: May 5, 2014

From: Mike Redpath
Senior Manager, Parks

File: 11-7200-20-DPAR1-01/2014-Vol 01

Re: Dog Off Leash Program Update 2014

Staff Recommendation

1. That the existing temporary fenced dog off leash area at Dover Park be relocated to the McCallan Road Right of Way/Railway Corridor and be designated as a fenced dog off leash area to be reviewed on an annual basis as detailed in the report "Dog Off Leash Program Update 2014" from the Senior Manager, Parks dated May 5, 2014.
2. That the vacant City-owned lot located at 7300 Elmbridge Way be designated as a fenced dog off leash area as detailed in the report "Dog Off Leash Program Update 2014" from the Senior Manager, Parks dated May 5, 2014 and be reviewed on an annual basis.
3. That a designated fenced dog off leash area be located on a portion of Garden City Community Park as detailed in the report "Dog Off Leash Program Update 2014" from the Senior Manager, Parks dated May 5, 2014 and be reviewed on an annual basis.
4. That a designated fenced dog off leash area be located on a portion of South Arm Community Park as detailed in the report "Dog Off Leash Program Update 2014" from the Senior Manager, Parks dated May 5, 2014 and be reviewed on an annual basis.

Mike Redpath
Senior Manager, Parks
(604-247-4942)

Att. 7

REPORT CONCURRENCE		
ROUTED TO:	CONCURRENCE	CONCURRENCE OF GENERAL MANAGER
Community Bylaws Real Estate Services	<input checked="" type="checkbox"/> <input checked="" type="checkbox"/>	
REVIEWED BY STAFF REPORT / AGENDA REVIEW SUBCOMMITTEE	INITIALS: 	APPROVED BY CAO

Staff Report

Origin

The purpose of this report is to provide an update on the current city wide Dog Off Leash program and to recommend designated areas for program expansion. This report directly relates to the following 2011-2014 Council Term Goal #10 Community Wellness:

10.4 Continued emphasis on the development of City's parks and trails systems.

Analysis

Background

On March 1, 1999, the City of Richmond commenced the designated Dog Off Leash program, currently there are seven designated off leash sites across the City and one pilot site. The following areas are currently designated as off leash areas for dogs in Richmond:

- Shell Road Trail;
- Horseshoe Slough Trails;
- McDonald Beach Park;
- Cambie Field (former Cambie School on Brown Road);
- Dyke Trail (South foot of No. 3 Road to Finn Slough);
- Vacant lot east of Highway 91 (Secret Park) in the Hamilton Area;
- Steveston Park (fenced off leash area); and
- Dover Park (pilot fenced off leash area).

With increased growth in Richmond's population, and approximately 5200 licensed dogs, there has been an increased demand for dog off leash areas where residents can exercise their pets off leash responsibly. For example, in the City Centre, and in established residential areas within a minimum of 800 metres of residential properties, as per the park distribution standard in the Council approved 2022 Parks and Open Space Strategy. Since the inception of the Dog Off Leash program in Richmond, the popularity of the designated off leash areas has grown.

The success of a fenced dog off leash area at Steveston Park has set a precedent and is a model for future program expansion. In addition, dog off leash areas continue to provide opportunities for outdoor social gathering and to get to know their neighbours, while encouraging responsible pet ownership. The designated off leash areas continue to allow for targeted enforcement of dogs running at large in non off leash areas.

Strategic expansion and monitoring of the Dog Off Leash program continues to provide for more equitable city-wide distribution and access for owners to responsibly exercise their dogs off leash in public spaces. The Dog Off Leash program supports the following key objectives of the Council approved Parks and Open Space Strategy:

Diversity and Multi-Functionality:

- *The system provides a variety of diverse open spaces that are flexible and able to respond to changes and community need.*
- *Community objectives are met while the finite resource of park land and public open space are protected.*

Health and Wellness

- *Residents of every neighbourhood have equal access to safe, appealing outdoor places to engage in healthy active lifestyles.*
- *The diverse range of interests of the community is reflected in the range of spaces and programs offered.*

Dover Park Pilot Project Program Evaluation

In March 2013, Council endorsed the implementation of a fenced area, nine month, pilot Dog Off Leash program at Dover Neighbourhood Park. This area was established to address the need for a dog off leash park in the area. The Dover Park pilot off leash site was installed in response to requests from residents in the area, as well as the recommendation in the 2009 Dogs in Parks Task Force report to “consider fenced off leash areas in locations throughout the City.”

A nine month pilot fenced Dog Off Leash program at Dover Park was established in August 2013. The Dover Park off leash area has been observed to be actively used by residents in the early morning, lunch hour, and in the evenings on both weekdays and weekends. Throughout the pilot program, staff have received written and oral feedback from residents, monitored the use of the park, and met with some of the residents of the Dover Crossing Neighbourhood who requested removal of the dog off leash designation (and circulated a petition).

Feedback received has been reviewed by staff and the following is a brief summary of written comments (58 written comments received, 32 positive and 26 negative):

- “The off leash area is unsightly to look at, the chain link fence is an eye sore;
- Fabulous new dog off leash area, my dog and I have always had to get in a car and drive to other areas to be off leash;
- Takes up too much space in the park;
- Love the park and the appreciate the contained area;
- Lots of my neighbours use it and we love it; and
- The extra noise created is a disturbance to the residents in the area.”

In addition to the written feedback detailed above, staff also received two petitions from the residents who live in the strata buildings surrounding Dover Park; one in support with 39 signatures collected (Attachment 1) and one in opposition with 167 signatures collected (Attachment 2). The two petitions present a clear division of opinion from “keep the off leash area” to “relocate and remove the off leash area,” based on specific concerns:

- The appearance of the dog off leash fence and benches;
- Noise from the animals barking;

- Impact to the site open space; and
- The lack of parking for residents and visitors to the area.

Dover Park Dog Off Leash Options for Consideration

Option One (Not Recommended): Maintain existing pilot fenced Dog Off Leash program at Dover Park

Staff do not recommend maintaining the temporary fenced Dog Off Leash program at the existing location within Dover Park given the high amount of public feedback received in opposition.

Option Two (Not Recommended): Relocate the fenced dog off leash area within Dover Park for an additional one year pilot

In an attempt to meet the demonstrated neighbourhood need for an area at Dover Park where residents can responsibly exercise their dogs off leash, and to ameliorate some of the concerns expressed, staff explored the option of moving the off leash usage to another area within Dover Park. This option is not recommended as it would only displace the reported resident complaints and concerns from one part of the park to another.

Option Three (Not Recommended): Relocate the Dover Park fenced dog off leash area to an alternate neighbourhood park site

This option would remedy the concerns identified by the Dover Park area residents who are opposed to the fenced dog off leash site and would eliminate the opportunity for residents in the area who support the fenced dog off leash site to have access. Staff have received suggestions from residents, who are opposed to the existing Dover Park fenced dog off leash site, and would like it relocated to a different park. The following sites have been suggested:

- Greenway along River Road at Barnard Drive in Terra Nova – Not recommended due to the limited space available.
- Spul'u'Kwucks School Neighbourhood Park – This is a school site, it would not be recommended.
- Blair/Burnett School Neighbourhood Park – This is a school site, it would not be recommended.
- Morris Park – This site is over 1.5 kilometers away from the Dover Crossing neighbourhood and given the distance is not a suitable relocation site.

Option Four (Recommended): Remove the designation at Dover Park and relocate the dog off leash designation to the McCallan Right of Way along the Railway Corridor as a one year pilot fenced dog off leash area and review the new location in one year.

This option would eliminate the close access for neighbours using the Dover Park site, but is within 600 meters of the existing Dover Park. It would support those residents in opposition to

the off leash area and would provide an options for those residents who were in support of maintaining a fenced dog off leash location at Dover Park, Attachment 3.

Dog Off Leash Program Expansion 2014-2015

With the increased growth of the City of Richmond's population, there has been an increase in requests for additional fenced dog off leash areas within the City Centre area and throughout Richmond where responsible pet owners can take their dogs to exercise off leash.

In October 2013, Council approved the Capstan Village Park design (Attachment 4) which includes a designated fenced dog off leash site. This park is located within the City Centre area, off of Cambie Road, and is scheduled to be open by summer 2015.

Proposed Program Expansion 2014:

In response to public requests for additional, neighbourhood off leash sites, three potential pilot sites have been identified to expand the current program in 2014:

- City-owned vacant lot at 7300 Elbridge Way (Attachment 5).
- Garden City Community Park located at 9351 Granville Avenue (Attachment 6).
- South Arm Community Park at 9020 Williams Road (Attachment 8).

The three temporary dog fenced sites will:

- Provide an off leash opportunity where access to a site within walking distance of the existing neighbourhoods does not exist today (e.g., within 800 metres).
- Not be in conflict with wildlife or natural areas;
- Support the Council approved 2022 Parks and Open Space Strategy goals of providing open spaces that are multifunctional and diverse; and
- Be reviewed on a regular basis to monitor usage, and for any other negative impacts to the sites.

It is proposed that a one year pilot Dog Off Leash program for the three sites detailed above be implemented commencing in the Summer of 2014. The proposed pilot monitoring period would allow for time to ensure park users and local area residents experience the site in multiple seasons.

Financial Impact

This report proposes the relocation of the existing Dover Park dog off leash area to pilot dog off leash area at McCallan Road Right of Way/Railway Corridor and the establishment of three new pilot dog off leash areas. The estimated costs for signage installation, temporary benches, and fencing rental at these sites are \$5000 total and, if approved, would be funded within the existing Parks operational budget.

Conclusion

Since the inception of Richmond's formal Dog Off Leash program in 1999, the City has been proactive in addressing community concerns while continuing to expand and refining the designated

dog off leash area program within Richmond's public open spaces. The privilege of being able to access safe and accessible off leash areas is valued by dog owners and also welcomed traditionally by non dog owners as the program provides certainty to the community as to where responsible dog off leash use is permitted. Continued monitoring is necessary to ensure that the program is meeting community needs as well as ensuring that Richmond's parks provide a range of both multifunctional and diverse programs for all.



Dee Bowley-Cowan
Acting Manager, Parks Programs
(604-244-1275)

- Att. 1: Resident Petition – In Support of Dover Park Pilot Program
- 2: Resident Petition – In Opposition of Dover Park Pilot Program
- 3: Site Map – McCallan Road Right of Way Dog Pilot Off Leash Site
- 4: Site Map – Capstan Village Dog Pilot Off Leash Site
- 5: Site Map – 7300 Elmbridge Way Pilot Dog Off Leash Site
- 6: Site Map – Garden City Community Park Pilot Dog Off Leash Site
- 7: Site Map – South Arm Neighbourhood Park Pilot Dog Off Leash Site

Resident Petition In Support Of Dover Park Pilot Program

NAME	EMAIL	PHONE (optional)
Yvonne	yvonne128@hotmail.com	
Sally H	sleepy_zali@hotmail.com	
Derek S	sotraggy@hotmail.com	
Tony Wong	tonywong@planetee.com	604 351 7018
ANNIE LIN	aniani_0@hotmail.com	604 220 2211
Lizzy	lizzyburgas@hotmail.com	
Dean Hartford	draftbr@hotmail.com	778 230 5014
Kory CRESTA	KoryCRESTA@shaw.ca	778-228-0889
Amily	wuyijingjing@hotmail.com	607-7819078
Rachel	csy-y@hotmail.com	278-628-8188
Jay	jean.kon@hotmail.com	278-891-8156
Niha	ninaalba000@yahoo.com	
Will	bonazangwill@gmail.com	
RAYMOND MORRETTI	SYLVESTERBATT001@hotmail.com	604-7670613
Kris Porter	KrisPorter@shaw.ca	604 828 4890
Gail M	gail.montague@telus.net	
Esther White	esmyers@telus.net	604-275-9895
Ethun Yapp	ethunyapp@hotmail.com	
Karen Yapp	yeckenkarenlos@hotmail.com	
Kajsa Gault	kmzarry@hotmail.com	
Paul Anderson	Linton1968@yahoo.com	604-671-9108
KATHERINE KIM	kbkkim@hotmail.com	
Trish	Harley.Mail.2011@gmail.com	
GAVIN	gavin02@gmail.com	
Maggie	mengj@sd38.bc.ca	
Aaron S	mybrunothedog@hotmail.com	604-644-1476
Carol Chen	carol.yuu@hotmail.com	778-869 7562
Michael Lam	mlam2107@gmail.com	604-218-0710
Belle Chen	belle-yuki@hotmail.com	778-885-7562
Darlene Howe	7420140000 darhowe@telus.net	604 274 4893
Bonnie Milby	bonnie1962umel@gmail.com	604 679-9555
ALLAN HANSON	allanhanson@shaw.ca	604-899-4437
BARRY WEAVER	bjweaver@live.ca	604-441-1257

Resident Petition In Opposition Of Dover Park Pilot Program

PETITION

TO: The City of Richmond

DATE: August/September 2013

WHEREAS The City of Richmond has erected a chain-link fence in Dover Park and designated that enclosed area as A Pilot Project Off-Leash Park for at least a period of nine months, and whereas the City of Richmond did not seek the agreement of the residents of Dover Crescent, (a residential area), we request that the off-leash area be re-located to another area of the City. Reasons for this request include:

- NOISE - dogs barking
- PARKING - non-resident dog owners using Dover Cres. parking
- APPEARANCE - a large dog pen undermines the look of the park

WE the undersigned petition the City of Richmond as follows: -

Request that the City of Richmond remove the chain-link fence erected in Dover Park and re-locate the Pilot Project Off-Leash Park to another area of Richmond. We request this happen as quickly as possible.

Name (printed)	Address (printed)	Signature
VERA ADAMSON	104 5860 DOVER CR RICHMOND BC	Vera Adamson
Denis Livolsi	316 5860 Dover Cr. Richmond BC	D Livolsi
Angela Livolsi	5860 # 316 Dover Cr Rmd, BC	Angela Livolsi
P. SCHNEEBERGER	505-5860 Dover Cr. Richmond B.C.	P. Schneeburger
Stansford	216-5860 Dover Cres	Stansford
GEORGE HANSFORD	"	Stansford
Susan Webb	501-5860 Dover Cres	S M Webb

Shartene Mooney	#408-5860 Dover Cr Richmond, BC	S. Mooney
Ch. Mooney	1 2 2	C. MOONEY
Yanne W	#103-5860 Dover Cr Richmond, B.C.	[Signature]
Fumihisa Furuya	#103-5860 Dover Cr Richmond, B.C.	[Signature]

PETITION

TO: The City of Richmond

DATE: August/September 2013

WHEREAS The City of Richmond has erected a chain-link fence in Dover Park and designated that enclosed area as A Pilot Project Off-Leash Park for at least a period of nine months, and whereas the City of Richmond did not seek the agreement of the residents of Dover Crescent, (a residential area), we request that the off-leash area be re-located to another area of the City. Reasons for this request include:

- NOISE - dogs barking
- PARKING - non-resident dog owners using Dover Cres. parking
- APPEARANCE - a large dog pen undermines the look of the park

WE the undersigned petition the City of Richmond as follows: -

Request that the City of Richmond remove the chain-link fence erected in Dover Park and re-locate the Pilot Project Off-Leash Park to another area of Richmond. We request this happen as quickly as possible.

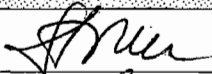
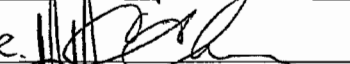
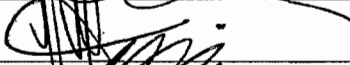
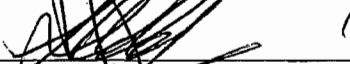
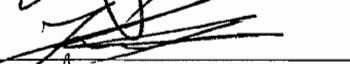
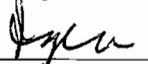
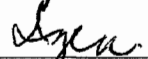
Name (printed)	Address (printed)	Signature
Mariana Stanilolu	114-5860 Dover Cr.	
CYNTHIA CHERRY	502-5860 DOVER CR.	
PETER CLAYTON	702-5860 Dover Cr.	
Shawn Gola	308, 5860 Dover Crescent	
MICHAEL VELIZARA	508-5860 Dover Cr.	
BARBARA IZEN	604-5860 " "	
ROY IZEN	" "	

Justy Chang	407 5860 Dover Cres	Justy Chang
Kevin Wong	407 5860 Dover Cres	Kevin Wong
TROY CHEN	108 - 5860 Dover Cr	email
TRUDY SMITH	"	"
GILLIAN BRAND	5860 Dover Cr	"
JONATHAN DOERKSEN	"	"
TENZIN BRAY	5860 Dover Cr	"
JOHN JIA	5840 Dover Cr	"
Victor Wong	803 5860 Dover Cr	"
Caroline Wong	"	"
Calvin Wong	1 - 5700 Dover Cr	"
Bernard Lo	18 - 5700 Dover Cr	"
Carlos Mauricio	48 - 5840 Dover Cr	"
Aurora Mauricio	"	"
KT Tong	402 5880 Dover Cr	"
William Ying		"
Gloria Pan		"
CAROL NG	5880 Dover Cr	"
MICHAEL TSIROULNIKOV	449 - 5880 Dover Cr	"
ALEJANDRO MURGUIA	442 - 5880 Dover Cr	"
AMANDA WA	433 - 5880 Dover Cr	"
BILL BLAIR	224 - 5880 Dover Cr	"
GEORGE SHAI	128 - 5880 Dover Cr	"
RAVINDER REEL	309 - 5880 Dover Cr	"
WAN MEI	513 - 5860 Dover Cr	"

PETITION

TO: The City of Richmond

DATE: August/September 2013

WHEREAS The City of Richmond has erected a chain-link fence in Dover Park and designated that enclosed area as A Pilot Project Off-Leash Park for at least a period of nine months, and whereas the City of Richmond did not seek the agreement of the residents of Dover Crescent, (a residential area), we request that the off-leash area be re-located to another area of the City. Reasons for this request include:

- NOISE - dogs barking
- PARKING - non-resident dog owners using Dover Cres. parking
- APPEARANCE - a large dog pen undermines the look of the park

WE the undersigned petition the City of Richmond as follows: -

Request that the City of Richmond remove the chain-link fence erected in Dover Park and re-locate the Pilot Project Off-Leash Park to another area of Richmond. We request this happen as quickly as possible.

Name (printed)	Address (printed)	Signature
BESCO HEOR	113-5860 DOVER CRESC	
LUCIAN STANILOIU	114-5860 DOVER C CRESCENT	
M. M. MOLTZAN	112-5860 DOVER	
L. DOTAN	209-5860	
J. DOTAN	208-5860	
D. DOTAN	208-5860	
M. DOTAN	209-5860	Michelle

PETITION

TO: The City of Richmond





DATE: 2013

WHEREAS The City of Richmond has erected a chain-link fence in Dover Park and designated that enclosed area as A Pilot Project Off-Leash Park for at least a period of nine months, and whereas the City of Richmond did not seek the agreement of the residents of Dover Crescent, (a residential area), we request that the off-leash area be re-located to another area of the City. Reasons for this request include:

- NOISE - dogs barking
- PARKING - non-resident dog owners using Dover Cres. parking
- APPEARANCE - a large dog pen undermines the look of the park

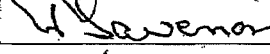
WE the undersigned petition the City of Richmond as follows: -

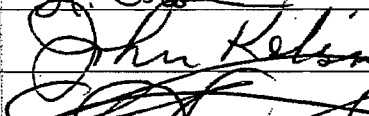
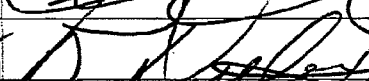
Request that the City of Richmond remove the chain-link fence erected in Dover Park and re-locate the Pilot Project Off-Leash Park to another area of Richmond. We request this happen as quickly as possible.

Name (printed)	Address (printed)	Signature
Susan Esplen	149-5880 Dover Cr.	
W. Saveman	435-5880 Dover Cr.	
Judysmith	108-5860 Dover Cr.	
H. Cronin	107-5880 Dover Cr.	
John Kolesnik	346 5880 Dover	
Don Dillingham	316 5880 Dover	
Rita Dillingham	316 5880 Dover	

V. Laninga	334-5880 Dover Cr.	
K Mennick	411 5880 Dover Cr.	
K Mennick	411 5880 Dover Cr.	
M. MORACZEWSKI	301-5880 Dover Cr.	MM
J. Ma	244-5880 Dover Cr.	J Ma
C. Cheung	437-5880 Dover Cr.	
R. McLean	253-5880 Dover Cr.	
ELIZABETH	348-5880 Dover Cr.	
Regina	102-5880 Dover Cr.	Regina
Regina Chee	443-5880 Dover Cr.	Regina
N. Hamir	238-5880 Dover Cr.	
Polando Masma	7302-Lindsay Rd	
A. MURQUA	442-5880 DOWER CR.	
VERN MOSES	303-5880 DOVER CR.	
H BAINS	431-5880 DOVER	
CHADWICK CHAN	425-5880 DOVER	
Jim McYarn	179 5880 Dover	
S. Frien	250-5880 Dover Cr.	
B. Scopazzo	*335-5880 Dover Cr.	
C. NG	423-5880 Dover Cr.	
Irene Ma	329-5880 Dover Cr.	
Shirley Ngai	426-5880 Dover Cr.	
Felixon Mok	426-5880 Dover Cr.	
Zheng Zhang	247-5880 Dover Cr.	
Jodi Brammer	604-29143-5880 Dover Cr.	

T BEAUPRE	434 5880 Dover	<i>T Beaupre</i>
S. CALDWELL	232-5880 Dover Cresc.	<i>S. Caldwell</i>
T. HALL	221-5880 Dover Cr	<i>T. Hall</i>
ANDY. HAO	347-5880 Dover	<i>Andy HAO</i>
a Mueller	#448 5880 Dover Cr	<i>a Mueller</i>
Jessica Sy	327-5880 Dover	<i>Jessica Sy</i>
T. FUJIMURO	405-5880 DOVER	<i>T. Fujimuro</i>
Xim Cha	128 - do -	<i>Xim Cha</i>
J. Palma	216-5880 Dover Crescent	<i>J. Palma</i>
S. Lan	125-5880 Dove-Cres	<i>S. Lan</i>
Sheela Chan	321-5880 Dover Cr	<i>Sheela Chan</i>
Quang	029-5880 Dover Cr	<i>Quang</i>
At Dillcassan	316-5880 Dover	<i>[Signature]</i>
JOE RANDA	346-5880 DOVER CRES.	<i>Joe Randa</i>
Ananda Wa	433-5880 Dover Cr	<i>Ananda Wa</i>
Yaixin Li	438-5880 Dover Cr	<i>Yaixin Li</i>
Gao min	227-5880 Dover Cres	<i>Gao min</i>
Sang Rye HAN	234-5880 Dover Cr	<i>Sang Rye HAN</i>
Gang Wony	202-5880 Dover Cr	<i>Gang Wony</i>
John Li	442-5880 Dover Cr	<i>John Li</i>
	422-5880 Dover Cr	<i>John Li</i>
W. Gerardo	445-5880 Dover Cr	<i>W. Gerardo</i>
Arnel C	310-5880 Dover Cr	<i>Arnel C</i>
J TAVERNOR	401-5880 DOVER Cr	<i>J Tavernor</i>
K TANG	402-5880 Dover Cr	<i>K Tang</i>

PETITION

TO: The City of Richmond

DATE: October 2013

WHEREAS The City of Richmond has erected a chain-link fence in Dover Park and designated that enclosed area as A Pilot Project Off-Leash Park for at least a period of nine months, and whereas the City of Richmond did not seek the agreement of the residents of Dover Crescent, (a residential area), we request that the off-leash area be re-located to another area of the City. Reasons for this request include:

- APPEARANCE - a large dog pen undermines the look of the park
- PARKING - non-resident dog owners using Dover Cres. parking
- NOISE - dogs barking

WE the undersigned petition the City of Richmond as follows: -

Request that the City of Richmond remove the chain-link fence erected in Dover Park and re-locate the Pilot Project Off-Leash Park to another area of Richmond. We request this happen as quickly as possible.

Name (printed)	Address (printed)	Signature
B. TAVERNOR	#35-5880 DOVER CR	<i>[Signature]</i>
K COMBER	150 5880 DOVER CR	<i>[Signature]</i>
S. SMITH	415-5880 Dover Cr	<i>[Signature]</i>
T. HOWARD	#436-5880 DOVER	<i>[Signature]</i>
T. SABOT	#241-5880 DOVER	<i>[Signature]</i>
B. DALEY	#344-5880 Dover	<i>[Signature]</i>
S. ESPLEN	#149-5880 Dover	<i>[Signature]</i>

PETITION

TO: The City of Richmond

DATE: October 2013

WHEREAS The City of Richmond has erected a chain-link fence in Dover Park and designated that enclosed area as A Pilot Project Off-Leash Park for at least a period of nine months, and whereas the City of Richmond did not seek the agreement of the residents of Dover Crescent, (a residential area), we request that the off-leash area be re-located to another area of the City. Reasons for this request include:

- APPEARANCE - a large dog pen undermines the look of the park
- PARKING - non-resident dog owners using Dover Cres. parking
- NOISE - dogs barking

WE the undersigned petition the City of Richmond as follows: -

Request that the City of Richmond remove the chain-link fence erected in Dover Park and re-locate the Pilot Project Off-Leash Park to another area of Richmond. We request this happen as quickly as possible.

Name (printed)	Address (printed)	Signature
CARLOS MAURICIO AURORA MAURICIO	46-5840 Dover ↓ ↓	<i>[Signature]</i> as mauricio
DORA LEE	50-5840 DOVER	<i>[Signature]</i>
Celia Lin	45-5840 Dover	<i>[Signature]</i>
Shinmei Huang Choi, Yu Choi	26-5860 Dover 47-5840 DOVER	<i>[Signature]</i> <i>[Signature]</i>
Connie Chan	44-5840 Dover Crescent	<i>[Signature]</i>
TONY CHAN	45-5840 DOVER CR.	<i>[Signature]</i>

R. Kijerman	909-5860	Kuack,
P. Chan	110-5860	Wang
Jan Wang	107-5860	Wang
A. Adken	715-5860	Adken
Riz Van Hest	509-5860	Riz Van Hest

parke@richmond.ca

McCallan Road Right Of Way - Pilot Dog Off Leash Site

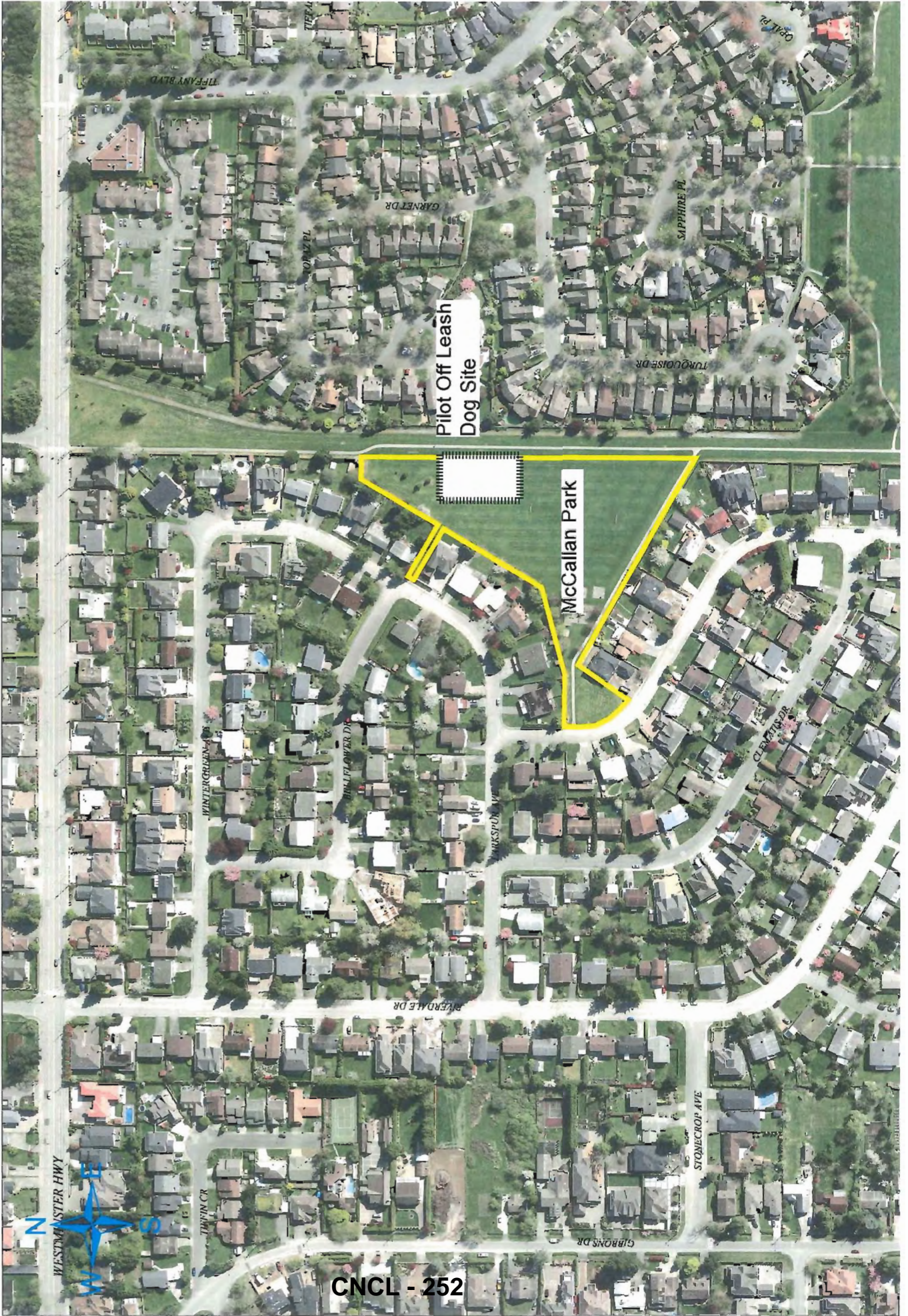

CNCL - 252

CNCL - 253



CONTEXT

1

This new City Centre park is envisioned as the "living room" for the Capstan Village area of Richmond, serving as the home ground for the social, recreational, and business life of the local community. It will function both as a quiet sanctuary of neighbourhood green, and a public urban square, and will offer a diverse mixture of landscapes, programs, activities and amenities for all to experience and enjoy in a shared space. The park will provide something for everyone, and people will be welcome to visit at all times of the day and throughout the seasons.

Key elements of the plan include: urban plaza/square; the "Great Lawn"; trees and landscaping; pedestrian pathways and bicycle paths; lighting; site furniture; play features; public art; off-leash dog area; and a sheltered stage area for performances.

7300 Elmbridge Road - Pilot Dog Off-Leash Area

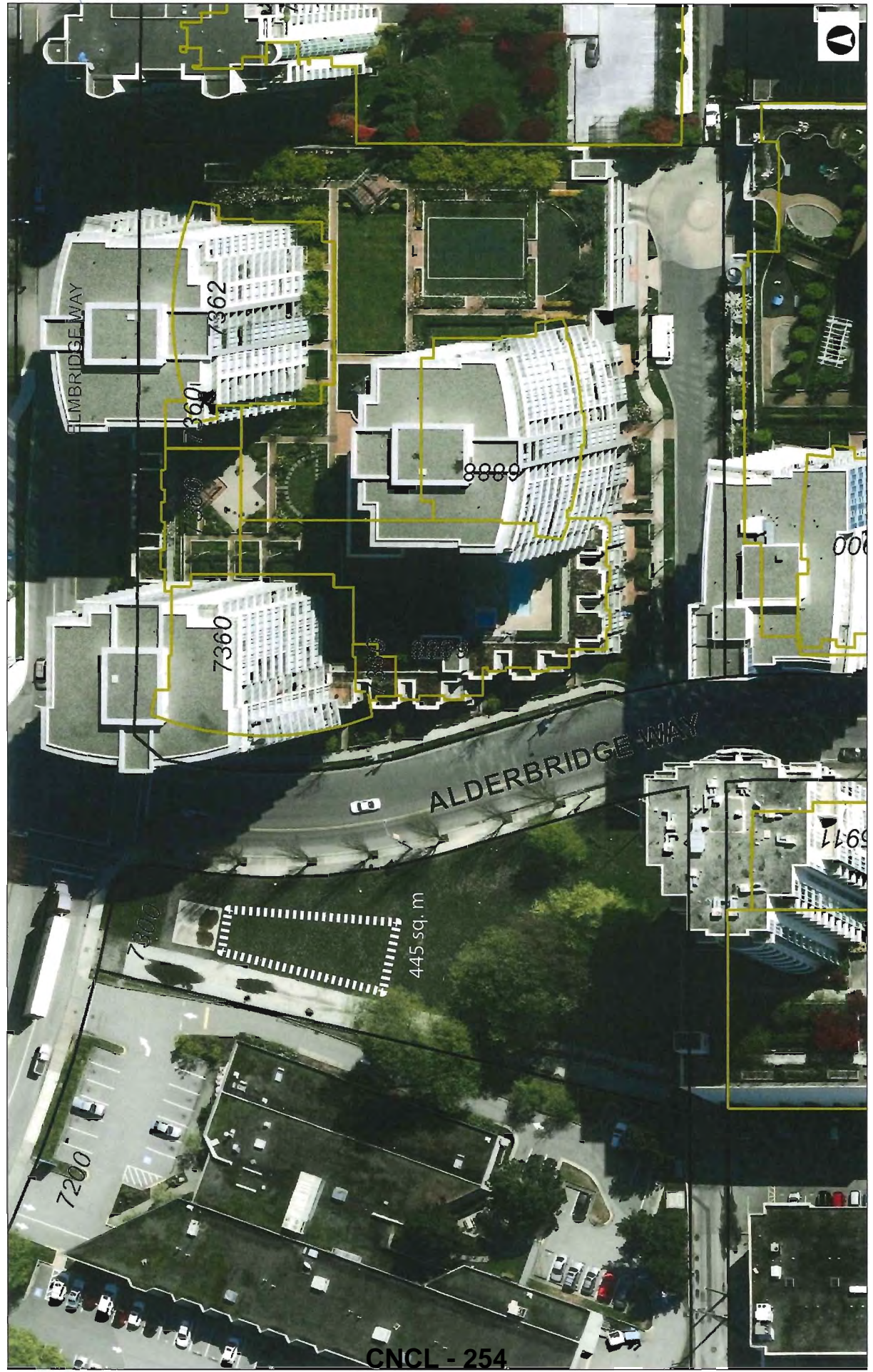

This map is a user generated static output from an Internet mapping site and is for reference only. Data layers that appear on this map may not be accurate, current, or otherwise reliable.

THIS MAP IS NOT TO BE USED FOR NAVIGATION

Garden City Community Park - Pilot Dog Off-Leash Area



42.4 0 21.18 42.4 Meters

This map is a user generated static output from an internet mapping site and is for reference only. Data layers that appear on this map may not be accurate, current, or otherwise reliable.

THIS MAP IS NOT TO BE USED FOR NAVIGATION

© City of Richmond

South Arm Park - 9020 Williams Road - Pilot Dog Off-Leash Area

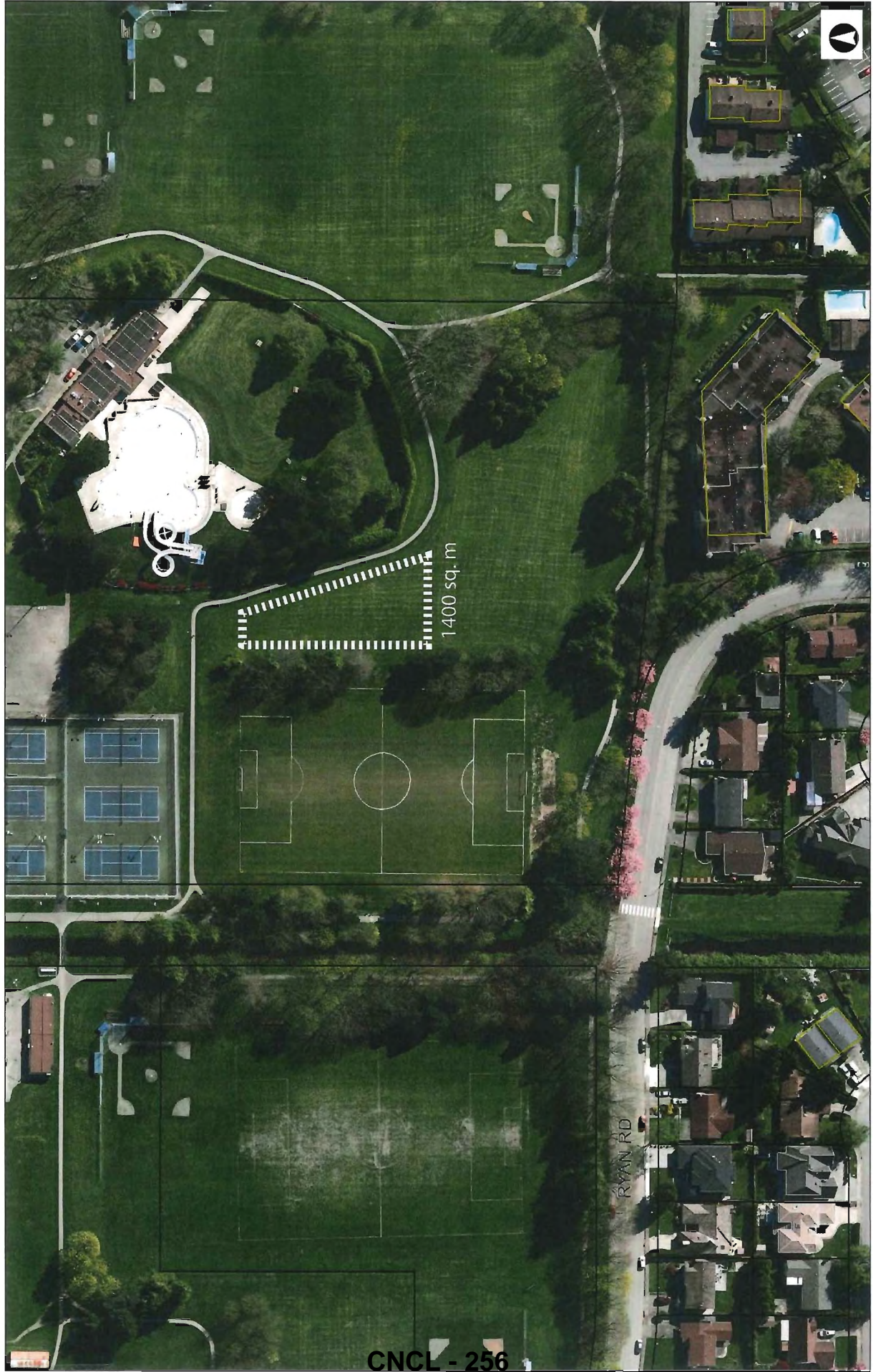

This map is a user generated static output from an Internet mapping site and is for reference only. Data layers that appear on this map may or may not be accurate, current, or otherwise reliable.

THIS MAP IS NOT TO BE USED FOR NAVIGATION