



Richmond Official Community Plan Bylaw OCP Bylaw 7100
Amendment Bylaw 9106 (RZ 12-605038)
7120, 7140, 7160, 7180, 7200, 7220, 7240, and 7260 Bridge Street and
7211, 7231, and 7271 No. 4 Road

The Council of the City of Richmond, in open meeting assembled, enacts as follows:

- 1. Richmond Official Community Plan Bylaw OCP Bylaw 7100 is amended by repealing the existing Character Area Map on page 41 of Schedule 2.10D thereof of the following area and replacing it with "Schedule A attached to and forming part of Bylaw 9106".
2. Richmond Official Community Plan Bylaw OCP Bylaw 7100 is amended by repealing the Land Use Map on page 42 of Schedule 2.10D thereof and replacing it with "Schedule B attached to and forming part of Bylaw 9106"
3. This Bylaw may be cited as "Richmond Official Community Plan Bylaw OCP Bylaw 7100, Amendment Bylaw 9106".

FIRST READING

MAR 10 2014

PUBLIC HEARING

APR 22 2014

SECOND READING

APR 22 2014

THIRD READING

APR 22 2014

OTHER CONDITIONS SATISFIED

SEP 09 2015

ADOPTED





MAYOR

CORPORATE OFFICER

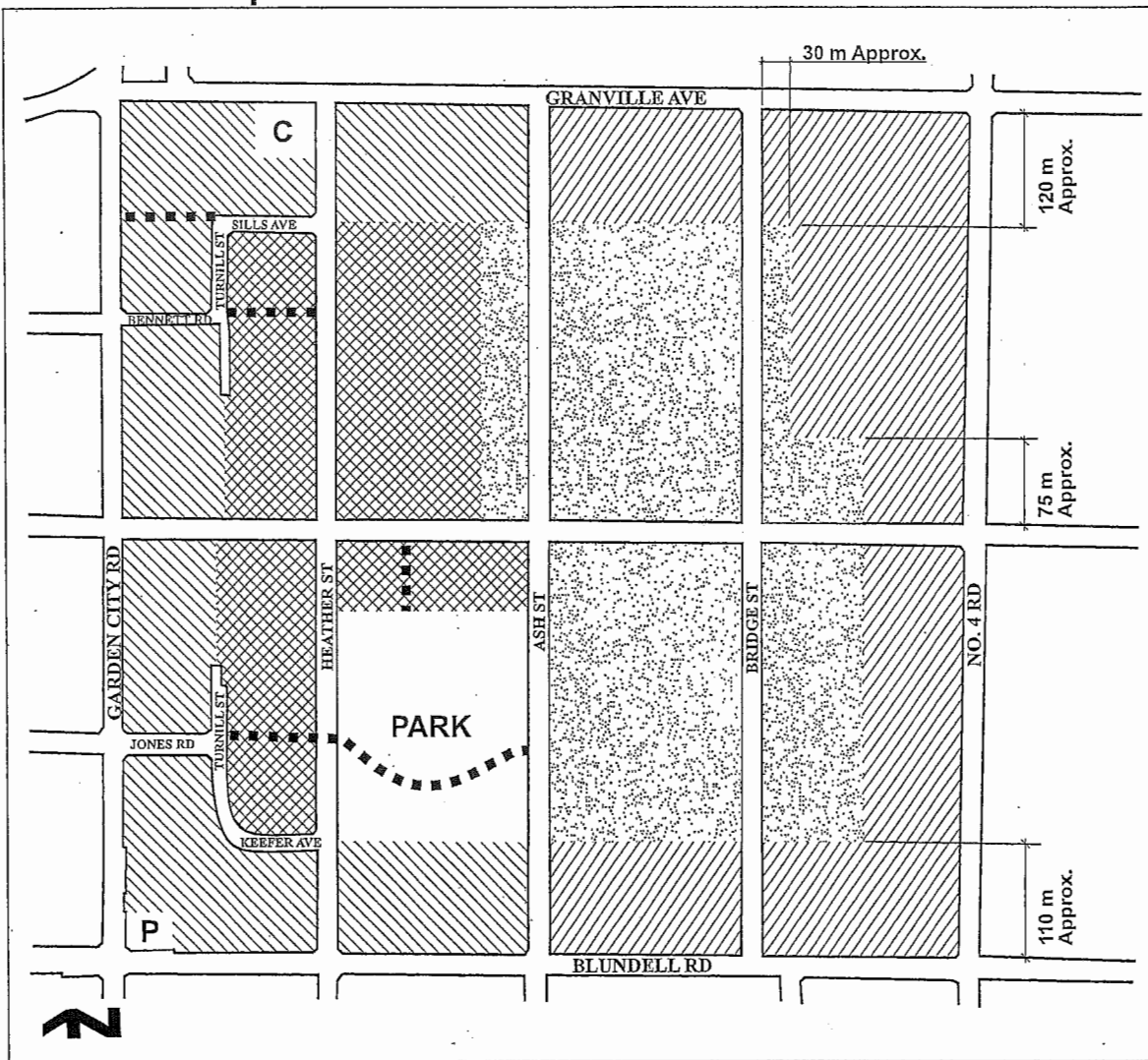
Land Use Map

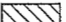
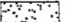

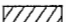

	Residential Townhouse up to 3 storeys over 1 parking level, Triplex, Duplex, Single-Family 0.75 base F.A.R.		Residential, Historic Single-Family, 2 ½ storeys maximum 0.55 base F.A.R., Lot size along Bridge and Ash Streets: • Large-sized lots (e.g. 18 m/59 ft. min. frontage and 550 m ² /5,920 ft ² min. area). Elsewhere: • Medium-sized lots (e.g. 11.3 m/37 ft. min. frontage and 320 m ² /3,444 ft ² min. area), with access from new roads and General Currie Road; Provided that the corner lot shall be considered to front the shorter of its two boundaries regardless of the orientation of the dwelling.		Trail/Walkway
	Residential, 2 ½ storeys typical (3 storeys maximum) Townhouse, Triplex, Duplex, Single-Family 0.60 base F.A.R.			C	Church
	Residential, 2 ½ storeys typical (3 storeys maximum), predominantly Triplex, Duplex, Single-Family 0.55 base F.A.R.			P	Neighbourhood Pub

Note: Stills Avenue, Le Chow Street, Keefe Avenue, and Turnill Street are commonly referred to as “ring road”

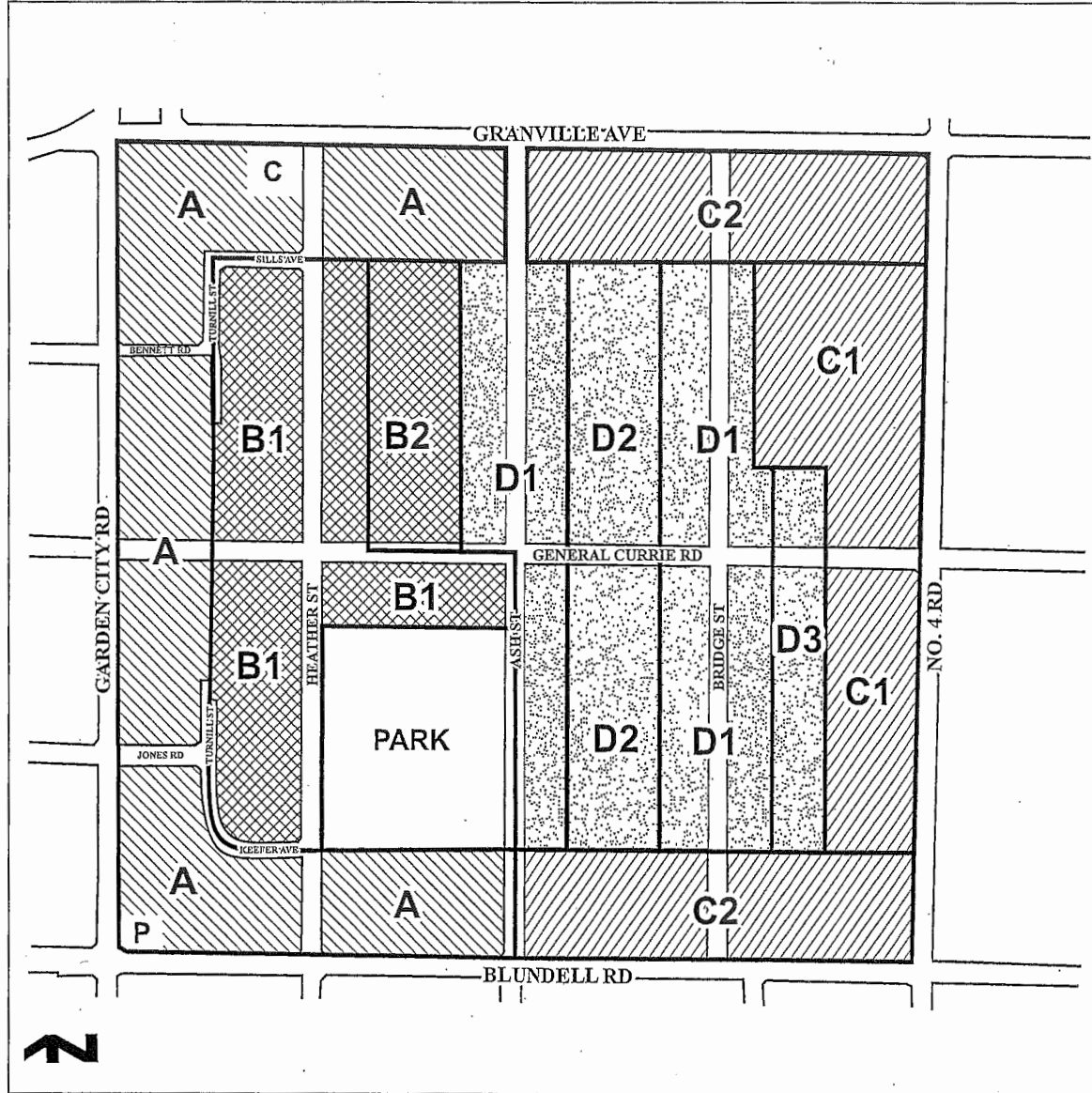
Character Area Key Map

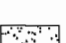

	Area A 3 storey Townhouse over parking		Areas C1, C2 Clusters of Predominantly Single-Family, Duplex, Triplex Units	C	Church
	Areas B1, B2 Townhouse - 2 ½ storeys typical (3 storeys maximum)		Areas D1, D2, D3 Single-Family	P	Neighbourhood Pub

Note: Sills Avenue, Le Chow Street, Keefe Avenue, and Turnill Street are commonly referred to as the “ring road”.



City of Richmond

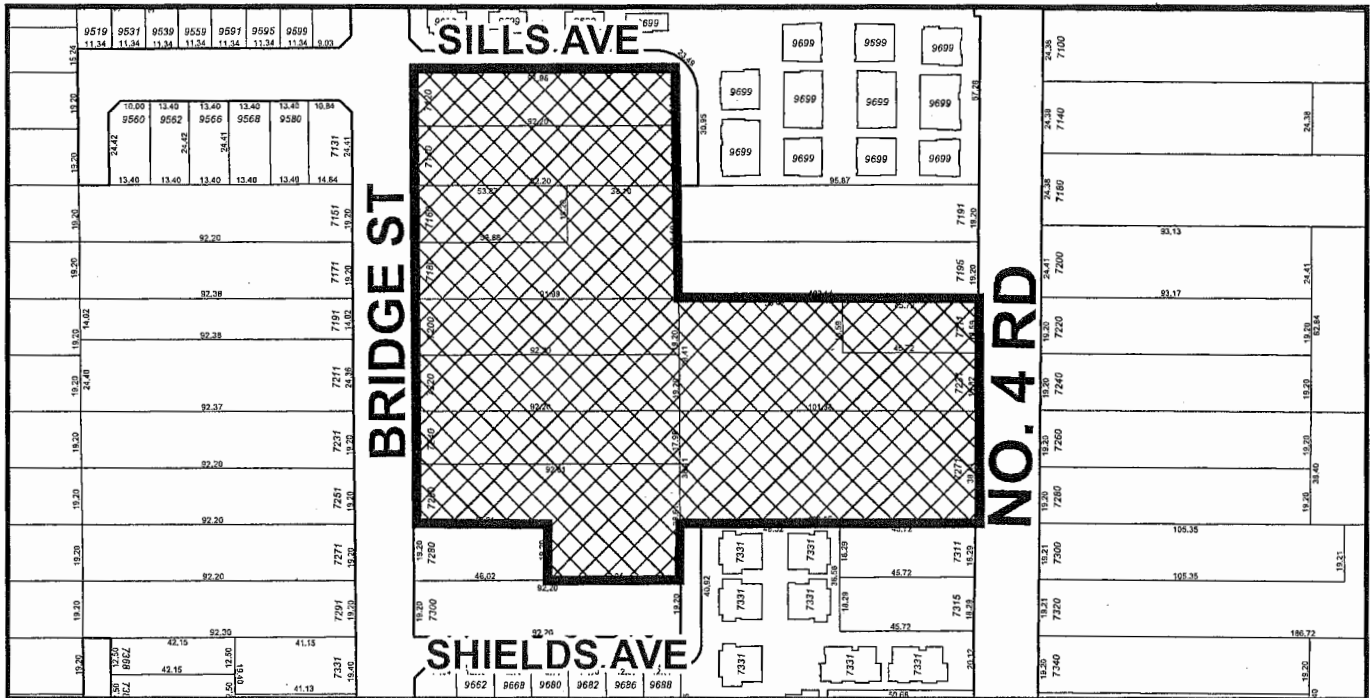
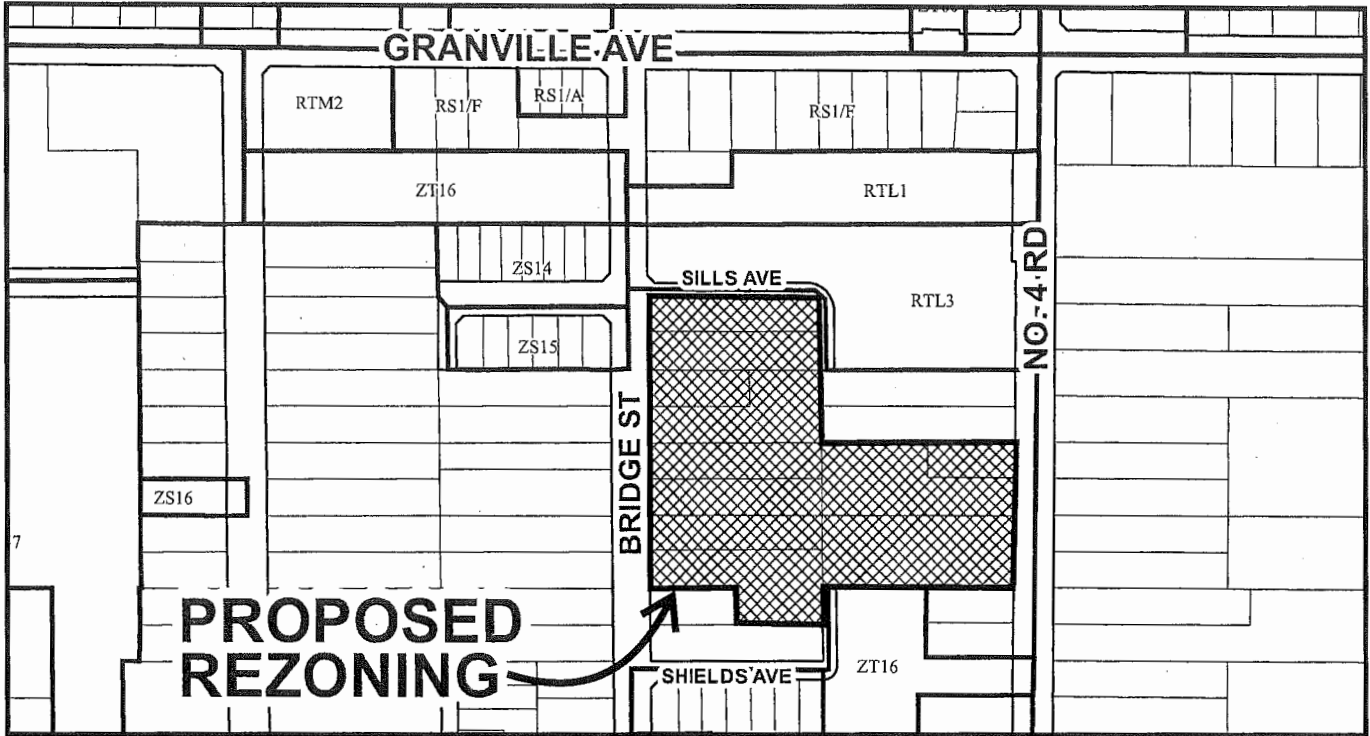

RZ 12-605038

Original Date: 03/26/14

Revision Date:

Note: Dimensions are in METRES

GNCL 597