



Richmond Zoning Bylaw 8500
Amendment Bylaw 8726 (RZ 10-544588)
6451 BLUNDELL ROAD

The Council of the City of Richmond, in open meeting assembled, enacts as follows:

- 1. The Zoning Map of the City of Richmond, which accompanies and forms part of Richmond Zoning Bylaw 8500, is amended by repealing the existing zoning designation of the following area and by designating it COACH HOUSE (RCH).

P.I.D. 003-937-402

The West Half of Lot 2 Except:

Firstly: Part Subdivided by Plan 43029 And

Secondly: Part Subdivided by Plan 43848

Section 18 Block 4 North Range 6 West New Westminster District Plan 13379

- 2. This Bylaw may be cited as "Richmond Zoning Bylaw 8500, Amendment Bylaw 8726".

FIRST READING

MAR 28 2011

A PUBLIC HEARING WAS HELD ON

APR 18 2011

SECOND READING

APR 18 2011

THIRD READING

APR 18 2011

OTHER REQUIREMENTS SATISFIED

JUL 19 2011

ADOPTED



MAYOR

CORPORATE OFFICER



City of Richmond

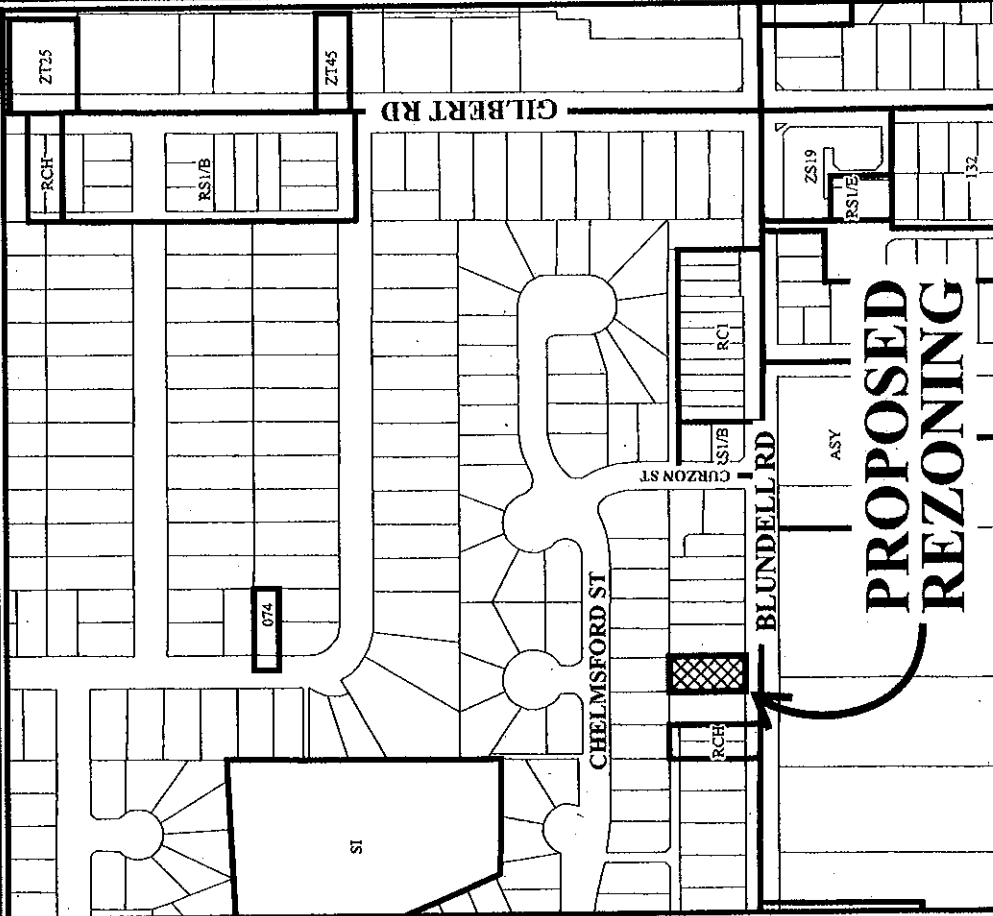

PROPOSED REZONING

35.6	18.29	35.6	20.62	35.6	20.27	35.6	18.29	1	45.72	6
35.6	20.27	35.6	20.62	35.6	20.27	35.6	20.63	1	45.72	13
10.46	39.69	45.69	45.72	45.72	45.72	45.72	20.63	6419	6431	6471
10.50	20.27	20.63	20.63	20.63	20.63	20.63	20.63	6419	6431	6471
54.91	6440									

BLUNDELL RD

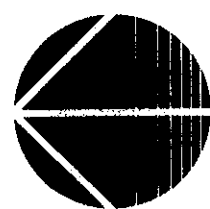

CNCL 130

RZ 10-544588

Original Date: 09/13/10

Revision Date: 02/24/11

Note: Dimensions are in METRES