



## City of Richmond

## Report to Committee

---

**To:** Parks, Recreation and Cultural Services Committee  
**From:** Dave Semple  
Director of Parks Operations  
**Date:** July 10, 2003  
**File:** 7200-01  
**Re:** Thompson Community Association Community Initiated Capital Project  
Outdoor Climbing Structure Proposal

---

### Staff Recommendation

1. That the proposal from the Thompson Community Association for the donation of a climbing wall structure at the Thompson/Burnett Park be approved.
2. That prior to undertaking any work, a contribution agreement between the Thompson Community Association and the City be developed that outlines the terms of funding, project design, installation and construction of the climbing wall structure.

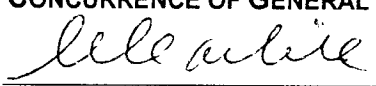

Dave Semple  
Director of Parks Operations  
(3350)

FOR ORIGINATING DIVISION USE ONLY		
<b>ROUTED TO:</b>	<b>CONCURRENCE</b>	<b>CONCURRENCE OF GENERAL MANAGER</b>
Recreation & Cultural Services .....	Y <input checked="" type="checkbox"/> N <input type="checkbox"/>	

## **Staff Report**

### **Origin**

Staff have received a proposal from the Thompson Community Association (Attachment 1) for the donation of a climbing wall or 'bouldering' structure to be installed adjacent to the Thompson Community Centre in the park site. The purpose of this report is to recommend approval of the proposal from the Thompson Community Association.

### **Background**

The Thompson/Burnett Neighbourhood Park, directly adjacent to the Thompson Community Centre is one of Richmond's most active public open spaces. Existing park site amenities include: two outdoor basketball courts, a playground structure for elementary school aged children, a lacrosse box primarily used for roller hockey, and a large grass open space area (Site Plan Attachment 2).

The Thompson/Burnett Park site is also home to the successful Night Shift Program, designed for youth to attend safe structured and un-structured evening and late night activities. Currently there is no dedicated funding or plans for future outdoor park amenity provision enhancements at this park site.

### **Problem/Opportunity**

Through the proposal from the Thompson Community Association, the City has an opportunity to add to the diversity of play opportunities for youth visiting the park site with the addition of a rock-climbing bouldering wall structure at little or no capital cost to the City.

### **Decision Criteria**

The following decision criteria detailed below address potential issues arising from the opportunity proposed by the Thompson Community Association to fund the capital installation of a climbing structure at the Thompson/Burnett park site:

- Liability for the proposed structure
- Annual operating budget implications for the park site maintenance
- Structure siting requirements
- Impact to the approved park master plan
- Capital acquisition and installation cost for the structure
- Level of need for the proposed asset

### **Alternatives**

- Option 1: Approve the proposal from the Thompson Community Association to fund the installation of a climbing structure at the Thompson/Burnett park site.
- Option 2: City funds the enhancement of the proposed climbing structure installation at the Thompson/Burnett park site.

Option 3: City rejects proposal from the Thompson Community Association

### Analysis

Option	Liability	Financial Implications Capital	Financial Implications Operating	Impact to Park Master Plan	Structure siting	Need for proposed asset
<b><u>Option 1</u></b> <i>Approve proposal from Thompson</i>	Play toy vendor assumes liability for installation, City assumes liability after installation.	None-community initiated capital project	\$1000.00 per annum.	Not approved in park master plan, structure represents an enhancement to the park site.	City reserves right for appropriate siting in the park site to ensure compatibility with existing uses.	Proposed Climbing structure presents an unprogrammed opportunity for older youth to participate in the activity of rock climbing.
<b><u>Option 2</u></b> <i>City funds proposed project</i>	Same as option 1.	Approximately \$60,000 required in capital program, not currently funded.	Same as option 1.	Same as option 1.	Same as option 1.	Same as option 1.
<b><u>Option 3</u></b> <i>Reject proposal - do nothing</i>	None	None	No operating budget impact.	None	N/A	Potential missed opportunity for community capital contribution.

### Impacts

#### Financial – Capital and Operating

There are no capital budget impacts associated with the proposal from the Thompson Community Association as this is a community initiated capital request to fund 100% of the project acquisition and installation costs.

The annual park site operating budget maintenance costs are estimated to be approximately \$1000 per annum with the addition of the proposed climbing structure being added to the existing inventory at the base level of service.

#### Environmental

There are no direct environmental benefits from the addition of the proposed climbing wall structure at the park site. It should be noted that a portion of the exiting green space

approximately 115 square feet in size at the site would be lost to the climbing structure and sub-surface material. An additional consideration for the installation will be to ensure protection of the geothermal field buried beneath a portion of the Thompson park site.

From an aesthetic perspective, the proposed climbing wall structure will resemble a typical playground installation, with re-cycled Fibar wood-chip surfacing to create a safe fall zone around the perimeter of the structure. A similar installation by the proposed vendor is located in Riley park in Vancouver and has been received favourably.

#### *Community and Social*

As a safe recreational activity the proposed climbing structure will challenge youth attending the park site to explore the limits of their potential. The proposed structure has the potential to foster age appropriate physical development, it can also provide social and intellectual development. As an amenity designed for older youth, the structure also presents a new opportunity for participation in the popular sport of rock-climbing.

#### *Organizational*

As a community initiated capital project, the proposal from Thompson represents a project that can help to enhance a current park site with no up front capital costs being expensed by the City.

#### **Conclusion**

The proposed outdoor play area improvements will provide the Thompson enhanced outdoor recreational opportunities.

From a liability perspective, the proposed climbing wall structure is sold by a playground equipment manufacturer and could be subject to Canadian Safety Standards Association (CSA) guidelines and inspection the same as Richmond's current playground inventory. Regular monthly inspections and reporting would occur at the site when the existing Thompson playground is inspected.

The City's role in the proposed project is to ensure that the design supports the overall objectives for the park and is well integrated with existing infrastructure.

#### **Implementation**

If approved, staff will develop a contribution agreement with the Thompson Community Association for the donation of the climbing wall structure to be located at the Thompson/Burnett Park Site. The contribution agreement will detail the terms of the installation, siting requirements, and timing for the project to proceed.



Mike Redpath  
Manager, Parks - Programs, Planning & Design  
(1275)

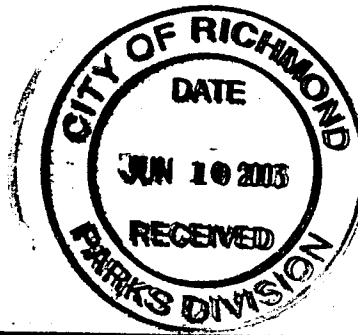

## City of Richmond

6911 No. 3 Road  
Richmond, BC V6Y 2C1

Main (604) 276-4000 Fax (604) 276-4177

## COMMUNITY INITIATED CAPITAL PROJECT APPLICATION

Application Date: 06 10 03 Program Year: \_\_\_\_\_

## 1. Applicant Details

Name of Community Group: THOMPSON COMMUNITY ASSOC.Contact Name: GEORGE ATKINSON Signature: \_\_\_\_\_Mailing Address: 5151 GRANVILLE AVE RICHMOND  
V7C 1E6Tel. No.: 604 718 8422 Fax No.: 604 718 8433

## 2. Project Location and Description (should be a detailed description of the project)

LOCATION: THE SOUTHWEST CORNER OF THE  
THOMPSON <sup>PARK</sup> ADJACENT TO THE BASKETBALL  
COURTS.DESCRIPTION: 2 MAN-MADE CONCRETE  
CLIMBING ROCKS (8 FT HIGH 11.5 FT. WIDE)\*  
SURROUNDED BY A 9 FT CHIP BASE AND  
A PERIMETER WOOD OR PLASTIC ENCLOSURE.  
\*SEE ROCK CRAFT DESIGNS BROCHURE

## 3. Project Justification (provide an outline of the need for, and benefits of, the project)

THIS IS DESIGNED FOR YOUTH TO USE AND  
PRACTISE CLIMBING SKILLS RATHER THAN  
USING OUR TOT AND CHILDRENS CLIMBING  
APPARATUS THESE ROCKS ARE DESIGNED  
TO HAVE PEOPLE CLIMB AROUND THEM  
RATHER THAN OVER THEM.

4. How Does this Project Align with the City of Richmond's Vision to "Be the Most Appealing, Livable and Well-Managed Community in Canada"?

THESE CLIMBING ROCKS WILL SHOWCASE  
OUR PARK (CHILDREN + YOUTH) FROM A  
HIGH TRAFFIC AREA. THESE ROCKS WILL GIVE  
A SENSE OF OWNERSHIP TO THE YOUTHS USING  
THIS PARK. THESE ROCKS ARE ALSO ARTISTICALLY  
DESIGNED TO GIVE AN "ART" LOOK.

5. Consequences of Not Proceeding with the Project (please explain)

TO HAVE <sup>THE</sup> YOUTH USING THE TOT AND  
CHILDRENS PLAY APPARATUS CAUSING  
DAMAGE AND OCCUPYING IT WHEN THE  
YOUNGER CHILDREN WANT IT.

6. Project Capital Cost

Construction Costs	\$ <u>53,344.87</u>
Permit Fees	\$ <u>0</u>
Development Cost Charges	\$ <u>0</u>
Other (specify)	\$ <u>0</u>
Total	\$ <u>53,344.87</u>

Capital Funding Sources

Funding Provided by Applicant	\$ <u>53,344.87</u>
Requested Municipal Funding	\$ <u>0</u>
Other (specify)	\$ <u>0</u>
Total	\$ <u>53,344.87</u>

7. Estimated Project Operating Cost

Annual Operating Costs	Total \$ <u>1000.00</u>
------------------------	-------------------------

Proposed Operating Funding Sources

Funding Provided by Applicant	\$ <u>0</u>
Requested Municipal Funding	\$ <u>1000.00</u>
Other (specify)	\$ <u>0</u>
Total	\$ <u>1000.00</u>

Post-it Fax Note	7671E	Date	June 6, 2003	# of pages	6
To	CRANK HILL	From	Shirley		
Co./Dept.	Thompson Community Association	Co.	Habitat Systems		
Phone #		Phone #			
Fax #	604-295-6076	Fax #			



systems incorporated

# Thompson Community Association

## Climbing Sculpture Proposal

Prepared June 6, 2003

*Thompson Community Association  
Richmond, BC  
Proposed Climbing Sculpture*



Proposal Date:	June 6, 2003
Equipment Manufacturer:	RockCraft Designs
Mounting:	Direct Bury
Surfacing:	Included
Installation:	Included
Freight:	F.O.B. Richmond, BC
Ship to address:	Richmond, BC

---

*Design #060603  
Fitz Roy & Cerro Torre Climbing Sculptures*

*Components*

Cerro Torre Sculpture - 11.5 feet long

Fitz Roy II - 9 foot extended version Sculpture

Boulder Sign

Decorative Boulder Seat



Page Two  
Thompson Community Association  
Design # 060603  
June 6, 2003



### Pricing

Supply equipment	\$38,240.20
Install the above equipment	\$ 5,336.00
Supply tufttimber borders - 4' long	\$ 1,400.00
Install the above borders	\$ 149.41
Supply 46 cubic yards Sof'Fall engineered wood fibre complete with geotextile landscape fabric	\$ 1,374.54
Install the above safety surfacing	\$ 578.13
Subtotal	\$47,078.28
PST @ 7.5%	\$ 2,971.11
GST @ 7%	\$ 3,295.48
Total	\$ 53,344.87

Price includes freight costs to Richmond, BC. Pricing is valid for 90 days. Terms are net 30 days from shipment of product from factory. Delivery is approximately 4-6 weeks. Standard terms & conditions are attached.

To place order, please sign and return by fax to (604) 294-4002.

Signature of acceptance: \_\_\_\_\_ Date: \_\_\_\_\_

Print Name: \_\_\_\_\_

# RockCraft Designs

## Climbing Sculpture Layout for Thompson Community Centre

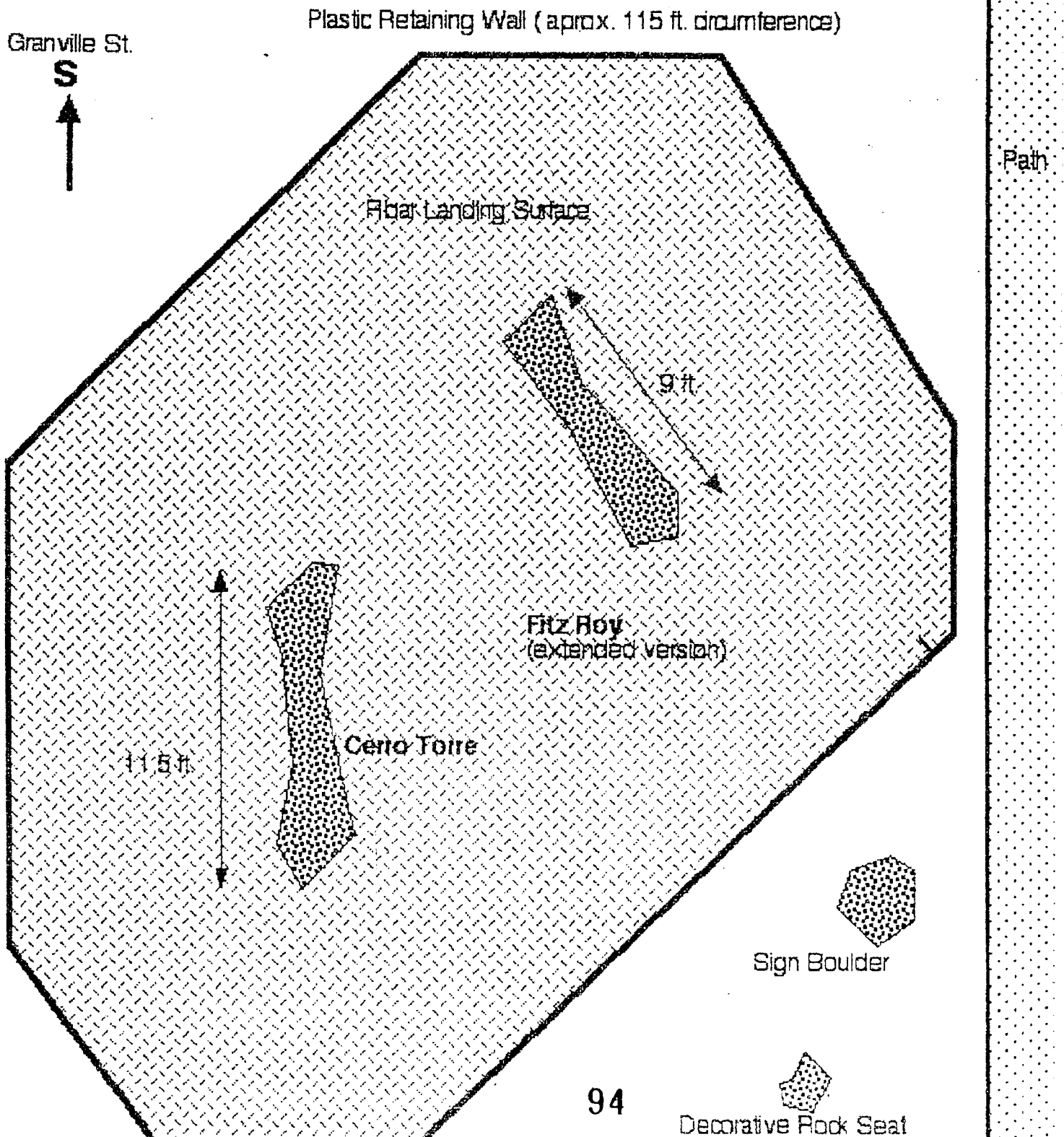

05/17/2003 13:15 4182920020

CROZIER AGENCIES LTD. TORONTO, ONTARIO

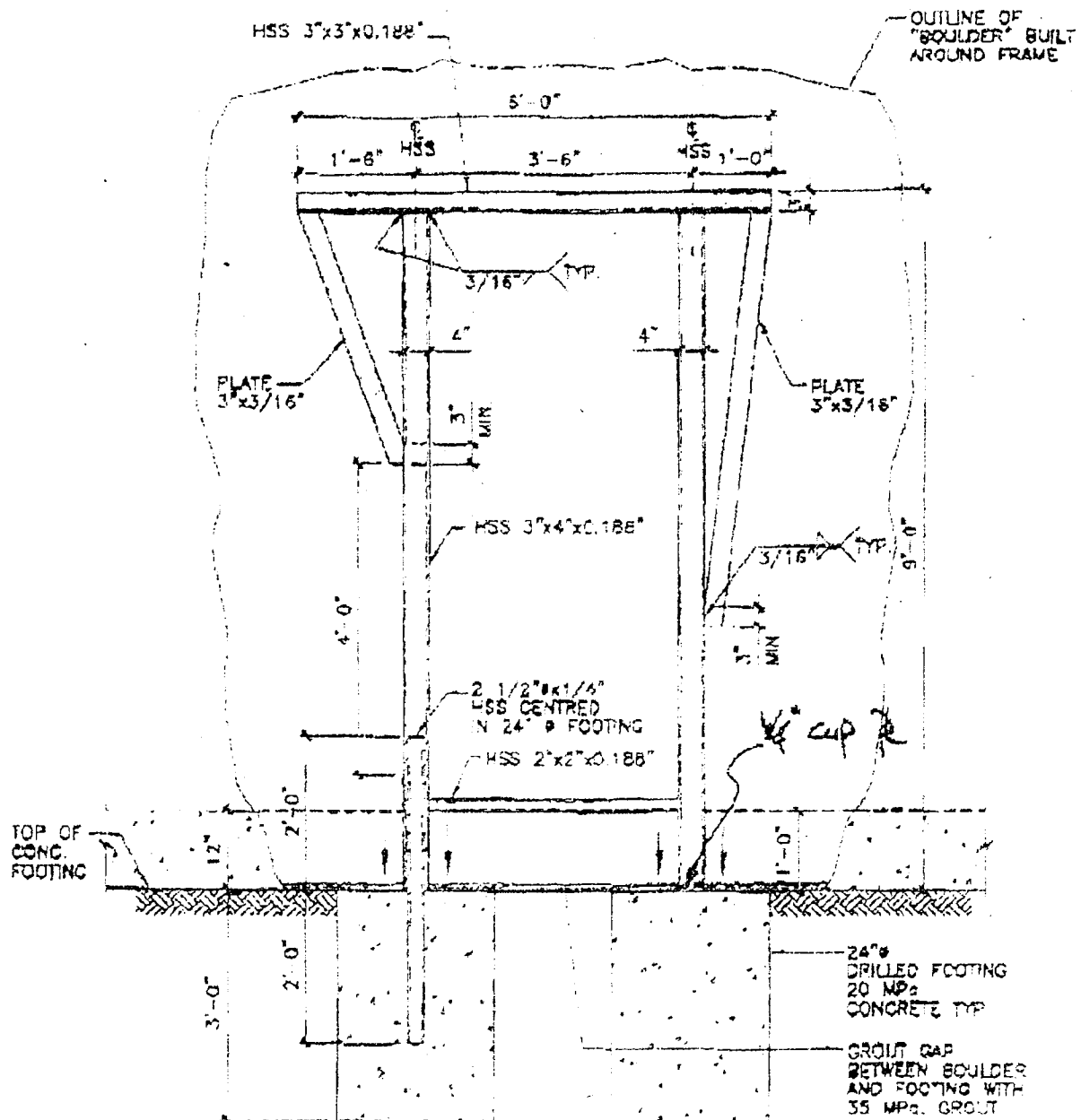

1 BOULDERING WALL FRAME 1 ELEVATION  
S1 SCALE 1/2"=1'-0"

**T.H. O'Rourke**

Structural Consultants Inc.

184 Shortt St. Toronto ON M5S 1S7  
Telephone (416) 292-0002 Fax (416) 292-5000

PROJECT

BOULDERING WALL FRAMES

CLIENT

CROZIER AGENCIES

WINNIPEG

FILE

BOULDERING WALL  
FRAME 1

DRAWN

A.S.

PROJECT NO.

03073

CHECKED

AS NOTED

DATE

MAY, 2003

FILE

03073-51

DWG. NO.

S1

MANITOBA



systems incorporated

## *Terms & Conditions*

All installation prices are quoted for normal ground conditions. Habitat Systems reserves the right to renegotiate contracts if abnormal ground conditions are determined during the course of an installation.

Customer is responsible for detailing all underground encumbrances one week prior to installation. Habitat is not responsible for damages incurred during installation due to incorrect or incomplete site information.

All prices are based on a clear, clean and level site, prepared to recommended space requirements. Habitat reserves the right to renegotiate contracts if additional site preparation is required, unless otherwise agreed upon in the quotation.

Vehicle and heavy equipment access must be provided to job site as required. Habitat is not responsible for damage to site and surrounding area while delivering and installing material.

Habitat Systems is not responsible for any charges resulting from vandalism.

Installation will be provided in accordance with manufacturer's specifications and CSA standards.

Habitat Systems will invoice for equipment and installation on the pre-arranged installation date. If installation is postponed, the customer will be invoiced for equipment only and this amount is payable net 30 days. The installation will be invoiced upon project completion.

Pricing includes freight costs to site. Pricing is valid for 90 days. Terms are net 30 days from shipment of product from factory.

