



## Parks, Recreation & Cultural Services Committee

Date: Tuesday, June 26, 2007  
Place: Anderson Room  
Richmond City Hall  
Present: Councillor Linda Barnes, Chair  
Councillor Sue Halsey-Brandt, Vice-Chair  
Councillor Cynthia Chen  
Councillor Bill McNulty  
Councillor Harold Steves  
Mayor Malcolm Brodie  
Call to Order: The Chair called the meeting to order at 4:00 p.m.

### MINUTES

1. It was moved and seconded  
*That the minutes of the meeting of the Parks, Recreation and Cultural Services Committee held on Tuesday, May 29, 2007 be adopted as circulated.*

**CARRIED**

### NEXT COMMITTEE MEETING DATE

2. Tuesday, July 24, 2007 (tentative date) at 4:00 p.m. in the Anderson Room.  
Staff was requested to explore available dates for the Parks, Recreation and Cultural Services Committee meeting to be scheduled before the July 23, 2007 Regular Council meeting.

# Parks, Recreation & Cultural Services Committee

Tuesday, June 26, 2007

---

## PARKS, RECREATION AND CULTURAL SERVICES DEPARTMENT

### 3. 2008 ARTIFICIAL TURF SITE SELECTION AND COMMUNITY CONSULTATION PROCESS

(Report: June 11, 2007, File No.: 06-2345-00-Vol 01, xr 2345-20-KGEO1; xr 2345-20-SARM1)  
(REDMS No. 2243215)

Dave Semple, Director of Parks and Public Works Operations and Mike Redpath, Manager, Parks - Programs, Planning & Design were available to answer questions.

*At this point, Councillor Harold Steves entered the meeting (4:02 p.m.)*

Jim Lammond, Chairperson, Richmond Sports Council addressed the Committee regarding the Minoru Oval, stating that due to it's seating capacity, Minoru is considered as the City's only stadium. He spoke about improvements and installation of artificial turf, and stressed the importance of time. He further stated that installation of two new artificial turf fields within 2008 would increase participation in sports activities within Richmond.

In answer to a question regarding the South Arm Park Master Plan, Mr. Semple advised that staff have been informed that Whiteside School may be rebuilt, and possibly even relocated; and a needs assessment has been completed by the South Arm Community addressing placement of youth activities on the site. City staff need to take these factors into consideration, and work through the community consultation process.

Discussion ensued about the South Arm Park Master Plan, back up plans, criteria, timelines, the need for further study, and alternate sites for installation of artificial turf. During the discussion, staff advised as follows:

- in the event that South Arm is not a suitable site for artificial turf, London and field three at Minoru have been included in the options report for consideration;
- the Minoru Oval is not recommended at this time due to outstanding processes concerning the facilities;
- ensuring that each side of the community has an artificial turf field is an important criteria, and placement of artificial turf at King George Park is a step in the right direction;
- a deadline of March 2008 for the completion of the South Arm Master Plan would allow ample time to identify and determine the most appropriate alternate site;
- South Arm Park has many constraints, including a displacement factor, and proximity and introduction of lighting to a residential area; and
- it is advisable to undergo a public community consultation process for the South Arm Park to ensure due diligence.

## Parks, Recreation & Cultural Services Committee

Tuesday, June 26, 2007

---

Staff was questioned if they could guarantee completion of two artificial turf fields by the end of 2008, if the Committee granted a deadline of March 2008 for the South Arm Master Plan. In response, Mr. Redpath advised that funding towards the proposed turf field projects will be confirmed upon the 2008 budget approval. If approved, the anticipated completion timeline is for October, 2008, prior to Thanksgiving.

In answer to questions regarding the constraints for placing artificial turf at the Minoru Oval, Mr. Lammond advised that he felt the issues are solvable by introducing a controllable fence along the parking lot, that could be open for public use, and closed off to the public during events.

Mike Redpath indicated that staff have consulted the Kajacks Track and Field Club regarding the concerns with respect to the Minoru Oval. Fencing on the inside of the field is hazardous for the runners, and obstructs the visibility of spectators. A conflict between Kajacks and the public has been identified, as runners and walkers treat the track as a community facility.

Serj Sanghera of the Richmond Sports Council, and Area Director for BC Minor Baseball expressed concerns regarding (i) lack of consideration given to Richmond for provincial programs and tournaments due to a shortage of fields; (ii) loss of many of Richmond's top youth performers to other communities; and (iii) restrictions and difficulties associated with playing on fields shared with other groups. Mr. Sanghera stressed the need for sites with dual baseball diamonds and storage facilities, so that they could become dedicated sites to the teams.

Discussion took place about possible sites that could be dedicated to baseball, and it was noted that the soccer community has indicated that upon completion of the artificial turf fields, they could give up the site at Blundell. It was further noted that the Blundell site could host two baseball diamonds, and accommodate a storage area for equipment.

Mr. Redpath advised that a plan for displacement of baseball is part of the Council approved Soccer Alliance proposal, and Blundell could become dedicated to baseball.

Roger Barnes from the Richmond Soccer Alliance, joined Roy Oostergo of Richmond Girl's Soccer. Mr. Barnes spoke about (i) benefits resulting from the introduction of the Soccer Alliance Proposal of June 2005; (ii) increased registrations due to the improved facilities; (iii) smaller sided teams resulting in changes such as six micro-fields instead of two larger fields; and (iv) the positive effect completion of the artificial turf fields will have on baseball and football.

## Parks, Recreation & Cultural Services Committee

Tuesday, June 26, 2007

---

In conclusion Mr. Barnes indicated that he felt Minoru Oval, being 30 square feet larger than South Arm Park, is the most appropriate site for the installation of artificial turf, and should be developed without any delay. Mr. Oostergo urged the Committee to dedicate a timeline to the proposed staff recommendations.

Discussion ensued amongst Committee members, staff and the delegation on:

- site constraints for Minoru Oval with respect to installation of artificial turf;
- undergoing a public community consultation process at Minoru Park to ensure due diligence;
- the possibility of an enclosable facility at Minoru for multi-sports events;
- introduction of traffic fencing at Minoru for minimization of conflict between the Kajacks Track and Field Club and members of the public who walk and jog during track practices; and
- the possibility of a parallel process for both South Arm Park and Minoru to be presented in March 2008.

Peter Mitchell, 6271 Nanika Crescent, questioned the continuity of the Annual City Centre Community Association Event at Minoru Park if artificial turf is installed, and talked about the importance of having a public community process. Mr. Mitchell highlighted several challenges and complications that would result from hosting the event at another site, or in a different part of Minoru Park.

Further discussion ensued about a consultation process for Minoru and timing, with advice being provided that before a conclusion is presented, consideration needs to be given to elements surrounding Minoru, including the facilities located south of Minoru such as the Community Safety Building, for which the footprint size will be determined when it comes forward in the Civic Plan; the aquatics centre; and senior's facilities.

It was moved and seconded

- (1) *That an artificial turf field at King George Park be approved for consideration in the 2008 Capital Budget;*
- (2) *That a Park Visioning and Master Plan process be initiated for South Arm Community Park and that the most appropriate configuration for an artificial turf at that site be determined as part of the Master Planning process;*
- (3) *That the South Arm Park Master Planning Process with a recommended final plan, including a potential location/configuration for a potential turf field at South Arm Community Park be completed and presented to Council by March 2008; and*
- (4) *That the findings of a study on the condition of the infield of Minoru Park be reported back to Council.*

# Parks, Recreation & Cultural Services Committee

Tuesday, June 26, 2007

---

The question on the motion was not called, as further discussion took place, as a result of which the following **amendment** was introduced:

It was moved and seconded

*That the main motion be amended by adding the following as Part (5):*

*“(5) That a public consultation process be carried out regarding replacement of the infield of the Minoru Oval with artificial turf to make it a competitive facility.”*

**CARRIED**

OPPOSED: Cllr. Linda Barnes

The question on the main motion, as amended, was then called:

*“(1) That an artificial turf field at King George Park be approved for consideration in the 2008 Capital Budget;*

*(2) That a Park Visioning and Master Plan process be initiated for South Arm Community Park and that the most appropriate configuration for an artificial turf at that site be determined as part of the Master Planning process;*

*(3) That the South Arm Park Master Planning Process with a recommended final plan, including a potential location/configuration for a potential turf field at South Arm Community Park be completed and presented to Council by March 2008;*

*(4) That the findings of a study on the condition of the infield of Minoru Park be reported back to Council; and*

*(5) That a public consultation process be carried out regarding replacement of the infield of the Minoru Oval with artificial turf to make it a competitive facility.”*

**CARRIED**

#### 4. **STEVESTON INTERURBAN (TRAM) LOCATION**

(Report: June 15, 2007, File No.: 10-6510-05-01) (REDMS No. 2244637; 2234365)

Peter Mitchell, 6271 Nanika Crescent, questioned the decision to have the Tram in a stationary position, and identified several locations that he felt would be suitable to offer a transportation service such as between the Oval, Terra Nova, and the Casino.

In answer to a question, Suzanne Greening, Coordinator of Leisure Services clarified that although a static display is currently planned, the four locations identified in the report will provide the capability to operate and move the Tram if necessary.

## Parks, Recreation & Cultural Services Committee

Tuesday, June 26, 2007

---

Dave Fairweather, a resident of Steveston spoke against locating the Tram at the Britannia Heritage Shipyard site, and expressed his opinion that the Tram should be located in a more public area with a laminated glass enclosure. Mr. Fairweather also spoke about difficulties related to volunteer recruitment and retention at the Britannia site. A copy of his submission is attached as Schedule 1 and forms part of these minutes.

Bryan Klassen, Britannia Site Supervisor advised that the Britannia Heritage Shipyard Advisory Board has discussed moving the Tram to Britannia, and the main concern was regarding the impact on the current plans for the site. He also indicated that it was his understanding, that the Board generally agreed to support moving the Tram to Britannia, as long as an appropriate location within the site is chosen; necessary resources are supplied; and a proper method to move the Tram is used. The Chair requested that Mr. Klassen ensure this issue is presented for discussion on the Board's next meeting.

Discussion ensued, and questions were raised about why staff recommended Britannia Heritage Shipyard when Steveston Park and No. 1 Road is number one in the ratings presented in Attachment 3 to the report.

It was advised that although Steveston Park and No. 1 Road rated in first place, there are concerns associated with the logistics of the park, and space limitations during special events. Further, the Steveston Society Board has stated that they do not support locating the Tram at Steveston Park and No. 1 Road.

Further discussion ensued about design details for the Tram barn and annual staffing costs.

It was moved and seconded

- (1) *That the Steveston Interurban (Tram) be permanently located in the Historic Zone of Britannia Heritage Shipyard site.*
- (2) *That the detailed designs of the Tram Barn be prepared using funds from the Tram project number 40886.*
- (3) *That the construction cost of the Tram Barn and relocation and restoration of the Tram at \$1.3 million be included for consideration in 2008/09 capital budget requests.*

The question on the motion was not called, as reference was made to two submissions: (i) a map of the Trites property (attached as Schedule 2); and (ii) a copy of the Richmond Record dated March 1926 (attached as Schedule 3), both providing support to the Britannia Heritage Shipyard site as being the original historical location for the Tram.

The Chair requested staff to ensure that the report for this item, and other supporting material be forwarded to the Britannia Heritage Shipyard Advisory Board to provide members with all aspects on this matter.

A request was made that the recommendations be voted on separately.

## Parks, Recreation & Cultural Services Committee

Tuesday, June 26, 2007

---

The question on Part (1) of the motion was then called, and it was **CARRIED** with Cllr. McNulty opposed.

The question on Part (2) of the motion was then called, and it was **CARRIED**.

The question on Part (3) of the motion was then called, and it was **CARRIED**.

### 5. **MANAGER'S REPORT**

#### a. **Seniors Games**

Staff advised that opportunities to have Richmond host the Senior's Games during the years 2009 – 2011 are currently being investigated.

#### b. **Ron's Backhoe Ltd.**

Reference was made to a newspaper article regarding a Richmond business which has been recently charged with five counts under the Greater Vancouver Regional District's municipal solid waste bylaw.

Discussion ensued, and as a result, the following **referral** motion was introduced:

It was moved and seconded

*That staff report back upon exploring options for the City to take with regard to continuing to do business with Ron's Backhoe Ltd. in light of the recent charges against the company by the GVRD.*

**CARRIED**

#### c. **Salmon Festival Canada Day Parade**

Mike Redpath updated the Committee about the Salmon Festival Canada Day Parade on July 1<sup>st</sup> at 10:00 a.m., and reminded Committee members to meet at the parade marshalling area at the entrance to Garry Point Park at 9:00 a.m.

#### d. **Summer Grants**

Anne Stevens reported that \$100,000 has been granted for the Summer Grants Program for 40 positions to be allocated amongst Community and Recreation; and Arts, Culture, and Heritage.

## Parks, Recreation & Cultural Services Committee

Tuesday, June 26, 2007

---

e. Soccer Tournament at Hugh Boyd Park

Eric Stepura, provided a short update regarding the success of the recent soccer game events at Hugh Boyd Park which had an attendance of approximately 650 people. He commended the efforts of 50 volunteers from Richmond Youth Soccer and Girls Soccer for organizing the event.

It was moved and seconded

*That letters of appreciation be sent to Jim Lammond, Chairperson, Richmond Sports Council, and Roger Barnes from the Richmond Soccer Alliance for hosting the recent soccer tournaments in which Zambia played against Richmond.*

CARRIED

### ADJOURNMENT

It was moved and seconded

*That the meeting adjourn (6:02 p.m.).*

CARRIED

Certified a true and correct copy of the Minutes of the meeting of the Parks, Recreation & Cultural Services Committee of the Council of the City of Richmond held on Tuesday, June 26, 2007.

---

Councillor Linda Barnes  
Chair

---

Shanan Dhaliwal  
Committee Clerk



SCHEDULE 1  
TO THE MINUTES OF THE PARKS,  
RECREATION AND CULTURAL  
SERVICES COMMITTEE MEETING  
OF TUESDAY, JUNE 26, 2007.

Councillor Barnes

Chair, Parks, Recreation & Cultural Svcs Committee      June 26, 2007.

1. The Staff Report of June 15<sup>th</sup> – reviewed.
2. The Analysis section: as might be expected, includes some declarations and assumptions open to debate. Some pertinent info omitted.
3. Nonetheless, the weighted evaluations of the criteria:  
    Overall Rank – Steveston Park No1. Road - First  
                    Britannia Heritage Shipyard Historic Zone – Second
4. Staff have however supported the Britannia Shipyard site for the permanent location and static display of Tram # 1220. I have trouble getting my head around that decision.
5. Staff have in mind, two quite different approaches to building design, suggesting that capital costs for the Steveston Park location could possibly be in the \$2-3 million area, based on higher-end design and construction. At least a couple of million less than Councillor Steves est
6. I certainly wouldn't approve of a big wooden barn in Steveston Park to house and display the tram – so why is it alright to impose such a structure in the Britannia Shipyard Park? The siting in the Historic Zone, pretty well blocks out 50% of the original plan for an open park, which incorporated various pathways and plantings.
7. Each of the site options provides for a 60 foot pull-out track for display of Tram #1220. I wonder under what conditions and by what method would this be undertaken? Safety issues/weather/volunteer crew!
8. The Staff Report indicates that the building of the tram barn, relocation and restoration would be included for consideration in the 2008/09 capital budget request.
  - . this suggests that restoration would'nt occur until after the relocation.
  - . the minutes of the May 29<sup>th</sup> Committee meeting, in response to my question as to whether any restoration had taken place, states – “due to resources and location, no significant work has taken place.
  - . having had ownership for 13 months, why at least, was a contract not let to restore the roof of the tram, plus other non-volunteer type work to prepare the tram for static display?

**. LETS GET ON WITH IT, IN THE PRESENT BUILDING, BEFORE RELOCATION!!**

9. The ranking and the logical siting of Tram #1220 is at the south-west corner of Steveston Park where for some time in various ways, this has been recognized as an historic location and a reminder of the important social and economic link that the Interurban Rail Service provided Steveston for over 50 years. What better place to display a piece of history and highlight the heritage of this part of Steveston?
10. As we know, there was a double track leading to this corner. The proposed siting of the tram building (Attachment 2.) suggests that along with a concrete apron, it would intrude significantly into the tree area, requiring removal of trees at considerable cost. As I see it there would not be a need to remove any trees ( a few lower branches).
11. I have taken some measurements in the area, with a different approach to a very suitable type of structure. A pretty rough drawing of what I recommend is provided and I ask that it be given serious thought as I think it would be very appropriate for the area. Its primary element is the visibility of the tram at all times, which Councillor McNulty spoke to in the previous meeting. A pull-out procedure would not be necessary, as it would stand on its own as a significant public and tourist attraction.
12. The desires of the Steveston Park Up-grade Plan would be respected with the removal of the existing tram building and the completion of greenway corridor walkway to Moncton & No, 1 Road, imbedding a portion of the existing railway track as part of the heritage landscape.
13. The concerns of members of the Britannia Heritage Shipyard Board, previously expressed on more than one occasion and the weight of public opinion should not be ignored.

Respectfully submitted:

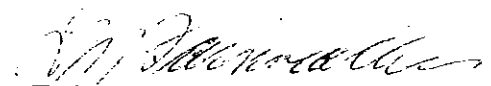
  
Dave Fairweather #328 12931 Railway Ave.

An alternative approach to housing Interurban Tram #1220  
for Static Display at Steveston Park

Structure: Measurements as required

Rust-free stainless steel and aluminum

Easy and fast construction process

Tempered or laminated safety glass

Solar reflective treated

Long side of roof – stainless steel covered

Display/storage sides of structure, framed in with door access

Roof venting as required

Reasonable cost

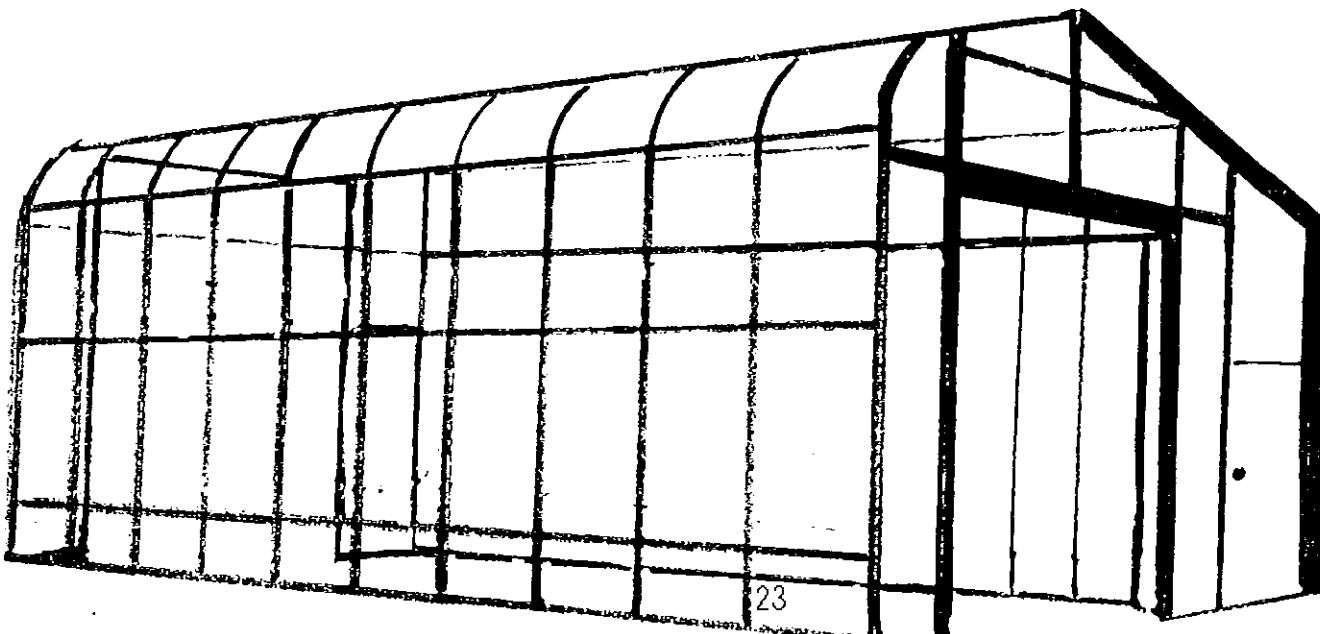
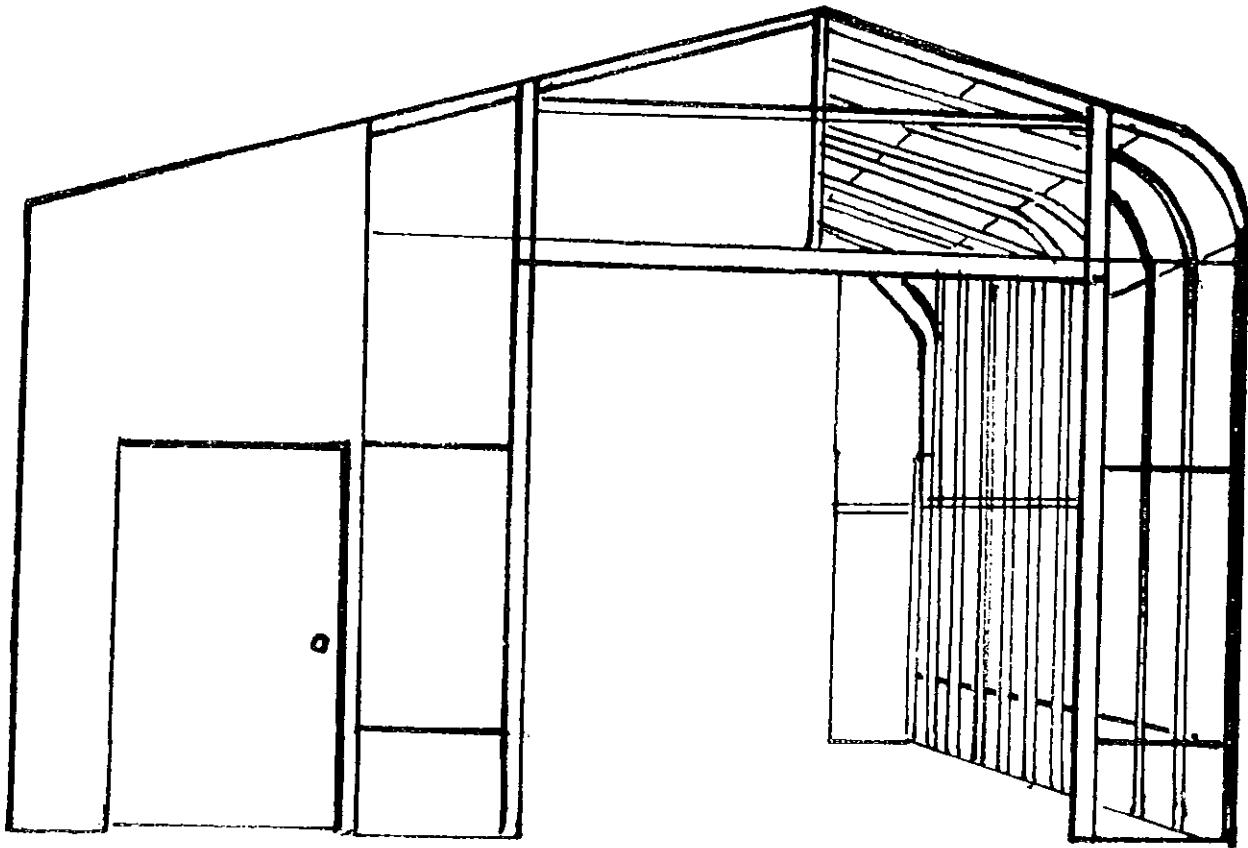

SCHEDULE 2  
TO THE MINUTES OF THE PARKS,  
RECREATION AND CULTURAL  
SERVICES COMMITTEE MEETING  
OF TUESDAY, JUNE 26, 2007.

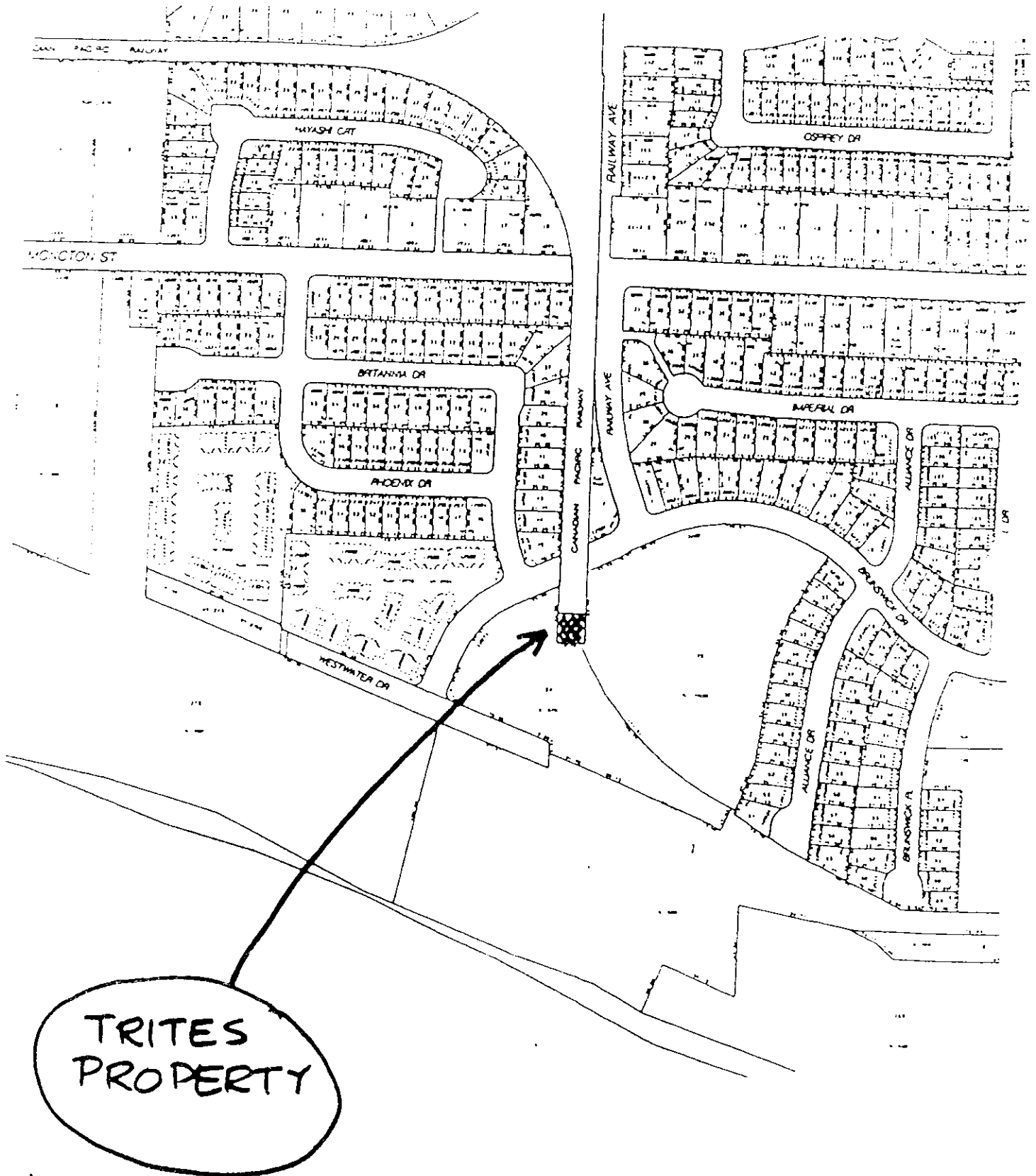

# RICHMOND RECORD

SCHEDULE 3  
TO THE MINUTES OF THE PARKS,  
RECREATION AND CULTURAL  
SERVICES COMMITTEE MEETING  
OF TUESDAY, JUNE 26, 2007.

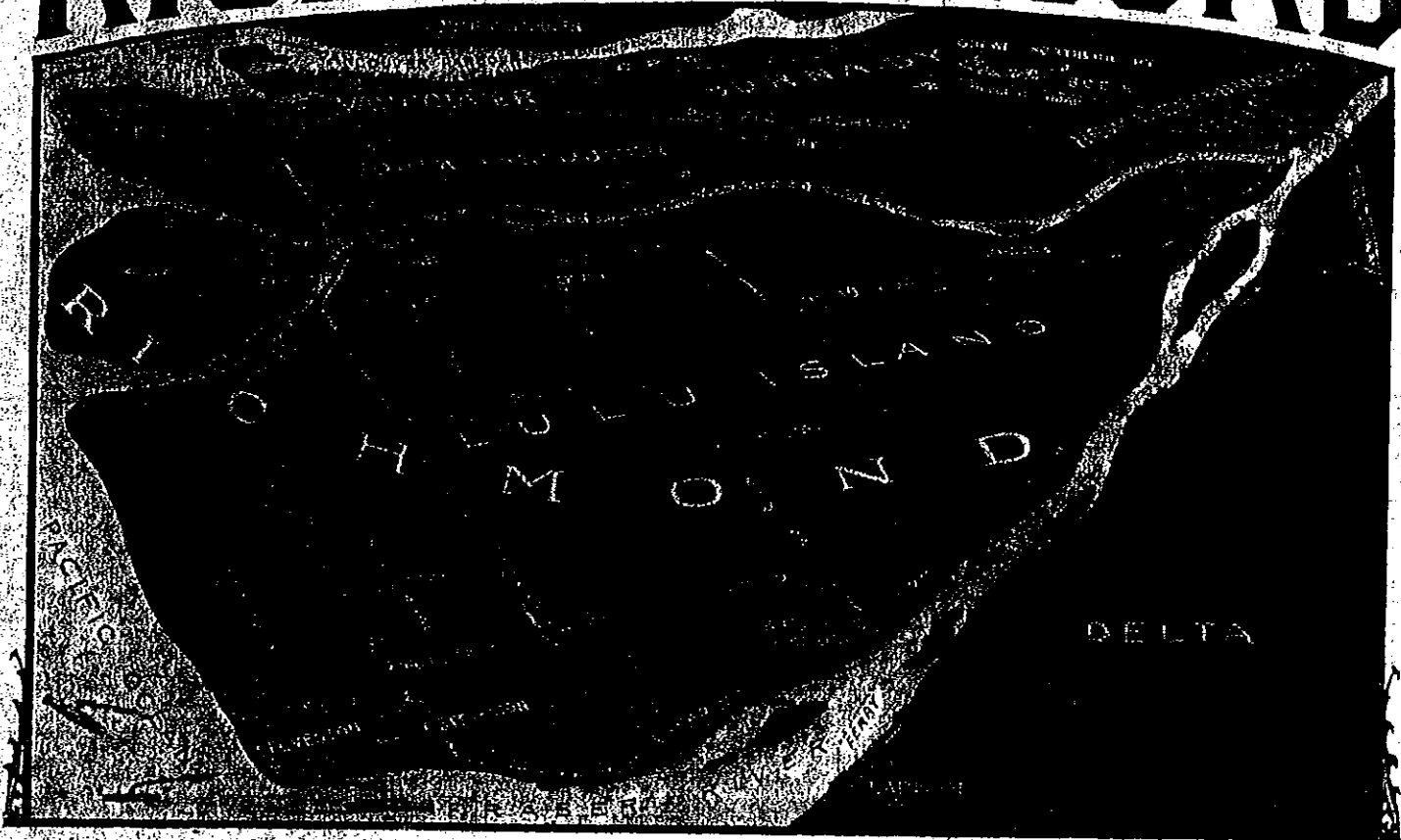

Vo. 1, No. 1

MARCH, 1926

5c per Copy, 50c per Year

## Our Bow

There is a very general desire manifest in Richmond for publicity: a desire to have better known abroad what we have to offer homeseekers, settlers and investors, and in this way to promote the growth and development of our district. In response to this desire a few Lulu Islanders put their heads together, and considered ways and means of rising to the occasion, and the publication of this little paper is the result.

This and following issues will be distributed among farmers in the prairie provinces. Copies will also be mailed to the Old Land, to the eastern provinces, and south of the line; and no opportunity will be overlooked to have copies reach the hands of those who are, or might be, interested in conditions here.

There is also a healthy desire in Richmond for a more general community spirit. The affairs of the Municipality have been discussed—not too seriously—from many angles at small meetings of ratepayers; but it was found that such discussion by a few could not create the community spirit that would be so helpful in the solution of our problems.

Our little paper, Mahomet-like, will go to the ratepayers who would not come to meetings. This issue will go to every home that receives mail in Richmond, and it is hoped that many will subscribe for the paper, and welcome following issues.

At first, the publication of a local paper seemed preposterous. In Richmond? But after the idea was examined and turned over in several minds, it became the sensible and practical thing to do. And so this little paper goes on to try its luck for a place in the affection of the people of Richmond.

## Our Title-Heading

The level, delta lands of Richmond, some 30,000 acres in area, are shown above at a glance, as they lie up against the cities of Greater Vancouver and New Westminster. Nature formed them for gardens, garden-homes, and the industrious smallholder. Our large farms will soon be a chapter of past history. With a water supply obtained from the mountains, electric light and power extended from Vancouver, transportation by paved roads and electric railway, and daily mail and daily newspaper delivery, the advantages of both city and country life are made possible, and disadvantages neutralised.

"The people of Richmond don't appreciate what they have," said a recent settler in the district. The remark expresses the first impression of visitors and newcomers. And it might well be true. Failure to appreciate what we have is a common failing with respect to possessions in general. It disables us from making the most of what we have, and dissipates our energies in discontents and frets that are mostly far from divine.

## The Fraser River

Our title-heading will show better than words could tell, how Richmond lies in the arms of the Fraser River. Lulu and Sea Islands are children of the river. For 10,000 years, it has been calculated, its floods have borne detritus from the mountains and valleys of the Rockies, and laid it layer upon layer to form these islands. It still continues extending them into the Gulf of Georgia at the rate of 10 to 20 feet per year. The Fraser will continue a main factor in the building of our for-

## The South Arm

We have to turn to the South Arm to see the greatest possibilities of industrial development. Here is the channel for ocean shipping. Nearly 20 miles of its water frontage is in Richmond, and it will be utilised for industries and shipping at no distant date. We have to visualise this in our calculations, not as optimists or pessimists, visionaries or peasants, but as sane realists.

The natural depth in the South Arm is 35 feet at low water. But at certain points where bars have formed, the depth at mean tide is 27 feet. This is now the controlling depth as far up as the city of New Westminster. Work on channel improvement is being steadily carried on by the Dominion Government, and the depth of water will be increased.

## The North Arm

We share with the municipalities on the peninsula interest in the North Arm, where many industries are already established. Point Grey Board of Trade has been active in promoting its improvement and development, and the newly formed Richmond Board of Trade will now take a hand in advancing its claims for attention, and in advertising its natural opportunities, where capital is seeking investment. It is to be hoped our Board of Trade will keep in touch with industries already there, and bring within view the widest possible prospect of the business and industrial world.

Richmond would like to see its Board of Trade take a lively interest in the re-establishment of the Milling industry at Eburne, and see that Messrs. Easterbrook receive every encouragement that it is possible for

## Council and School Board

The estimates presented by the School Board to the Council amount to \$57,832.00 for the current year. Of this amount the Government pays:

On account of teachers' salaries \$17,409.00  
On account of transportation 2,423.00

The estimates show an increase over last year, mainly for teachers' salaries, though the amount for supervising principal is reduced by \$200.00.

The Medical Health Officer's salary was last year increased from \$250 to \$350, at which figure he is engaged this year. Why do we go to a neighboring municipality for this official? He also received \$250 last year as Municipal Health Officer. Why is a Richmond doctor not appointed? We presume that some day this anomaly will be remedied.

The School Trustees also asked the Council for the extra mill for capital expenditure. This should yield in round figures about \$6,000. The ratepayers are insisting on a new central school half way between Bridgeport and Steveston, and both the trustees and councillors will no doubt agree on its necessity. It will take wise and courageous management to hold down our school expenditures to the pace of growth of our assessments and sources of revenue.

### Requests for Grants

The Agricultural Society directors presented their annual requests for grants at a mid-February adjourned meeting of the Council.

For the Fair and Exhibition	\$500.00
For music for May-day	100.00
For New Westminster Exhibit	250.00

The last mentioned was granted, the request for May-day withdrawn, and the Council "laid over" the request for \$500. It came out in the discussion that many of the Councillors were not wholly satisfied with the management of the May Day celebration and the Fair, that both these events were exploited to their detriment for other if kindred objects of the society. It seemed that the society aimed at a surplus with which to build, sometime, a community hall, the land for which was already bought and partly paid. This indirection of the grants in previous years, it was contended, was at the expense of the success of May and Fair Days.

### Apropos

There should be no surplus in the accounts of Fair and May Day celebrations, unless the public in great numbers present insist upon it and make it unavoidable. For the management to insist upon it is fatal. It is its part to spend to the limit of its resources for success.

If any one thing killed our celebrations it was the aim at a surplus, a surplus that has the habit of becoming a liability by investment. A private enterprise, mindful of the vicissitudes of fortune and the curves of trade lines, may wisely strive for a surplus, and build up reserves. But a public institution that depends on the entertainment and support of the people, its surplus and reserves must be built up in the hearts and minds and memories of the people, including the children. It is always available to be drawn upon there, and never a liability. Here applies: "Lay not up for yourselves treasures upon earth, where moth and rust doth corrupt, . . . But lay up for yourselves treasures in heaven . . . For where your treasure is, there will your heart be also."

For Sale

Cross, Rennie

Insurance, Real Estate, etc.  
Canadian Guaranty Co. (Incorporated in B.C.)  
37 Bute Street, Vancouver B. C.

For Sale

May Bird, A.L.C.M.

Paints and Papers  
Garden City Lulu Island

To Let

To Let

# Flour

IMPERIAL BRAND  
Made from the Finest of  
Hard Wheat

GRAHAM FLOUR,  
WHOLE WHEAT and  
PASTRY FLOUR

Made in B. C. by



We sell by sack or ton. Corn, cracked or whole; wheat, shorts, bran; oats, rolled or chopped; barley, ground or whole; chicken, chop, shell, scratch food or middlings.

Poultry Specials, beef, scrap, alfalfa meal and sunflower seed also in stock.

Eburne Flour Mill

Lulu Island

PHONE EBURNE 77

## The Curb Market

Modern civilisation can produce for the needs of all. But the marketing and economical distribution of goods from producer to consumer vexes the best minds of business and government. The problem has created a press, platform and a literature of its own. Distribution is so costly, and so many toil and profit takers come in between them, that both producer and consumer are in revolt.

But for the producers of Richmond, the Vancouver curb market is a high perfect solution of the problem. By electric car or trusty Ford, the smallholders of Richmond can run in with their eggs, butter, milk, preserves, vegetables, fruits, flowers, poultry, meats and herbs, sell their stock direct to the consumer, and return home in the early evening with the cash in their pockets. For the nominal fee of 25 cents they rent a stall on the street curb for a day, and buyer and seller get down to business, common sense enacting the law for every transaction. Too many laws spoil our sport and dull our wit in business.

The consumer gets fresh meats and vegetables at first hand; home-made, home-grown things at first cost. There is no boxing, crating, culling and dolling up to withstand the rough handling and mauling over of brokers, and transactions are done and ended for ever on the spot. May the Curb Market grow and flourish.

### Proposal to Enlarge Curb Market

The Richmond Board of Trade, at the instance of Mr. C. W. Lusk, passed a resolution that it "views with interest the proposal before the Vancouver City Council to improve and enlarge the Curb Market, increasing the facilities for direct trading between producer and consumer, and appreciates this practical encouragement to the prosperity of small industries in the surrounding districts."

The Ladner Board of Trade is to be commended for having passed a similar resolution.

# R. M. GRAUER

GROCER, BUTCHER & GENERAL MERCHANT

Live Stock Bought and Sold

Hardware, Fencing, Sacks, Binder Twine, Seeds

Phone Marpole 123

EBURNE