

Staff Report

Origin

In December 2005, Council approved the report: "Richmond Soccer Alliance Field Sport Proposal and Artificial Turf Installations," and staff were given the following referral:

" That Option 1A and 1B (as detailed in the report dated November 17th, 2005 from the Director of Parks Operations) be endorsed for future artificial turf field upgrades in Richmond, and that Council commit to four fields by 2008, as per the Richmond Soccer Alliance Field Sport Proposal.

That staff report to Council in 2006 with a phased implementation plan for additional future artificial turf installations in Richmond (as outlined in the report dated November 17th, 2005 from the Director of Parks Operations)."

The purpose of this report is in response to the above referral generated as a result of the Council endorsed Richmond Soccer Alliance proposal and to recommend approval of an implementation plan for two artificial turf field installations in 2008.

Findings Of Fact - 5 year Sports Field Improvement Initiatives

- 2002- Richmond's first artificial turf installation completed at Minoru Park on Field 2. The Minoru artificial turf has been a success with programming to facility capacity during the fall/winter season. The first installation of artificial turf is capable of hosting 2,080 prime-time games throughout the year whereas natural grass can host only 360 games per year, this equates to a 6:1 ratio of artificial turf versus natural grass usage.
- 2004/2005- City of Richmond begins preparation of Sports Field Strategy with a vision of creating an environment where "Everyone Can Play"
- 2005 - The Richmond School District and the City of Richmond partner in the development of Richmond's Second artificial turf field at Richmond Secondary School. This field, in close proximity to the Minoru field complex provides for tournament hosting abilities with 3 fields at Minoru nearby. The field is also actively used by the School district athletic programs.
- 2006- Council approves the Richmond Field Sport Strategy, the purpose of this strategy is to provide a vision (Everyone Can Play!) and direction for field sports in Richmond. The strategy identifies the needs and the gaps within the existing service delivery system, and identifies a prioritized list of specific areas of focus for a 5 year period.
- 2006 - Richmond Soccer Alliance Proposal approved by Council. 4 Turf fields are to be phased in over 2 years, Hugh Boyd being the first installation in 2006, and 2 locations to be determined in 2006 or 2007 for installation in 2008.
- 2006 - The Boyd Artificial Turf Field Complex is constructed. The field, the largest single artificial turf field surface in North America is 6 acres in size, or three full sized fields. The field complex is an instant success, and up to 250 players have been practising on the fields each hour. The facility is booked from 5pm to 11pm weekdays and all day weekends during the fall/winter and also heavily used in the spring/summer season.

- As of 2006 Richmond is home to 5 artificial turf field surfaces, per capita the provincial leader to date in the provision of high quality sports playing field surfaces.
- The Boyd field site is chosen as the home for the BC Provincial Cup Soccer Championships in 2007, and is also a major regional tournament site with the site hosting capacity including 3 turf fields and two sand based grass fields for a total of 5 surfaces.
- Last year, Richmond Sports Council and the City adopted the Provincial Government target of increasing participation in sports and wellness by 20 percent over the next five years. Just 12 months later, the city's youth soccer clubs have already met that five-year target.

This year's winter and spring soccer programs all increased registration. In total, youth soccer in Richmond grew by 660 players this year, an increase over 2005-6 of 22 percent as below:

Richmond Boys/Girls Soccer Registration

	2005-6	2006-7	Players Change	Per Cent
Richmond Boys (Fall/Winter)	1,497	1,522		
Richmond Girls (U5-18) (Fall/Winter)	960	1,052		
Boys/Girls Spring Program	579	1,125		
Total Year - Youth Soccer	3,036	3,699	+663	+22%

- Field user fees are introduced for the new Boyd Field complex and in addition, and over 145 Richmond youth have benefited from the Everyone Can Play soccer fee and equipment access program, and a local KidSport Chapter is being introduced in Richmond.
- 20 of the targeted 50 natural grass fields are released from the programmed inventory as a result of the new turf installations, these parks are returned to neighbourhood passive uses. The remainder are planned to be phased out after completion of the proposed 2008 artificial turf fields.
- Two new baseball diamonds are constructed at Manoah Steves and Blundell, including drainage improvements and lighting modifications- work required to accommodate displaced baseball uses from the Hugh Boyd Turf.
- 2007 -Richmond was the recipient of the Bell Canada True Sport Community Award at the prestigious Canadian Sport Awards held March 23, 2007 at the University of Manitoba in Winnipeg. The Bell True Sport Community Award promotes the importance of values based sport and publicly recognizes those communities that are living examples of fair and ethical sport initiatives.

Analysis

Community Field Sport Proposal Summary

As per the June 2005 Council endorsement of the Richmond Soccer Alliance proposal, the alliance of 13 Richmond soccer associations proposed "a new partnership with the City built on the City's Guiding Principles which will provide soccer fields that better meets the needs of its players and will better serve

the community of Richmond at large.” To summarize, this community initiated proposal identified the following:

- *The need to create quality playing field facilities in Richmond as opposed to the existing quantity of playing fields today.*
- *An offer from the Richmond soccer associations to institute a pay-for-play program based on per user estimated to generate \$140,000 per annum.*
- *Richmond’s soccer alliance has demonstrated their commitment towards the proposal by offering to contribute \$250,000 towards the capital costs of building the centre.*
- *The presentation of a collaborative proposal that benefits soccer, other field sports and neighbourhood parks city-wide.*
- *The release of up to 50 existing playing fields from Richmond’s current programmed inventory reducing the reliance on over 40 acres of neighbourhood park space city-wide.*

The proposal does not identify a particular site for the installation of field improvements or new fields in the community but does identify the need for facilities to achieve the following outcomes:

The outcomes of the proposal are to:

1. Provide long needed training and improved playing surfaces for 3,700 soccer players.
2. Reduce the number of soccer fields required by nearly 50, freeing up approximately 40 acres of park space for other community uses.
3. Reduce the chronic over-usage and damage to grass fields.
4. Improve the quality of diamonds for summer sports groups.
5. Improve the playability and quality of playing fields for other community sports.
6. Reduce the City’s annual operating costs to restore over-used fields which are currently shut down for rehabilitation from April to October annually.

Timing:

The timing of the community proposal, as endorsed by Council, for the proposed field improvements is for the Fall of 2006. As per the community proposal: “...if the facility cannot be built by the Fall of 2006, then the community proposal requests for completion and endorsement of the full project plan, with a significant first phase in 2006, and designation of potential funding and build-out by 2008.”

Since approval of the 2005 Richmond Soccer Alliance proposal, many of the planned outcomes have been met, others have been set as goals in the Richmond Field Sport Strategy.

Site Analysis Guiding Principles

The following guiding principles were developed in collaboration with Richmond soccer and baseball field user groups and endorsed in September 2005 by the Soccer Alliance proposal group for use in assessing various sites for lit artificial turf fields:

Sport Specific Requirements:

- That the needs of all field sport users be considered in the site selection and programming of the new artificial turf fields.
- That the needs of the athletes take precedent over the needs of spectators, officials and media in determining facility design priorities.
- That new fields and diamonds be built to meet minimum dimensions or better so that these facilities are adaptable to future changes in age groups allotted.

Everyone benefits:

- That any group that might be displaced by field/diamond renovation be first informed and be provided the opportunity to discuss options for relocation.
- That tourism hosting amenities be strongly considered in new field sport facility designs.

Phasing:

- That the preferred sites be prioritized in case the work has to be phased.

Neighbourhood & Environmental Impacts:

- That the impacts upon adjacent property owners/residents be considered in the locations selected for lit artificial turf fields.
- That a recommended lighting buffer standard of 50 metres from residential housing be adhered to.
- That efforts be made to retain mature trees, and tree protection is a priority.
- That the new facilities be compatible with the intended use and character of the park.
- That community consultation will be done for future new installations of lit artificial turf fields.

Technical Requirements:

- That artificial turf and natural turf not be mixed on the same playing field or diamond.
- That proper sun orientation be considered in the layout of fields and diamonds.
- That capital and ongoing maintenance costs be strongly considered in selecting locations for lit artificial turf fields.

Need

- That there be a demonstrated need for any replacement fields or diamonds.

Site Selection Evaluation Criteria

The following site selection criteria were used to assess the suitability of the site options considered.

Adequate Size	Meets the same standard (or bigger) for field dimensions, safety buffers and walkways as were used for fields at Minoru and Richmond Secondary.
Groups/Activities Displaced:	Includes other sport facilities such as fields, diamonds or leases.
Accessibility	Conditions such as soil conditions, drainage, sun orientation and close proximity to the majority of participants should be considered.
Park Compatibility	The park has been identified in the original site/park Master Plan as an approved site for athletic field sport features.
Neighbourhood Compatibility	The potential impact to residents of an heavily used active sport facility being placed adjacent to their homes. Factors such as light spillage, noise, traffic congestion, parking should be considered.
Field Light Pollution	Meets the parks standard of light illumination being 50 metres or more away from residential houses.
Tree Protection	The number of mature trees that will have to be removed and/or relocated.
Timing	The earliest construction start date - the Council endorsed proposal is for commencement in 2006 with completion in 2008.
Land Ownership	The ownership of the property. Properties that are not owned by the City of Richmond will require additional approval.
Existing Amenities	What amenities are already present at the site, i.e. adequate power, lights, washrooms, parking, storage, other fields etc.
Tournament Opportunities	Is the site compatible for hosting tournaments i.e. adequate parking, washrooms, change rooms, spectator seating, concessions etc.
Park Impact	What existing uses of the site have to be considered, can they be relocated elsewhere on existing facilities, or will they need new facilities built to replace them? What other school and community sport field user demands can be accommodated on the new facilities?
Added Capacity	The number of additional sand field equivalents that will be added to the City's current supply of field sport facilities.
Displacement Cost	The cost of replacing any park features such as fields, ball diamonds, pathways or trees that need to be replaced and/or relocated.
Total Cost	The total cost of constructing the new lit artificial turf fields plus all costs of relocation or replacement of existing park features such as fields, diamonds and trees.
Guiding Principles	Does the option support the guiding principles endorsed by the field sport community for future field upgrades?

Location Analysis:**1. Hugh Boyd Natural Grass Sand field Conversion- Not Recommended**

With approval of the 2006 Hugh Boyd Complex, several field locations were identified as potential sites for future artificial turf installations. Preferred field locations in 2006 included the potential installation of an additional field at Hugh Boyd park in the Hugh Boyd Oval sand field.

Since the installation of the 3-field, 6 acre artificial turf complex at Hugh Boyd, the soccer community, and staff, have revisited this option and do not recommend it proceeding at this time. With the additional game and practice space at Boyd currently as a result of the artificial turf installation, the two natural sand grass fields there are being reserved for games only.

These fields are perhaps now Richmond's highest quality natural grass game playing surfaces and are coveted by the players and field sport community- they have been reserved for game use only and do not have the same level of annual wear/damage done to other grass fields throughout the City. A conversion either of these fields would eliminate the opportunity for Richmond to offer a championship quality grass field surface for games and tournaments.

2. Minoru Oval

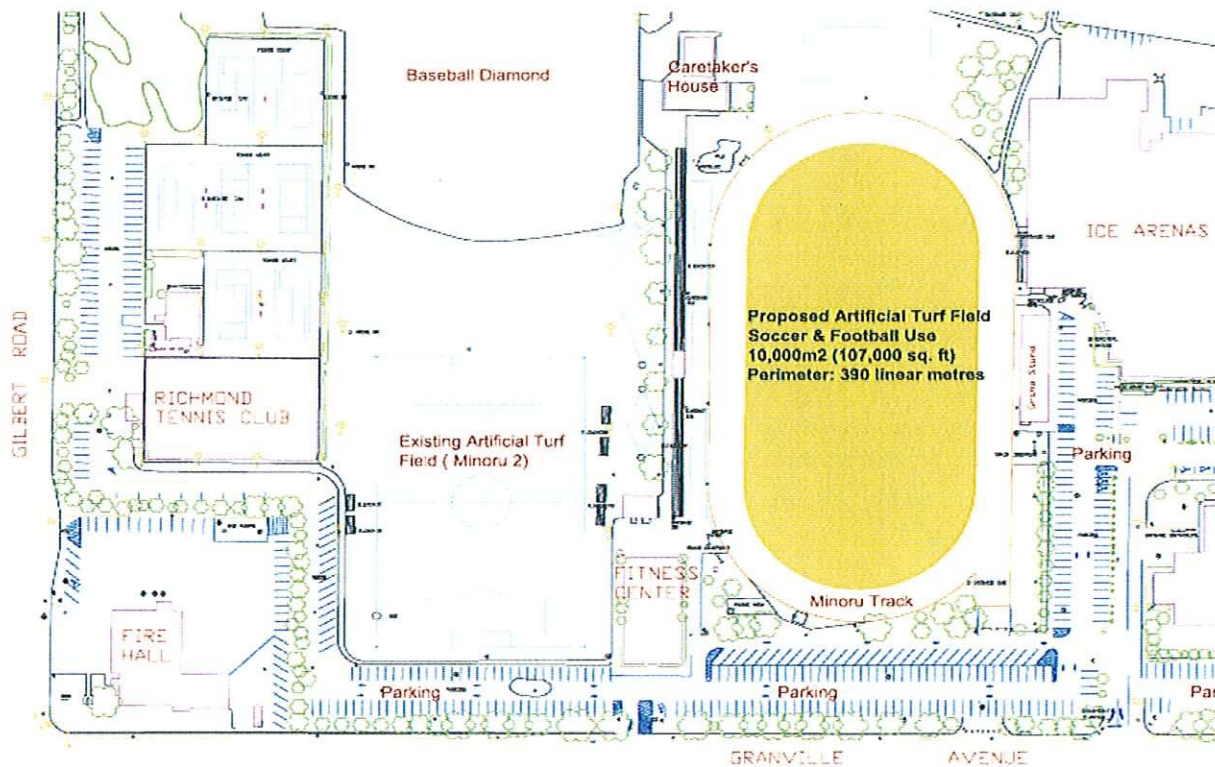

Minoru Park Oval

Address: 7000 Block of Granville Avenue

Total Artificial Turf Area: 10,000 sq. metres (107,000 sq. ft) estimated cost: \$1,200,000

Site Opportunities:

The opportunity to convert the centre of the Minoru Oval to artificial turf presents the community with a field surface area that can accommodate soccer, football, community events, and other field sports. The improvements could take advantage of existing lighting, the grandstand stadium 400 person covered

seating, and an additional 500 person outdoor seating in the bleachers. The total area inside the oval allows for a larger field configuration including the two 'd' areas of the field allowing for end zones and additional field practise space. Also this site would not allow the introduction of organic elements such as dirt in the area.

The site has ample parking, and washroom amenities near by, as well is located close to the existing Minoru turf field, and the Richmond High Field, presenting excellent tournament hosting opportunities. Additionally, by converting the field to a soccer/football field configuration, there is a potential to use this project to find a long needed home for rugby by freeing up field space at McNair Park currently used by football.

Construction cost efficiencies would be found in the utilization of the existing park drainage system, and lighting system as well. The proposal to upgrade the Minoru oval field has strong support from the field sport community, at the June 12, 2007 Richmond Sports Council meeting, the following resolution was approved:

"Given Richmond's need for a usable, enclosable community stadium, and the current poor quality of Minoru Oval for multiple sports, Richmond Sports Council recommends that Minoru Oval be regarded as a prime candidate for location of one of the two AT fields to be built in 2008".

Site Constraints:

The draft Minoru Park Master Plan indicated that the Minoru Oval and grandstand were amenities that were valued by the community and should stay in the park for the future. However, through the master plan process, it was also noted that due to heavy public and track and field use of the track surface, that programming of the oval field should be limited to evening and game time uses. A conversion to turf would not contribute to any additional distribution of artificial turf in the community park system as there are already many amenities centralised at the site today.

Consideration could be given to alternate sites that allow for a more equal distribution of artificial turf field surfaces city-wide, or adjacent to secondary and high school facilities to maximize site usage.

Staff have contacted the Kajacks Track and Field Club, and they have indicated their support for a turf field at Minoru, however would like to see the City enforce and control the walkers and joggers who use the track during their practises. They have indicated that additional signage around the park is necessary to prevent track and field activities from being in conflict with public use of the track.

Today the Minoru oval is an open site, and the installation of a turf field requires some sort of perimeter fencing to prevent dogs, and vehicles from accessing the site. A conversion to turf would require that a 4-foot perimeter fence be installed at the south end of the track, and the north end of the track to prevent vehicular access and to prevent dog owners from accessing the athletic park site.

Any fencing inside the field area would present a hazard to track and field use as well as a visual barrier to track running event activities and competitions. An additional potential hazard with locating artificial turf inside the oval is the potential for the field ground rubber to be spread on to the track surface causing a possible maintenance conflict and possible slip hazard to track users.

King George Park- Recommended

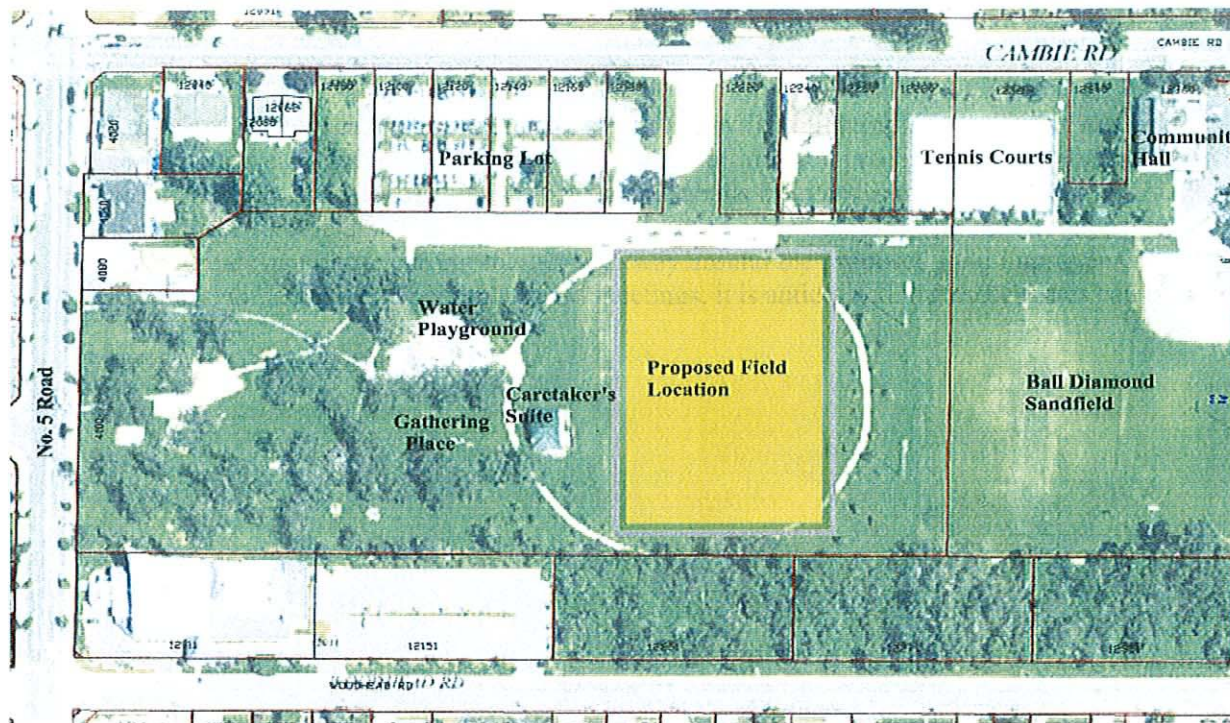

King George Park

Address: 4100 No. 5 Road

Total Artificial Turf Area: 7526 sq. metres (81,000 sq. ft.) estimated cost: \$1,400,000

Site Opportunities:

The King George Park site is currently programmed for field sport uses for community and school district programs. Recent improvements to the site include the installation of a caretaker and parking area that are adjacent to the current field facilities, and the site is one of the few in the parks inventory with perimeter walkway lighting in the evenings.

Consultation with Richmond's field sport community indicates a high level of support for a field installation at this site, as well it was identified as a potential site in 2005. Staff have also received a letter of support from the East Richmond Community Association in support of a future artificial turf field installation in King George Park (Attachment 1).

Installation of an artificial turf field at this site would more equally distribute the provision of all weather field facilities across the City and allow for more active use of the current field which is not playable for much of the year due to drainage issues and overuse. With the proximity to McNeely Elementary, Cambie Secondary school, and Mitchell Elementary school, and the community centre, the field could be used by the district athletic programs, and community programs year round as well.

Increased evening usage of the park site would also improve the public surveillance of this area of King George Park, which has been a site of late night activity for many years. Increased public access to the site via the proposed artificial turf field would be introducing positive evening activities to the site potentially reducing unwanted evening park activities.

Nearby amenities include parking, washrooms, a children's play area and gathering place at King George Park. As well, the caretaker facility is strategically located at the edge of the proposed field which would provide excellent surveillance.

Site Constraints:

The proposed field location does not currently have any field lighting. The adjacent baseball playing field does include field lighting today, and a community information process would be necessary as with other field lighting installations. Additionally, to prevent balls from entering the nearby parking area, as well as to contain the turf field site, perimeter fencing would be necessary. The site design process would also include a re-design of the current 'circle' walkway around the proposed field improvement. Through site the site design process, and neighbourhood meetings, it is anticipated that these issues can be addressed.

South Arm Park- Concept Only

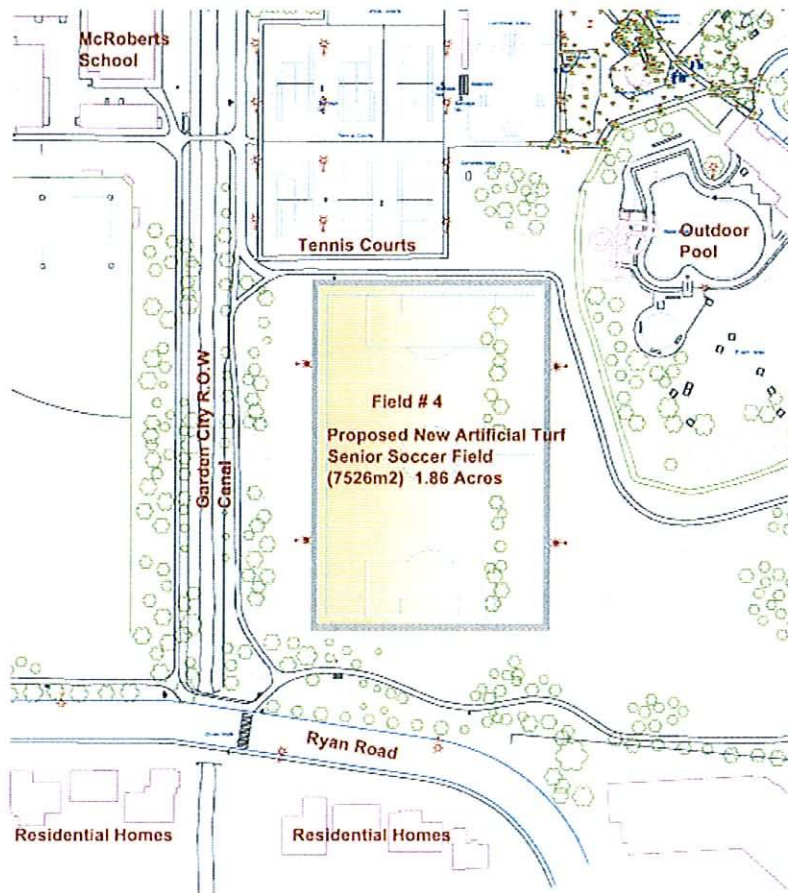

South Arm Park – Field 4

Address: 9020 Williams Road

Total Artificial Turf Area: 7526 sq. metres (81,000 sq. ft.) estimated cost: \$1,600,000

Site Opportunities:

South Arm Park is one of Richmond's oldest Community parks and has a high level of athletic use today. Property ownership at the site is a mix of city and school district lands and any field installation would

require consultation with the Richmond School District. The proximity of Whiteside Elementary, and McRoberts Secondary school, and the Community centre present great opportunities for daytime programming and enhancement of current program offerings.

The proposed installation of an artificial turf field at South Arm also would contribute to the equitable distribution of all weather artificial turf fields city-wide. Staff have also received a letter of support from the South Arm Community Association (SACA) indicating their support for a future artificial turf field to be located at South Arm (Attachment 2).

Additionally, SACA has offered to fund the cost of walkway lighting for the park. The financial value of this offer would be dependant on the proposed scope of walkway lighting and a design process which to ensure a safe installation. Should a field not proceed, it is unknown if the offer to 'assist' in walkway lighting would remain.

Field 4- as indicated in the concept drawing above is the optimal location for an artificial turf field as previously indicated to Council in 2005. However, the site presents many constraints that require attention prior to proceeding with a turf field installation.

Site Constraints:

South Arm Park possibly has the greatest number of site constraints today of any community park field site, these include:

- **Site Master Plan:** The South Arm Park master plan is due for revision. This process typically involves the recruitment of consultants and engagement of all of the park and community stakeholders, as well as the neighbourhood to provide feedback on the park site and to identify any community needs that may be addressed. The South Arm Community Association initiated neighbourhood needs analysis in 2005 which can be used as background information for this process.
- **Lighting:** the site has no field lighting today, the introduction of lighting at this field site would have to be carefully engineered and a public consultation process would be necessary. Given the close proximity to residential homes along Ryan Road, and the apartments and single family residential properties on the east and west sides of the park, glare and light spillage would be very difficult to contain.
- **Property Ownership:** the site at South Arm is a mix of property ownership and consultation and agreement with the Richmond School District would be necessary for many field configurations on the site
- **Displacement:** South Arm is a park built to capacity today. The removal of any one element or introduction of a new facility or programmed use may require the relocation of other amenities. For example, many of the rectangular soccer facilities on the park today, also double as baseball diamonds and outfields, all heavily used year round. The installation of a turf field needs to respect the needs of baseball on the site as well.
- **Trees-** South Arm is a site with significant trees, many of which are mapped and dedicated by the community years ago to the community. Staff arborists estimate the relocation of trees at the site would cost \$10,000 per tree. for example the concept diagram above would have a financial implication of \$170,000 to relocate established large trees.

- ❑ **Parking:** South Arm park already has challenges from the existing school, community facility, baseball, swimming pool, tennis facilities, playground, community hall and soccer parking demands. Staff annually receive complaints from residents on Ryan Road from public parking in the residential areas. A parking study to determine appropriate parking would be a part of the master plan.
- ❑ **Surveillance and Security:** The field sport playing areas at South arm are not in close proximity to the existing park caretakers. Site security is a major concern at this site. Examples of recent vandalism include the arson events at the South Arm Pool hedge.
- ❑ **Whiteside School:** Staff have been informed that in the future Whiteside elementary in South Arm park may be rebuilt. The potential configurations of this school would need to be considered within a park master plan process

Summary- South Arm:

South Arm may be an ideal location for a future artificial turf field. Prior to considering an exact location of a potential artificial turf field at this site, staff recommend the completion of a park master plan and community consultation process which will confirm the feasibility and suitability of an artificial turf installation at South arm.

Summary of options for consideration:

1. **King George and South Arm- Recommended:**
 - a. Approve the concept of installing one artificial turf field at King George Park in 2008, subject to the completion of a neighbourhood public information process and;
 - b. Initiate a comprehensive park master planning process for South Arm Park which will in part, determine if an artificial turf field is a feasible and appropriate amenity at the site.
2. **King George and Minoru – Not Recommended**
3. **South Arm and Minoru – Not Recommended**
4. **No field Improvements -** This option would not meet the needs of Richmond's current and future field sport community, and would not present any financial implications. Deferring any potential sports field amenity improvements will not address the existing current reality as described by the community soccer alliance proposal.

Financial Impact

The proposed field installations as detailed in this report would have the following financial implications: King George Park artificial turf field- \$1,400,000. The South Arm Master Planning process would have a financial implication of up to \$50,000 and be funded from parks advanced design. Installation of an artificial turf field, at South Arm is estimated to be \$1,600,000 but the actual cost would be determined upon final location of a field, displacement costs and other required amenities as determined through the park master planning process.

Council has approved a capital submission of \$3,500,000 in the current 5 – year capital plan towards the 2008 artificial turf installations as per the Richmond Soccer Alliance completion project detailed in this

report. Any funding towards these proposed turf field projects would be confirmed at the completion of the 2008 budgeting process. This funding towards these proposed turf field projects would be confirmed at the completion of the 2008 budgeting process. Therefore installation of these fields will be subject to confirmation of such funding.

It should be noted that the Richmond Soccer Alliance has fulfilled their commitment of providing \$250,000 in community donations towards the 2006 Hugh Boyd Field Improvement project. Field user fees are also being collected on each artificial turf field in Richmond today.

The operating budget impact from the proposed fields is currently estimated to be \$18,588, and has been included in the current Council approved operating budget impact portion of the 5 year capital plan. This operating budget impact includes operating maintenance for the new field facilities, as well as the increased usage of washroom facilities at the two park sites. The field maintenance will be reduced through the collection of field user fees.

Additional impacts to the washroom facilities in the community centres located adjacent to King George and South Arm would require an additional \$10,000 as an operating impact. Again, the operating revenue generation is estimated to be \$20,000 from user fees at the proposed fields and can off-set this additional increase.

Conclusion

Richmond has a long history of providing innovative solutions in the provision of outdoor field sport amenities that are well utilized, often beyond capacity. The proposal to install additional artificial turf sports fields builds on Richmond's tradition of striving to provide the best possible field sport amenities. The proposed improvements satisfy the site selection criteria and guiding principles developed to address the Council endorsed Richmond Soccer Alliance proposal.

The additional artificial turf will increase Richmond's ability to host field sport tournaments, reduce play on existing overused natural grass facilities.

This report proposes the installation of two new artificial turf surfaces that would provide a more equal distribution of high quality playing field surfaces throughout the City; the future installations will directly contribute to Richmond's vision of becoming the most appealing, liveable and well managed community in Canada.

If South Arm is approved as a preferred site, prior to construction additional planning is required, particularly at the South Arm Community Park site. This report details the need for a comprehensive park master plan prior to making any commitments for a future field installation at South Arm.

If approved, staff will begin advanced design preparations and prepare the necessary public consultation processes and capital program submissions to facilitate commencement in the 2008 year. Staff will continue to monitor actual usage of the current field sport facilities, and the impact of the additional fields on the entire outdoor sports field system in Richmond's parks. Future facility developments will need to be evaluated against other civic and community parks and recreation capital facility priorities.



Mike Redpath

Manager, Parks - Programs, Planning & Design
(1275)

Attachment 1



EAST RICHMOND COMMUNITY ASSOCIATION

50 YEARS OF COMMUNITY PARTNERSHIP

February 9, 2007

Mayor and Councillors
City of Richmond
6911 No. 3 Road
Richmond, BC V6Y 2C1

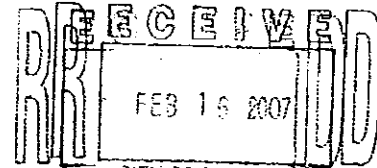

CITY OF RICHMOND
C.A.C.'S OFFICE

*Feb 16/07
- Copy to
D.S. / Anne
Stevens
- DS
- please prepare
reply.*

Dear Mayor Brodie and Councillors:

Re: Artificial Turf in East Richmond

We understand that the City of Richmond is planning to place two artificial turfs during 2008.

On behalf of East Richmond Community Association, we would like to urge you to consider placing one of those artificial turfs in King George Park

As you are aware, King George Park is one of the most used parks in the area. It is the centre of East Richmond. As part of our East Richmond Healthy Community Project we have a lot of initiatives designed to improve the area. Placement of artificial turf at King George Park would be another welcome addition to our community. We would appreciate your favourable consideration in this matter.

Sincerely,

Balwant Sanghera
President
East Richmond Community Association

cc: Rob Howard, Council Liaison, East Richmond
Jim Lamond, Chair, Richmond Sports Council
Cathy Volkering-Carlile, General Manager, Parks, Recreation and Cultural Services

CAMBIE COMMUNITY CENTRE

2079016 4111 CUMBER ROAD, RICHMOND, B.C. V6V 1N7 TEL: 273-6300 FAX: 273-6301



Attachment 2



SOUTH ARM COMMUNITY ASSOCIATION

pc-councillors
 - CAO
 - GM, Parks, Rec & Culture
 - Dir. Parks.

May 10, 2007

formule keep

Mayor Malcolm Brodie
 Richmond City Councillors

Copied & distributed to all.
 Date: *May 15/07*
 Initials: *AM*

Re: South Arm Community Association Support for Proposed Artificial Soccer Field for South Arm Park

I am writing on behalf of the South Arm Community Association to:

- express our very enthusiastic support for this initiative, and
- further pledge financial support to this project

We see this proposed project as one that will provide a significant benefit to our community and to all of Richmond. The South Arm Park is a large and superb community facility that serves both South Arm area families and Richmond-wide residents and sports users.

In my last meeting with the Richmond Soccer people about this initiative we discussed how the South Arm Community Association could lend our support to this initiative. The one very exciting idea that I would support is that we could assist with the cost of secondary lighting for the park. This general park use and safety lighting could be mounted and powered off the main field lighting standards and could be used to

- improve security and safety for evening users of park.
- extend the usefulness of the walking and running paths around the outside of the park and the soccer fields when the main field lighting was not on. With the busy schedules that we all have today, a method to extend the use of an existing park facility is a real win
- encourage even more Richmond citizens to exercise in this park and become more fit

This new artificial field would be an ideal fit to the recommendations coming out of South Arm's recently completed Vibrant Community Initiative in which many members of our community were extensively polled and engaged in Focus Groups to learn their needs. Identified N1-DS from the consultant's survey results included the recommendations to:

- To invest in more facilities for the South Arm Park, and
- To provide increased fitness and exercise facilities for the South Arm area, and
- To continue supporting the health and wellness activities already associated with the South Arm Fitness facility.

City of Richmond
 RECEIVED
 MAY 15 2007
 MAYOR'S OFFICE

- 2 -

We would hope to in turn be able to partially program the use of the field during the daytime off-peak hours. I can only begin to think of a partial list of the new and enhanced programs that could be offered to the public on an all-weather field that would not become the wet soggy bog that appears in our fields later into the rainy season. We can get more people out into the healthy outdoors to exercise and enjoy physical activities. Some ideas that immediately come to mind include:

- soccer for new moms – and we have the facility and experienced staff to provide the childminding right on site at the Centre
- tai chi for all ages
- bocce ball
- extension of some of our very popular fitness and aerobics programs
- enhancements to our large Out-of-School Care programs
- more general wellness activities coordinated with other new city programs taking advantage of being outside in the winter when it is not raining but there is a dry safe footing on the field

Sincerely



Ian Shaw
President, South Arm Community Association

cc: David Gillis, South Arm Fitness Coordinator
Jim Lamond, Chairman, Richmond Sports Council
Roger Barnes, President, Richmond Youth Soccer
Roy Matsuyama, Area Coordinator, South Arm
Peter Healy, Principal, McRoberts High School