



REPORT TO COUNCIL

TO: Richmond City Council
FROM: Councillor Harold Steves, Chair
Parks, Recreation and Cultural Services Cttee.
DATE: April 3, 2002
FILE: 7000-09-20
RE: **NIKKEI FISHERMEN'S COMMITTEE ARTWORK DONATION TO THE CITY -
JAPANESE FISHERMEN MEMORIAL**

The Parks, Recreation and Cultural Services Committee, at its meeting held on Tuesday, March 26, 2002, considered the attached report, and recommends as follows:

COMMITTEE RECOMMENDATION

That:

1. *the artwork donation from the Japanese Canadian Fishermen's Committee to the City of Richmond (as presented in the report dated March 6, 2002 from the Manager, Policy Planning), be accepted.*
2. *the City contribute \$10,000 from the Public Art Fund to the public art project.*

Councillor Harold Steves, Chair
Parks, Recreation and Cultural Services Committee

Attach.

VARIANCE

Please note that staff recommended the following:

That the artwork donation from the Japanese Canadian Fishermen's Committee to the City of Richmond (as presented in the report dated March 6, 2002 from the Manager, Policy Planning), be accepted.

Staff Report

Origin

On February 20th, the Nikkei Fishermen's Committee submitted a proposal to donate an artwork to the City commemorating the Japanese Fishermen.

The Nikkei Fishermen's Committee submission is presented on **Attachment 1**.

The purpose of this report is to present:

- An overview of the Nikkei Fishermen's Committee,
- The rationale for the proposed gift to the City,
- The proposed artwork design, theme, materials, and artist,
- The proposed artwork location, and site plan,
- The proposed site preparation, anticipated maintenance, and related costs,
- An overview of the proposed artwork budget and fundraising program,
- The Review process and independent panel comments,
- The staff comments, and recommendations to Council.

Findings Of Fact

Overview of the Nikkei Fishermen's Committee

The Nikkei Fishermen's Committee is made up of retired fishermen, most of whom who reside in Richmond, and who came together over a year ago to undertake a project to honour and recognize the contribution that Japanese-Canadians have made to the development of the commercial fishing industry in BC. Key partners in the overall venture also include the Japanese Canadian National Museum and the Wakayama Kenjin Kai.

Rationale for Proposed Gift to the City

The artwork theme is "to honour the working Japanese Canadian fisherman whose contribution to the fishing industry should never be forgotten". The Nikkei Fishermen's Committee believes that Steveston is the most suitable community for the proposed artwork, as it has been a key port, fishing industry centre and home for many Japanese Canadian fishermen. The BC Packers site, as a former major fishing enterprise, is the most suited place to honour the Japanese Canadian fishermen.

Proposed Artwork design, Materials, and Artist

The proposed artwork is a bronze sculpture that is simple with a human scale (4' 3" height), easily recognizable by all ages. The sculpture places emphasis on form rather than detail. It depicts an image of a sitting fisherman holding a fish and a net. The image could be of a fisherman 100 years ago, 20 years ago, or today (see **Attachment 2**).

Nikkei Fishermen's Committee has commissioned a local Japanese Canadian Richmond artist, Junichiro Iwase, to design the bronze statue.

Proposed Location and Site Plan

The proposed location for the sculpture is on a future park site on the BC Packers land. The proposed site plan for the area is shown on **Attachment 3**.

Proposed Artwork Site Preparation, Installation and Anticipated Maintenance Costs.

The BC Packer's area in question is currently being developed for housing by Onni Developments Ltd. As part of the development, Onni is undertaking basic site preparation work for the housing site and the adjacent areas including the propose park site.

Onni has also agreed to cover the cost of installing the sculpture at the designated location.

The proposed bronze material for the sculpture is expected to result in minimal maintenance cost for the City. It is expected that the proposed sculpture will require ongoing site maintenance of the ground surrounding the artwork, periodic cleaning, and security monitoring.

Nikkei Fishermen Committee's Artwork Budget

The total budget for the development of artwork is \$55,000. To date, most of the private contributions for this work have already been raised, with the remaining funds to be received shortly. The budget is further detailed on **Attachment 1**.

The Committee does request that the City of Richmond contribute:

- Site preparation and installation costs, and
- \$5,000 towards the completion of the project.

Proposed Artwork Ownership, Transfer to the City

If the proposed artwork donation is acceptable to the City, the Nikkei Fishermen's Committee will donate the sculpture and transfer ownership of the works to the City. With this gift, the Committee anticipates that the City will provide on-going maintenance, cleaning and security of the sculpture and the grounds immediately around it.

Analysis

Guidelines for Private Donations of Public Artwork to the City of Richmond

On September 13, 1999, Council endorsed the "Guidelines for Private Donations of Public Artwork to the City of Richmond" (**Attachment 4**). These Guidelines have been established to evaluate proposed voluntary public art gifts from private sources.

The Guidelines include "Acceptance Conditions" and "Public Art Selection Criteria" (e.g. City Sites, Theme, Relevance, Artistic Excellence, Physical Durability, Public Safety, Costs, Legal).

The Guidelines state that all proposed gifts are to receive independent assessments by an independent public art review panel made up of artists, design professionals and citizens.

Public Art Review Panel

The Public Art Commission set up the 5 member Panel made up of the following individuals:

- ❑ Dick Aporta, Richmond resident and retired high school art teacher,
- ❑ Masa Ito, Richmond resident and landscape architect,
- ❑ Joan Kellinghusen, Richmond resident,
- ❑ Barbara Zeigler, Richmond resident, artist, and UBC Fine Arts Professor, and
- ❑ Alberto Replanski, Richmond resident and sculptor.

Public Art Review Panel Findings

The proposed artwork:

- ❑ Conforms to the standards as presented in the Guideline's "Acceptance Conditions" and "Public Art Selection Criteria".
- ❑ Is humble and modest in design, yet simplistic in form and presentation.
- ❑ Is a traditional piece, and yet well memorializes and honours the Japanese community and the fishers.
- ❑ Presents an approachable figurine to the public.
- ❑ Is suitably located within the park and its natural setting by the river.
- ❑ Inspires a sense of emotion as a result of its tilted head toward the front and as a result of its human scale.
- ❑ Focus toward the river presents a sense of interest and surprise to the approaching public from the rear.

The proposed artwork base should:

- ❑ Be of a natural rock material, as presented.
- ❑ Allow for a continued visual integration and connection with the artwork.
- ❑ Be set as low on the ground, not more than 3 feet in height, to maintain scale with the public.
- ❑ Be easily accessible and approachable to the passing public.
- ❑ Have minimal landscape around it to permit people to touch it without damaging adjacent landscape.

The Public Art Review Panel unanimously endorsed:

- ❑ The proposed Japanese Canadian Fishermen artwork and its proposed location, and
- ❑ Recommends that Council consider to accept the artwork donation from the Nikkei Fishermen's Committee, subject to no City funds be allocated toward the installation of the work on-site.

Staff Comments of Proposed Artwork Donation to the City

City staff have met with Dr. Tanaka, Nikkei Fishermen's Committee on numerous times to discuss the proposal. A meeting was arranged with Onni Development to meet on the former BC Packers site to visualize where the sculpture would be located. The site that was finally selected provides a number of advantages that include close proximity to a parking area for easy access for some of the older members of the community, an open grass area for gatherings, it is immediately adjacent to the river, and the views are excellent of Steveston Village, the mouth of the Fraser River, and Gulf Islands in the distance. The site had obvious sentimental value to the fishers who joined us on the site tour.

March 14, 2002

- 5 -

Onni Development has expressed interest in assisting with the project by providing the concrete base and site preparation with this proposal.

Staff believe that the simplicity and the realism expressed in the final art work is easy to understand and provides animation to the park by adding a 'human' face to the history of the area, therefore, would not conflict with other parks elements.

However, staff believe that request of \$5,000 contribution to the works is precedent setting, one that may result in similar requests from future private donors. Staff suggest that the Nikkei Fishermen's Committee be request to seek the additional \$5,000 through their existing fundraising program.

In addition, the Guidelines For Donation of Public Artwork specifically state that " The City will consider gifts of works of art for placement at City owned sites on the understanding that no City funds will be required for production, siting, and installation."

Staff recommend that Council consider accepting the proposed sculpture gift from the Nikkei Fishermen's Committee for placement at the site identified in this report (**Attachment 3**).

Financial Impact

The artwork will require ongoing site maintenance of the ground surrounding the artwork, periodic cleaning, and security monitoring.

Conclusion

The proposed sculpture of the Japanese Canadian fishermen represents a significant gift, one that will promote Richmond history, honour the Japanese Canadian community, and commemorate the contributions of the Japanese Canadian fishermen.



Kari Huhala
Senior Planner

KEH:keh



Japanese Canadian National Museum

Nikkei Fishermen's Reunion Project

Richmond Public Art Commission
C/o city of Richmond
Urban Development Division
6911 No. 3 Road
Richmond, BC
V6Y 2C1

February 8, 2002

RE: Nikkei Fishermen's Reunion Project- Donation of Statue of Japanese Canadian Fishermen to City of Richmond

The Nikkei Fishermen's Committee proposes to donate a statue to the City of Richmond in 2002. Attached is our submission for your consideration and approval.

It is proposed that the life size statue of a Japanese-Canadian Fishermen poised to process a fish would be erected on Steveston's re-developing waterfront. Site options have already been reviewed in a preliminary manner with some members of City Council and the Parks Planning department.

Progress and development of the Japanese-Canadian community, the BC commercial fishing industry, and City of Richmond started back in the 19th century and together all three have moved forward and come together to shape a part of Canadian history. The statue will be a permanent recognition of the contribution Japanese-Canadian fishermen have made to the development of the west coast commercial fisheries. Much of this development has occurred in or been associated with Steveston and Richmond.

Richmond artist Jun Iwase was commissioned by the Nikkei Fishermen's Committee to come up with a design that has broad appeal to all segments of the public and yet captures the spirit of the pioneer Japanese-Canadians who settled in Richmond. We believe Mr. Iwase has been able to accomplish this in collaboration with the retired senior fishermen.

Since Japanese-Canadian history is so tied to the history of Steveston (Richmond), the Nikkei Fishermen's Committee in donating this statue, is asking the City of Richmond to participate as a partner with associated project costs. These would include site preparation, statue installation, on-going maintenance, and \$5000 towards the cost of this project.

104

Nikkei Fishermen's Committee

February 2002

428 Glenbrook Drive • New Westminster, B.C. • V3L 5J5 • Tel: 604-524-9897 • Fax: 604-524-9897



Japanese Canadian National Museum

Nikkei Fishermen's Reunion Project

Respectfully, the Nikkei Fishermen's Committee, many who are retired fishermen and prominent long time Richmond residents asks you to consider our submission. Should you have any questions or need elaboration, please contact me at (604) 274-4222 (W), (604) 274-1684 (H), or 7571 Montana Rd. Richmond BC V7C 2K7

Sincerely,

Dr. Jim Tanaka

On behalf of the Nikkei Fishermen's Committee

Cc: His Worship, Mayor Brodie
Richmond City Councilors
Mr. David Semple
Ms. Yvonne Stitch
Ms. Cathy Carlile

Proposal for the Donation of a Commemorative Statue to

**The City of Richmond and
The Public Art Commission**

By

The Nikkei Fishermen's Committee

February 8, 2002

Nikkei Fishermen's Committee¹

The ad hoc group members are all retired fishermen, most of whom reside in Richmond and who came together over a year ago to undertake a project to honour and recognize the contribution that Japanese-Canadians have made to the development of the commercial fishing industry in British Columbia.

The core committee, which comprises 12 members, plus 4 facilitators, has been meeting faithfully twice monthly at the Steveston Japanese-Canadian Cultural Centre in Steveston to plan and carry out their project. No one is paid for his or her participation. All staff support by facilitators has also been unpaid (assembling a data base, communications, proposal writing, mailing lists, administration, fundraising etc.)

There are 3 components to the project:

1. Reunion Dinner for Japanese-Canadian Fishermen and their spouses.
2. Commissioning and placement of a statue on the Steveston waterfront in memory and recognition of the contribution of Japanese-Canadian fishermen to the development of the commercial industry.
3. Publication of a photo-history of Japanese-Canadian participation in the fishing industry.

Part 1 was successfully concluded on November 3, 2001 with over 300 Japanese-Canadian fishermen and their spouses, widows and widowers gathered together at the Steveston Buddhist Temple hall and participated in a jubilant reunion. Though the average age of the guests was approximately 75 years, people came from as far away as Toronto and Prince Rupert. A good number had not seen each other for 60 years, when they had been relocated from the coast.

Mayor Brodie and Councilors Kumagai and McNulty who were invited guests, got to sample of some the traditional fishermen's feast and witness the festive program.

Part one was successfully planned, organized and executed under budget. It is with the same commitment that the Nikkei Fishermen's Committee is already into parts 2 and 3 of the project.

¹ Nikkei refers to those of Japanese ancestry

Key partners in the overall venture that should be recognized are the Japanese-Canadian National Museum and the Wakayama Kenjin Kai (Wakayama is the prefecture or ancestral origin for many Japanese-Canadians in BC).

Rationale for Purpose of Gift

Steveston and more recently, the City of Richmond has been a key port, fishing industry centre and home for many Japanese-Canadian fishermen. And despite the prominent role that Japanese-Canadians have played in the development of the West Coast fishing industry in Canada there is no permanent recognition of this on the landscape. It would be fitting if a monument was erected recognizing the contribution of Japanese-Canadians to the fishing industry and most appropriate if it was sited in historic Steveston.

Purpose of Artwork and theme from Artist

The Nikkei Fishermen's Committee has commissioned a local Japanese-Canadian Richmond artist to come up with a design and ultimately a statue in bronze that would be placed on the Steveston waterfront. His statement of themes is captured as follows:

"Looking at old photos and listening to the stories of the senior fishermen from the committee and outside committee, I soon realized that this was going to be an intensely emotional project for the fishermen and their families. These men have their own vision of the monument, some want to see a salmon as part of the design, others a fishing net, and some a fishing boat. One thing I found in common when talking to these men was that they were all modest people. At that moment, it soon became clear to me that the best way to honor them is to show them an individual. Not to demonstrate what a salmon looks like or boats with nets, but a working class individual whose contribution to the fishing industry will never be forgotten. The sculpture I have developed is a simple one, which places emphasis on form rather than detail. It is an image that can be easily recognized by a child and understood by an adult." It is an image of a fishermen 100 years ago, it could be 20 years ago and yes, it still could be today. It is the image of a father, grandfather, and uncle..... it is collectively ours. It is simple and not abstract, yet it touches all of us (non Japanese-Canadians too). And while there are many places of historical significance to Japanese-Canadians in BC, cannery row in Steveston holds a special significance.

Project Time Line (for Statue)

Oct /01 -Artist's drawings and the clay model are reviewed and approved by the Nikkei Fishermen's Committee.

- Nov 3 /01 -The model is publicly unveiled at The Reunion Dinner in presence of His Worship, the Mayor of the City of Richmond, Mr. Brodie.
- Dec /01 -Project budget is reviewed and confirmed based on estimates received from a number of foundries in Canada and the US.
- Jan /02 -Decided by the Fishermen's Committee to pursue detailed negotiations with Langley based foundry.
- Feb /02 -Submission to Richmond Public Art Commission approved for submission by the Nikkei Fishermen's Committee.
-Confirm contract with foundry (anticipate final delivery within 4 months after contract signed).
-Confirm contract for granite base or natural boulder.
- July /02 -Receive final product and have it shipped to supplier of base.
-Anticipate final site preparations to receive the statue at the selected waterfront site in Steveston.
- Aug /02 -Deliver statue and base to site and have it installed.
Contingency month.
- Sept /02 -Official unveiling and ceremony/refreshment.
-Tentatively set for Friday, September 20, 2002

Project Ownership, Transfer to City

It is proposed by the Nikkei Fishermen's Committee to donate the statue to the City of Richmond and transfer ownership of the same to the city.

With this significant gift, it is anticipated that the city will provide on-going maintenance, cleaning and security of the statue and immediately surrounding grounds.

Site Plan Showing the Work in Relation to the Site

Attached on the site plan map is marked the final location where the statue is to be erected on the former BC Packers lands near the Phoenix Pond and adjacent to the Britannia Shipyard. It is fitting at this time to erect the monument of this nature along the Fraser River in the area where the BC Packers cannery once prospered. The proposed monument, I believe, will reflect the legacy of pioneering Nikkei Fishermen and all the generations that followed.

Visual Presentation Material of the Work on Site

Also appended for the Commission's review are:

1. Photographs of the model statue
2. Sketch of two base options
3. Photographs of the proposed site and the views seen from the site

It is difficult to visualize which base will be appropriate for the proposed site, however, the committee believes a natural boulder will compliment the surrounding area of the proposed site.

Detailed Budget

As mentioned earlier, there are 3 components to the Nikkei Fishermen's Reunion project. The total projected budget for all 3 parts is estimated to be \$105,000.

The statue, which is the subject of this submission, is part 2 of the overall project. Not including site preparation or site installation costs, the projected budget total is \$55,000.

Nikkei Fishermen's Statue

<u>Application of Funds</u>		<u>Source of Funds</u>	
Foundry Casting (life size)	\$20,000	Japanese-Canadian Community Donations	\$20,000
Model and moulds	7,000	National Assn of Japanese-Canadians	1,500
Granite Base	15,000	Corporate Donations	26,000
Artist's Fee	5,000	Financial Institutions	6,500
Plaque	1,500	Community at large	1,000
Shipping to mount on base and to final site in Steveston	1,000		
Insurance	500		
Contingency	5,000		
TOTAL	55,000	TOTAL	55,000

Information supporting the estimates from the foundry, Trio Bronze, and the provider of the granite base, Quadra Stone, are appended (Natural boulder would be much less expensive and appropriate).

The Artist 's fee is based on Mr. Iwase's proposal and 20% of casting costs.

Insurance: This will be negotiated with the foundry (Trio Bronze) at the time the contract is drawn (eg. Delivery and installation at the site, etc). After the statue has been installed, it may be insured under the auspices of the City of Richmond.

Landscaping: This will be arranged by Mr. Eizo Hayashi, a professional gardener, who is on the committee for the cost of materials only.

Funds Committee to February 8, 2002 for Part 2 Statue

Japanese-Canadian Community	\$12,000(received)
National Assn Japanese Canadians	\$1,500 (received)
Corporate Donations (Fishing Co.s)	\$6,000(received)
Financial Institutions (CIBC, Gulf Fraser)	\$ 3,000 (received)
<u>Corporate (Conditional)</u>	<u>\$ 18,000</u>
To Be Raised	\$14,500

Fund raising is well in hand. A targeted Japanese-Canadian community campaign should see our goal for part 2 (Statue) of the three-part project met by June 2002.

Not shown are 2 cost items that the Nikkei Fishermen's Committee is requesting the City of Richmond to contribute in this project:

- Site preparation costs (to receive the statue and base).
- Site installation costs to place the statue and base (The Nikkei Fishermen's Committee will cover the cost of shipping the statue and base to the site).
- \$5000 towards the completion of this project

These costs have not been estimated at this time and will require further discussion with City of Richmond staff.

The Office of the Consulate of Japan is waiting for the City of Richmond's commitment to our requests. Upon the City's commitment, the committee requires a letter of commitment from the City of Richmond in order for the Nikkei Fishermen's Committee to receive funding from the government of Japan.

Anticipated Maintenance Costs

Given the design, these are expected to be minor and isolated to:

- On-going site maintenance of grounds
- Periodic cleaning
- Security

Artist's Resume

Please refer to the attached letter.

Contact

For further information contact: Dr. Jim Tanaka
7571 Montana Rd. Richmond BC V7C 2K7
(604) 274-4222 (W) or (604) 274-1684 (H)
Fax: (604) 274-1662
E-mail: jtanaka@globalserve.net

type (D)
proposal - natural rock base

2 sizes (high/low)

MEASUREMENTS ARE APPROXIMATE

Dark Stone
English Plaque on ^{same or} separate stone
accompanying sculpture

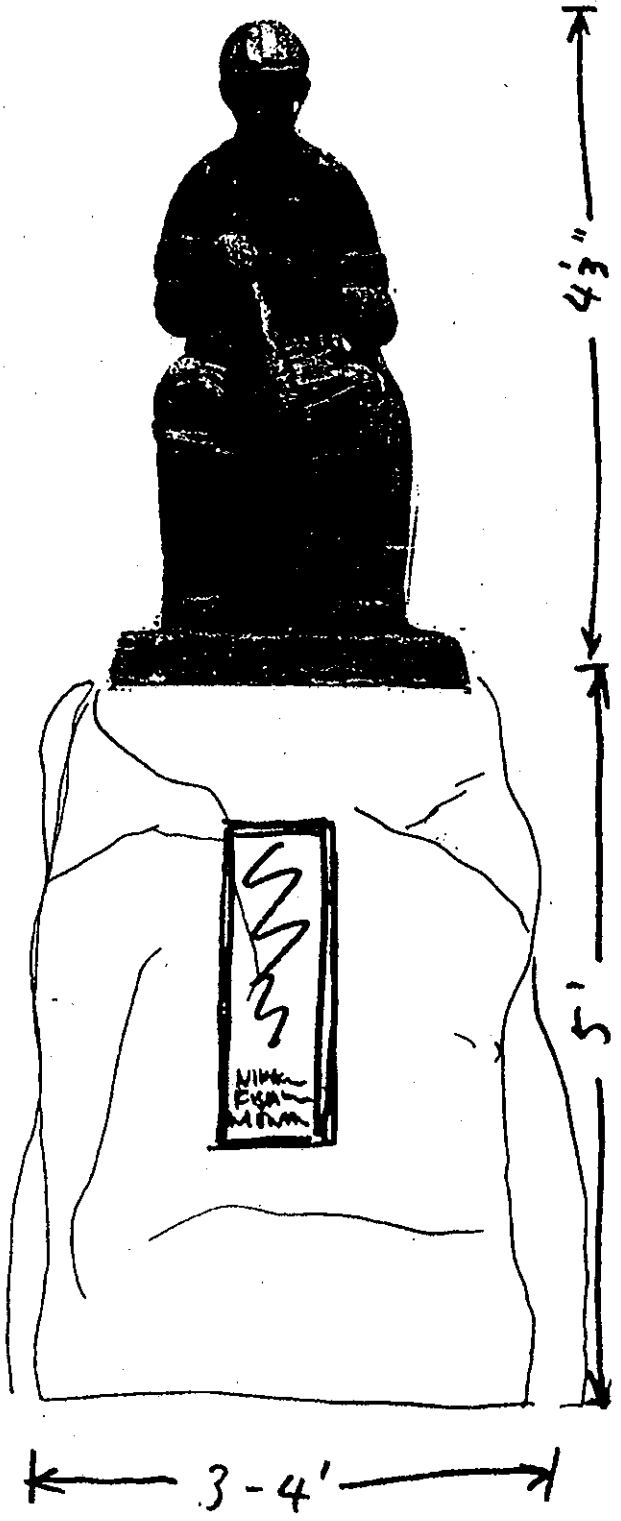

Type A
Proposal - Traditional

MEASUREMENTS
ARE
APPROXIMATE

SCULPTURE:
LIFESIZE BRONZE
BLACK PATINA
ST. WEIGHT 500lbs.

BASE
SOLID STONE/GRANITE?
PLAQUE TEXTURE:
SMOOTH/ROUGH?
ST WEIGHT 3-4 TONS

PLAQUE
SAME PATINA
AS SCULPTURE

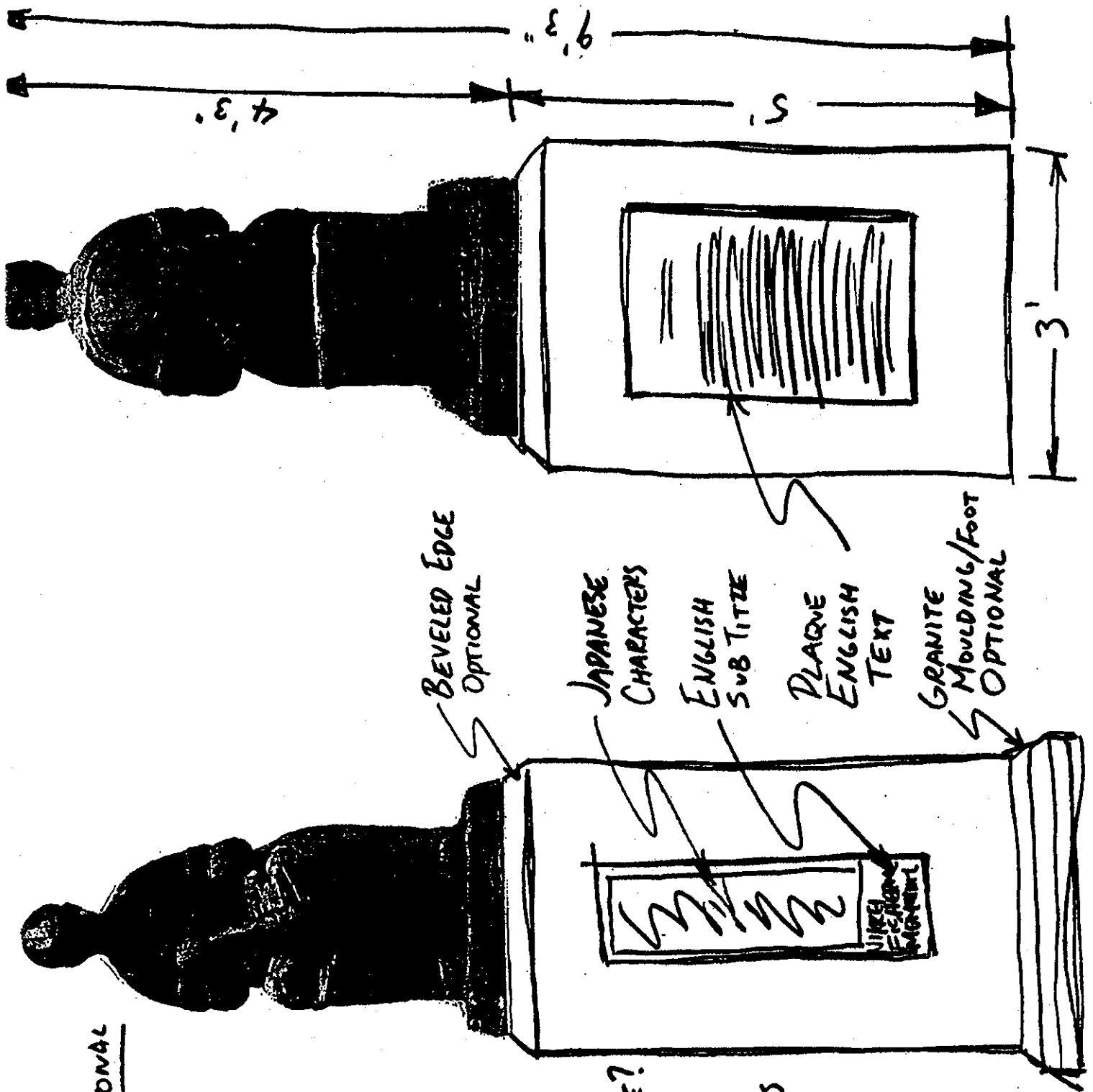

THIS DRAWING IS NOT TO BE REPRODUCED OR TRANSMITTED IN ANY FORM OR BY ANY MEANS, ELECTRONIC OR MECHANICAL, INCLUDING PHOTOCOPYING, RECORDING, OR BY ANY INFORMATION STORAGE AND RETRIEVAL SYSTEM, WITHOUT THE WRITTEN CONSENT OF L. KIM PERRY & ASSOCIATES INC.

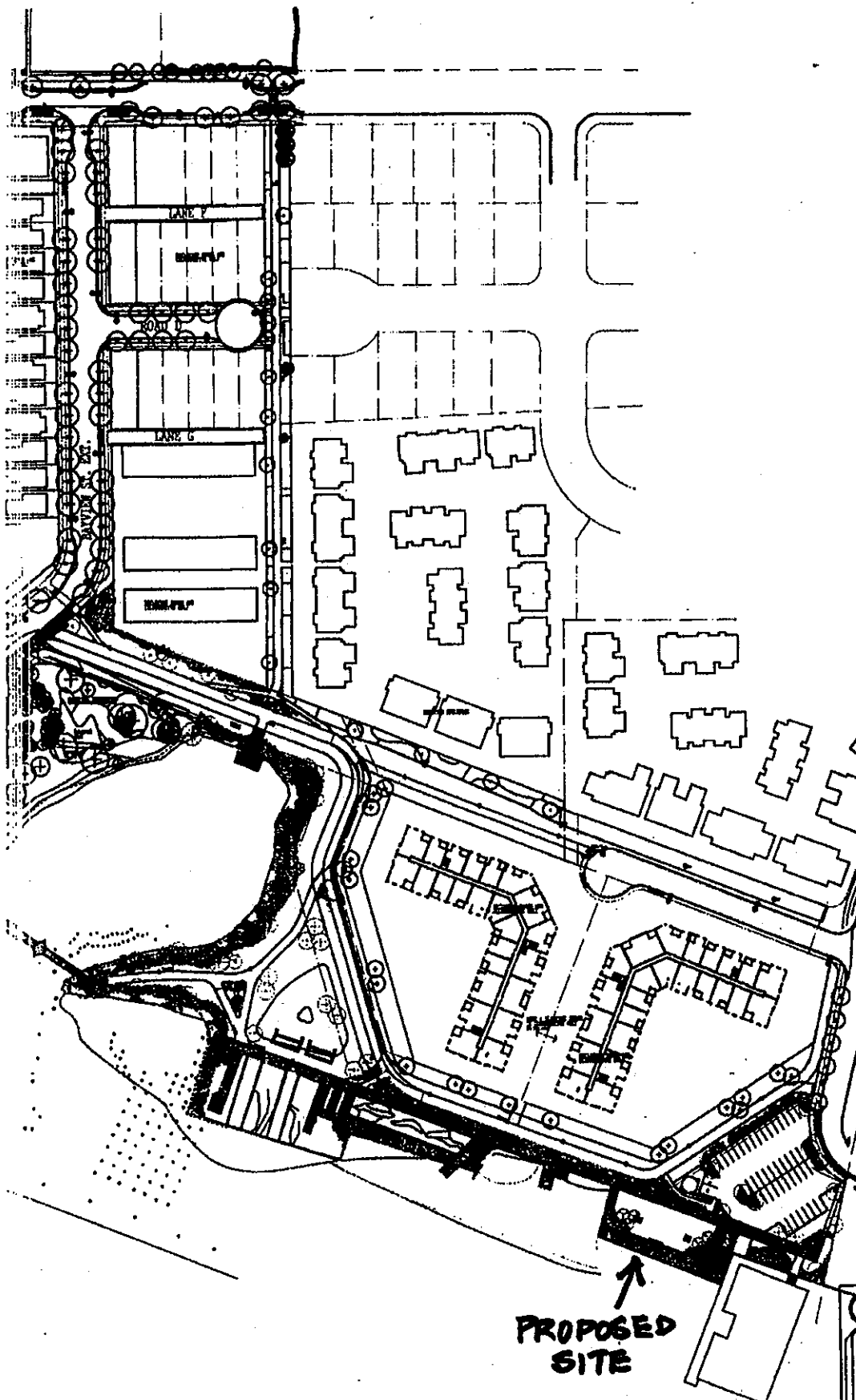

May 11/01	City Approved
Apr 23/01	Revision of one tree and re-issued for final approval
Apr 23/01	Re-issued for final approval
Apr 25/01	Issued for final approval
Apr 5/00	Issued for final approval
Apr 12/00	Re-issued for final Richmond review
May 4/00	Issued for Richmond Review
Date	Revisions

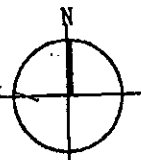

Perry & Associates 1644 W 1st Avenue
 Landscape Architecture Vancouver, B.C. V6J 1S1
 Site Planning T 778-0111 F 778-0116

IMPERIAL LANDING
 at Steveston

PROPOSED SITE

1 5 10 25 30 40 50m

City of Richmond 6311 No. 1 Road Richmond, B.C. V7B 2C1	
TITLE: Street Landscape Plan Key	
PROJECT NO. 97-018	DATE 5/00
DRAWN LAM	SCALE
DATE: May 11/01	FILE NO. 97-018
CITY FILE NO. 97-018	DATE 12/00
BY: LAM	BY: PJP

July 18, 2001

To: Kari Huhtala

Re: Statement of purposed artwork

It is a great honor for me, as a local artist, to build a monument/sculpture dedicated to the Japanese-Canadian Fishermen who brought "growth" to the community of Steveston. It is this "growth" which will be the basis for my theme and ideas.

A sculpture that would compliment the surrounding environment and architecture would be ideal. After visiting the proposed site many times, I feel that a non-representational sculpture would be fitting for the setting. The sculpture will be cast in bronze and mounted on a concrete base/pedestal. The design of the sculpture will be simple and organic in appearance. The height of the piece(s) will be under 17 ft.

I am very enthusiastic about this project for many reasons. One, it will give me a chance to give something back to the community where I was brought up. Secondly, I hope it will make-it-known that Richmond is a City of artists. More importantly, it is a project which means so much to so many people.

Yours truly,

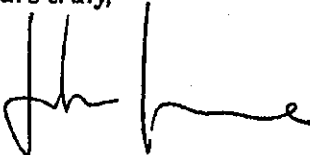
A handwritten signature in black ink, appearing to read 'Junichiro Iwase', with a stylized, cursive script.

Junichiro Iwase

Sculptor

December 6, 2001

Junichiro Iwase

email:

phone:

Re: Artist's Statement for Nikkei Fishermen's Monument

Dear Sir or Madame,

I would like to make a correction in the first statement I had made on July 18th regarding the Nikkei Fishermen's Monument. Originally, I had planned on building a monument that was non-representational and more abstract in design. However, after collaborating with the senior fishermen from the committee, we have come to an agreement that a figurative statue would be more appropriate for such a memorial. (Please refer to the attached photo of the proposed model)

The purpose of this artwork is to honor the Japanese-Canadian (Nikkei) Fishermen for their enormous contribution to the BC fishing industry. It is my opinion that a fishermen's memorial of this kind will bring a sense of history and pride to the community of Steveston.

Thank you for your consideration. I hope we will receive your support on this project. If you have any questions regarding this monument, please do not hesitate to contact me at the above address.

Best regards,

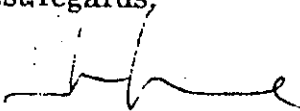

Junichiro Iwase

Sculptor

Nikkei Fishermen's Monument (Revised Model)



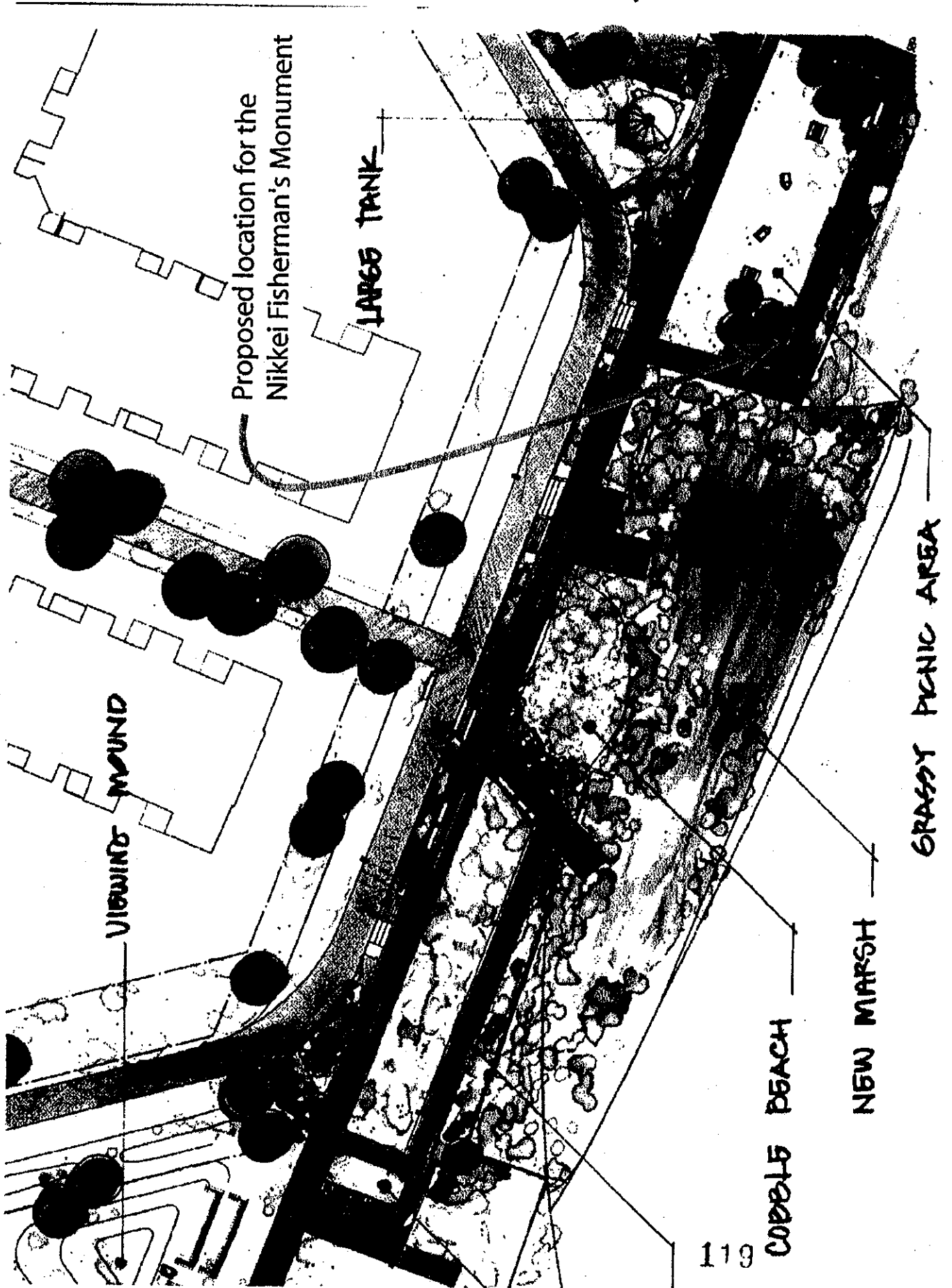

Proposed location for the
Nikkei Fisherman's Monument

LARGE TANK

VIEWING MOUND

GRASSY PICNIC AREA

NEW MARSH

COBBLE BEACH

119



City of Richmond

British Columbia, Canada

- City Contacts ●
- Feedback Form ●
- Site Search ●
- Related Links ●
- Help ●

Home

Discover Richmond ● News ● Council ● Administration ● Services ● Pay & Purchase ● Register

You are here: [City of Richmond](#) > [City Services](#) > [Planning & Transportation](#) > [Public Art](#) > Private Donations

Public Art Program

- ▶ About the Program
- ▶ Projects and Locations
- ▶ Program Development
- ▶ Policy Plan & Action
- ▶ Developer Contributions
- ▶ Private Donations
- ▶ Artist Opportunities

Community Projects

- ▶ 1998 Community Public Art Projects

Public Art Commission Reports

- ▶ 1999 Annual Report & Year 2000 Work Plan
- ▶ 1998 Annual Report

Public Comments

- ▶ Questions & Comments
- ▶ Survey Results & Directions

Resources

- ▶ Related Links

Planning & Transportation

- ▶ About Planning and Transportation
- ▶ Official Community Plan
- ▶ Environmentally Sensitive Areas - Design Manual
- ▶ Environmental Project Guidebook
- ▶ State of the Environment Report
- ▶ Mayor's Environmental Awards 2000
- ▶ Agriculture
- ▶ Native Plants & Wildflowers
- ▶ City Centre Transportation Plan Summary
- ▶ Transportation Planning
- ▶ U-turns on No. 3 Road

Guidelines for Private Donations of Public Artwork to the City of Richmond

Background Statement & Intent

These Guidelines have been established to evaluate proposed voluntary public art gifts from private sources.

Gifts of artwork to the City are an important part of Richmond's growing Public Art Collection. Proposed gifts of artwork(s) namely, those privately purchased or commissioned and located on City sites will be reviewed before being placed into the City's Public Art Collection.

There are very limited City funds to preserve and conserve these works of art. There is also a limited number of suitable sites on City property for gifted artworks.

The Guidelines are founded on the conviction that the acquisition of valid public art, like the City's long-term investment in capital works and social development, is contingent on the incorporation of professional advice and community representation.

All proposed gifts are to receive independent assessments by a public art review committee, which will include artists, other members of the professional art community, and by representatives of the neighbourhoods involved, based on the Guidelines below, which complement the current Public Art Program.

While the following guidelines have been written specifically for the gifting of artworks, other proposals for creative or innovative public art projects are welcomed and encouraged, for example:

- Provision of a site and/or an endowment for an artist residency or a public art symposium
- Provision of a site and/or an endowment for a changing exhibition of public art, sculpture garden, etc.

These proposals are also subject to the guidelines below.

Guideline Objectives

1. To encourage and ensure that the City acquires public art that meets a high standard and is appropriate and meaningful for the community.

- ▶ Traffic Circles
- ▶ Assisted Housing Facilities
- ▶ Homeless Strategy
- ▶ Heritage
- ▶ Industrial Strategy
- ▶ Public Art Program
- ▶ Architectural Design Awards 1998

Go To >

- ▶ Publications List
- ▶ Publications - "How to Order"
- ▶ Demographic Hot Facts

2. To provide a procedure for reviewing proposed gifts to the City of art works intended for placement in public places under the City's jurisdiction.
3. To acquire works that contribute to and enhance the City's Public Art Collection.

☉ Definitions

Public Art: Artwork (e.g. sculptures, paintings, statues, etc.) intended for placement or installation at indoor and outdoor areas of public use under the City's jurisdiction.

Richmond Public Art Commission (RPAC): The City Council appointed citizen advisory committee board, made up of art professionals, urban designers, individuals from the development industry and from the community at large.

Gift: An existing or proposed work of art or funded project offered as a donation by someone to the City for placement at a public site under the City's jurisdiction.

Sponsor: An individual or group, other than the artist, who proposes a donation of a work of art or funded project for placement on a public site under the City's jurisdiction.

Role of Sponsor: The Sponsor's principal role is to state the intent of the donation and provide the funding for its manufacturing, installation, and maintenance. Community groups or corporations can act as a sponsor, provided that they are capable of demonstrating community support for the proposal and clear financial responsibility for its acquisition, production, installation, and maintenance at the time of the proposal.

Note: Demonstrating community support reinforces the public nature of the proposal.

☉ Acceptance Conditions

1. The City will consider gifts of works of art for placement at City owned sites on the understanding that no City funds will be required for production, siting, installation or maintenance of the work.
2. A work of art must have a sponsor or co-sponsors who will present the proposal and, when necessary, be responsible for raising or providing the necessary funds in accordance with the budget that they presented to the City and the Public Art Commission.
3. No gift of an artwork will be accepted by the City until all funds for its development and siting have been secured (e.g. by cheque, cash, etc.).
4. The City will consider the following types of proposals for works of art intended for placement at a public site under the City's jurisdiction:
 - a) A sponsor's offer of an already completed work of art.
 - b) A sponsor's offer to commission an artwork by a specific artist or artists.
 - c) A sponsor's offer to commission an artwork by means of a public competition as described in the Public Art Program, Policy Plan and Implementation Actions.

☉ Public Art Selection Criteria

The Public Art Program encourages the creation of work of the highest standards, that is deemed relevant to the community, and that allows the public to be inspired, make connections and understand relationships among the works in the collection and the community. City staff will review all proposals of gifts of artwork based on the following criteria, and refer them to the Public Art Commission, its review panels and City Council.

1. City Sites:

Gifted public artwork must be for sites under the City's jurisdiction (e.g. City owned, City managed (e.g. public right of way).

2. Theme:

A stated theme of the artwork, which is consistent with the goals, objectives and mandate of the City and the Richmond Public Art Program must be identified.

3. Relevance:

Works of art must be appropriate for the proposed site and its surroundings, and complement surrounding architecture, topography, history and the social dynamic of the particular community in which the art will be placed.

4. Artistic Excellence:

The work of art shall merit placement in a City public place.

A demonstrated ability and potential of the artist to execute the proposed piece, based on previous artistic achievement and experience must be shown.

In the case of a donation of an existing work of art, the quality of the work(s) must be supported by documentation from an independent professional evaluator.

In addition, the artwork must enhance the public art collection.

5. Physical Durability

Consideration of the artwork's long-term durability against theft, vandalism, and weather must be addressed.

6. Public Safety

All proposals must address public safety concerns.

7. Costs

All costs of the proposed artwork, including production, acquisition, siting, installation, and maintenance must be provided by the sponsor and be detailed in the proposal.

8. Legal

Consideration will be given to the proposed terms of donation, legal title, copyright authenticity, artist right to reproduce, liability and other issues as appropriate.

④ Acquisition Procedures & Process

1. All offers of artwork proposed for sites under City jurisdiction must be in writing and be submitted to the Public Art Commission which is responsible for reviewing proposals, designating review panels, and reporting its recommendations to City Council.

Richmond Public Art Commission
 c/o City of Richmond
 Urban Development Division
 6911 No. 3 Road
 Richmond, B.C. V6Y 2C1

2. The sponsor will be asked to submit a detailed proposal to the City and Public Art Commission prior to its consideration. The proposal must contain:
 - A rationale for the proposed gift
 - A brief statement of proposed artwork and theme from the artist
 - A project time line
 - Project ownership, transfer to the City and stakeholder responsibilities
 - A site plan showing the work in relation to the site
 - Visual presentation material of the work on the proposed site(s) and community, including drawing(s), photograph(s) and model(s) of the proposed work with scale and materials indicated
 - A detailed budget, with projected costs for the project, including: materials, installation, documentation, construction, maintenance, insurance, etc.
 - Funds committed to date and proposed source(s) of funds
 - Anticipated maintenance for completed and/or donated artwork
 - Artist's resume and any additional supporting material
 - All other program criteria should be addressed in the proposal
3. The Commission and City staff will review offers of artwork to determine whether they meet initial criteria for the City's public art collection.
4. All those qualifying will be put on a list of possible donations.
5. The Commission will appoint and instruct a panel(s) to review the offers and sites for compatibility and make recommendations to the Commission.
6. The panel of no fewer than three members and no more than 5 persons with suitable expertise, including art professionals and at least one neighbourhood representative, if appropriate, to evaluate the work according to the criteria and the choice of site.
7. The panel chair will report the panel's decision in writing to the Commission.
8. Public Art Commission accepts or rejects the panel's decision.
9. Public Art Commission makes a recommendation to City Council on accepted proposals.
10. If the proposal is accepted by the City Council, a formal agreement will be drawn up outlining the responsibilities of each party (the City, the sponsor, the artist and outside contractors, where applicable). The agreement will address project funding, insurance, siting, maintenance, project supervision, vandalism, the plaque, the right of removal or transfer, public safety and other issues as necessary.
11. If the panel, Public Art Commission, or City Council decides against selecting the proposal, City staff will notify the sponsor and the artist with the rationale for

their decision.

Integrity and Registration of the Artwork

1. The City will be the owner of the artwork and reserves the right to move or alter the work to meet public safety or other City concerns. Any such change, will be made in consultation with artist and sponsor, and the Public Art Commission.
2. The completed and installed work of art will be registered in the City's Public Art Inventory together with the artist's statement of purpose.

 [BACK TO TOP](#)

02.08.02 15:57

[Home](#) | [Discover Richmond](#) | [News and Events](#) | [City Council](#) | [City Administration](#) | [City Services](#) | [Pay & Purchase](#) | [Register](#)
[City Contacts](#) | [Feedback Form](#) | [Site Search](#) | [Related Links](#) | [Help](#)
[Copyright © 2002, City of Richmond](#) | [Disclaimer](#)