



Parks, Recreation & Cultural Services Committee

Date: Tuesday, November 25th, 2003
Place: Anderson Room
Richmond City Hall
Present: Councillor Harold Steves, Chair
Councillor Evelina Halsey-Brandt, Vice-Chair
Councillor Linda Barnes
Councillor Derek Dang – 5:00 p.m.
Councillor Sue Halsey-Brandt
Councillor Bill McNulty
Mayor Malcolm Brodie – 4:35 p.m.
Also Present: Councillor Rob Howard – 4:18 p.m.
Call to Order: The Chair called the meeting to order at 4:00 p.m.

MINUTES

1. It was moved and seconded
That the minutes of the meeting of the Parks, Recreation and Cultural Services Committee held on Tuesday, September 23rd, 2003, be adopted as circulated.

CARRIED

DELEGATIONS

2. *Ms. Nora Wright, Chairperson, and Mr. Balwant Sanghera, Vice-Chair, of the East Richmond Community Association regarding the Healthy Community Project in East Richmond. (3040-01)*

Parks, Recreation & Cultural Services Committee

Tuesday, November 25th, 2003

Ms. Nora Wright, President, and Mr. Balwant Sanghera, Vice-President, of the East Richmond Community Association, were present to provide an update on the East Richmond Healthy Community Project. Ms. Wright read a written submission, a copy of which is attached as Schedule 1 and forms a part of these minutes.

Mr. Sanghera then spoke about the loss of identity felt in the East Richmond area and said that he hoped for continued collaboration on creating more pride in this most culturally diverse part of Richmond. Mr. Sanghera also spoke about the need for a 'village centre' at No. 5 Rd. and Cambie Rd. Attention was then brought to two issues that would enhance liveability in the East Richmond area – i) a trail from Bridgeport Rd. to Westminster Highway; and ii) a connection to the proposed Williams Rd. shuttle that would loop around the East Cambie area.

Discussion then ensued among Committee members, staff and the delegates that included the following:

- a clarification that the trail location would be further east than the Shell Road Trail. The Director of Parks, Dave Semple, spoke about the current trail system in the area, and agreed to review the request;
- that East Richmond be considered during Richmond 125 Celebration and Olympic celebration discussions with a view to providing the East Richmond area with a legacy;
- that the report "Road to Action Phase 1. (2003-2006) be given to staff for a review in conjunction with the Parks Master Plan;
- a review of the priorities of the East Richmond Community Association, which included continued discussion with Richmond Health Services regarding the provision of a walk-in clinic in the community hall, and the future vision of a neighbourhood house that would deliver programs and services to the area;
- the possible option of integrating services into the community centres;
- a suggestion that the original portion of Mitchell School be considered for use as a neighbourhood house.

Councillor Howard joined the meeting during the above discussion – 4:18 p.m.

As a result of the discussion the following *referral* motions were introduced:

Parks, Recreation & Cultural Services Committee

Tuesday, November 25th, 2003

It was moved and seconded

That staff work with the East Richmond Community Association in the development and integration of the concepts contained in the report 'A Road to Action Phase 1. (2003-2006), which would include the creation of a 'village centre'.

Prior to the question being called direction was given that during Richmond 125 and future Olympic Celebration activities the East Richmond area be looked at with a view to possible legacies – such as the requested trail.

The question was then called and it was **CARRIED**.

It was moved and seconded

That staff review the options of connecting the proposed Williams Road shuttle service to the East Richmond area and report to the Public Works and Transportation Committee.

CARRIED

It was moved and seconded

That the request for an RCMP presence in East Richmond be referred to the Community Safety Committee.

CARRIED

PARKS, RECREATION AND CULTURAL SERVICES DIVISION

3. STEVESTON HARBOUR AUTHORITY/TIN SHED SITE COMMUNITY CONTRIBUTION AGREEMENT

(Report: November 14/03, File No.: 1000-14-026) (REDMS No. 1093011)

The Director of Parks, Dave Semple, was present.

It was moved and seconded

That staff proceed with the development of a Community Contribution Agreement with the Steveston Harbour Authority for the greening of the Tin Shed Site.

CARRIED

Parks, Recreation & Cultural Services Committee

Tuesday, November 25th, 2003

4. **ABERDEEN CENTRE STREET BANNER SPONSORSHIP PROPOSAL - FAIRCHILD DEVELOPMENTS LTD.**

(Report: November 14/03, File No.: 7200-20-SBAN1) (REDMS No. 1092918)

The Director of Parks, Dave Semple, was present.

It was moved and seconded

That the sponsorship of street banners for the opening of the new Aberdeen Centre by the Fairchild Developments Ltd. be approved for commencement in December 2003.

CARRIED

5. **2010 TRAILS STRATEGY**

(Report: November 13/03, File No.: 2400-05) (REDMS No. 1092849, 1073031)

The Director of Parks, Dave Semple, was present.

It was moved and seconded

That Council endorse the 2010 Trails Strategy as the guide for developing the Richmond Trails System.

CARRIED

Mayor Brodie joined the meeting – 4:35 p.m.

6. **RICHMOND 125 CELEBRATION OPPORTUNITIES**

(Report: November 7/03, File No.: 7400-20-RQAC1) (REDMS No. 1080847)

The Director of Parks, Dave Semple, and the Manager, Parks, Programs – Design, Mike Redpath, were present.

Discussion ensued among Committee members and staff on:

- the anticipated success of cost recovery;
- the expectation that community groups would provide comment on what is doable by the community in terms of in-kind donations, volunteers etc.;
- the use of the Council Provision Account as a funding source;
- the need to identify the preferred options and the corresponding sponsorship support;
- a determination of the significance of the 125th anniversary to the City;
- the importance of a Waterfront Festival event and the associated sponsorships;

Parks, Recreation & Cultural Services Committee

Tuesday, November 25th, 2003

- the use of the cornucopia as the logo for the celebrations;
- the interest expressed by the Intercultural Advisory Committee in being involved from the outset.

Clr. Dang joined the meeting during the above discussion – 5:00 p.m.

It was moved and seconded

That the expanded celebration opportunities for Richmond's 125th Anniversary as detailed in the report dated November 7th, 2003 from the Director, Parks, and the Director, Corporate Planning and Intergovernmental Relations be referred to staff for a report to be provided as soon as possible that would include:

- (1) *community involvement;*
- (2) *the comments made by Committee; and*
- (3) *specific identification of funding sources.*

CARRIED

7. **MEMORIAL GARDEN FEASIBILITY STUDY**

(Report: November 5/03, File No.: 2345-01) (REDMS No. 1089786, 1043347, 1069058, 1055194)

The Director of Parks, Dave Semple, introduced Mr. Eric Lees, LEES + Associates Landscape Architects and Cemetery Planners, to the Committee.

Mr. Lees then gave a power-point presentation, a copy of which is attached as Schedule 2 and forms a part of these minutes.

Discussion then ensued among Mr. Lees, Committee members and staff on:

- whether the significance of the possible net revenue had been determined;
- the significance of the appropriate siting of such a facility;
- the amount of public process involved in Approach #2;
- the implications of cultural preferences; and
- the attempt that should be made for cost recovery.

It was moved and seconded

That:

- (1) *the Richmond Memorial Garden Feasibility Study Phase 1 be received for information; and*

Parks, Recreation & Cultural Services Committee

Tuesday, November 25th, 2003

- (2) *staff be directed to implement Phase 2 of the Richmond Memorial Garden Feasibility Study to investigate the financial, governance and siting issues of potentially locating a Memorial Garden in Richmond.*

Prior to the question being called direction was given that the Intercultural Advisory Committee be requested to provide comment on the matter.

The question was then called and it was **CARRIED**.

8. MANAGER'S REPORTS

There were no reports.

ADJOURNMENT

It was moved and seconded

That the meeting adjourn (5:35 p.m.).

CARRIED

Certified a true and correct copy of the Minutes of the meeting of the Parks, Recreation & Cultural Services Committee of the Council of the City of Richmond held on Tuesday, November 25th, 2003.

Councillor Harold Steves
Chair

Deborah MacLennan
Administrative Assistant



EAST RICHMOND COMMUNITY ASSOCIATION

50 YEARS OF COMMUNITY PARTNERSHIP

Parks, Recreation and Cultural Services Committee

Re: East Richmond Healthy Community Project

The formation of this project began in early 2001 when City staff, representatives from Richmond Health Services, Richmond School Board, RCMP, Library, Family Services, Richmond Youth Service Agency and Richmond Child Development Board and the East Richmond Community Association got together to address the concerns of this rapidly growing and changing area with a vision to:

“To promote leadership and the provision of community services that reflects the desire of East Richmond residents to live in a safe and healthy community.”

This project will also make every effort to mobilize and empower the community and its residents to foster a sense of community health and well being..

In May 2001 the East Richmond Community Profile was published with many thanks to City staff who worked hard to produce this invaluable document which provided details and statistics with regard to the residents, businesses and the community amenities. East Richmond is now home to approximately 20,000 people, 12,000 employees and 3,500 businesses

It has been evident for many years that East Richmond is devoid of basic services that other areas of Richmond both enjoy and take for granted e.g. library, health services, community policing, transportation and shopping areas.

In early 2003 East Richmond Community Association hired a consultant to survey the community and a number of focus group meetings took place in April of this year with both residents and businesses alike with over 200 participants. The consultant produced a Community Consultation summary and key elements identified by these focus groups were safety, services, transportation, beautification, redevelopment of shopping area and improvements on the quality of life.

Following the consultants report, a Road to Action Phase 1. (2003-2006) was published which addressed the steps that would be taken in the future to realize the wishes of our community and to assist in the provision of much needed services in East Richmond. As a result Selena

Schroeder was hired by the ERCA to spearhead this project. A Steering Committee is also in the early stages of forming and recruiting members from citizens, agencies and businesses so that we can all work together towards our common vision.

A Community Service Providers Forum was held in October and very well attended by a variety of agencies who were very supportive of our initiatives. A Community Forum and Social event was held in November at Cambie Community Centre and again, was very well attended by over 150 people.

Our first success was the provision of library services and we are all very excited about the opening of the new Cambie Library in early January 2004. ERCA has contributed \$50,000 towards this project and will continue to be a proud supporter of our library. Cambie's proactive youth group, Youth Taking Charge, have also donated \$763 and support from the youth in the community has been tremendous.

Our second goal will be the provision of community policing and office space is being arranged within Cambie community centre to accommodate the RCMP. Our third goal will be provision by Richmond Health Services of a health clinic in the East Richmond community hall for two days per week.

We are also currently working on a beautification project for the No. 5 Road and Cambie area and have been awarded a grant from the Public Art Project so that we are now able to move head and have street banners designed by Cambie High students and we are confident that this will add to the sense of vibrancy and energy within the community.

Our long term wish would be for a Neighbourhood House to deliver community based programs and services for our area which is amongst the most culturally diverse in the Lower Mainland.

As you can see we are determined and committed to achieve our vision. We are all confident that we can make a difference in the life of East Richmond residents by shaping our future together.

The support and encouragement of the City of Richmond is very much appreciated and we will continue to keep you informed of our progress of the East Richmond Healthy Community Project of which we are inordinately proud.

N. Wright

Nora Wright
President

Balwant Sanghera

Balwant Sanghera
Vice President

Shaping Our Future

A Healthy Community Strategy for East Richmond

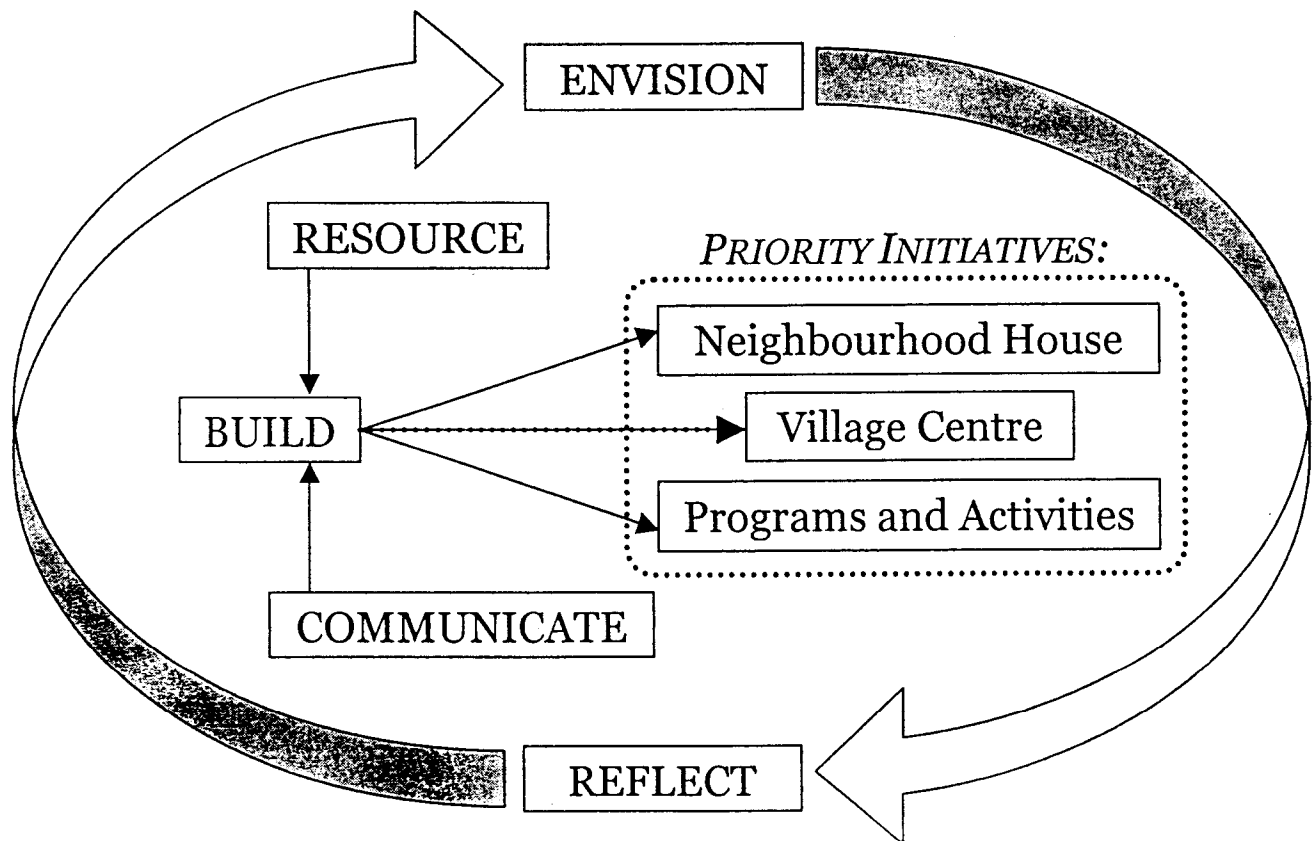

Road to Action

Phase 1 (2003 – 2006)



An Initiative of
The East Richmond
Healthy Community
Project

Sponsored by
The East Richmond
Community
Association



CORE FUNCTIONS	ACTIONS	RESULTS
ENVISION AND REFLECT	<ul style="list-style-type: none"> • Work with community members to articulate a common vision for the future of East Richmond. • Agree on project objectives and select appropriate indicators to monitor progress. • Create annual maps to display indicators and community visions. • Organize a forum of East Richmond residents, businesses and groups to discuss and take action on local issues. • In 2006, evaluate successes to date. 	A grassroots-driven process that is representative of the community; a mechanism for self-reflection and analysis of progress towards objectives; a local coalition which represents East Richmond on community issues.
RESOURCE	<ul style="list-style-type: none"> • Identify and pursue grant opportunities and local business sponsors. • Re-develop Cambie volunteer process. • Recruit and train local volunteers. • Assist ERCA with board development. • Develop revenue streams through activities that engage the community. • Acknowledge all sponsors and volunteers via appreciation events, notice boards, etc. 	Business and community partnerships to support local projects; increased community participation and volunteerism; ongoing support for ERHCP initiatives.
BUILD	<ul style="list-style-type: none"> • Plan and implement priority initiatives: <ul style="list-style-type: none"> • Neighbourhood House • Village Centre • Programs and Activities 	See table on next page for details.
COMMUNICATE	<ul style="list-style-type: none"> • Establish information links within the community; e.g. newsletter, forums, etc. • Work with key community leaders to encourage awareness and participation. • Develop a toolkit and protocol for press releases and media communication. • Develop a printed/online resource to provide information to the public about programs and services offered by various agencies in East Richmond. 	A community information link; a well-informed public that is actively involved in its community.



Richmond Memorial Garden Feasibility Study Summary Presentation

Parks, Recreation and Cultural Services Committee

November 25, 2003

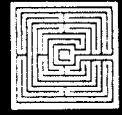

Memorial Garden Feasibility Study

November 25, 2003

SCHEDULE 2 TO THE MINUTES OF
THE PARKS, RECREATION AND
CULTURAL SERVICES COMMITTEE
MEETING HELD ON TUESDAY,
NOVEMBER 25TH, 2003.

Richmond Memorial Garden Feasibility Study Summary Presentation

- Trends in burial and cremation
- Richmond's unique situation
- Community response
- Memorial Garden recommendations



Memorial Garden Feasibility Study

November 25, 2003

Trends in Burial and Cremation

- Canadian and regional trends
- Richmond trends

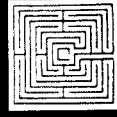

Memorial Garden Feasibility Study

November 25, 2003

Canadian and regional trends

Canadian Cremation Rates 1994-2000



Canadian and regional trends

- Cremation rates for Canada increased from 3.8% in 1961 to 46.2% by 1999
- In BC: A 180 degree shift in cremation and burial patterns over the last 12 years
- In BC: Highest cremation rate in North America in 1999: 74% cremation rate

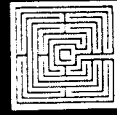

Richmond trends

- Demographic drivers
- Burial patterns



Memorial Garden Feasibility Study

November 25, 2003

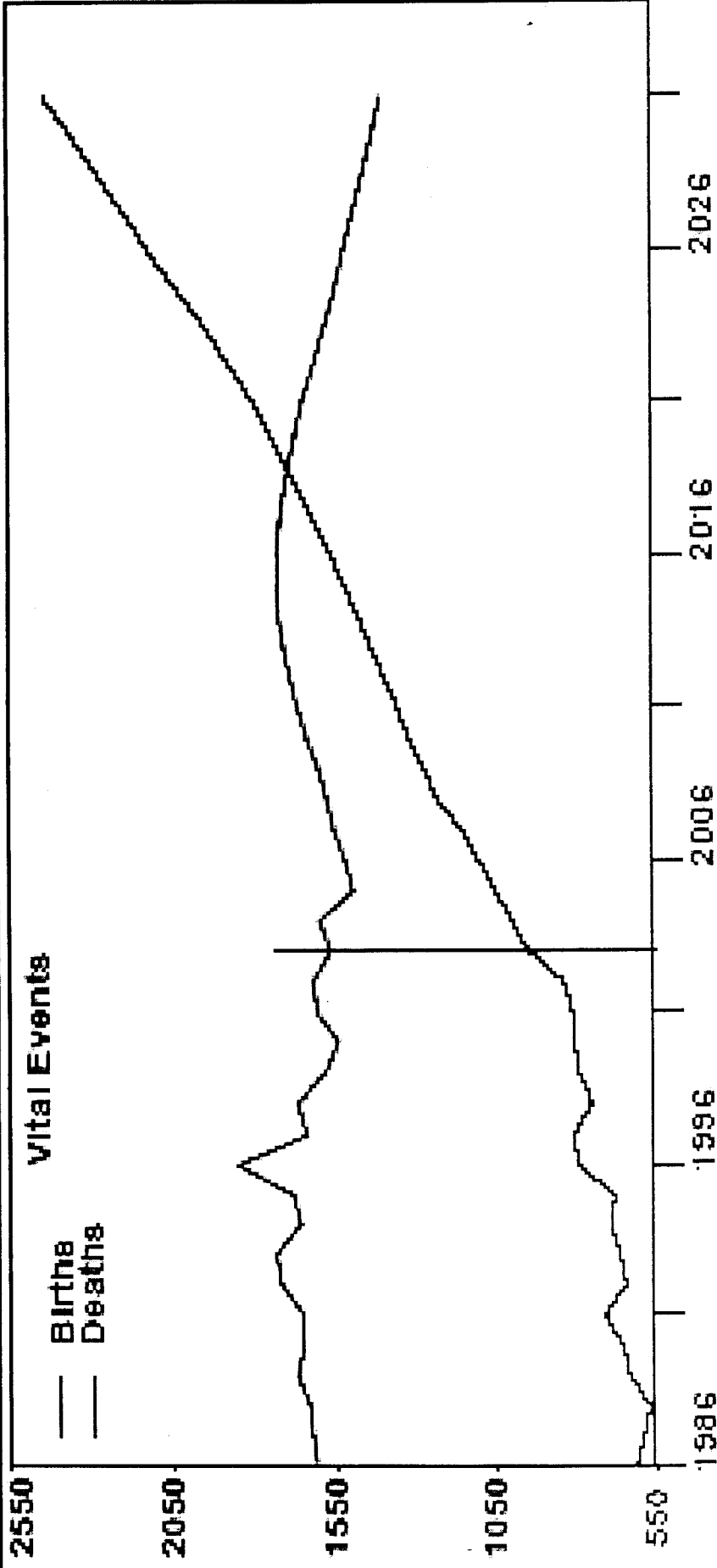

Death rate increasing while the birth rate decreases

Death rate 2001: 5 per thousand

Death rate *Projected* 2030: 11.7 per thousand

Source: Compiled by LEES + Associates from information from Vital Statistics B.C.

The baby boomer bulge:

Top: 2002

Bottom: 2026

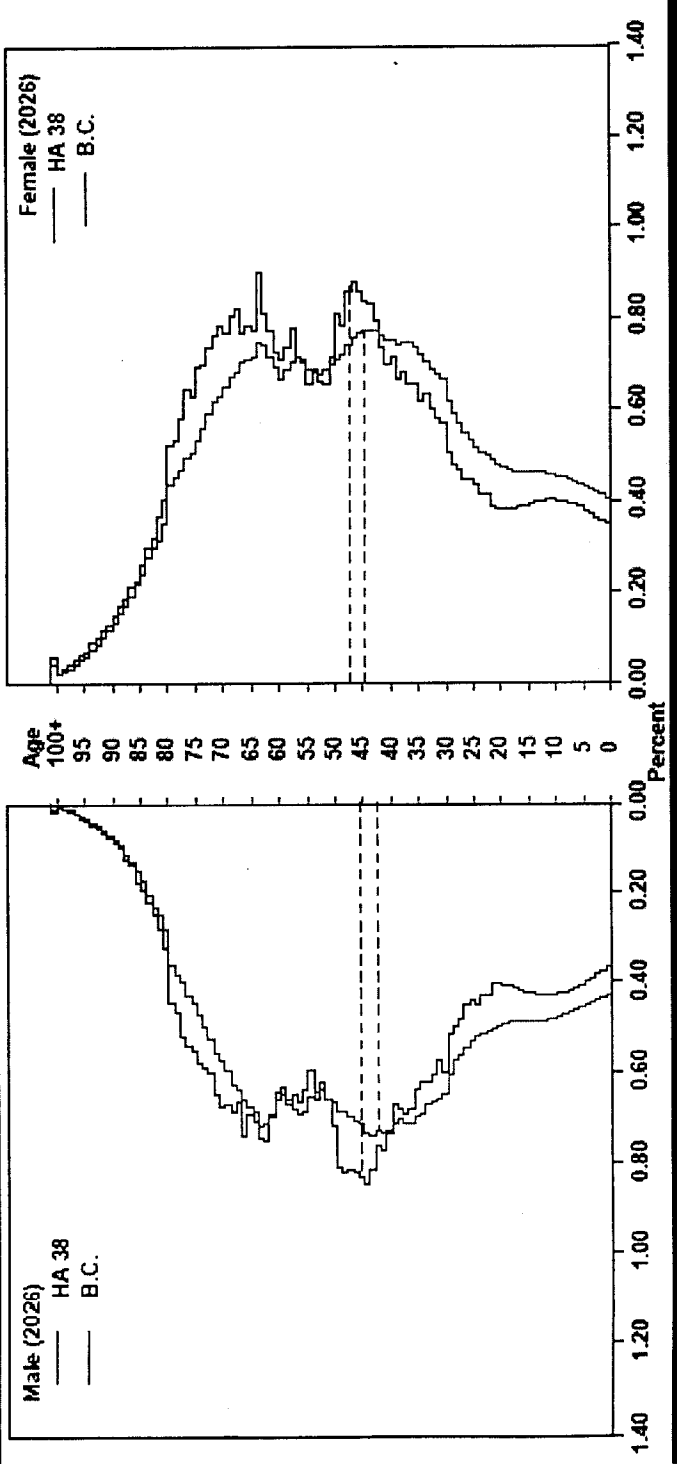
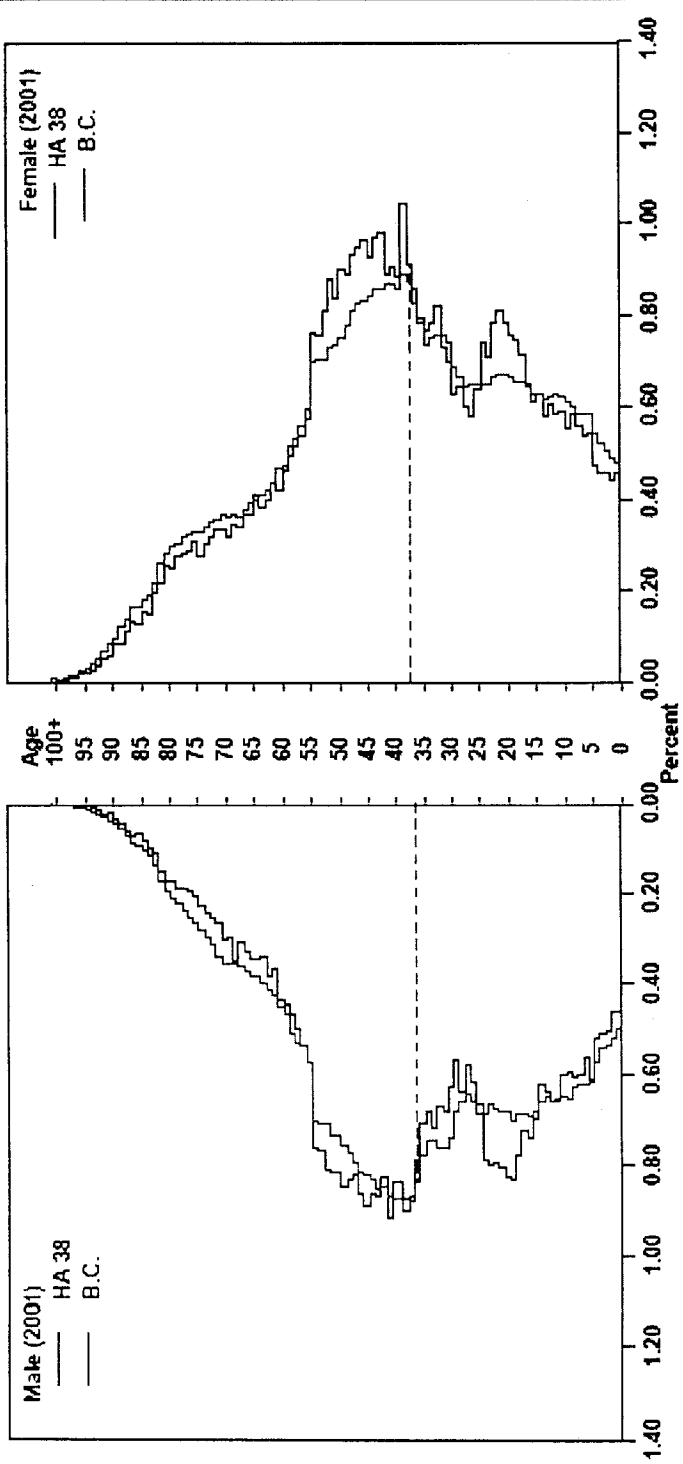

Method of Disposition of Decedents in the City of Richmond

Local Health Area 38, in the Year 2002

Burials: 225 (27.4%)

Cremations: 592 (72.1%)

TOTAL: 822

Source: Compiled by LEES + Associates from information from Vital Statistics B.C.

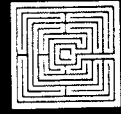

Memorial Garden Feasibility Study

November 25, 2003

Where are Richmond residents buried?

Residents of Richmond: Major Places of Burial (Casket and Mausoleum)	1998	1999	2000	2001	2002	TOTAL
Boundary Bay Cemetery, Delta	3	5	10	6	1	25
Forest Lawn Memorial Park, Burnaby	46	53	38	44	45	226
Gardens of Gethsemani, Surrey	13	15	20	13	12	73
Mountain View Cemetery, Vancouver	9	12	6	14	6	47
Ocean View Burial Park, Burnaby	56	64	73	66	67	326
Valley View Memorial Gardens, Surrey	29	32	38	43	49	191
Victory Memorial Park Cemetery, Surrey	16	20	17	16	13	82
TOTAL:	172	201	202	202	193	970
Number of all burials: (LHA 38) 1998-2002.	200	223	217	238	225	1,103

Source: Compiled by LEES + Associates from information from Vital Statistics B.C.

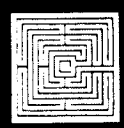

Memorial Garden Feasibility Study

November 25, 2003

Community Response

- **Is a place of memorialisation important in Richmond?**
- **What kinds of memorialisation should be considered?**
- **What are the specific community needs?**
- **What are appropriate site selection criteria?**
- **What role should the City have in a Memorial Garden?**

Is a place of memorialisation important in Richmond?

- **Unanimity that a site of this type is important for Richmond**
- **“Richmond is an incomplete community without a place for interment”**

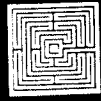

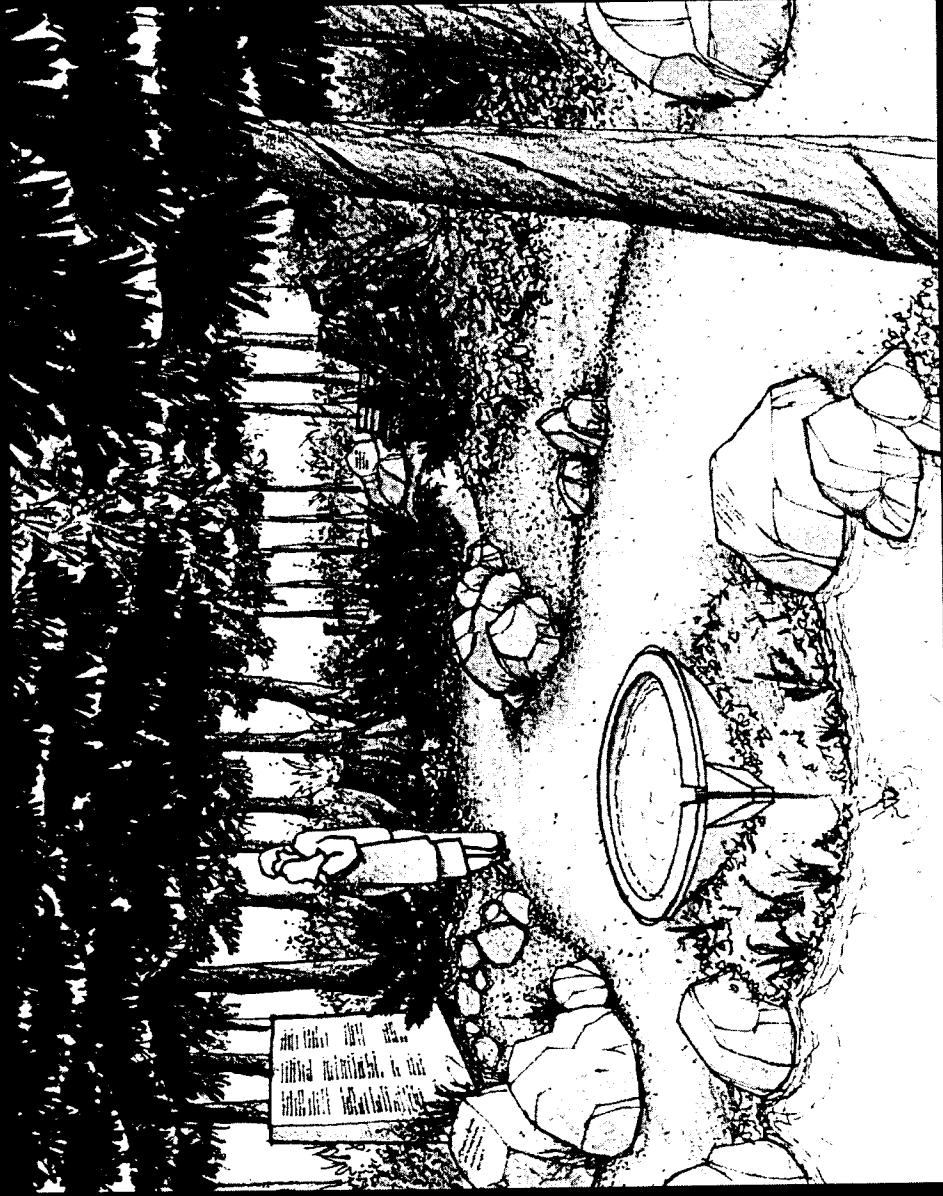

A scattering garden concept
Design: LEES + Associates



Memorial Garden Feasibility Study

November 25, 2003

What kinds of memorialisation should be considered?

- Providing a place of remembrance
- A place to learn about the past
- Creating a sense of place
- A scattering garden
- Columbaria
- A water feature (or be near the river)
- A meeting or celebration room





Family Columbaria, West Vancouver, BC



The Woods Columbaria, West Vancouver

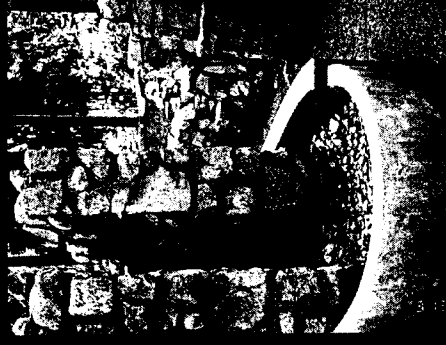
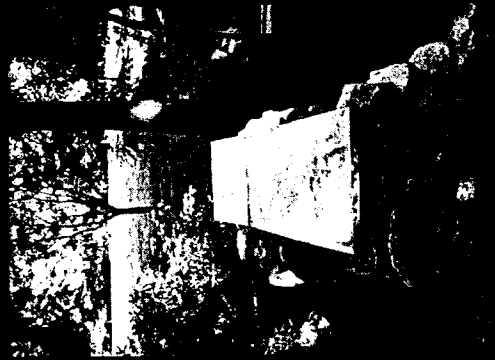

What are the specific community needs?

The Buddhist community suggested:

- The visual appeal should “celebrate Richmond’s natural beauty.”
- A place to scatter cremated remains
- A place for memorialisation

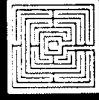

Options for cremated remains



Scattering gardens



Above: a Danish scattering wall
Right: The Promontory Green, Kelowna BC
Design: Hilton Landmarks



The Avenue of Urns, Belgium

The Muslim community:

- **The Muslim community requires full body burial and preferably burial within 24 hours of death, so this should be a consideration.**
- **Mausolea may be acceptable**

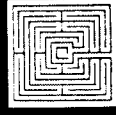

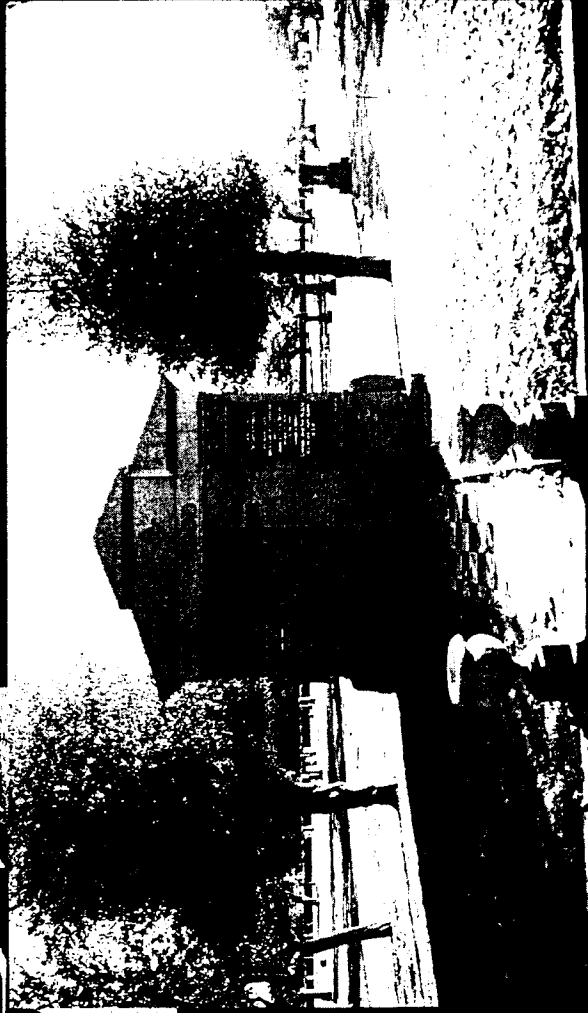

WCCA Conference September 8, 2003

The Sikh community

- Would prefer a crematorium on-site and a building to accommodate the hundreds of people that may attend the rites before and after a cremation.
- The Hindu and Sikh communities stated that moving water is preferable for scattering
- A place for memorial plaques is desirable



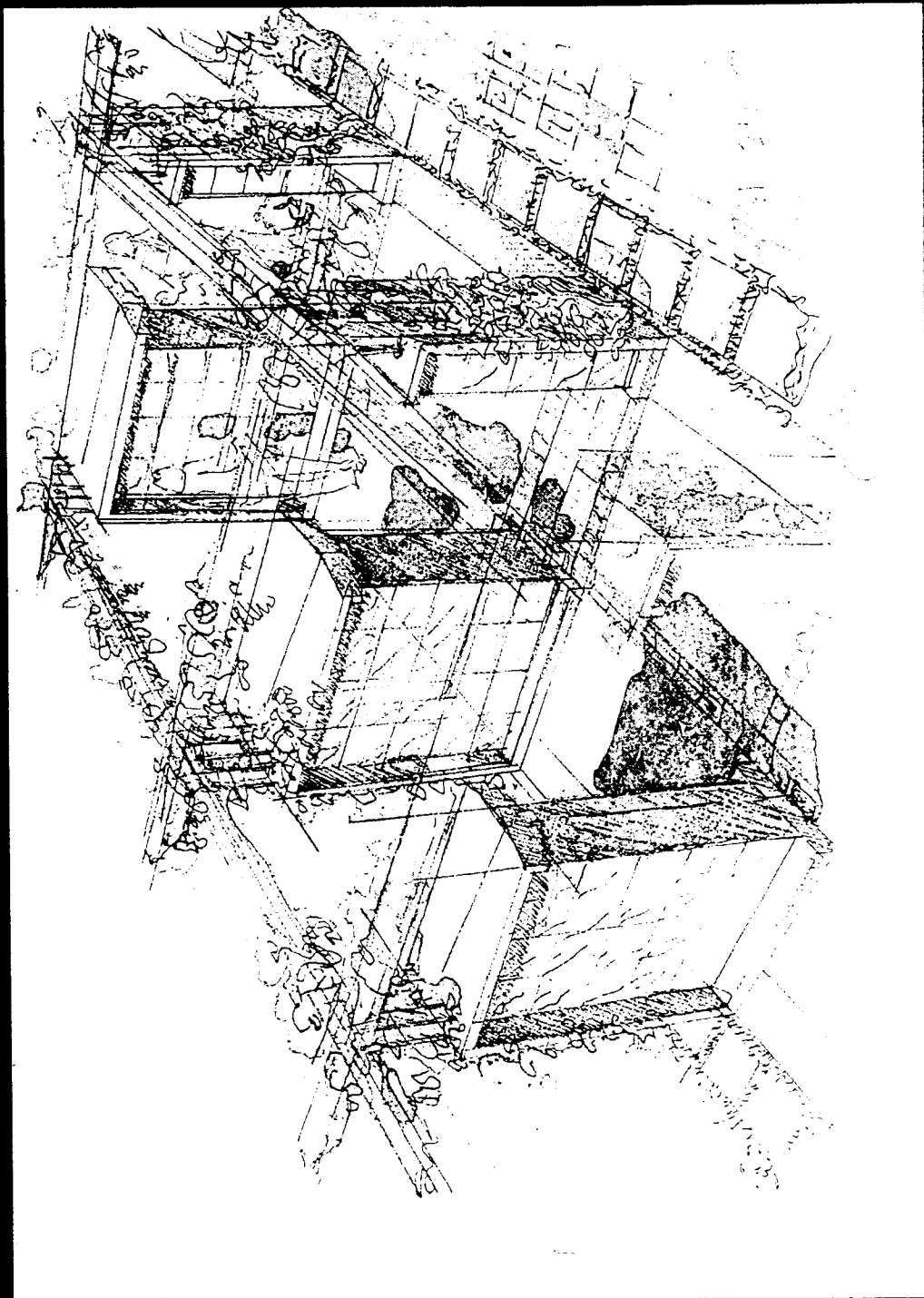

WCCA Conference September 8, 2003

The Chinese Community

- The Chinese community traditionally visit gravesites of ancestors on special days, such as “Qingming” (April 4)
- The garden should include places for burnt offerings.
- The memorial garden should be a positive place; a place for the living.
- Feng Shui principles should be incorporated, where possible

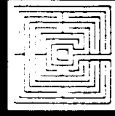



Ting: paper currency used in burnt offerings at the cemetery

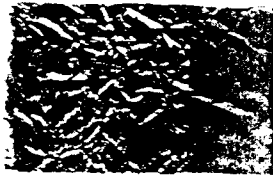

Cemetery visitors during the annual Qingming Festival (April 4th) in Hong Kong



Memorial Garden Feasibility Study

November 25, 2003

If a memorial garden were found to be feasible, what would the site selection criteria be?

- **River views, waterfront, natural water features**
- **Visual and auditory buffers**
- **Mountain view**
- **Historically significant**
- **Not in the flight path or near industrial areas**
- **Not in close proximity to residential**
- **Large enough to accommodate growth**

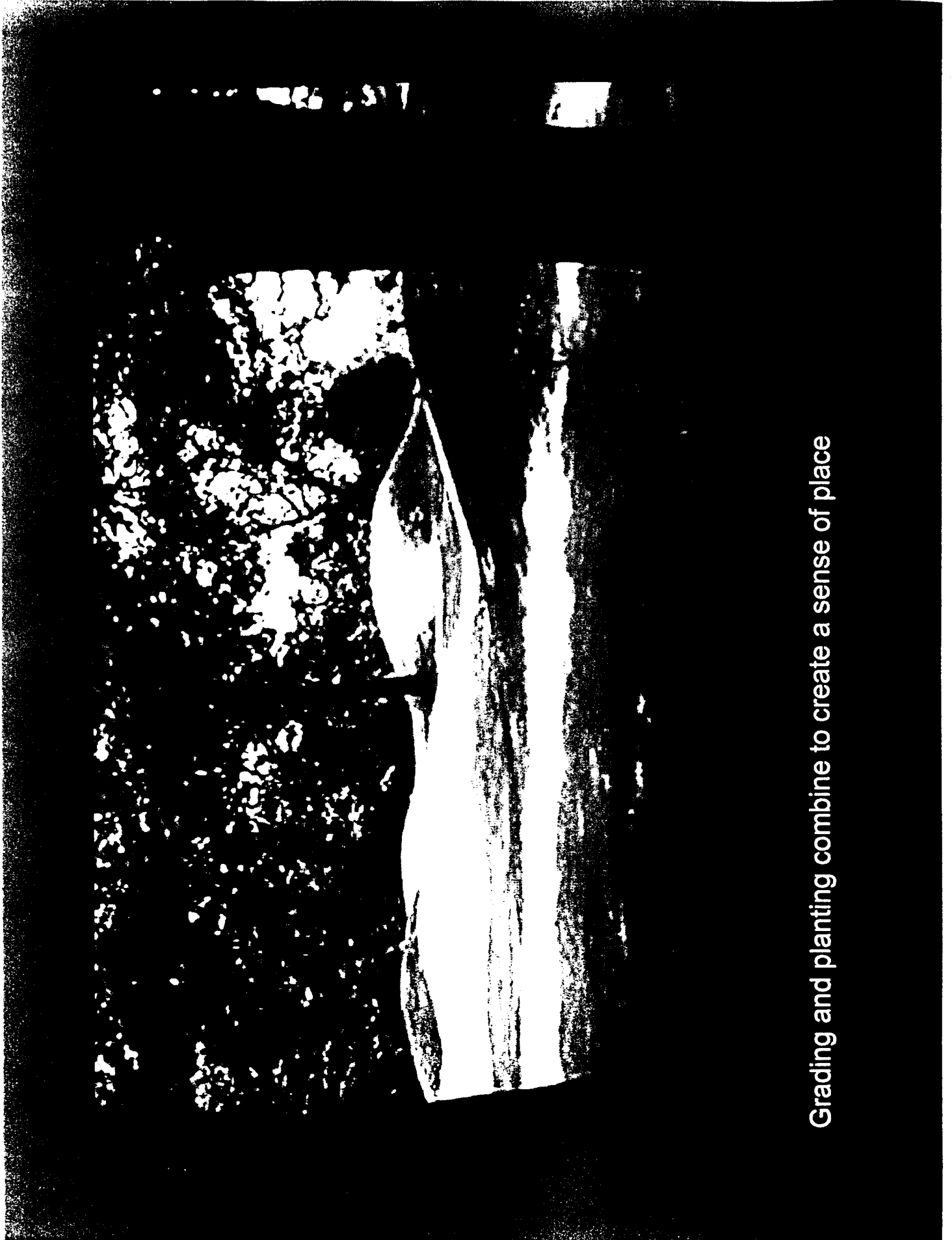

Grading and planting combine to create a sense of place



Memorial Garden Feasibility Study

November 25, 2003

What role should the City take in the Memorial Garden?

Opinions were varied from:

- City-owned
- A Public initiative
- Private
- No ongoing City financial involvement
- Public-private partnership
- City should be involved for control, planning and to ensure fairness/equality

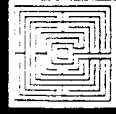

Recommendations:

1. Develop a business case analysis, including:
 - A pro forma
 - A detailed market study
2. Analyze potential governance models
3. Identify potential sites
4. Proceed directly to Phase II of the study

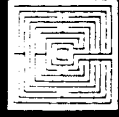

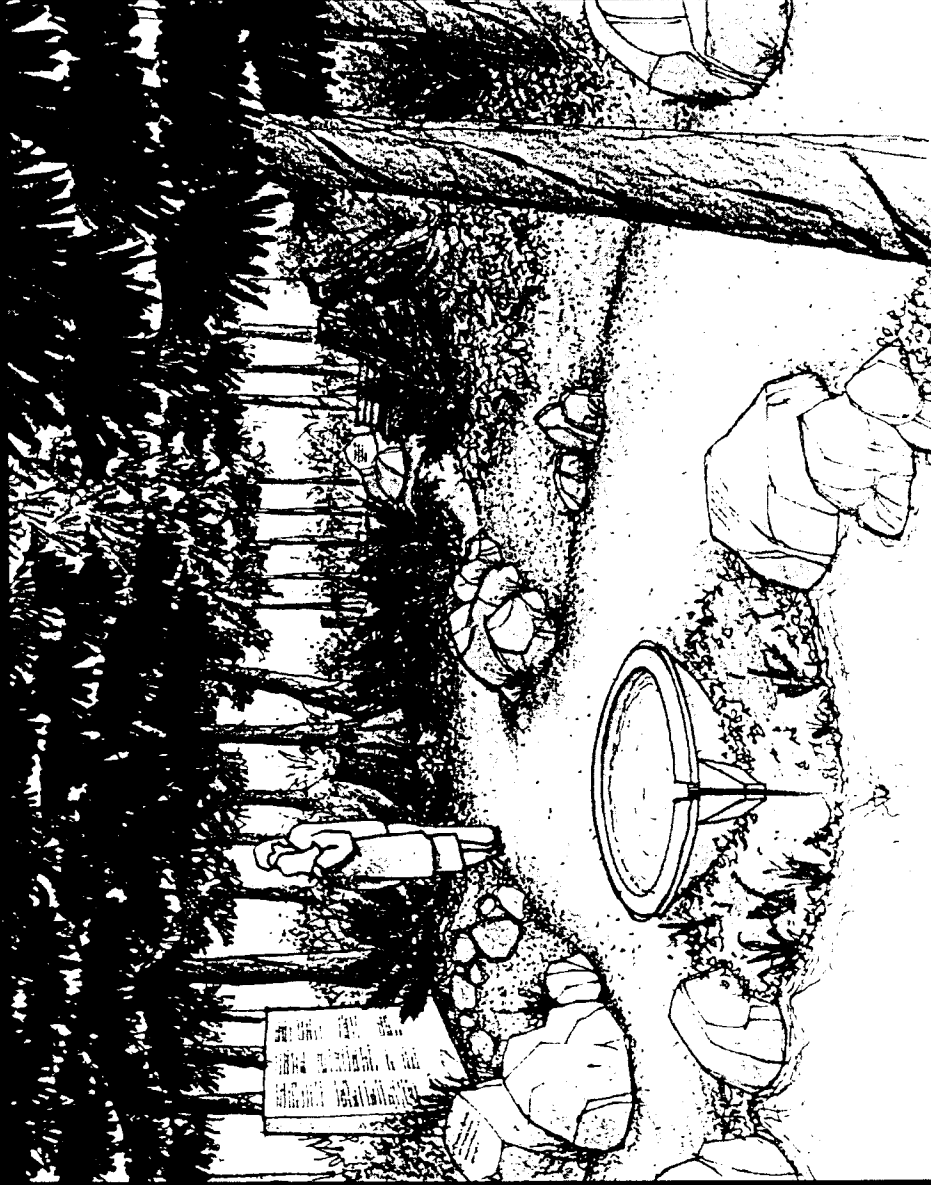

A scattering garden concept
Design: LEES + Associates



Memorial Garden Feasibility Study

November 25, 2003